

Plan  
Scale 1:1250

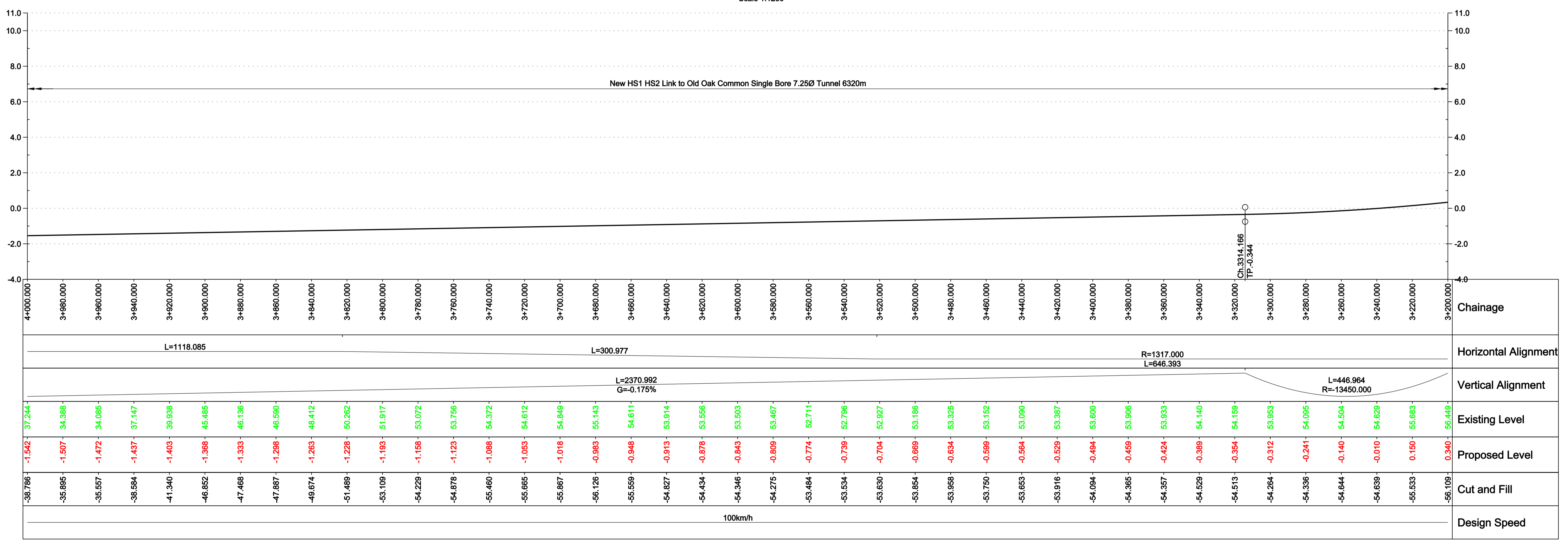

Profile  
Scale H 1:1250 V 1:125

© Crown copyright and database rights 2011 Ordnance Survey 10049190

**Legend**

- Listed buildings
- Area of Outstanding Natural Beauty
- RAMSAR
- World Heritage Site
- SSSI
- Special Areas of Conservation
- Special Protection Areas
- National Nature Reserves
- Parks and Gardens
- Scheduled Ancient Monuments
- Historical Battlefields
- National Parks
- Flood Risk Zones
- HS1 - HS2 Link
- Modified existing Classic Rail
- North London Line

**Notes**

- For notes and legend information refer to the keyplan information on drawing no.: HS2-ARP-00-DR-RW-05140
- Highway, Footpath and bridleway replacements not shown.
- For 1:10k Plan and Profile drawings of HS2 lines refer to: HS2-ARP-00-DR-RW-05001

2.0	05/01/12	SH	MP	CL
Approved				
1.0	23/12/11	CO	MP	CL
For Coordination				
Issue	Date	By	Chkd	Appd

Client: **hs2**

Job Title: **High Speed 2 Feasibility Study**

Scale at A1: **As Shown**

Discipline: **Rail**

**ARUP**

The Arup Campus, Blythe Gate, Blythe Valley Park  
Salford, West Midlands B90 8AE  
T +44(0)121 213 3000 F +44(0)121 213 3001  
www.arup.com

Drawing Title: **Post Consultation Route HS1 - HS2 Link Sheet 5 of 11**

Drawing Status: **Approved**

Job No: **209742-00**

Drawing No: **HS2-ARP-00-DR-RW-05145**

Issue: **2.0**