

Drawing No.
P 622.1A

Related Drawings
S 32 sheets 2 & 3

© CROWN COPYRIGHT

NOTES: 1. All dimensions for the 600mm dia sign shall be varied proportionally for the other roundel sizes.

2. Symbol details are given on drawing S 32 sheets 2 & 3.

3. The tile outline does not form part of the sign.

4. COLOURS : Border ----- RED
Symbol ----- BLACK
with white legend
Background --- WHITE

5. When the sign is used as a symbol on a directional sign the lorry symbol may be reversed as shown on drawing S 32 sheets 2 & 3.

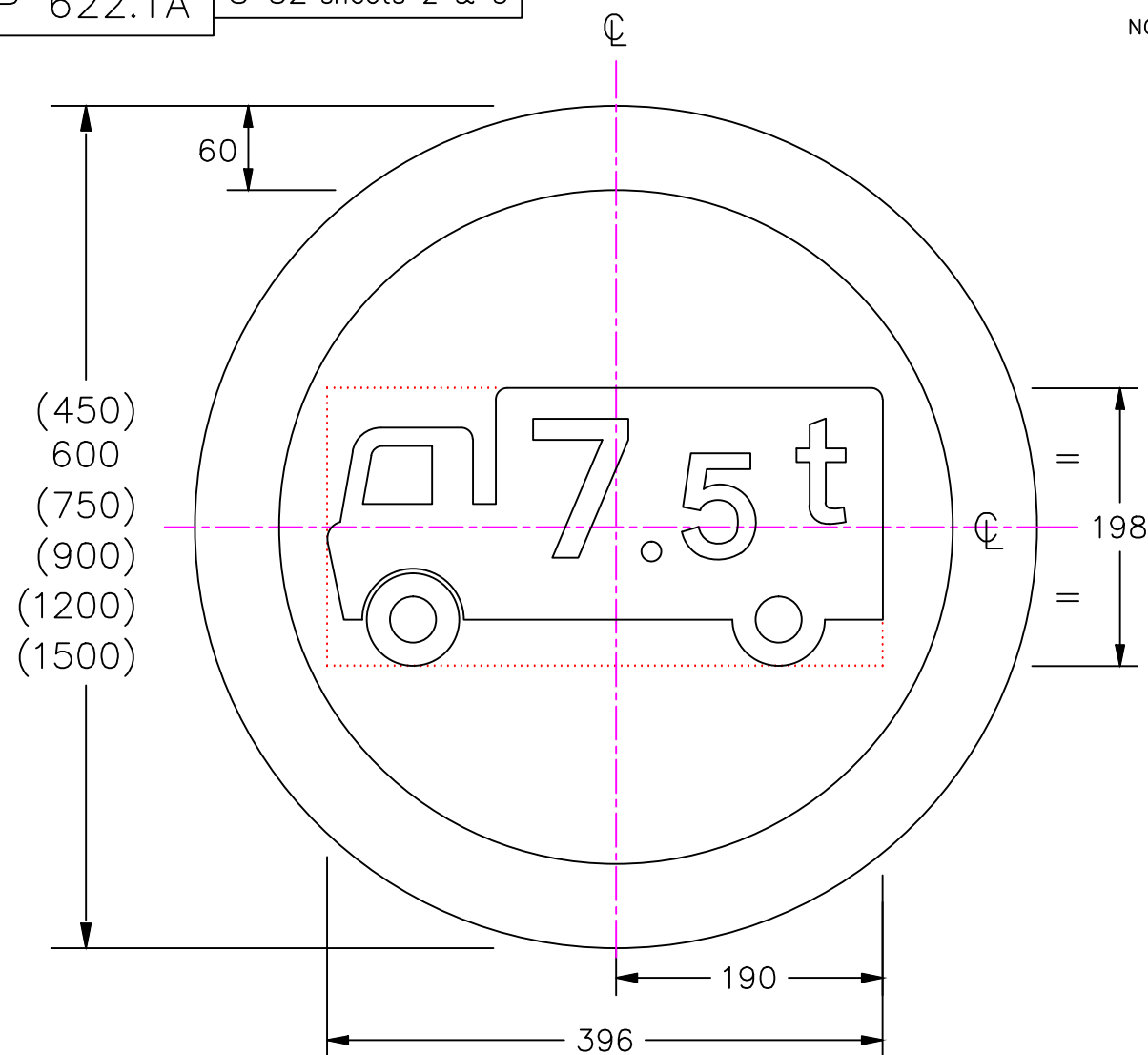

VARIANT

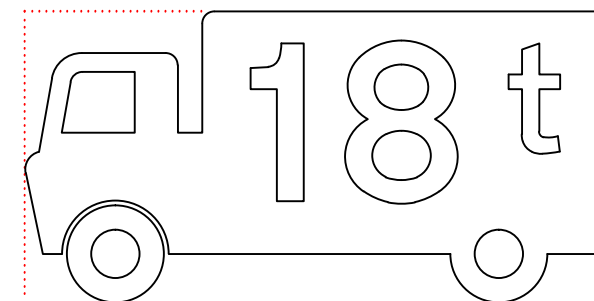

P622.1A

Before using this drawing, confirm that it has not been superseded.

**Department for
Transport**

Title: Regulatory Sign
GOODS VEHICLES OVER 7.5 TONNES
OR 18 TONNES (mgw) PROHIBITED

Issue: Date:
A: 5.7.94
B: 4.12.02
C: 11.11.11

Drawn by :
S.P.
Approved by :
R.M.

Dimensions :
MILLIMETRES

Drawing No.
P 622.1A