



GT50/066/0004

**ROAD TRAFFIC REGULATION ACT 1984 – SECTIONS 64 AND 65
AUTHORISATION OF TRAFFIC SIGNS AND SPECIAL DIRECTIONS**

The Secretary of State for Transport, in exercise of his powers under Sections 64 and 65 of the Road Traffic Regulation Act 1984, and of all other powers enabling him in that behalf, for the purpose of informing road users of contra-flow cycles on Kent Street and Maidstone Road, Leicester, hereby:-

1. authorises the erection at or within 5 metres of the sites shown schematically in the attached set of plans numbered GT50/066/0004-1 of a traffic sign (hereinafter referred to as “the authorised sign”) conforming as to size, colour and character with that shown on the attached drawing numbered NP 960.2; and
2. directs that, notwithstanding the provisions of Direction 18 of the Traffic Signs General Directions 2002 (Part II of SI 2002/3113), the authorised sign may be used with the road marking shown in diagram 1057 in Schedule 6 to the Traffic Signs Regulations 2002 (Part I of SI 2002/3113, “the 2002 Regulations”); and
3. directs that it is a condition of this authorisation that the authorised sign may be placed only to indicate the effect of a corresponding Traffic Regulation Order; and
4. directs, without prejudice to any statutory provision to the like effect, that it is a condition of this authorisation that the erection of the authorised sign at or near the said sites shall continue to have effect only until such day as may be appointed by one month’s notice given by the Secretary of State in writing to the traffic authority for the removal or alteration of the authorised sign and on that day the said authorisation shall, without prejudice to the giving of any further authorisation or direction, cease to have effect.



GT50/066/0004

The provisions of Regulations 12, 18 and 19 of the 2002 Regulations shall apply to the authorised sign in the same manner as they apply to the sign shown in diagram 960.1 in Schedule 5 to those Regulations.

Dated.....*28 April*.....2011

Signed by authority of the Secretary of State



.....
Transport



Existing Give Way marking denoting existing priorities to be taken out

Murray Street

Kent Street



Department for Transport
Date 28/4/2011
No. 6750/066/0004

Proposed "No Waiting" restriction

Proposed Advisory Contraflow Cycle Lane

Proposed Centre Line denoting new priority

Proposed sign NP960.2 to be provided on both sides of carriageway (subject to Departure from Standards and aft approval, to be sought by Project Manager and Designer advised accordingly)

- Proposed Centre Line denoting new priority
- Existing Gully to remain
- Proposed new kerb line to extended build-out
- Existing kerb line to be taken out
- Existing No Entry sign and post to be taken down

New bollards with sign 955 to create cycle gate to on carriageway advisory cycle lane

New No Entry sign (Illuminated) to be located such that cyclists do not travel between two No Entry signs so as not to contravene regulations

Proposed Give Way Signs and Markings to indicate change of priority

DK	DK	
		Extents of proposed dropped kerbs
		Proposed bollard
		Proposed bollard with sign 955
		Sign 955
		NP960.2 Unsegregated Contraflow Cycle Route

Leicester City Council
Regeneration & Culture Department
Highways & Transportation Division

CLIENT
TITLE

Transport Strategy

A47 Cycle Link

Kent Street Proposed Layout

DRAWING No.

HD/2595/SUS/005

REV

F

SCALE

1:250

DRAWN BY

VKB

DATE

20/01/2010

CHECKED

VKB

SIZE

A4

ACAD FILE

UPRN

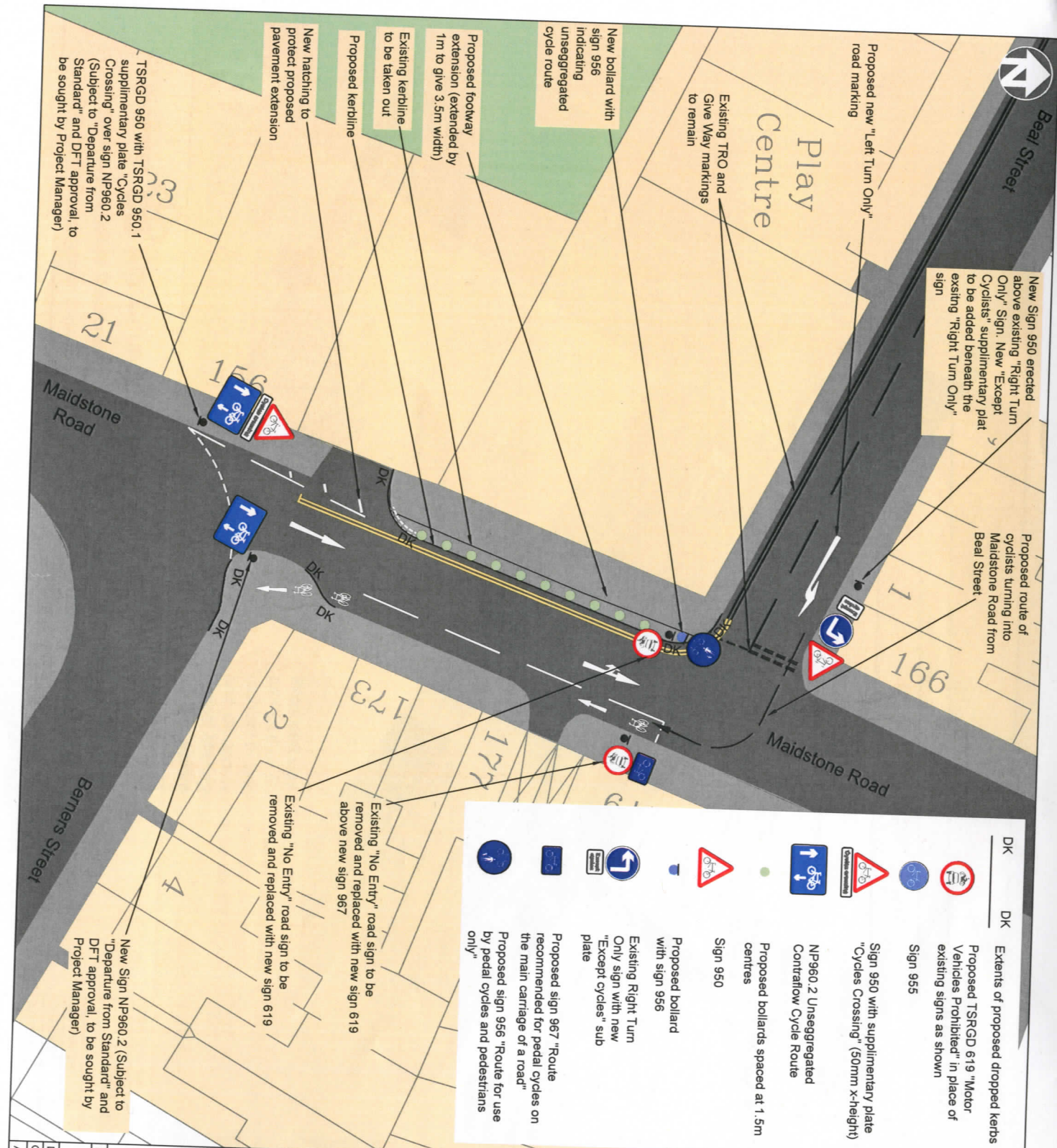

Drawing Number		HD2595/SUS/003	
Notes		1. Do not scale from this drawing use annotated dimensions only	
		2. All non-standard details (ie Sign NP 960.2) to be subject to approval from the council's relevant Department from Standards Board and dft approval, to be sought by the Project Manager. Project Manager to advise Designer if approval is not given	
		3. Signs shown not to scale	
Revision		Amendment	Date
A		Issued for Consultation	21/01
B		Includes TRO lining and bollards	03/02
C		Alterations as requested by Project Manager	04/02
D		Included NP 960.2 sign and "Elephant Feet" marking	08/02
E		Alterations as requested by Project Manager	08/02
F		Alterations for DFT	04/03
G		"Cycle Gate" bollards removed	05/03
H		Layout revised to include new 619 in place of existing 616. "Elephant Feet" road markings removed	08/03
J		Alterations to DFT requirements	16/03
K		Amended as to DFT instructions sent 24/11/2010	26/11
Title		A47 Cycle Link	
Client		Leicester City Council Regeneration & Culture Department Highways & Transportation Division	
Drawing No.		REV	SCALE
HD2595/SUS/003		K	1:250
DRAWN BY		VMB	DATE
CHECKED		VMB	SIZE
ACAD FILE		UPRN	A3

NP 960.2

245