



GT50/114/0006

**ROAD TRAFFIC REGULATION ACT 1984 – SECTIONS 64 AND 65
AUTHORISATION OF TRAFFIC SIGNS AND SPECIAL DIRECTIONS**

The Secretary of State for Transport, in exercise of his powers under Sections 64 and 65 of the Road Traffic Regulation Act 1984, and of all other powers enabling him in that behalf, for the purpose of informing road users of access restrictions and the presence of contra-flow cycles in Market Street, Kettering, hereby: -

1. authorises the erection at or within 5 metres of the sites indicated schematically in the attached set of plans numbered GT50/114/0006 of a traffic sign (hereinafter referred to as “the authorised sign”) conforming as to size, colour and character with that shown on the attached working drawing numbered NP960.2; and
2. directs that, notwithstanding the provisions of Direction 18 of the Traffic Signs General Directions 2002 (Part II of SI 2002/3113), the authorised sign may be used with the road marking shown in diagram 1057 in Schedule 6 to the Traffic Signs Regulations 2002 (Part I of SI 2002/3113, “the 2002 Regulations”); and
3. directs that it is a condition of this authorisation that the authorised sign may be placed only to indicate the effect of a corresponding Traffic Regulation Order; and



GT50/114/0006

4. directs, without prejudice to any statutory provision to the like effect, that it is a condition of this authorisation that the erection of the authorised sign at or near the said sites shall continue to have effect only until such day as may be appointed by one month's notice given by the Secretary of State in writing to the traffic authority for the removal or alteration of the authorised sign and on that day the said authorisation shall, without prejudice to the giving of any further authorisation or direction, cease to have effect.

The provisions of Regulations 12, 18 and 19 of the 2002 Regulations shall apply to the authorised sign in the same manner as they apply to the sign shown in diagram 960.1 in Schedule 5 to those Regulations.

Dated... 22 March2011

Signed by authority of the Secretary of State

...



A Grade 7 Official of the Department for Transport



NOTES.

1. SIGNAGE OUTSIDE OF (AND WAITING/LOADING RESTRICTION SIGNAGE WITHIN) THE INTENDED PEDESTRIAN ZONE HAS BEEN OMITTED FOR CLARITY. FULL SIGNAGE IS COVERED ON DRAWING D12315-T-861.
2. OMISSION OF YELLOW MARKINGS (TO TSRGD(2002)) WITHIN THE PEDESTRIAN ZONE IS THE SUBJECT OF A SEPARATE REQUEST FOR AUTHORISATION.
3. SIGN FACE AND POST INDICATIONS ARE NOT TO SCALE.
4. SIGNS TO DIAGRAM NP960.2 ARE SPECIFIED AT THE LARGER PRESCRIBED SIZE (780x570mm) OWING TO THE OMISSION OF CARRIAGEWAY MARKINGS.
5. ● ■ INDICATE STREET LIGHTING COLUMNS.

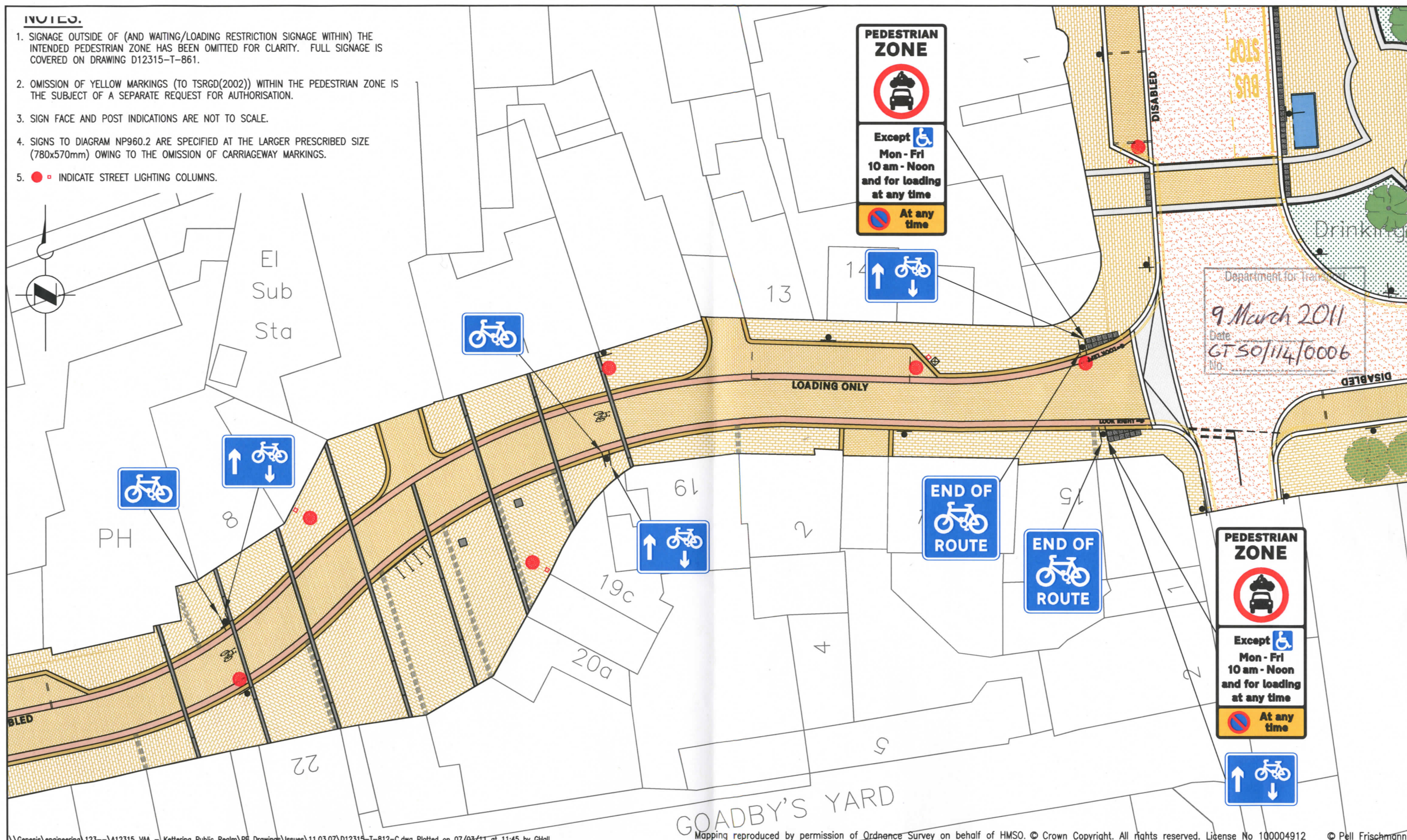

\\Genesis\\engineering\\123--\\A12315_VAA - Kettering Public Realm\\PF Drawings\\Issues\\11.03.07\\D12315-T-812-C.dwg Plotted on 07/03/11 at 11:45 by GHall

Mapping reproduced by permission of Ordnance Survey on behalf of HMSO. © Crown Copyright. All rights reserved. License No 100004912 © Pell Frischmann

Pell Frischmann

5 MANCHESTER SQUARE LONDON W1U 3PD

Telephone +44 (0)20 7486 3661
Email: pflondon@pellfrischmann.com
www.pellfrischmann.com

Project

KETTERING BOROUGH COUNCIL
PUBLIC REALM WORKS
PHASES 2 AND 3

Drawing Title

CASE 1866 - SUMMARY MARKET STREET SIGNAGE FOR THE SPECIAL
AUTHORISATION FOR THE USE OF ADVISORY CONTRA-FLOW CYCLE SIGNS
AS SPECIFIED IN DFT WORKING DRAWING NP 960.2

Name	Date	Scale
Drawn	CJO	12.07.10
Designed	CJO	06.07.10
Checked	AT	13.07.10
Approved	JAC	13.07.10
File No.		D12315-T-812-C.dwg
Drawing Status		FOR APPROVAL

Drawing No.

D12315-T-812 SHEET 1

Revision

C

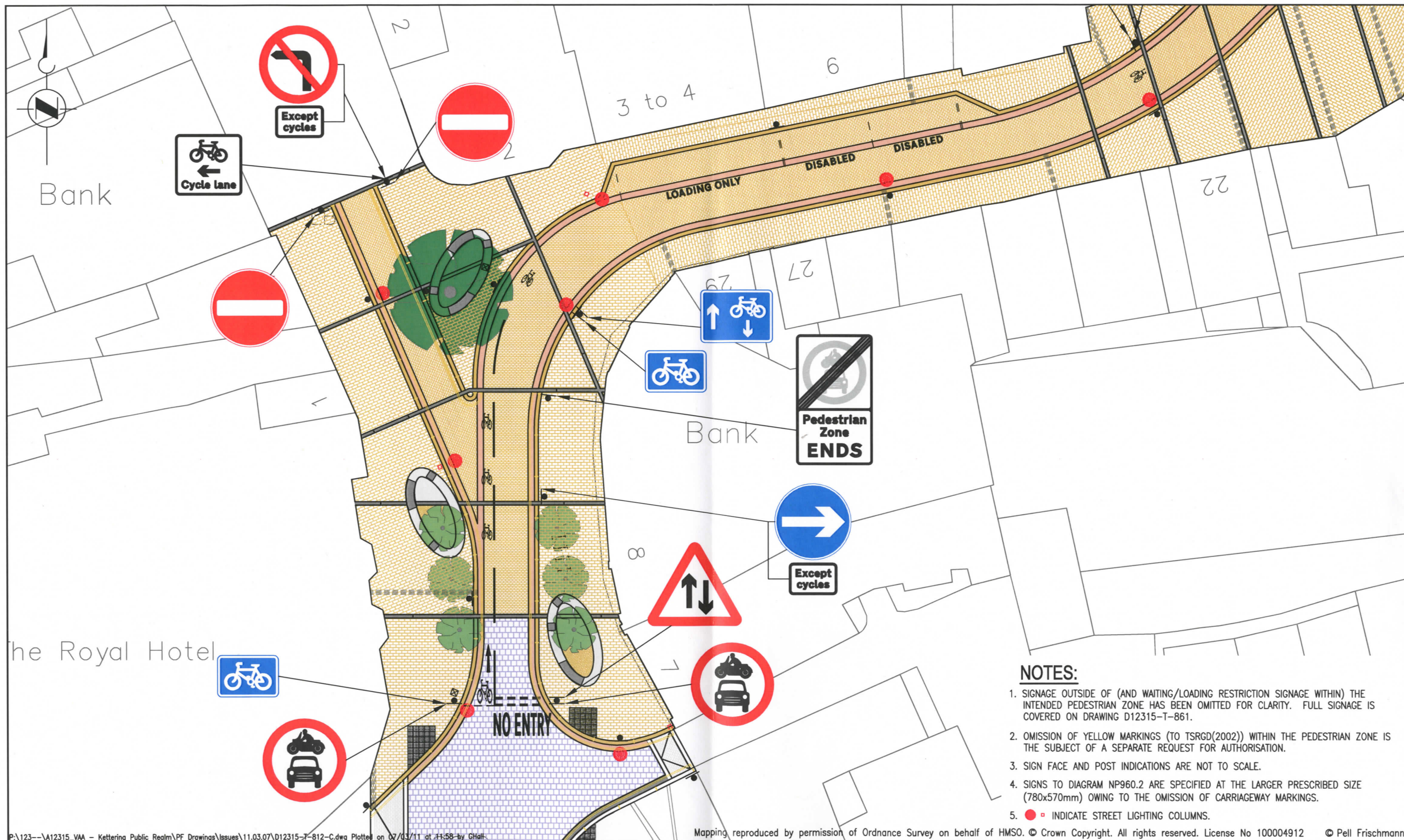

NOTES:

- SIGNAGE OUTSIDE OF (AND WAITING/LOADING RESTRICTION SIGNAGE WITHIN) THE INTENDED PEDESTRIAN ZONE HAS BEEN OMITTED FOR CLARITY. FULL SIGNAGE IS COVERED ON DRAWING D12315-T-861.
- OMISSION OF YELLOW MARKINGS (TO TSRGD(2002)) WITHIN THE PEDESTRIAN ZONE IS THE SUBJECT OF A SEPARATE REQUEST FOR AUTHORISATION.
- SIGN FACE AND POST INDICATIONS ARE NOT TO SCALE.
- SIGNS TO DIAGRAM NP960.2 ARE SPECIFIED AT THE LARGER PRESCRIBED SIZE (780x570mm) OWING TO THE OMISSION OF CARRIAGEWAY MARKINGS.
- ■ INDICATE STREET LIGHTING COLUMNS.

Mapping reproduced by permission of Ordnance Survey on behalf of HMSO. © Crown Copyright. All rights reserved. License No 100004912 © Pell Frischmann

Pell Frischmann

5 MANCHESTER SQUARE LONDON W1U 3PD

Telephone +44 (0)20 7486 3661
Email: pflondon@pellfrischmann.com
www.pellfrischmann.com

Project

**KETTERING BOROUGH COUNCIL
PUBLIC REALM WORKS
PHASES 2 AND 3**

Drawing Title

**CASE 1866 - SUMMARY MARKET STREET SIGNAGE FOR THE SPECIAL
AUTHORISATION FOR THE USE OF ADVISORY CONTRA-FLOW CYCLE SIGNS
AS SPECIFIED IN DFT WORKING DRAWING NP 960.2**

	Name	Date	Scale
Drawn	CJO	12.07.10	1:250 @ A3
Designed	CJO	06.07.10	File No. D12315-T-812-C.dwg
Checked	AT	13.07.10	Drawing Status
Approved	JAC	13.07.10	FOR APPROVAL

Drawing No.

D12315-T-812 SHEET 2

Revision

B

NOTES:

1. SIGNAGE OUTSIDE OF (AND WAITING/LOADING RESTRICTION SIGNAGE WITHIN) THE INTENDED PEDESTRIAN ZONE HAS BEEN OMITTED FOR CLARITY. FULL SIGNAGE IS COVERED ON DRAWING D12315-T-861.
2. OMISSION OF YELLOW MARKINGS (TO TSRGD(2002)) WITHIN THE PEDESTRIAN ZONE IS THE SUBJECT OF A SEPARATE REQUEST FOR AUTHORISATION.
3. SIGN FACE AND POST INDICATIONS ARE NOT TO SCALE.
4. SIGNS TO DIAGRAM NP960.2 ARE SPECIFIED AT THE LARGER PRESCRIBED SIZE (780x570mm) OWING TO THE OMISSION OF CARRIAGEWAY MARKINGS.

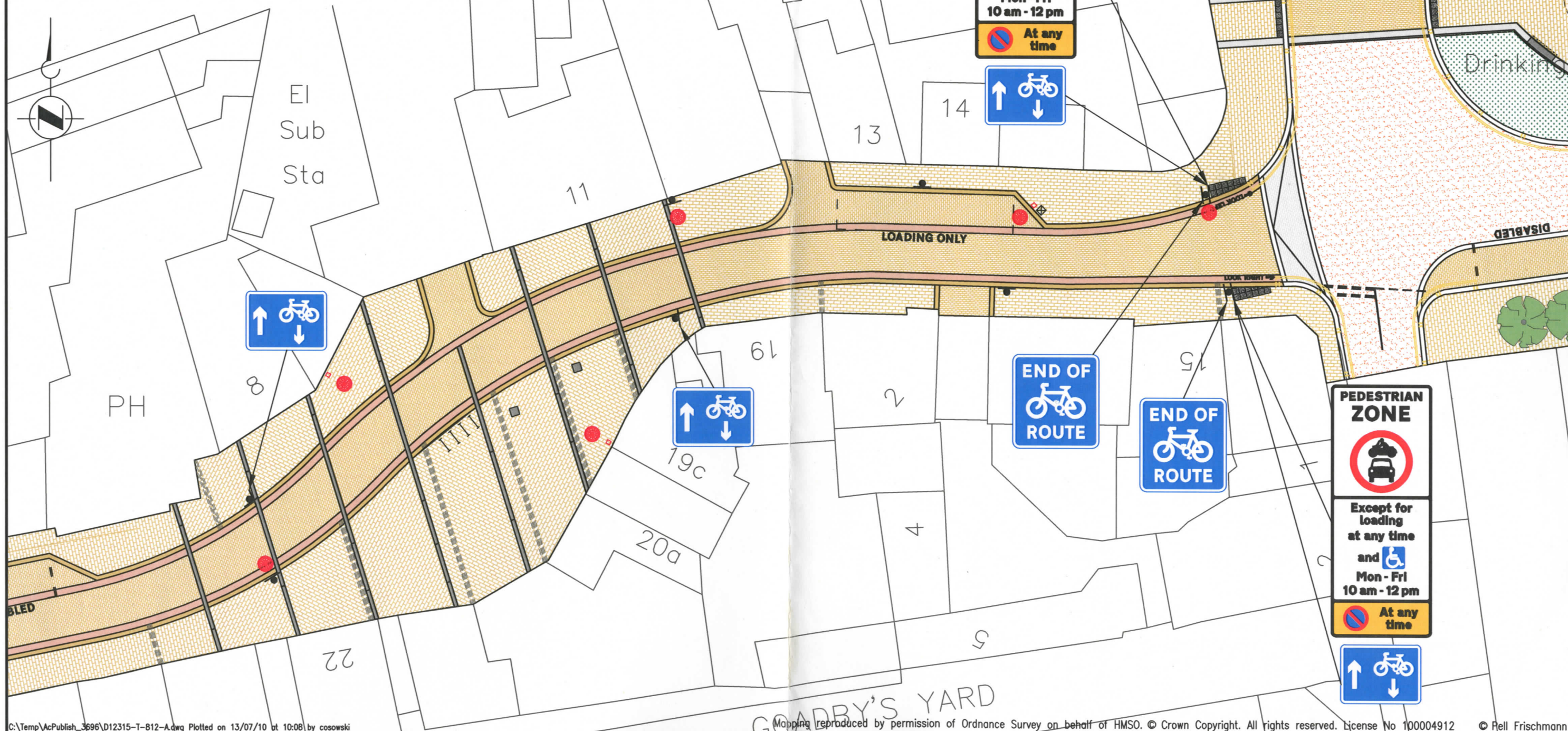

C:\Temp\AcPublish_3696\12315-T-812-A.dwg Plotted on 13/07/10 at 10:08 by cosowski

Mapping reproduced by permission of Ordnance Survey on behalf of HMSO. © Crown Copyright. All rights reserved. License No 100004912 © Pell Frischmann

Pell Frischmann

5 MANCHESTER SQUARE LONDON W1U 3PD

Telephone +44 (0)20 7486 3661
Email: pflondon@pellfrischmann.com
www.pellfrischmann.com

Project

KETTERING BOROUGH COUNCIL
PUBLIC REALM WORKS
PHASES 2 AND 3

Drawing Title

SUMMARY MARKET STREET SIGNAGE FOR THE SPECIAL
AUTHORISATION FOR THE USE OF ADVISORY CONTRA-FLOW CYCLE SIGNS
AS SPECIFIED IN DFT WORKING DRAWING NP 960.2

Name	Date	Scale
Drawn	CJO	12.07.10
Designed	CJO	06.07.10
Checked	AT	13.07.10
Approved	JAC	13.07.10
Drawing No.		File No. D12315-T-812-A.dwg
D12315-T-812 SHEET 1		Drawing Status FOR APPROVAL
Revision		A

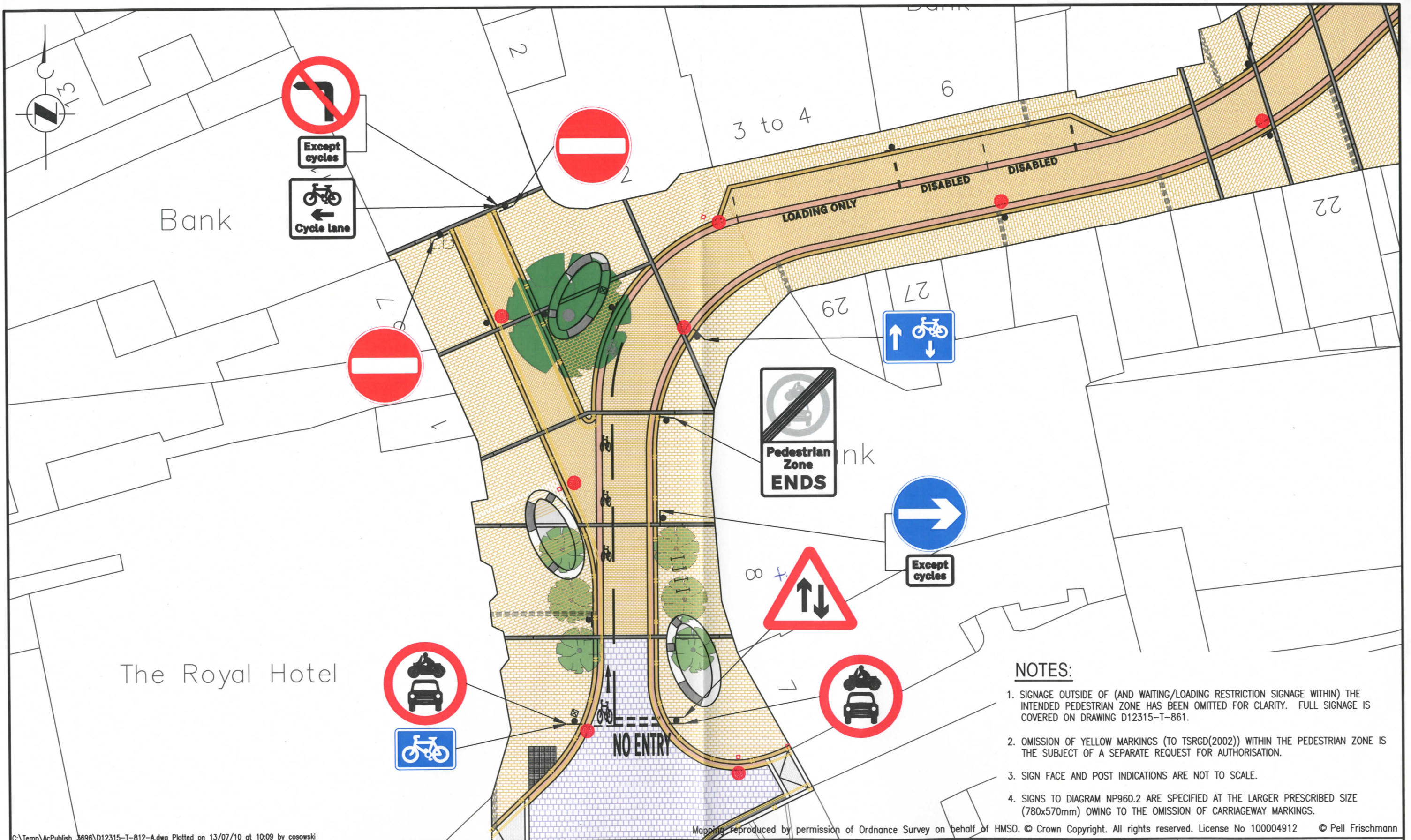

NOTES:

1. SIGNAGE OUTSIDE OF (AND WAITING/LOADING RESTRICTION SIGNAGE WITHIN) THE INTENDED PEDESTRIAN ZONE HAS BEEN OMITTED FOR CLARITY. FULL SIGNAGE IS COVERED ON DRAWING D12315-T-861.
2. OMISSION OF YELLOW MARKINGS (TO TSRGD(2002)) WITHIN THE PEDESTRIAN ZONE IS THE SUBJECT OF A SEPARATE REQUEST FOR AUTHORISATION.
3. SIGN FACE AND POST INDICATIONS ARE NOT TO SCALE.
4. SIGNS TO DIAGRAM NP960.2 ARE SPECIFIED AT THE LARGER PRESCRIBED SIZE (780x570mm) OWING TO THE OMISSION OF CARRIAGEWAY MARKINGS.

Mapping reproduced by permission of Ordnance Survey on behalf of HMSO. © Crown Copyright. All rights reserved. License No 100004912 © Pell Frischmann

C:\Temp\AcPublish_3696\012315-T-812-A.dwg Plotted on 13/07/10 at 10:09 by cosowski

Pell Frischmann

5 MANCHESTER SQUARE LONDON W1U 3PD

Telephone +44 (0)20 7486 3661
Email: pflondon@pellfrischmann.com
www.pellfrischmann.com

Project

KETTERING BOROUGH COUNCIL
PUBLIC REALM WORKS
PHASES 2 AND 3

Drawing Title

SUMMARY MARKET STREET SIGNAGE FOR THE SPECIAL
AUTHORISATION FOR THE USE OF ADVISORY CONTRA-FLOW CYCLE SIGNS
AS SPECIFIED IN DFT WORKING DRAWING NP 960.2

	Name	Date	Scale
Drawn	CJO	12.07.10	1:250 @ A3
Designed	CJO	06.07.10	File No. D12315-T-812-A.dwg
Checked	AT	13.07.10	Drawing Status
Approved	JAC	13.07.10	FOR APPROVAL

Drawing No.

D12315-T-812 SHEET 2

Revision

A