

ROAD TRAFFIC REGULATION ACT 1984 – SECTIONS 64 AND 65
AUTHORISATION OF TRAFFIC SIGNS AND SPECIAL DIRECTIONS

The Secretary of State for Transport, in exercise of his powers under Sections 64 and 65 of the Road Traffic Regulation Act 1984, and all other powers enabling him in that behalf, for the purposes of informing road users of sites reserved for authorised vehicles engaged in bus lane enforcement in Bury , hereby:-

1. authorises the erection at or within 5 metres of the sites marked with a green cross in the attached set of plans numbered GT50/018/0004-1 of a traffic sign (hereinafter referred to as “the authorised sign) conforming as to size, colour and character with that shown at A on the attached drawing numbered GT50/018/0004-2, save that the legend shall be “Authorised vehicles only”; and
2. authorises the placing at the sites highlighted in yellow in the said set of plans of a traffic sign consisting of a road marking, (hereinafter referred to as “the authorised marking”) conforming as to size, colour and character with that shown in diagram 1010 in Schedule 6 to the Traffic Signs Regulations 2002 (Part I of SI 2002/3113, “the 2002 Regulations”), save that the layout and size of the bay shall be as shown in the said set of plans; and
3. directs that the authorised marking may only be used with the authorised sign; and



GT50/018/0004

4. directs, without prejudice to any statutory provision to the like effect, that it is a condition of this authorisation that the erection of the authorised sign and the placing of the authorised marking at or near the said sites shall continue to have effect only until such day as may be appointed by one month's notice given by the Secretary of State in writing to the traffic authority for the removal or alteration of the authorised sign and the authorised marking and on that day the said authorisation shall, without prejudice to the giving of any further authorisation or direction, cease to have effect.

The provisions of Regulations 12, 18 and 19 of the 2002 Regulations shall apply to the authorised sign in the same manner as they apply to the sign shown in diagram 829.1 in Schedule 4 to those Regulations.

The provisions of Regulations 12 and 31 of the [Traffic Signs Regulations 2002 (Part I of SI 2002/3113)] or [2002 Regulations] shall apply to the authorised marking in the same manner as they apply to the road marking shown in diagram 1057 in Schedule 6 to those Regulations

Dated.....5 March..... 2008

Signed by authority of the Secretary of State

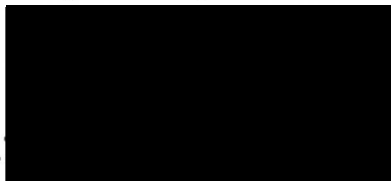

.....
A Grade 7 Official of the Department for Transport



Date 3/3/2011
 No. GT50/018/004-2

SCHEDULE—PART 4

New diagrams for Schedule 4 to the 2002 regulations (continued)



(50)
62.5
 (75)
 (100)
 (125)

820A

Road unsuitable for heavy goods vehicles

Item	
1	Regulations: None
2	Directions: None
3	Diagrams: None
4	Permitted variants: Schedule 16, items 11, 28 "heavy goods vehicles" may be varied to "HGVs". The legend may be omitted when an arrow is added to the sign
5	Illumination requirements: Schedule 17, item 4

A

75

829.6

Waiting place at a lay-by or observation platform for police or other authorised vehicles only

Item	
1	Regulations: None
2	Directions: None
3	Diagrams: None
4	Permitted variants: "patrol" may be omitted. "Police patrol" may be varied to "Authorised"
5	Illumination requirements: Schedule 17, item 4



37.5 min
 100 max

75 min
 200 max

832.1B

Vehicle check point ahead

Item	
1	Regulations: None
2	Directions: None
3	Diagrams: None
4	Permitted variants: Schedule 16, item 47
5	Illumination requirements: Schedule 17, item 4



37.5 min
 100 max

75 min
 200 max

832.2B

Vehicle condition check point ahead

Item	
1	Regulations: None
2	Directions: None
3	Diagrams: None
4	Permitted variants: Schedule 16, item 47
5	Illumination requirements: Schedule 17, item 4

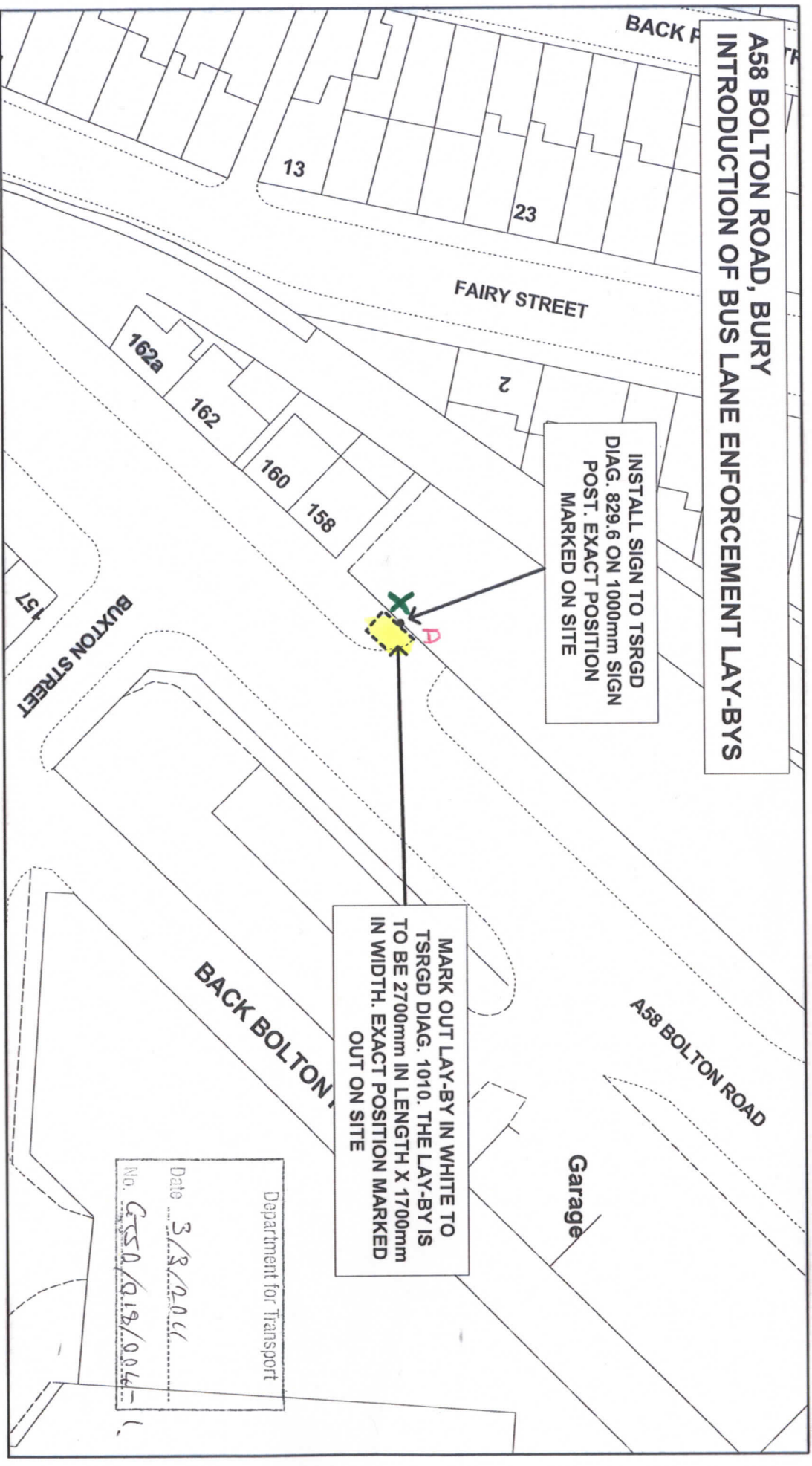

PLAN TS2202A
SCALE 1:500
DRAWN ECJ
DATE 13.09.10

Environment and Development Services
Operations Division
Traffic Management & Road Safety Services
3 Knowsley Place
Duke Street, Bury, BL9 0EJ
Telephone 0161-253 7799
Fax No 0161-253 7963



Reproduced from the Ordnance Survey map with the permission of the Controller of H.M. Stationery Office © Crown Copyright. Unauthorised reproduction infringes Crown copyright & may lead to prosecution & civil proceedings. Bury Council Licence 100023063/2010

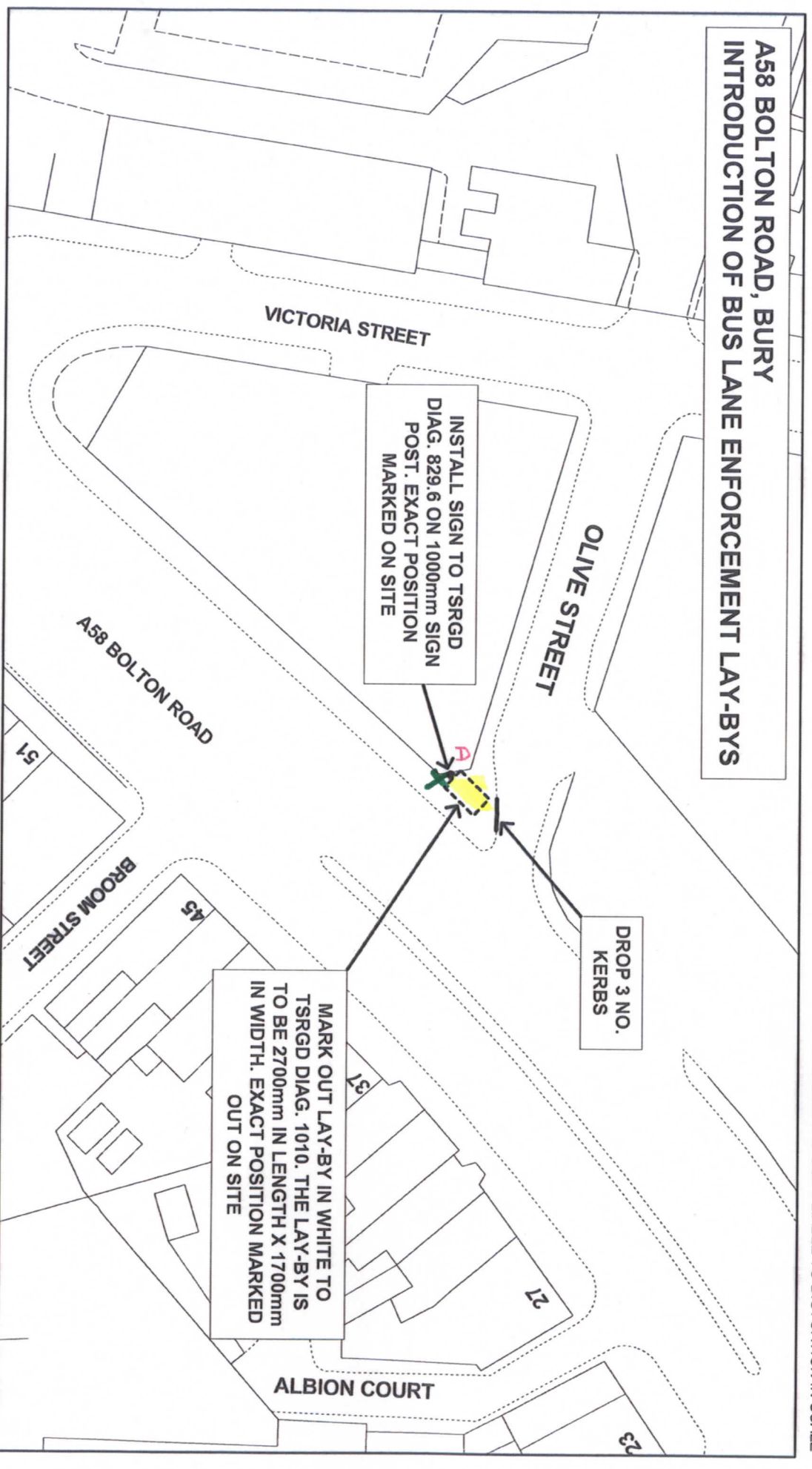

PLAN TS2202B
SCALE 1:500
DRAWN ECJ
DATE 13.09.10

Environment and Development Services
Operations Division
Traffic Management & Road Safety Services
3 Knowsley Place
Duke Street, Bury, BL9 0EJ
Telephone 0161-253 7799
Fax No 0161-253 7963



Reproduced from the Ordnance Survey map with the permission of the Controller of H.M. Stationery Office © Crown Copyright. Unauthorised reproduction infringes Crown copyright & may lead to prosecution & civil proceedings. Bury Council Licence 100023063/2010

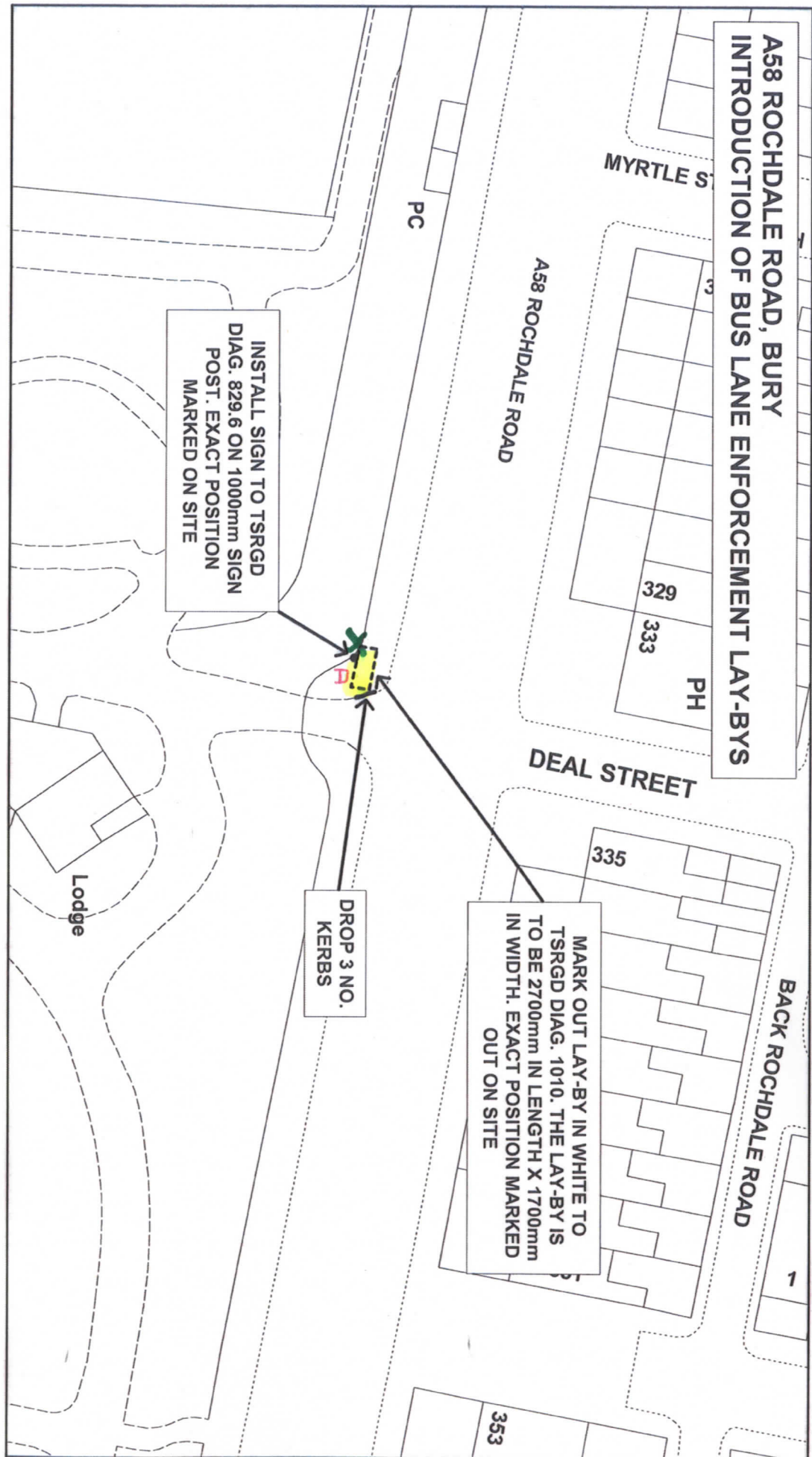

PLAN TS2202C
SCALE 1:500
DRAWN ECJ
DATE 13.09.10

Environment and Development Services
Operations Division
Traffic Management & Road Safety Services
3 Knowsley Place
Duke Street, Bury, BL9 0EJ
Telephone 0161-253 7799
Fax No 0161-253 7963



Reproduced from the Ordnance Survey map with the permission of the Controller of H.M. Stationery Office © Crown Copyright. Unauthorised reproduction infringes Crown copyright & may lead to prosecution & civil proceedings. Bury Council Licence 100023063/2010

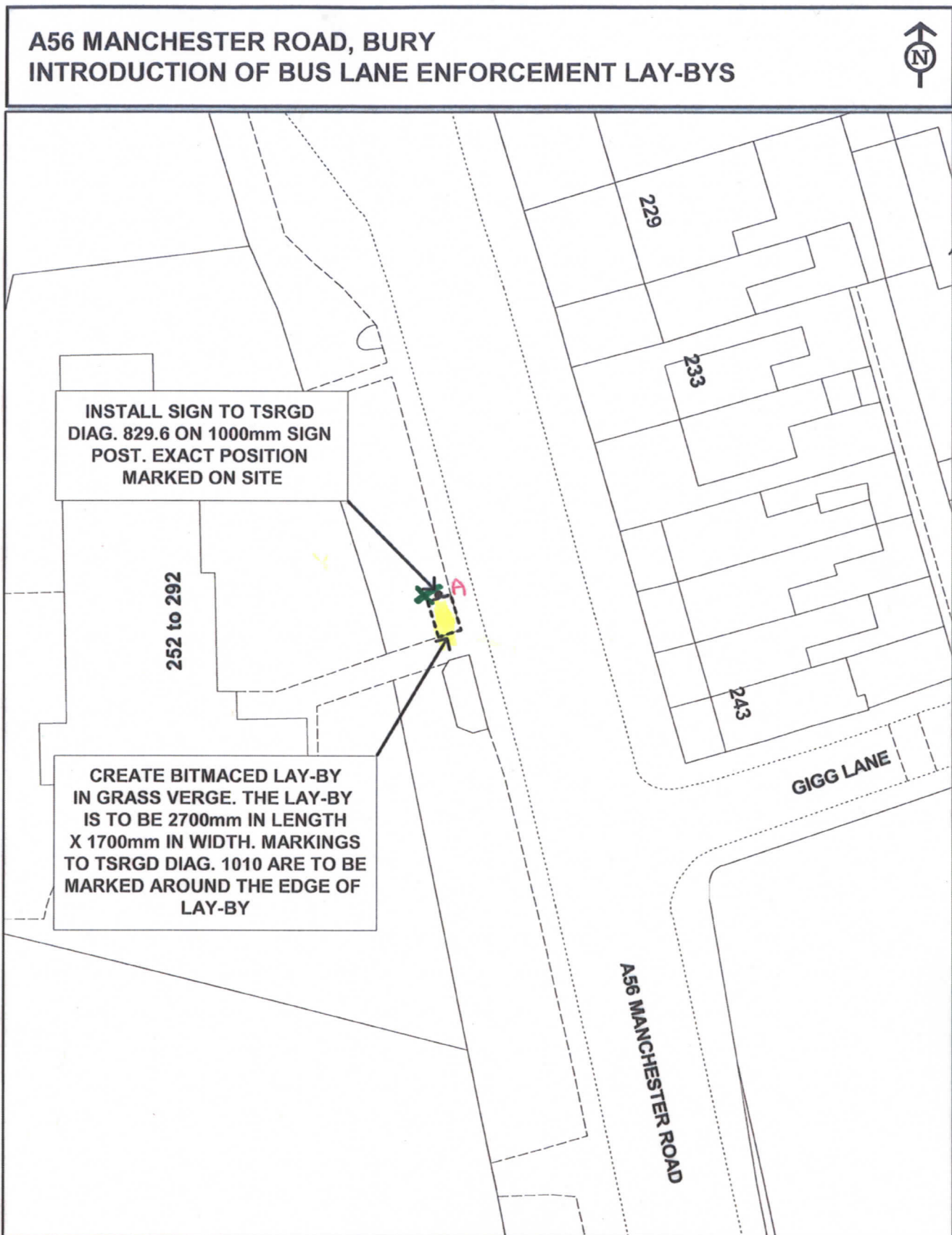

PLAN TS2202D
SCALE 1:500
DRAWN ECJ
DATE 13.09.10

Environment and Development Services
Operations Division
Traffic Management & Road Safety Services
3 Knowsley Place
Duke Street
Bury BL9 0EJ
Tel : 0161-253 7799
Fax : 0161-253 7963



A665 BURY OLD ROAD, PRESTWICH INTRODUCTION OF BUS LANE ENFORCEMENT LAY-BYS

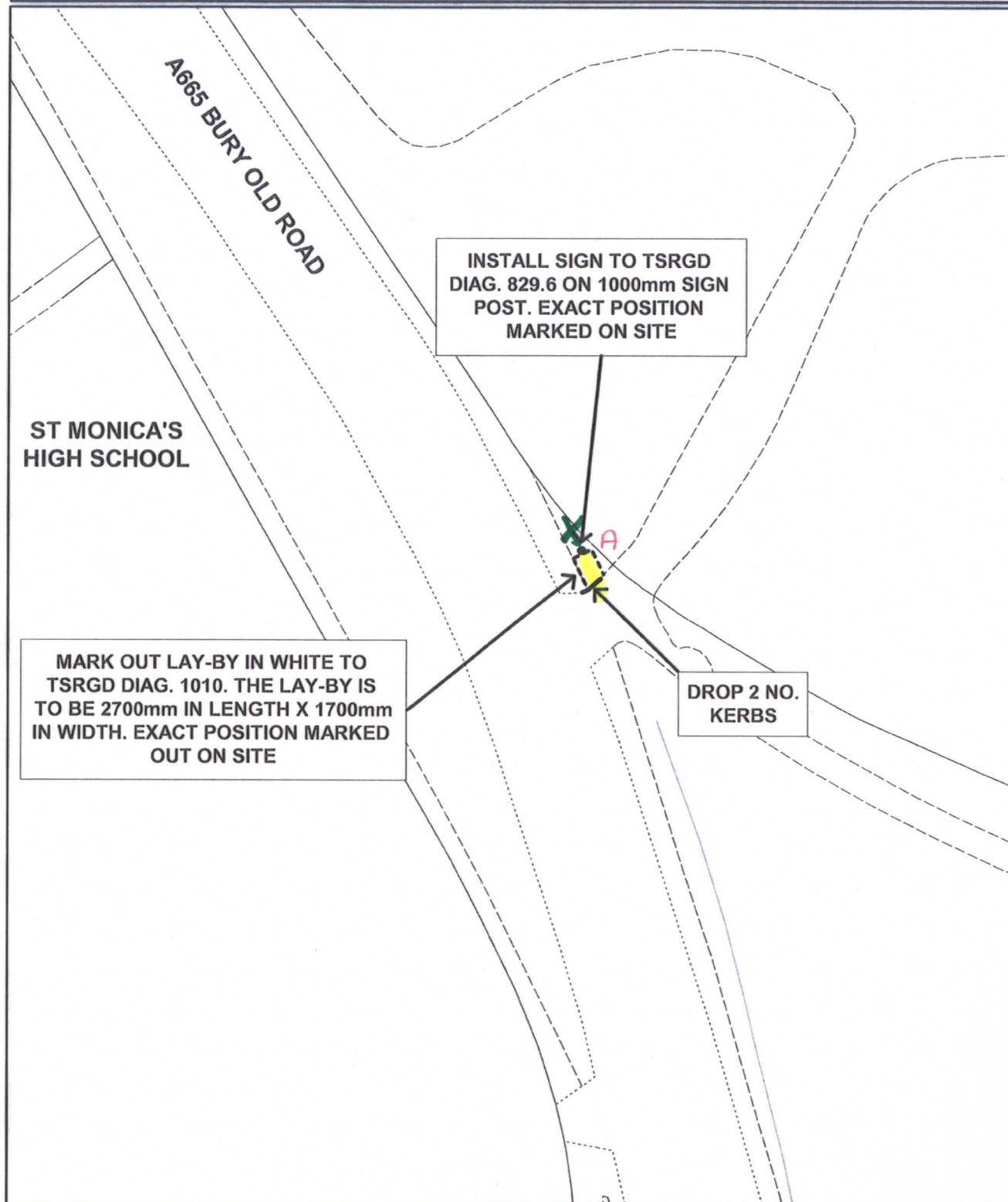

PLAN TS2202F
SCALE 1:500
DRAWN ECJ
DATE 13.09.10

Environment and Development Services
Operations Division
Traffic Management & Road Safety Services

3 Knowsley Place
Duke Street
Bury BL9 0EJ

Tel : 0161-253 7799
Fax : 0161-253 7963

Bury
COUNCIL

A56 BURY NEW ROAD, WHITEFIELD INTRODUCTION OF BUS LANE ENFORCEMENT LAY-BYS

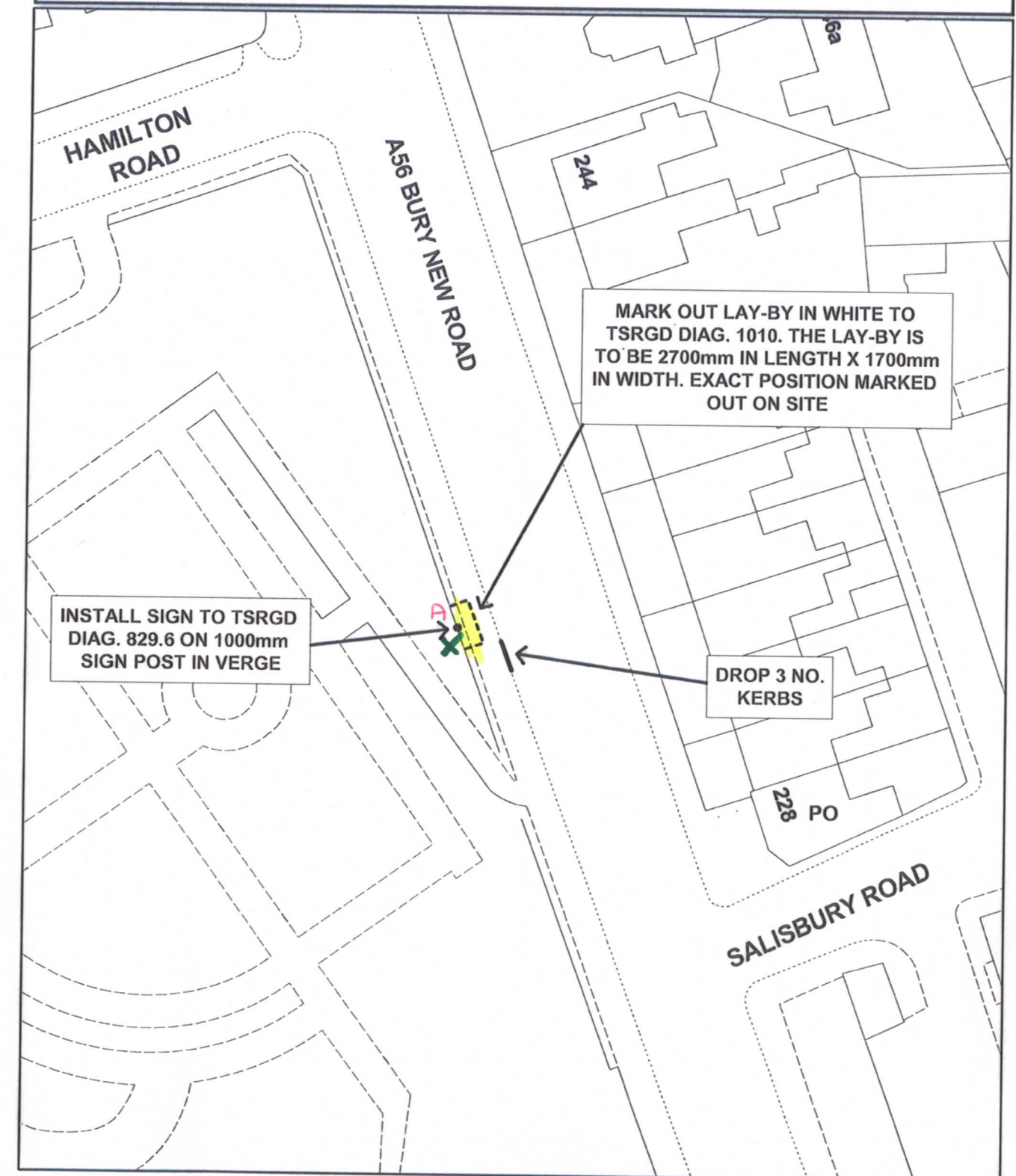

PLAN TS2202E
SCALE 1:500
DRAWN ECJ
DATE 13.09.10

Environment and Development Services
Operations Division
Traffic Management & Road Safety Services

3 Knowsley Place
Duke Street
Bury BL9 0EJ

Tel : 0161-253 7799
Fax : 0161-253 7963

Bury
COUNCIL

A665 BURY OLD ROAD, PRESTWICH INTRODUCTION OF BUS LANE ENFORCEMENT LAY-BYS

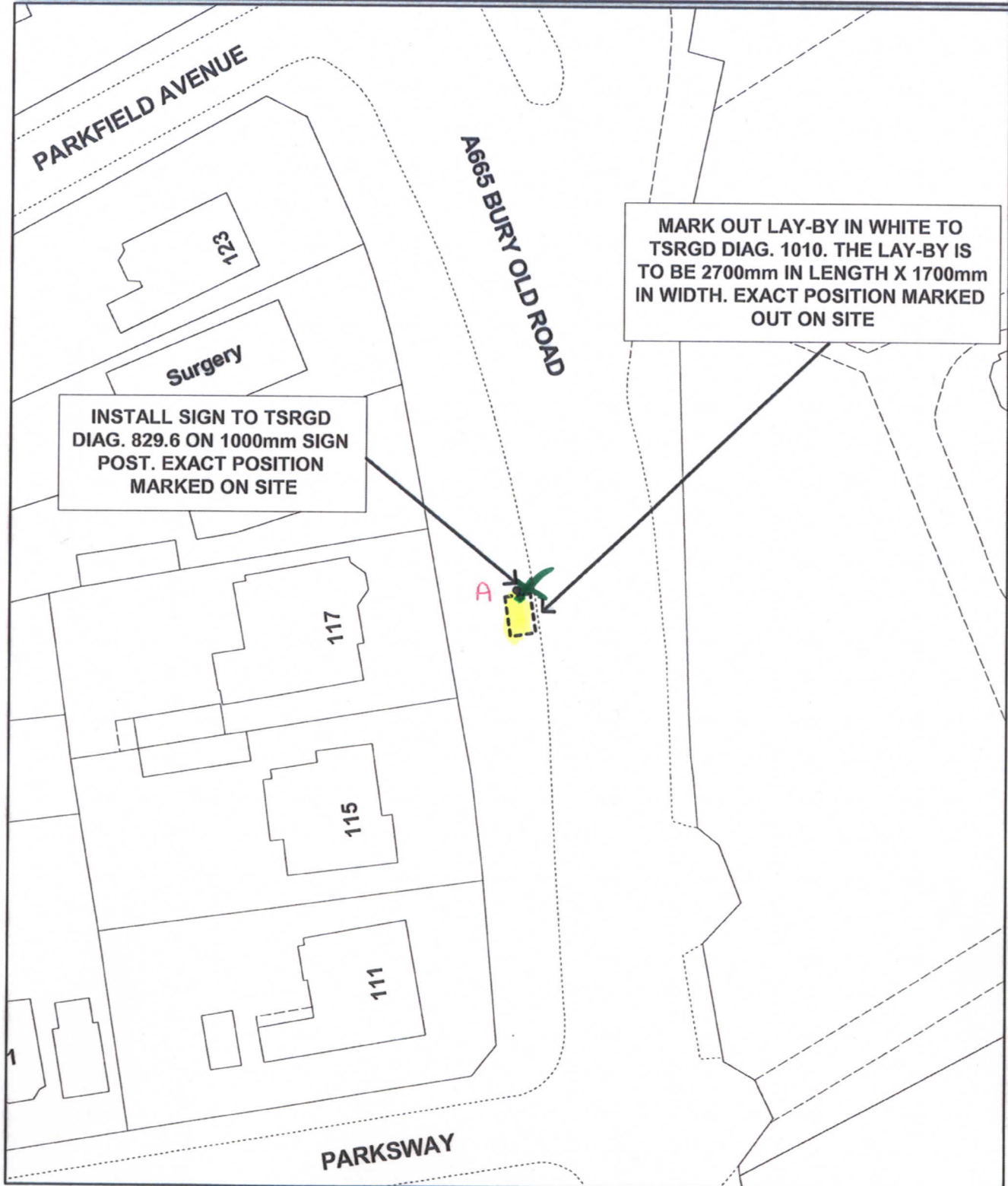

PLAN TS2202G
SCALE 1:500
DRAWN ECJ
DATE 13.09.10

Environment and Development Services
Operations Division
Traffic Management & Road Safety Services

3 Knowsley Place
Duke Street
Bury BL9 0EJ

Tel : 0161-253 7799
Fax : 0161-253 7963

Bury
COUNCIL