



GT50/139/0035

**ROAD TRAFFIC REGULATION ACT 1984 - SECTIONS 64 AND 65  
AUTHORISATION OF TRAFFIC SIGNS AND SPECIAL DIRECTIONS**

The Secretary of State for Transport, in exercise of his powers under Sections 64 and 65 of the Road Traffic Regulation Act 1984, and of all other powers enabling him in that behalf, for the purpose of assisting in the free flow of vehicular traffic at the junction of York Road, Juniper Drive and Petergate in the London Borough of Wandsworth, hereby:-

1. authorises the placing at or within the vicinity of the site shown on the attached plan numbered GT50/139/0035-1 of a traffic sign consisting of a road marking (hereinafter referred to as "the authorised marking") conforming as to size, colour and character with that shown in diagram 1044 in Schedule 6 to the Traffic Signs Regulations 2002 (Part I of SI 2002/3113, "the 2002 Regulations"), save that the overall size and shape of the authorised marking shall be as shown on the said plan; and
2. directs, without prejudice to any statutory provision to the like effect, that it is a condition of this authorisation that the placing of the authorised marking at or near the said site shall continue to have effect only until such day as may be appointed by one month's notice given by the Secretary of State in writing to the traffic authority for the removal or alteration of the authorised marking and on that day the said authorisation shall, without prejudice to the giving of any further authorisation or direction, cease to have effect.

Section 36 of the Road Traffic Act 1988 shall apply to the authorised marking as it applies to the marking shown in diagram 1044 in Schedule 6 to the 2002 Regulations.



GT50/139/0035

The provisions of Regulations 12 and 31 of the 2002 Regulations shall apply to the authorised marking in the same manner as they apply to the marking shown in diagram 1044 in Schedule 6 to those Regulations.

Dated.....*28 July*.....2011

Signed by authority of the Secretary of State

[Redacted Signature]

.....  
A Delegated Official of the Department for Transport

**CERTIFIED TRUE COPY**

[Redacted Stamp]

*28/7/2011*  
DEPARTMENT FOR TRANSPORT

# TRAFFIC SIGNS AND ROAD MARKINGS

See Inset A

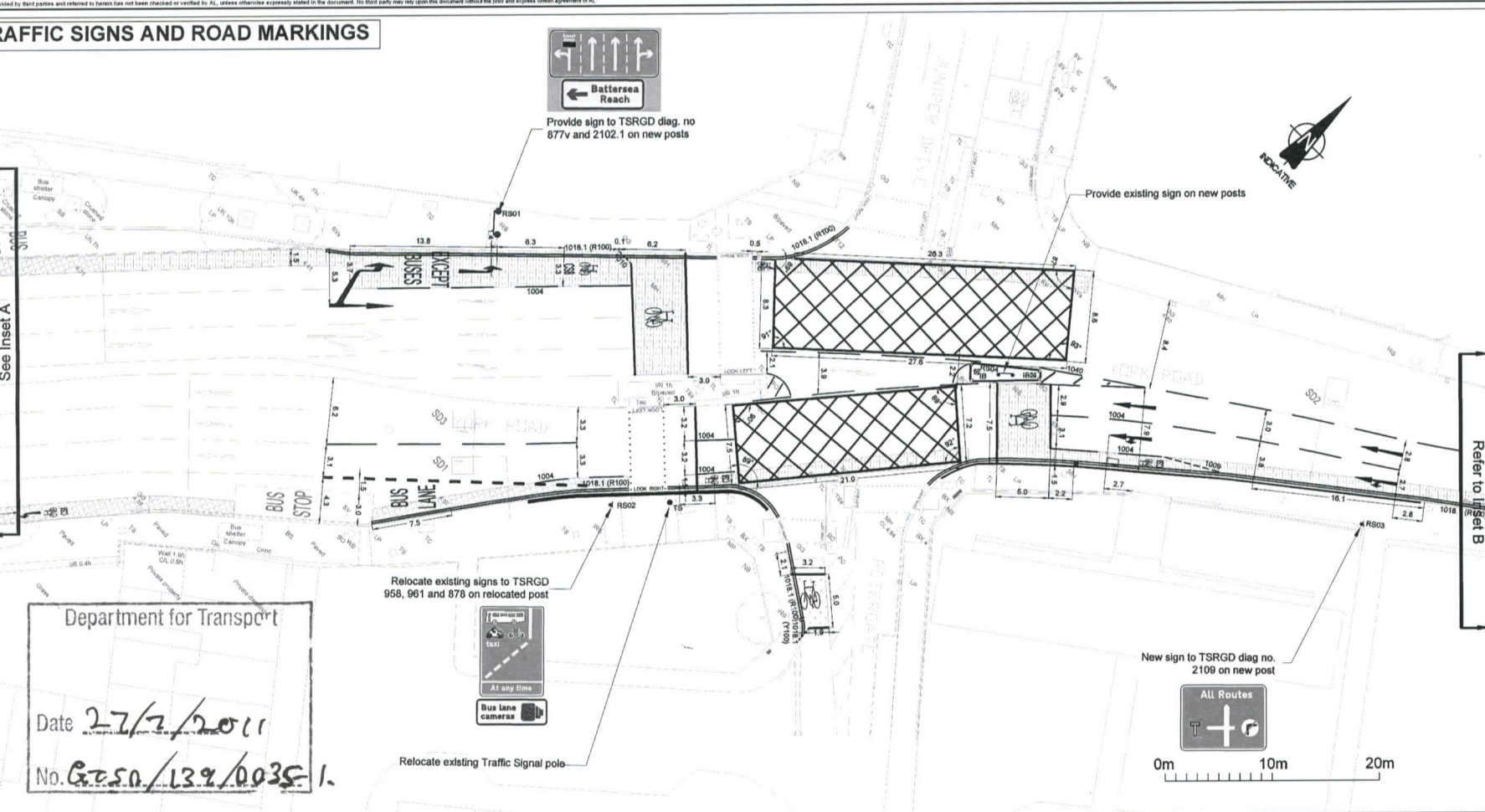

- NOTES**
- All details are to be checked on site by the Supervisor.
  - All new lines, signs and road markings are to be laid in accordance with 'The Traffic Signs Regulations and General Directions 2002' (TSRGD) and Cycle Superhighways Infrastructure Design Guidance.
  - All dimensions in metres unless otherwise stated.
  - Location of all signs indicative, subject to location of underground utility services. Revised locations to be agreed with Supervisor.
  - Contractor to be aware of hazards identified on the Residual Hazard Management Record and enforce all Health and Safety Regulations.
  - Drawing based on topographical survey provided by Land Survey Solutions Ltd dated April 2010.
  - All items shown in bold grey are existing and are to remain unless stated otherwise.
  - Temporary Traffic Management to be in accordance with Chapter 8 of the Traffic Signs Manual 2009 and relevant Codes of Practice.
  - For sign details refer to 60144895-CBS-CP8-05.
  - Make safe all redundant electrical connections.
  - All signs to be mounted at a height of 2.1m minimum, and have a minimum horizontal clearance to kerb face of 0.5m unless otherwise stated.
  - Road markings to be refreshed where the supervisor deems necessary.
  - Contractor to check all existing information prior to the commencement of the works. Any discrepancies are to be reported to the supervisor immediately.
  - Arrows (Diag. 1038) to be positioned as indicated, centrally in the appropriate lane.
  - Signs must be visible and not obstructed by trees, lamp columns, other signs etc.
  - Works around trees must adhere to BS5837 and NUG4 particularly with regard to treatment of roots and general tree protection. Ground levels must not be changed around trees.

## LINING AND SIGNING KEY

For details of road markings refer to Standard Detail diag no. 60144895-CBS-CP8-05

- ROAD MARKINGS IN GREY ARE TO BE RETAINED**
- Provide Cycle Superhighway Blue Surfacing - Carriageway Non-HFS
  - Provide Cycle Superhighway Blue Surfacing - Carriageway HFS (to be in to existing HFS extents)
  - Provide Green Surfacing - Carriageway HFS

- New / Relocated sign. Refer to sign schedule for details.
- 1018.1 TSRGD diagram number
- Cycle Superhighways Medium Logo as per 60144895-CBS-CP8-05/SD/008 1200/006
- New Road Markings
- New Kerline
- 'Keep Left' illuminated bollard with incorporated sign to TSRGD diag. no. 610. Use existing electrical connection

## FOR CONSTRUCTION

A		Revised Information Stage 1/2 RIA		REV	ASB	GLW
Rev	Date	Drawn	Check	Mark	Check	Sign
Client:						
<b>Construction Package 6</b> <b>Juniper Drive Junction</b> <b>Detailed Design</b> <b>Sheet 4 of 4</b>						
Design:	DR	CAD:	DR			
Chk'd:	GLW	App'd:	IB			
Date:	25/09/2010	Scale:	1:200 @ A1			
AECOM House 63-77 Victoria Street 16th Floor, Suite 1611 London, W1 1ER				Tel: +44 (0)1773 330000 Fax: +44 (0)1773 330000 www.aecom.com		
No. 60144895-CBS-CP8-05/SD/1200/004						A

