



GT50/122/0004

**ROAD TRAFFIC REGULATION ACT 1984 – SECTIONS 64 AND 65
AUTHORISATION OF TRAFFIC SIGNS AND SPECIAL DIRECTIONS**

The Secretary of State for Transport, in exercise of his powers under Sections 64 and 65 of the Road Traffic Regulation Act 1984, and of all other powers enabling him in that behalf, for the purpose of informing road users of contra-flow cycling in Wentworth Place and Cathcart Avenue, Plymouth, hereby:-

1. authorises the erection at or within 5 metres of the sites referenced "50" within a black circle in the attached set of plans numbered GT50/122/0004-1 of a traffic sign (hereinafter referred to as "the authorised sign") conforming as to size, colour and character with that shown on the attached drawing numbered NP 960.2; and
2. directs that, notwithstanding the provisions of Direction 21 of the Traffic Signs General Directions 2002 (Part II of SI 2002/3113, "the 2002 Directions"), a sign to diagram 616 in Schedule 2 to the Traffic Signs Regulations 2002 (Part I of SI 2002/3113) "the 2002 Regulations") may be used in combination with a plate to diagram 954.4 in Schedule 5 to those Regulations, within the vicinity of the sites marked with an orange cross on the said plan; and
3. directs that, notwithstanding the provisions of Direction 18 of the Traffic Signs General Directions 2002 (Part II of SI 2002/3113), the authorised sign may be used in conjunction with the road marking shown in diagram 1057 in Schedule 6 to the Traffic Signs Regulations 2002 (Part I of SI 2002/3113, "the 2002 Regulations"); and



GT50/122/0004

4. directs that it is a condition of this authorisation that the authorised sign may be placed only to indicate the effect of a corresponding Traffic Regulation Order; and
5. directs, without prejudice to any statutory provision to the like effect, that it is a condition of this authorisation that the erection of the authorised sign at or near the said sites shall continue to have effect only until such day as may be appointed by one month's notice given by the Secretary of State in writing to the traffic authority for the removal or alteration of the authorised sign and on that day the said authorisation shall, without prejudice to the giving of any further authorisation or direction, cease to have effect.

The provisions of Regulations 12, 18 and 19 of the 2002 Regulations shall apply to the authorised sign in the same manner as they apply to the sign shown in diagram 960.1 in Schedule 5 to those Regulations.

Dated 1 July 2011

Signed by authority of the Secretary of State

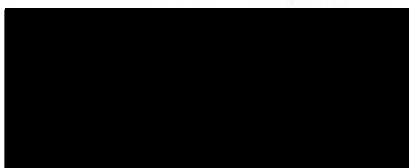

.....
A Delegated Official of the Department for Transport



- © CROWN COPYRIGHT. This drawing must NOT be reproduced.
- NOTES:—
- Details of the cycle symbol are on dwg. S 24.
 - The outline of the tile does not form part of the sign.
 - COLOURS:— BS.873:Part 6
Symbol, Border
and Arrows ----- WHITE
Background ----- BLUE
 - Dimensions are shown in stroke widths (one quarter of notional x-heights). The Table of Sign Sizes shows the actual sign sizes in millimetres.

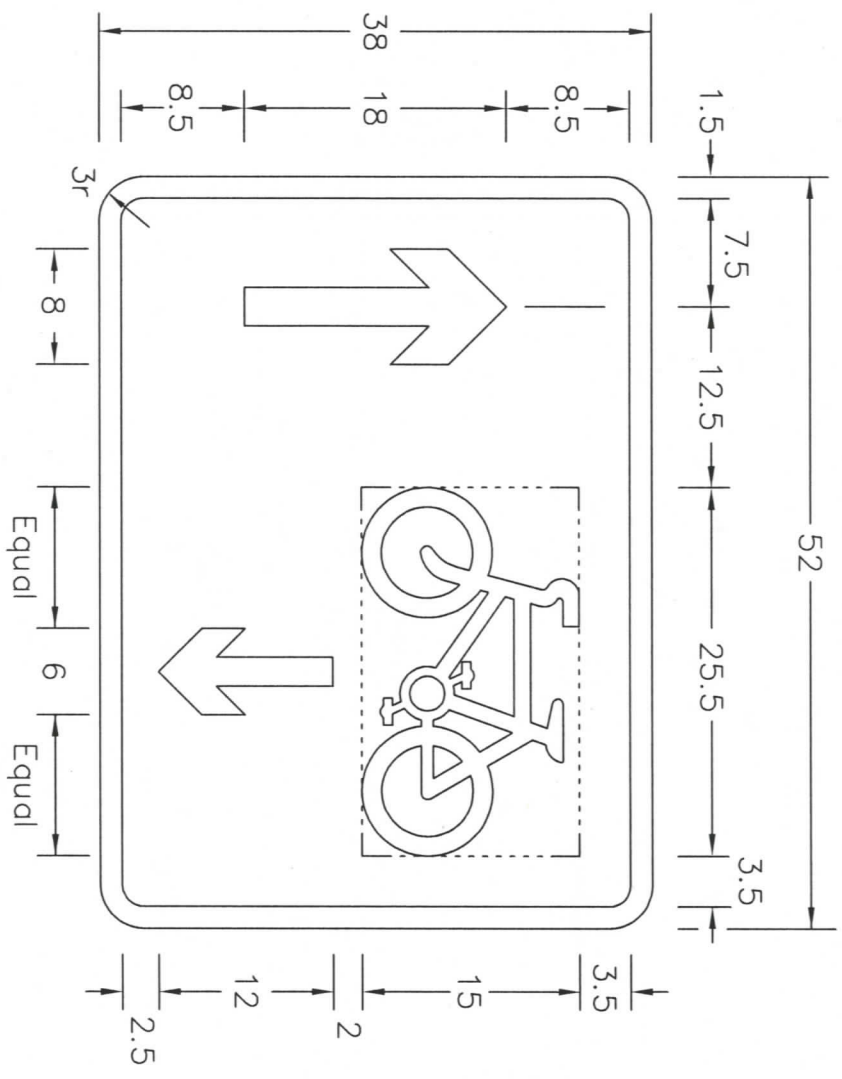
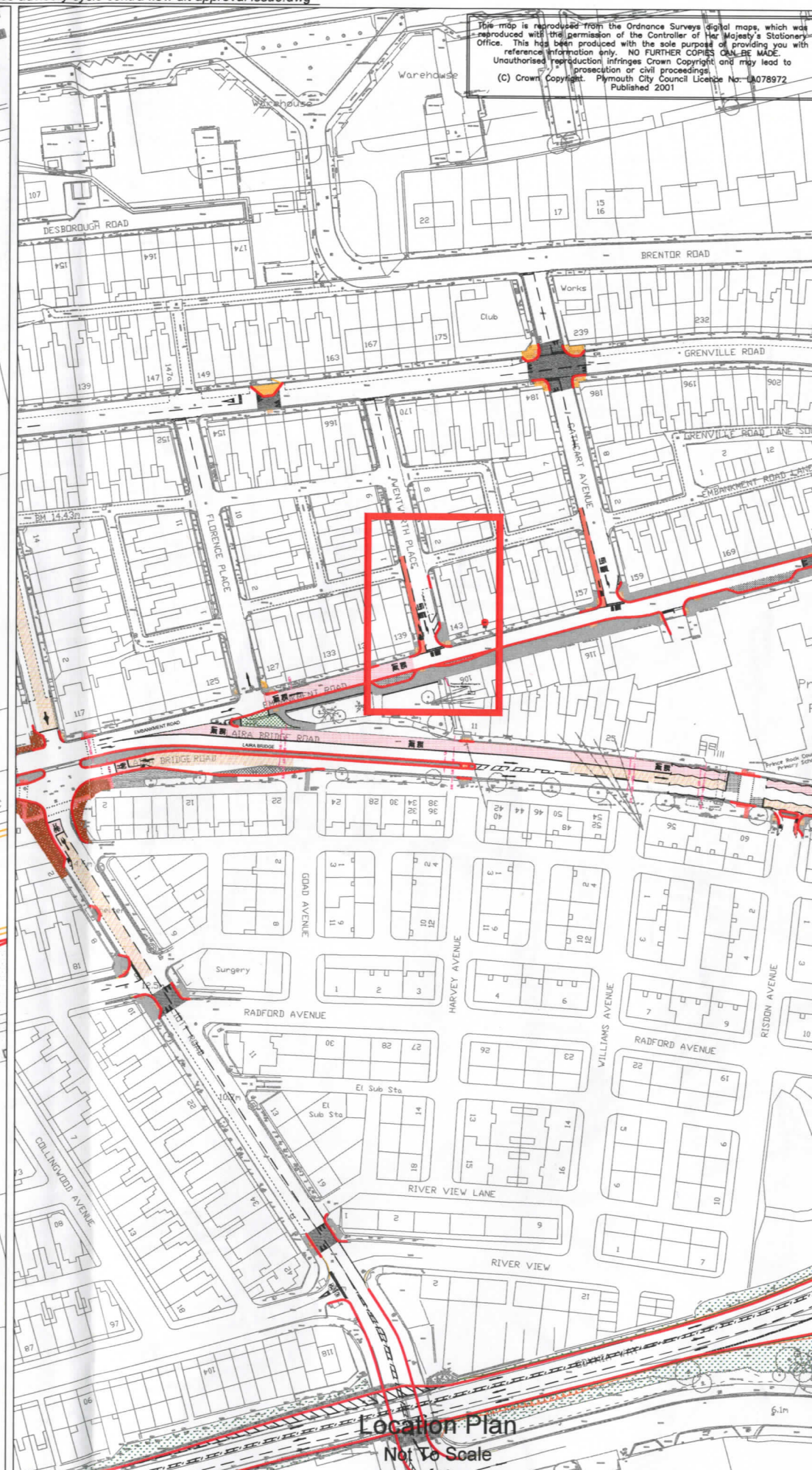
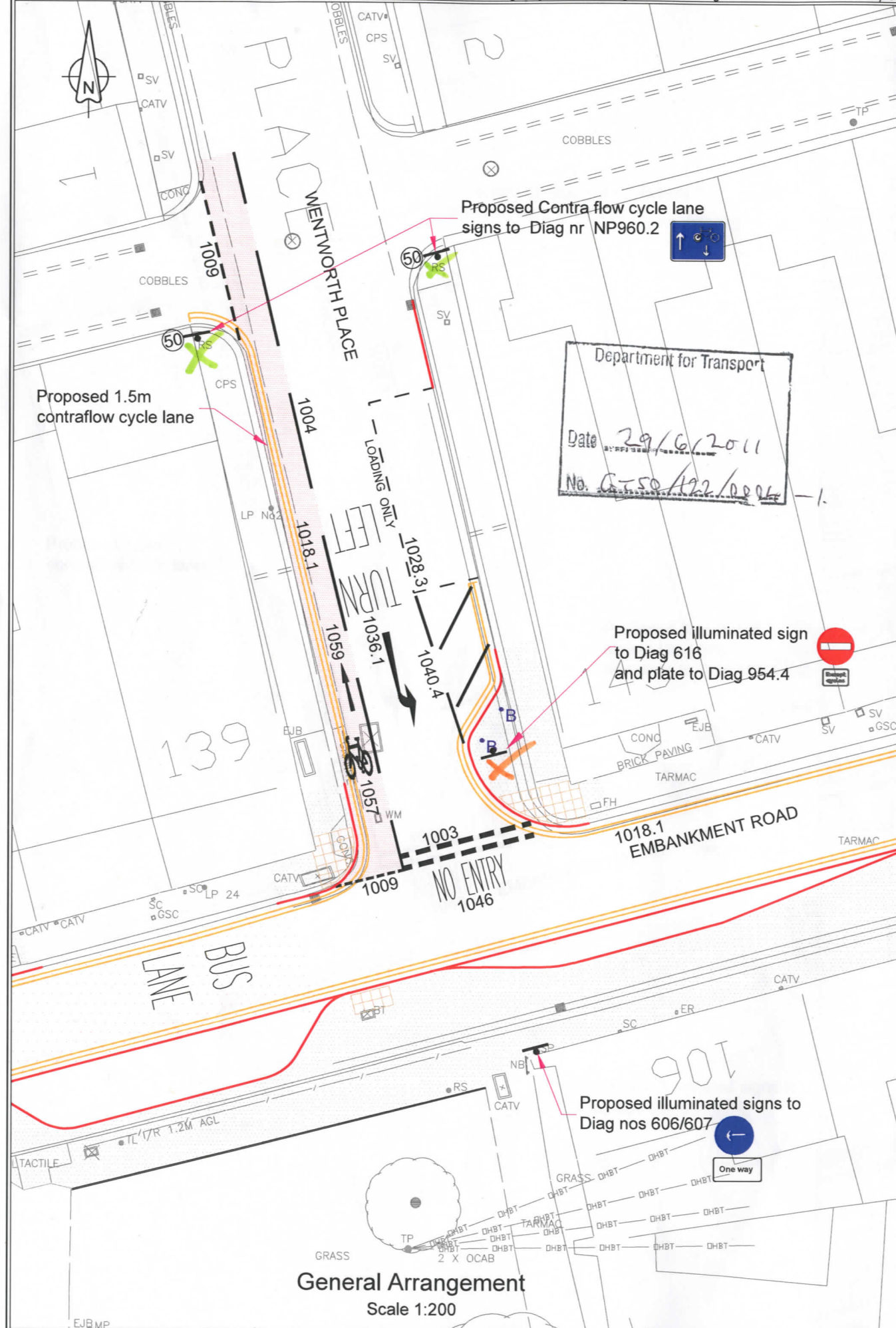

TABLE OF SIGN SIZES (mm)		
Stroke Widths	12.5	15
Width of Sign	650	780
Height of Sign	475	570

NP960x2

Before using this drawing, confirm that it has not been superseded.

















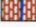

NOTES

1. This drawing supersedes all previous issues of cycle contra flow information for Wentworth Place.
2. For full scheme signage details please refer to drawings 409822-CON-1200-002
3. For full scheme road marking details please refer to drawings 409822-CON-1200-001

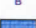
KEY:

Existing:	 Earthworks
Survey and OSmap	 Retaining wall
Safety barrier	 Alterations to bridge
Road gully	 Safety fence
Kerbing	 Kerbing
White road markings	 Fencing
Yellow road markings	 White road markings
	 Yellow road markings

	Carriageway - full construction (refer to specification)
	Carriageway - concrete finish (SD7.7 and 7.8)
	Carriageway - macadam surfacing (SD7.17)
	Carriageway - Plain off w/c regulate and replace
	Footway - surface type F1 (SD11.19)
	Footway - granite flags (SD11.5)
	600x400x70mm flame textured finish laid in random mix of the following 3 colours: silver grey (G603) 40%, mid grey (G645) 30% and light pink grey (G663) 30% in breaking joint.
	Drainage - Surface water channel reused
	Footway - concrete finish
	Footway - to match existing adjacent surface finish (refer to relevant standard details)
	Footway - buff ribbed (round top) tactile paving
	Footway - buff blister tactile paving (SD11.52)
	Footway - red blister tactile paving (SD11.53)
	Proposed bollard (type to be specified)
	Pedestrian deterrent paving (SD11.25)
	Red surfacing for buses (refer to specification)
	Proposed new signs to be authorised, (Ref. Diag nr NP960.2)

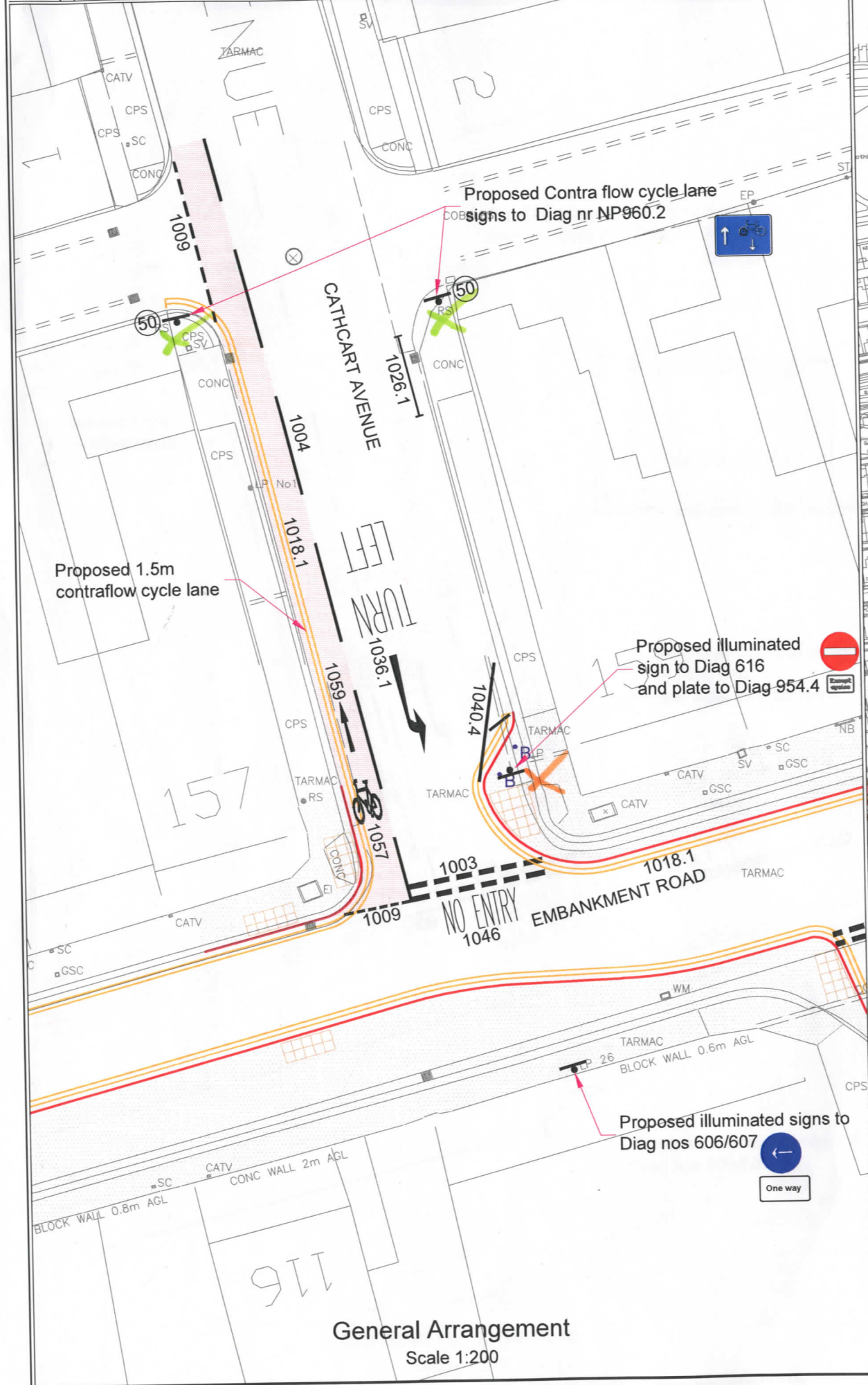

NOTES

- This drawing supersedes all previous issues of cycle contra flow information for Cathcart Avenue.
- For full scheme signage details please refer to drawings 409822-CON-1200-002
- For full scheme road marking details please refer to drawings 409822-CON-1200-001

KEY:

Existing	Proposed
Survey and OS map	Earthworks
Safety barrier	Retaining wall
Road gully	Alterations to bridge
Kerbing	Safety fence
White road markings	Fencing
Yellow road markings	White road markings
	Yellow road markings

Carriageway - full construction (refer to specification)
Carriageway - concrete finish (SD7.7 and 7.8)
Carriageway - macadam surfacing (SD7.17)
Carriageway - Plain off w/c regulate and replace
Footway - surface type F1 (SD11.19)
Footway - granite flags (SD11.5)
600x400x70mm flame textured finish laid in random mix of the following 3 colours; silver grey (G603) 40%, mid grey (G645) 30% and light pink grey (G663) 30% in breaking joint.
Drainage - Surface water channel used
Footway - concrete finish
Footway - to match existing adjacent surface finish (refer to relevant standard details)
Footway - buff ribbed (round top) tactile paving
Footway - buff blister tactile paving (SD11.52)
Footway - red blister tactile paving (SD11.53)
Proposed bollard (type to be specified)
Pedestrian deterrent paving (SD11.25)
Red surfacing for buses (refer to specification)

Proposed new signs to be authorised.
(Ref. Diag nr NP960.2)

E	Amendments to relevant prescribed signing.	KLI	ADC	24.05.11
D	Amended following safety audit comments 12.04.11	KLI	ADC	05.05.11
C	S/E info removed, various road marking details added, notes amended.	KLI	ADC	05.04.11
B	Setting out information added.	ADC	ADC	21.03.11
A	Initial Issue	ADC	ADC	02.03.11
Rev	Revision details	Chkd	Appd	Date

Drawn: NA/BM	Preliminary
Design: NA	For comment
Chkd: ADC	For tender
Appd: ADC	For construction
Date: 02.03.2011	As constructed
	Other

Civic Centre | Royal Parade | Plymouth | PL1 2AA
Public Helpdesk 01752 658000

Project Name
EAST END TRANSPORT SCHEME

Drawing Title
HIGHWAYS
CATHCART AVENUE
ADVISORY CYCLE CONTRA-FLOW
DFT APPROVAL ISSUE

Original Drawing Size : A3
Scale : As Shown Dimensions : M
Drawing No : 409822-SK035
Rev : E