



GT50/082/0005

**ROAD TRAFFIC REGULATION ACT 1984 – SECTIONS 64 AND 65
AUTHORISATION OF TRAFFIC SIGNS AND SPECIAL DIRECTIONS**

The Secretary of State for Transport, in exercise of his powers under Sections 64 and 65 of the Road Traffic Regulation Act 1984 and of all other powers enabling him in that behalf, for the purpose of indicating parking places for disabled persons on roads for which the London Borough of Haringey is the traffic authority, hereby:-

1. authorises the placing at the locations shown in the attached set of plans numbered GT50/082/0005-1 of a traffic sign consisting of a road marking (hereinafter referred to as "the authorised marking") conforming as to size, colour and character with that to diagram 1028.3 in the Traffic Signs Regulations 2002 (Part I of SI 2002/3113, "the 2002 Regulations") save that the length of the bays shall be as shown in the said set of plans; and
2. directs that, notwithstanding the provisions of Direction 24(1) of the Traffic Signs General Directions 2002 (Part II of SI 2002/3113), the authorised marking shall only be used with the sign to diagram 661A in Schedule 2 to the 2002 Regulations; and
3. directs that it is a condition of this authorisation that the authorised marking may be placed only to indicate the effect of a corresponding Traffic Order; and



GT50/082/0005

4. directs, without prejudice to any statutory provision to the like effect, that it is a condition of this authorisation that the placing of the authorised marking on the said roads shall continue to have effect only until such day as may be appointed by one month's notice given by the Secretary of State in writing to the traffic authority for the removal or alteration of the authorised marking and on that day the said authorisation shall, without prejudice to the giving of any further authorisation or direction, cease to have effect.

The provisions of Regulations 12 and 31 of the 2002 Regulations shall apply to the authorised marking in the same manner as they apply to the road marking to diagram 1028.3 in Schedule 6 to those Regulations.

Dated 5 September 2011

Signed by authority of the Secretary of State

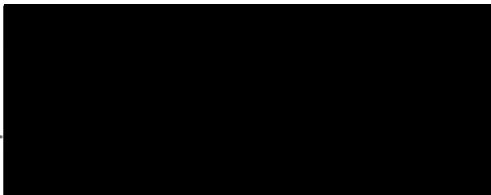

A Delegated Official of the Department for Transport

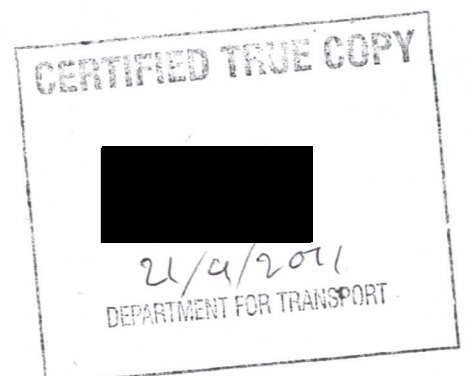

This product includes mapping data licensed from Ordnance Survey with the permission of HMSC © Crown Copyright. LBN 2011. All rights reserved.
License number: 100019199.

NOTES:

- KEY:
- Proposed double yellow lines.
 - Existing disabled bays.
 - Existing lamp column.
 - Existing post and sign.
 - Proposed disabled bay.

Department for Transport

Date 5/9/2011

No. 6750/032/005

Project	Client	Contract	Drawn	Check

WAITING RESTRICTIONS
BATCH 5

CAMBRIDGE GARDENS, N17

FRONTLINE SERVICES
TRANSPORT POLICY & PROJECTS

HC/ST/PPM/LR B5 - 005

APRIL 2011

NTS@A3

1

1

1

1

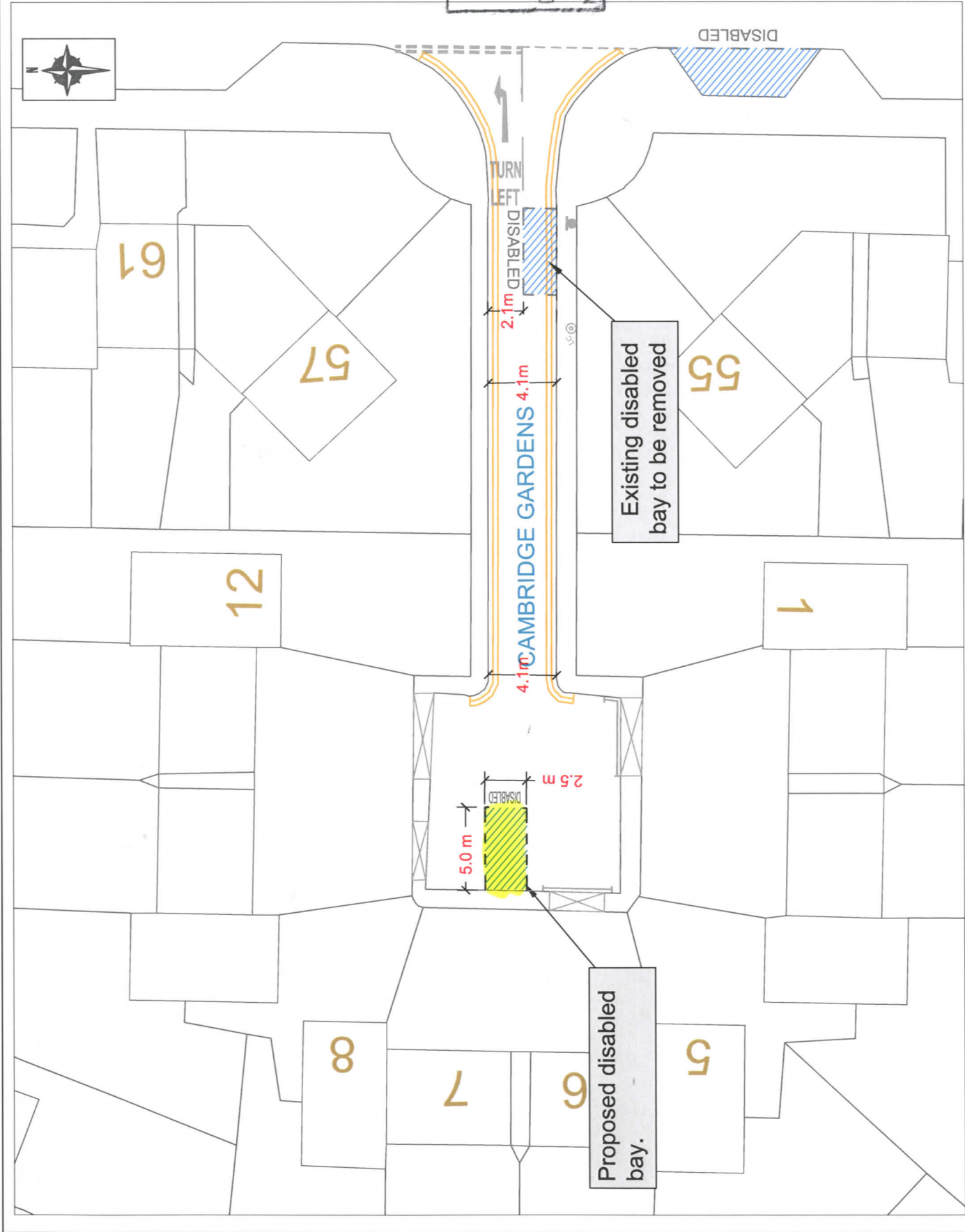

Section: Highways, Street Scene

Date: 14/04/2011

Scale: 1:500

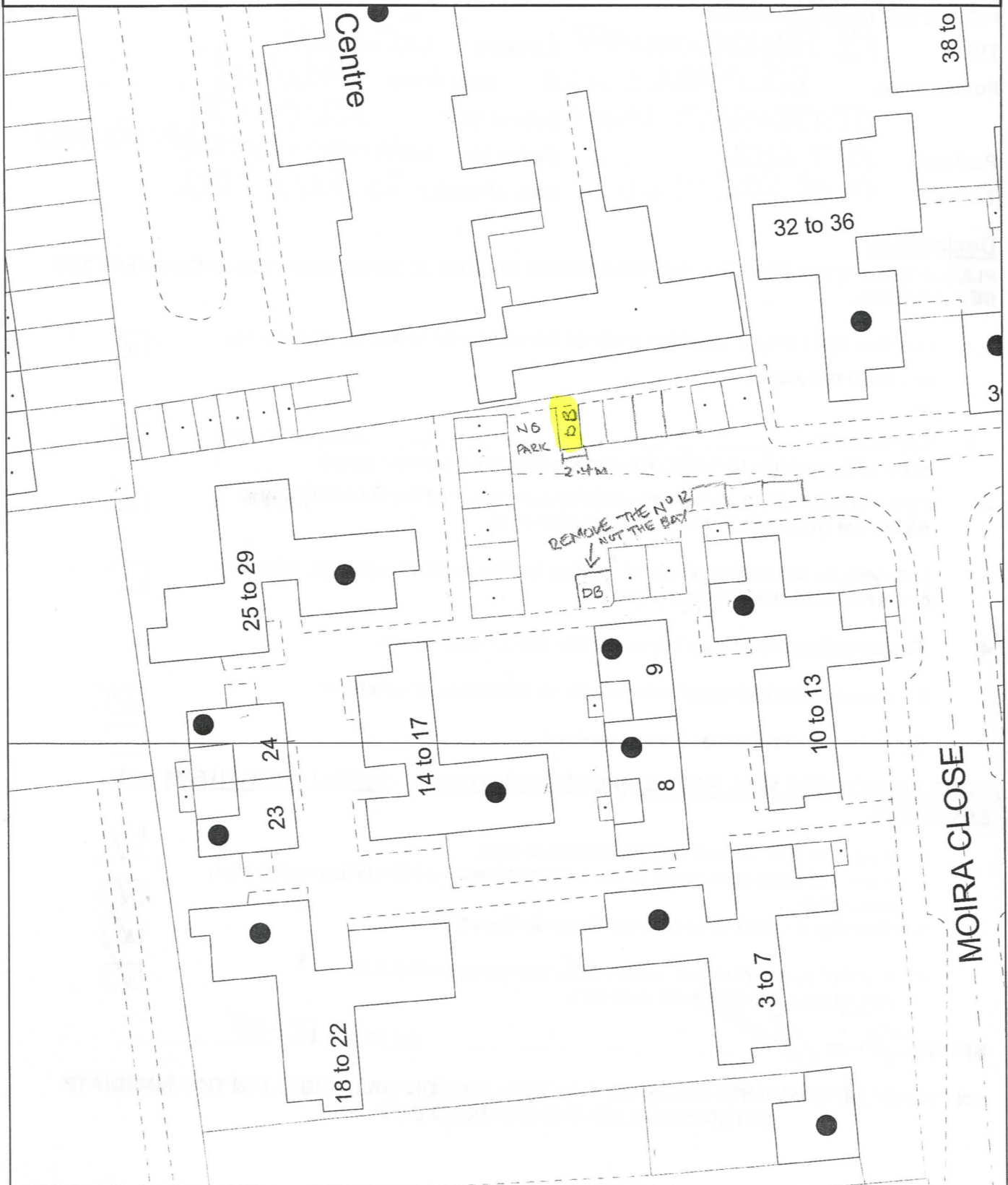

Location: 25 MOIRA CLOSE N17

Based upon the Ordnance Survey map with the permission of the Controller of Her Majesty's Stationery Office
Crown copyright reserved. Licence No. 100019199 2007

Section: Highways, Street Scene

Date: 01/06/2011

Scale: 1:500



Location: 1 Allison Road N8

Based upon the Ordnance Survey map with the permission of the Controller of Her Majesty's Stationery Office
Crown copyright reserved. Licence No. 100019199 2007

Section: Highways, Street Scene

Date: 14/04/2011

Scale: 1:500



Location: 78 BARRINGTON ROAD N8

Based upon the Ordnance Survey map with the permission of the Controller of Her Majesty's Stationery Office
Crown copyright reserved. Licence No. 100019199 2007

Section: Highways, Street Scene

Date: 14/04/2011

Scale: 1:500

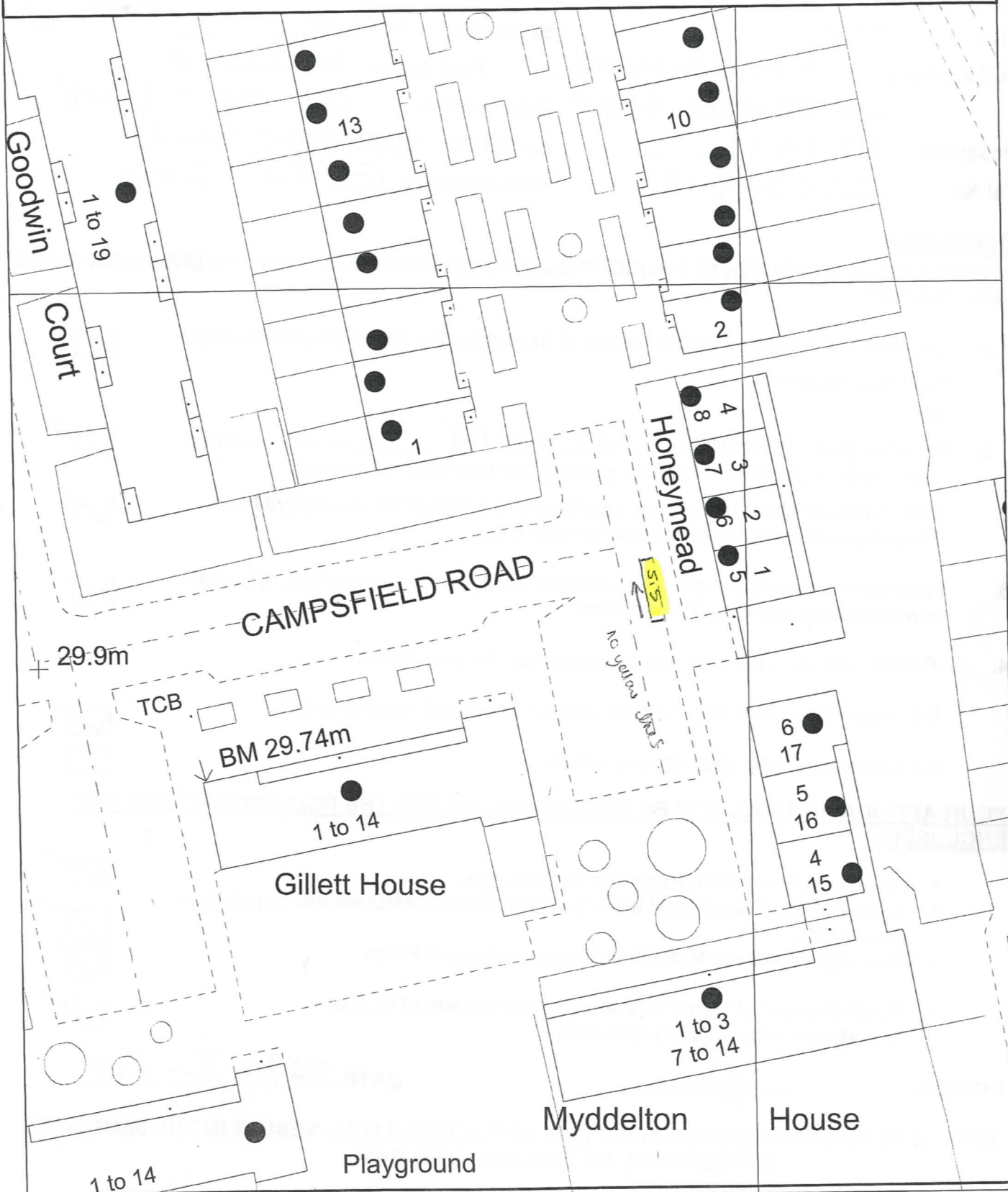

Location: 3 HONEYMEAD, CAMPSFIELD ROAD N8

Based upon the Ordnance Survey map with the permission of the Controller of Her Majesty's Stationery Office
Crown copyright reserved. Licence No. 100019199 2007

Section: Highways, Street Scene

Date: 14/04/2011

Scale: 1:500



Location: 40 CHURCH CRESCENT N10

Based upon the Ordnance Survey map with the permission of the Controller of Her Majesty's Stationery Office
Crown copyright reserved. Licence No. 100019199 2007

Section: Highways, Street Scene

Date: 14/04/2011

Scale: 1:500

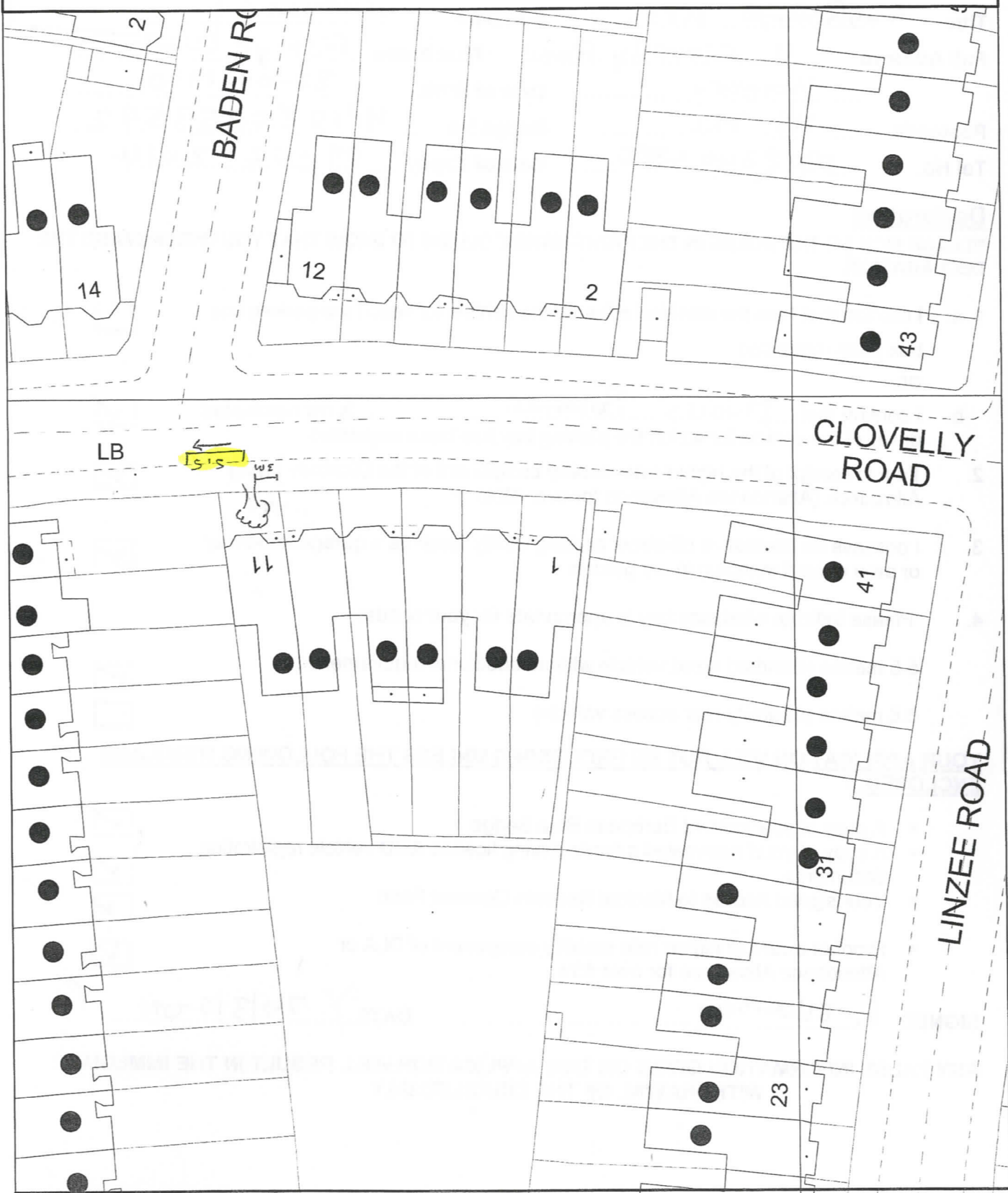

Location: 11 CLOVELLY ROAD N8

Based upon the Ordnance Survey map with the permission of the Controller of Her Majesty's Stationery Office
Crown copyright reserved. Licence No. 100019199 2007

Section: Highways, Street Scene

Date: 14/04/2011

Scale: 1:500

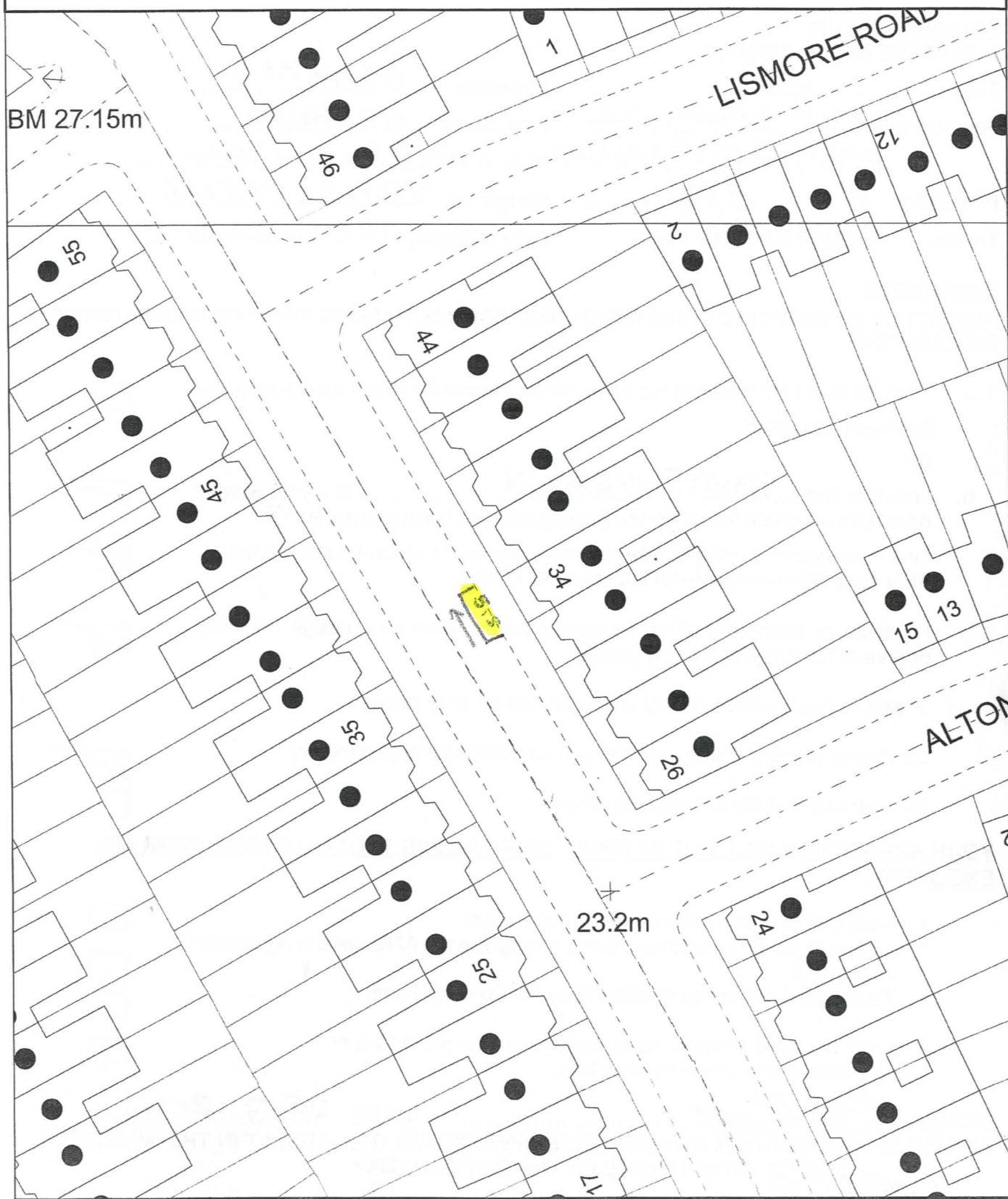

Location: 34B DOWNHILLS PARK ROAD N17

Based upon the Ordnance Survey map with the permission of the Controller of Her Majesty's Stationery Office
Crown copyright reserved. Licence No. 100019199 2007

Section: Highways, Street Scene

Date: 27/05/2011

Scale: 1:500

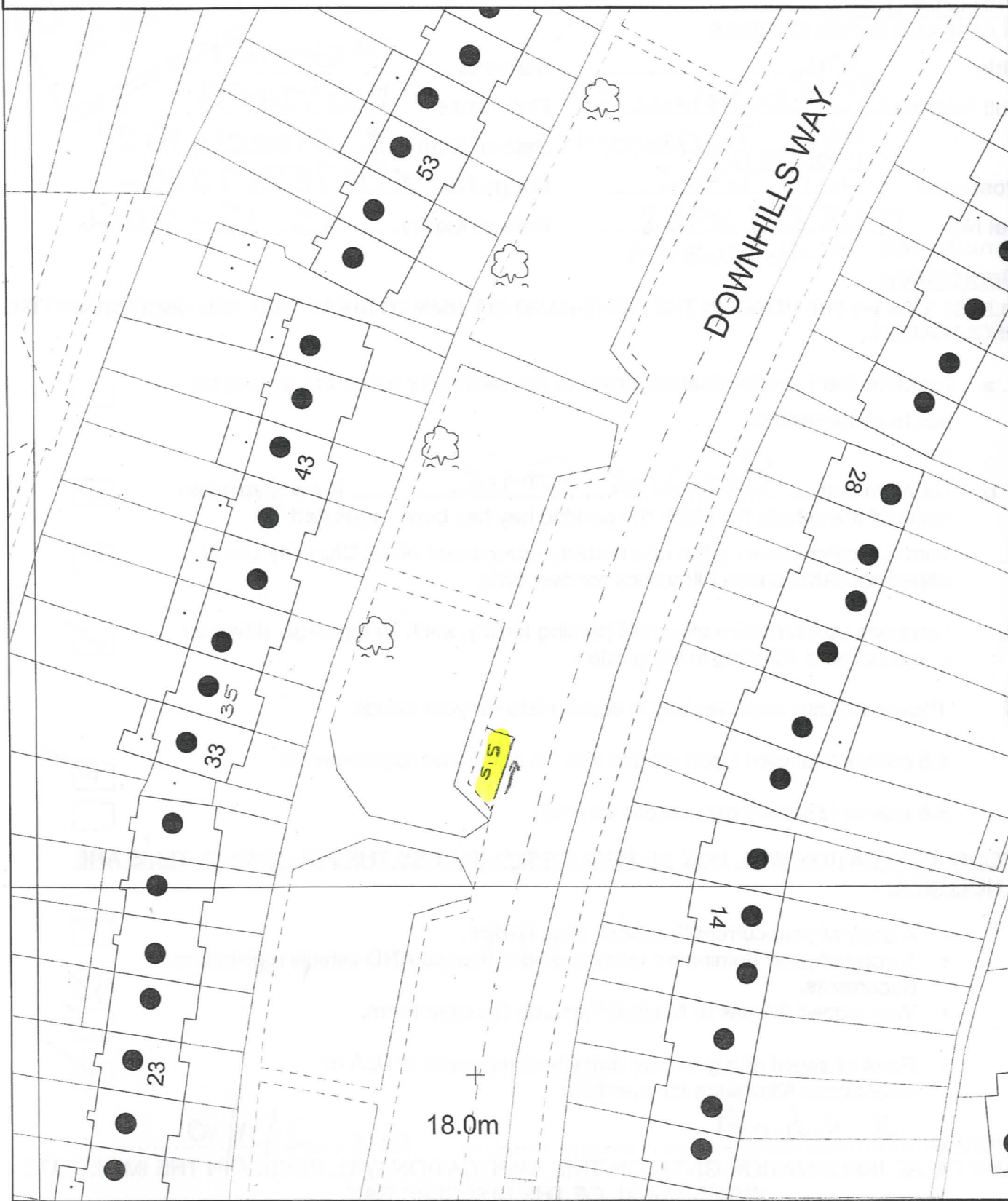

Location: 35 Downhills Way N17

Based upon the Ordnance Survey map with the permission of the Controller of Her Majesty's Stationery Office
Crown copyright reserved. Licence No. 100019199 2007

Scale: 1:500

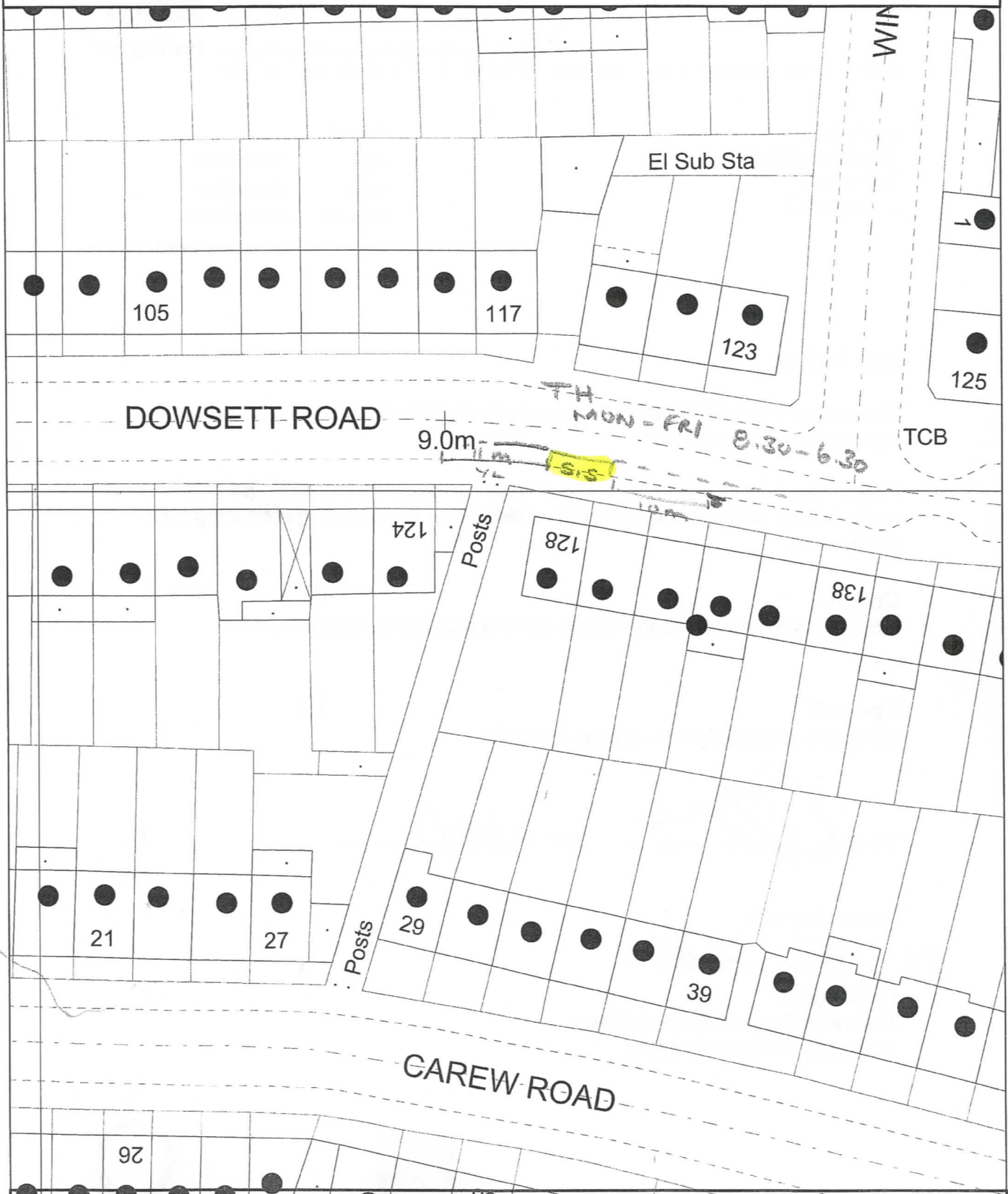

Location: 128 DOWSETT ROAD N17

Based upon the Ordnance Survey map with the permission of the Controller of Her Majesty's Stationery Office
Crown copyright reserved. Licence No. 100019199 2007

Section: Highways, Street Scene

Date: 14/04/2011

Scale: 1:500

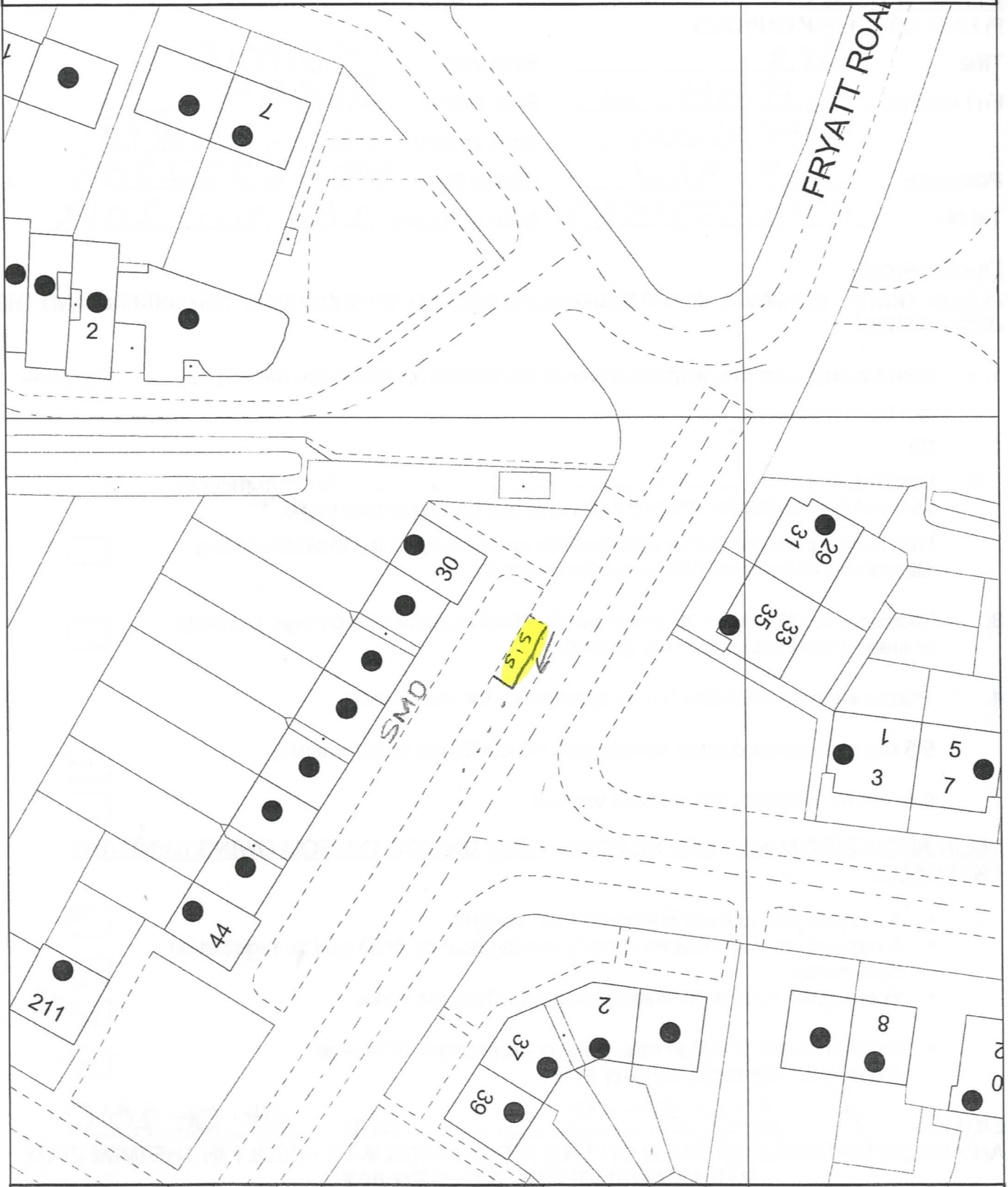

Location: 30 FRYATT ROAD N17

Based upon the Ordnance Survey map with the permission of the Controller of Her Majesty's Stationery Office
Crown copyright reserved. Licence No. 100019199 2007

On Footway?

Section: Highways, Street Scene

Date: 14/04/2011

Scale: 1:500

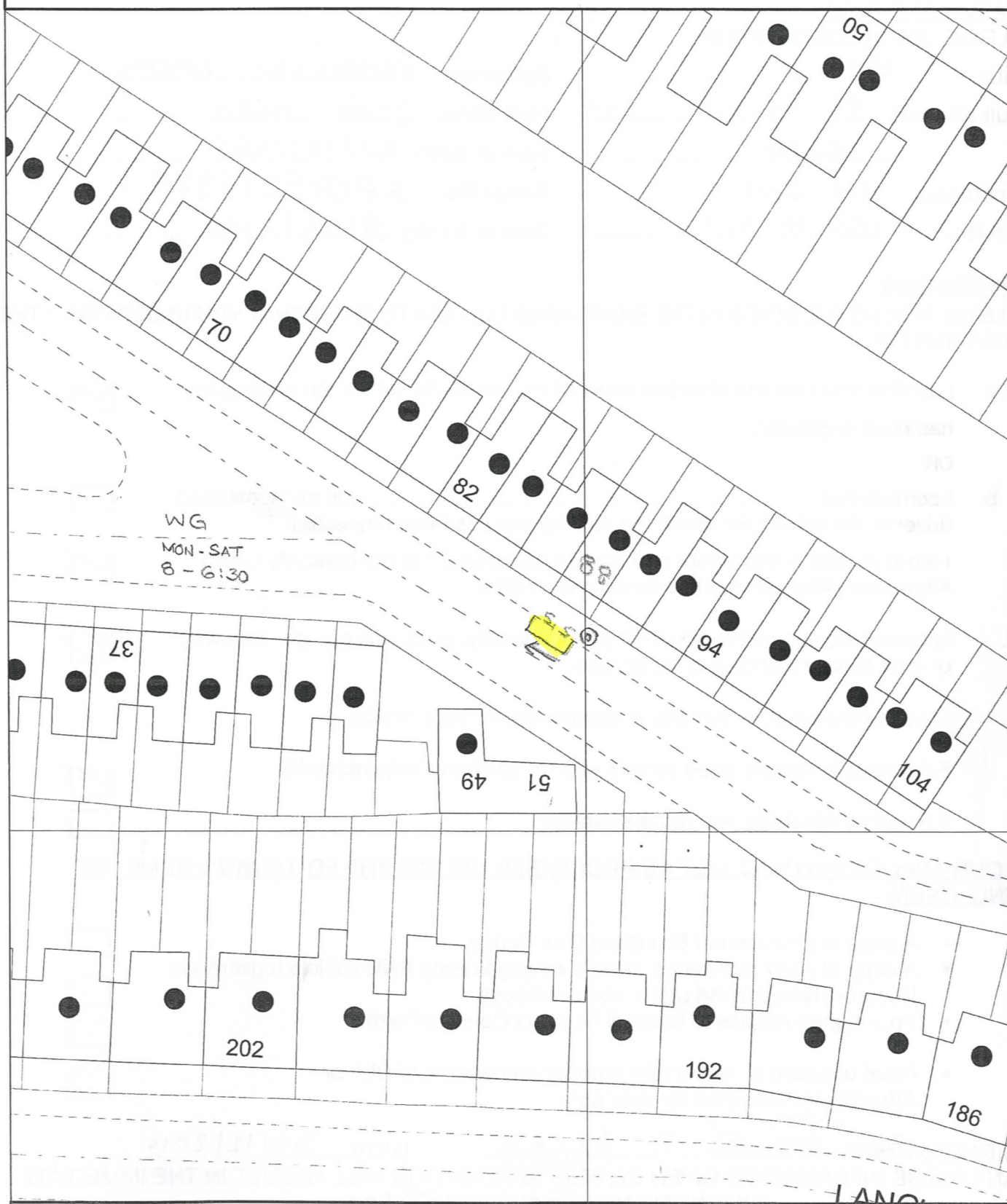

Location: 88 GRAHAM ROAD N15

Based upon the Ordnance Survey map with the permission of the Controller of Her Majesty's Stationery Office
Crown copyright reserved. Licence No. 100019199 2007

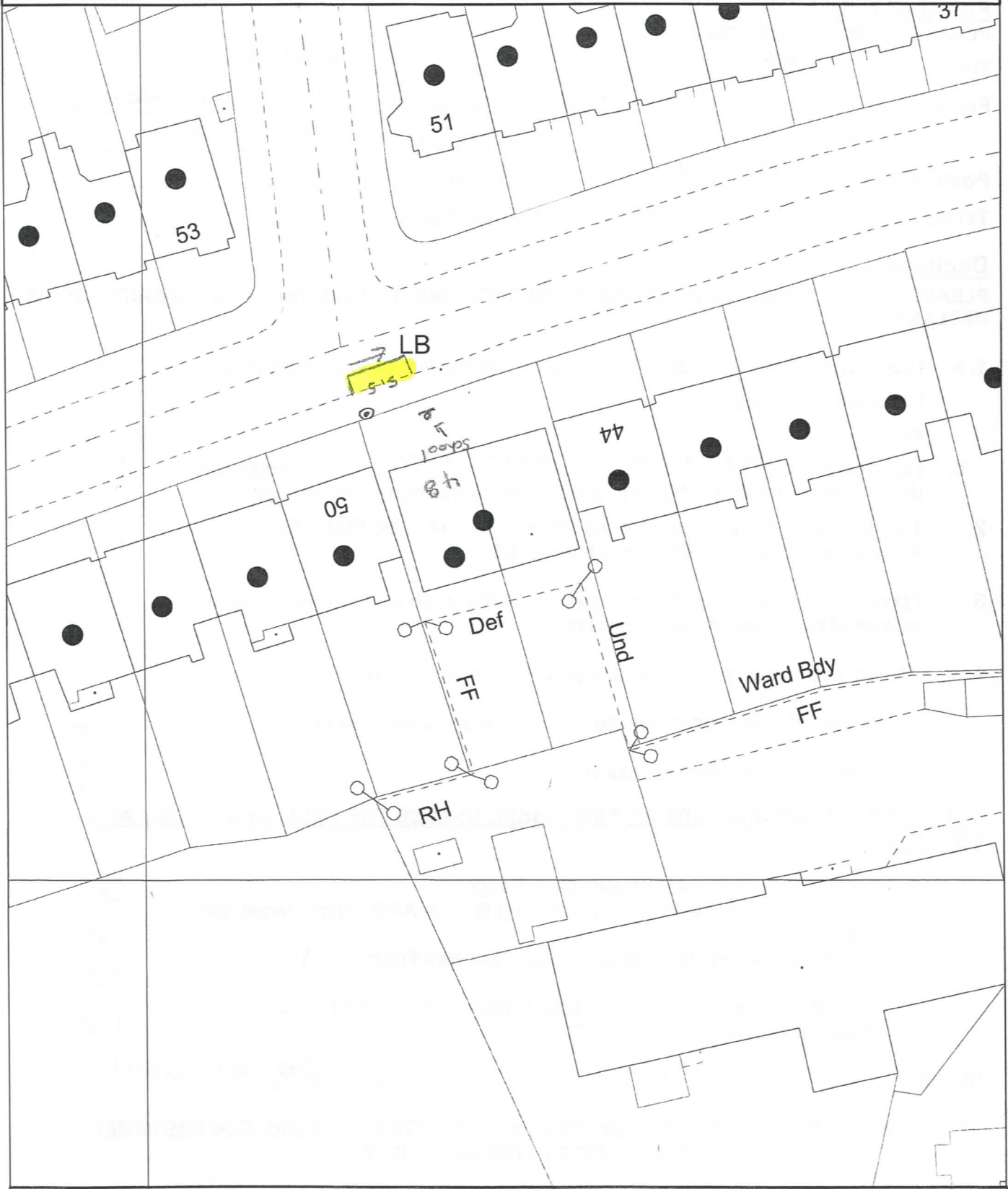

Based upon the Ordnance Survey map with the permission of the Controller of Her Majesty's Stationery Office
Crown copyright reserved. Licence No. 100019199 2007

Section: Highways, Street Scene

Date: 14/04/2011

Scale: 1:500

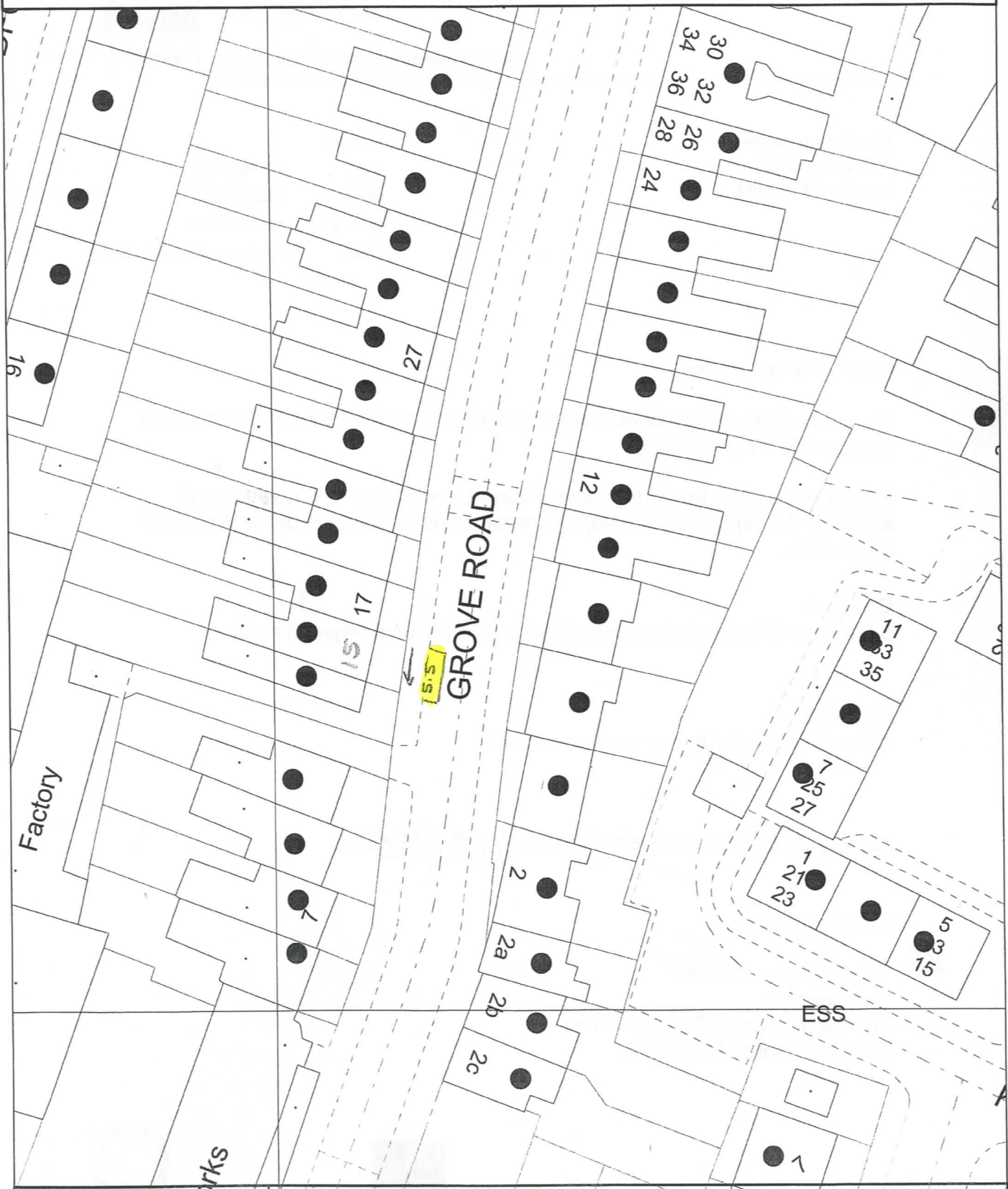

Location: 15 GROVE ROAD N15

Based upon the Ordnance Survey map with the permission of the Controller of Her Majesty's Stationery Office
Crown copyright reserved. Licence No. 100019199 2007

Section: Highways, Street Scene

Date: 14/04/2011

Scale: 1:500

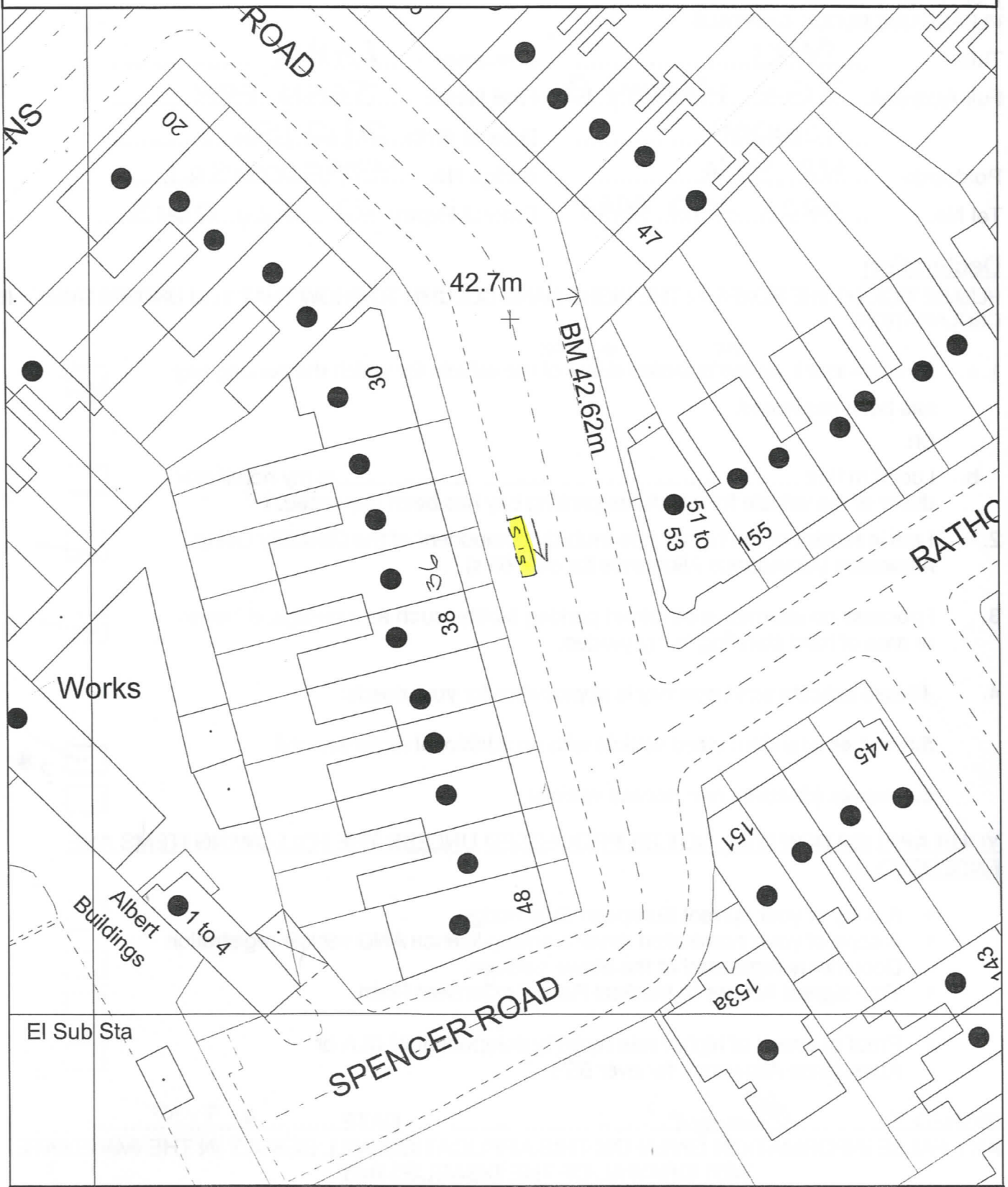

Location: 36A HARVEY ROAD N8

Based upon the Ordnance Survey map with the permission of the Controller of Her Majesty's Stationery Office
Crown copyright reserved. Licence No. 100019199 2007

Section: Highways, Street Scene

Date: 14/04/2011

Scale: 1:500



Location: 60 Langdon Park Road N6

Based upon the Ordnance Survey map with the permission of the Controller of Her Majesty's Stationery Office
Crown copyright reserved. Licence No. 100019199 2007

Section: Highways, Street Scene

Date: 14/04/2011

Scale: 1:500



Location: 19 LAURADALE ROAD N2

Based upon the Ordnance Survey map with the permission of the Controller of Her Majesty's Stationery Office
Crown copyright reserved. Licence No. 100019199 2007

Section: Highways, Street Scene

Date: 14/04/2011

Scale: 1:500

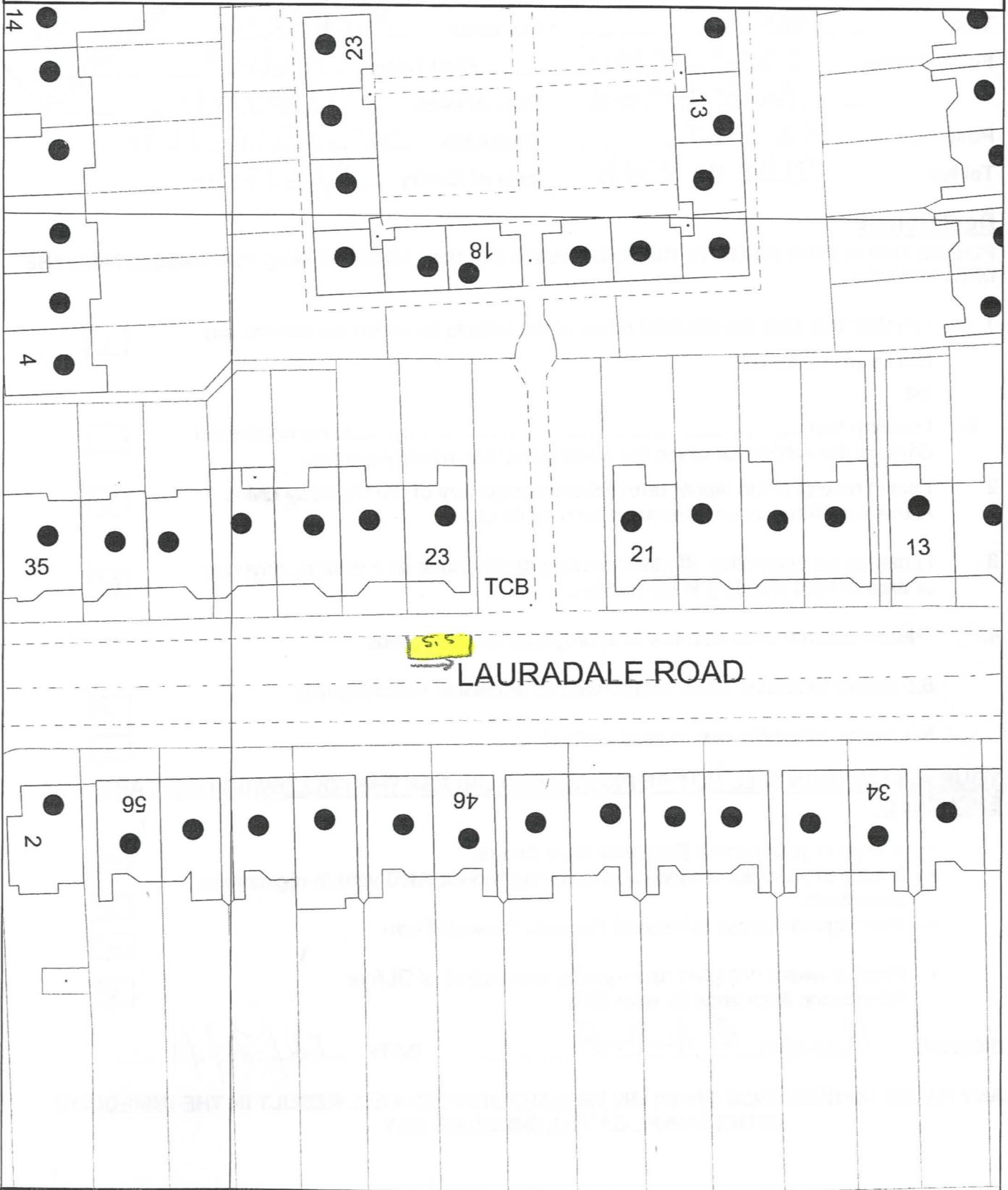

Location: 23 LAURADALE ROAD N2

Based upon the Ordnance Survey map with the permission of the Controller of Her Majesty's Stationery Office
Crown copyright reserved. Licence No. 100019199 2007

Section: Highways, Street Scene

Date: 04/05/2011

Scale: 1:500

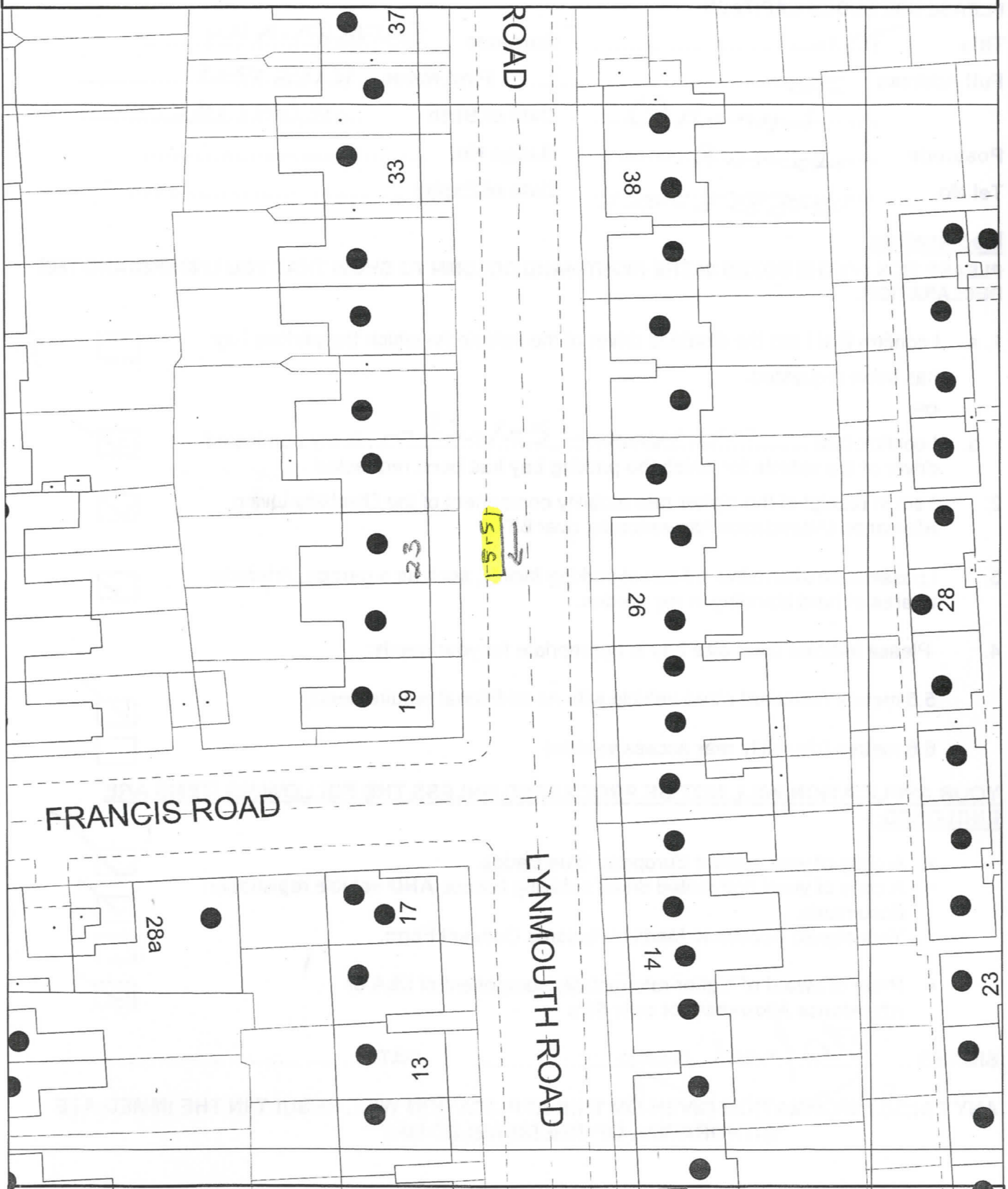

Location: 23 Lynmouth Road N2

Based upon the Ordnance Survey map with the permission of the Controller of Her Majesty's Stationery Office
Crown copyright reserved. Licence No. 100019199 2007

Section: Highways, Street Scene

Date: 14/04/2011

Scale: 1:500

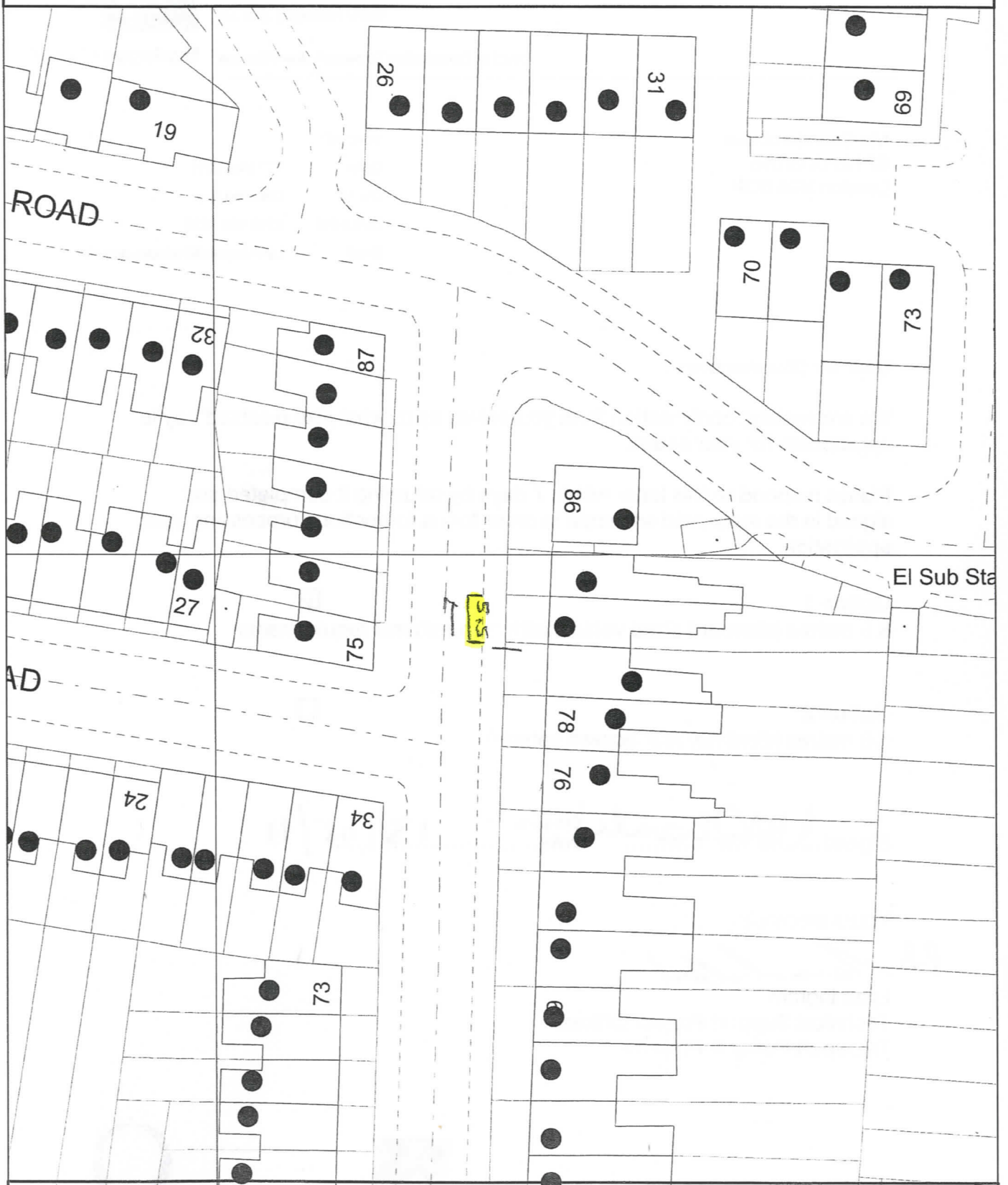

Location: 82 NORTH GROVE N15

Based upon the Ordnance Survey map with the permission of the Controller of Her Majesty's Stationery Office
Crown copyright reserved. Licence No. 100019199 2007



Location: 121A NORTH VIEW ROAD N8

Based upon the Ordnance Survey map with the permission of the Controller of Her Majesty's Stationery Office
Crown copyright reserved. Licence No. 100019199 2007

Section: Highways, Street Scene

Date: 14/04/2011

Scale: 1:500



Location: 5 PRINCES AVENUE N22

Based upon the Ordnance Survey map with the permission of the Controller of Her Majesty's Stationery Office
Crown copyright reserved. Licence No. 100019199 2007

Section: Highways, Street Scene

Date: 14/04/2011

Scale: 1:500

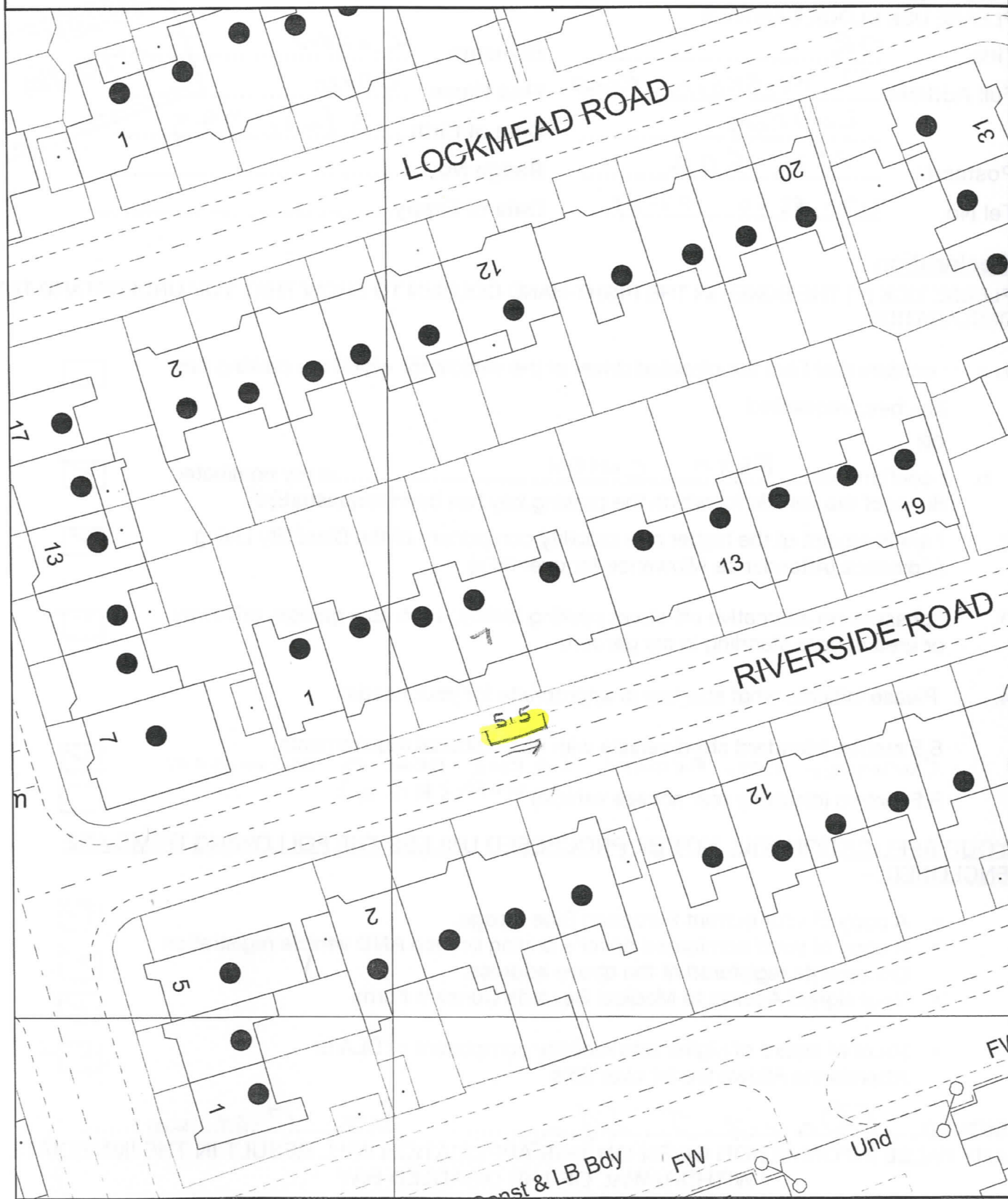

Location: 7 RIVERSIDE ROAD N15

Based upon the Ordnance Survey map with the permission of the Controller of Her Majesty's Stationery Office
Crown copyright reserved. Licence No. 100019199 2007

Section: Highways, Street Scene

Date: 14/04/2011

Scale: 1:500

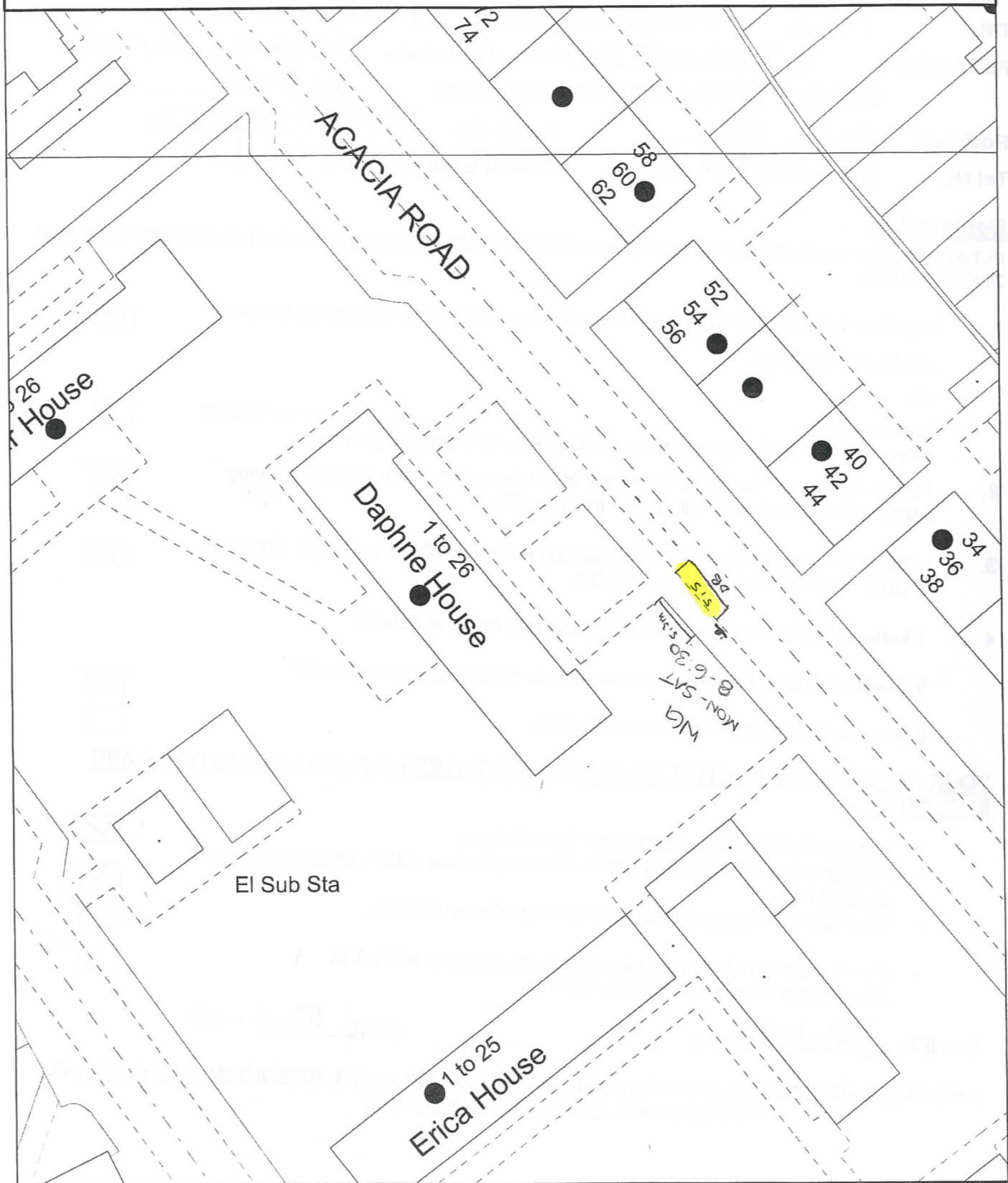

Location: 1 Daphne Hse, Acacia Road N22

Based upon the Ordnance Survey map with the permission of the Controller of Her Majesty's Stationery Office
Crown copyright reserved. Licence No. 100019199 2007

Section: Highways, Street Scene

Date: 27/05/2011

Scale: 1:500

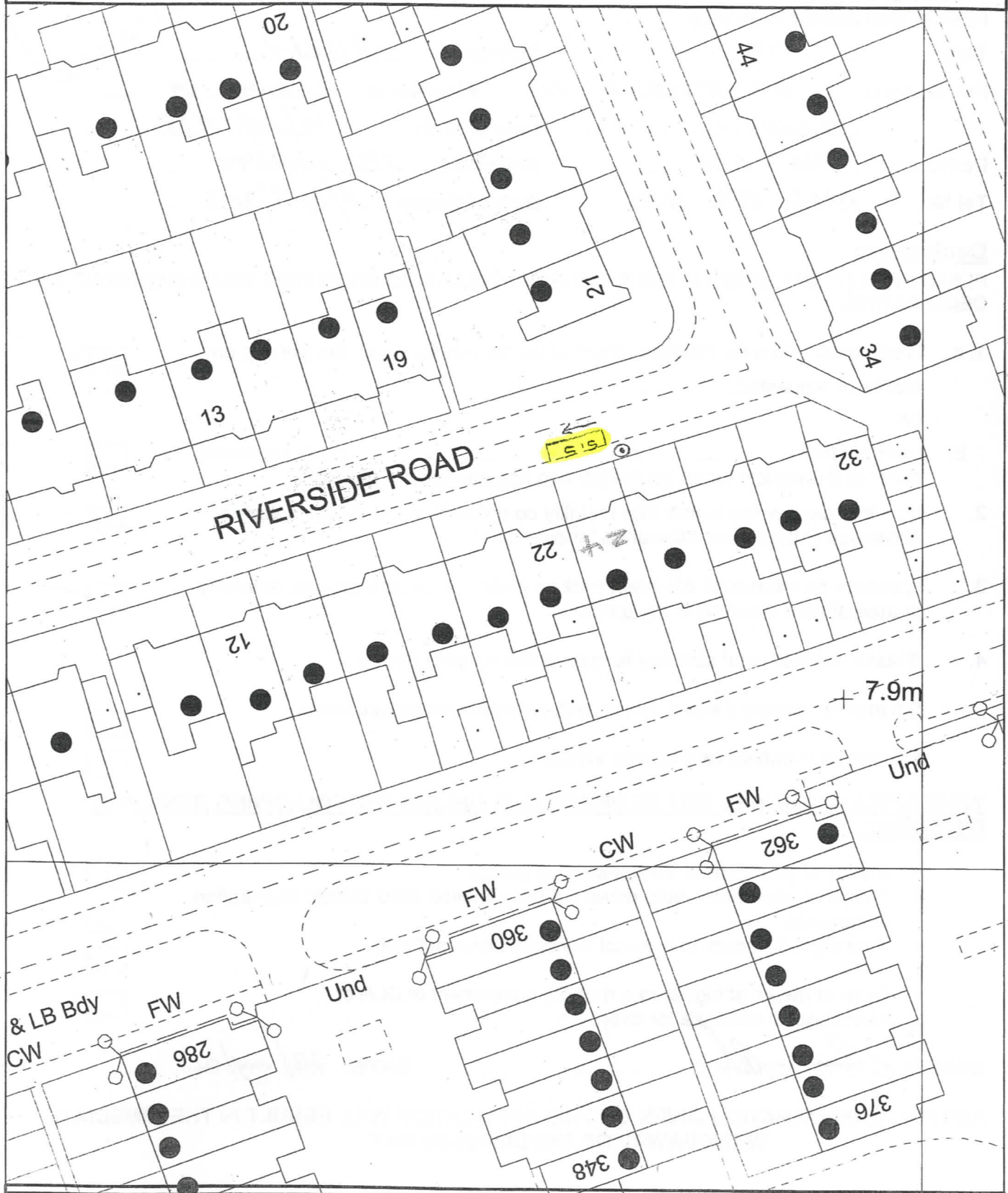

Location: 24 Riverside Road N15

Based upon the Ordnance Survey map with the permission of the Controller of Her Majesty's Stationery Office
Crown copyright reserved. Licence No. 100019199 2007

Section: Highways, Street Scene

Date: 14/04/2011

Scale: 1:500

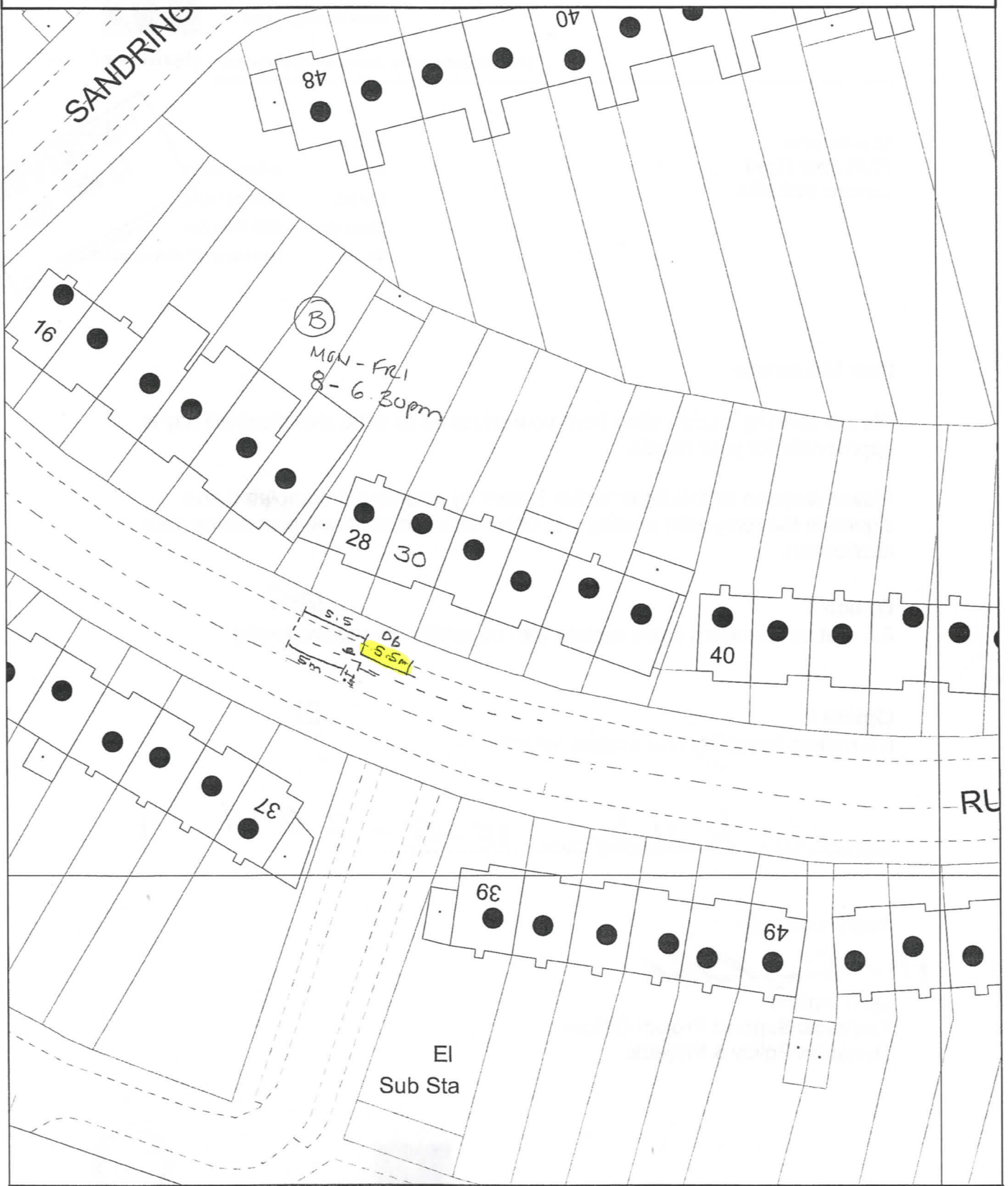

Location: 30 RUSPER ROAD N22

Based upon the Ordnance Survey map with the permission of the Controller of Her Majesty's Stationery Office
Crown copyright reserved. Licence No. 100019199 2007

Section: Highways, Street Scene

Date: 14/04/2011

Scale: 1:500

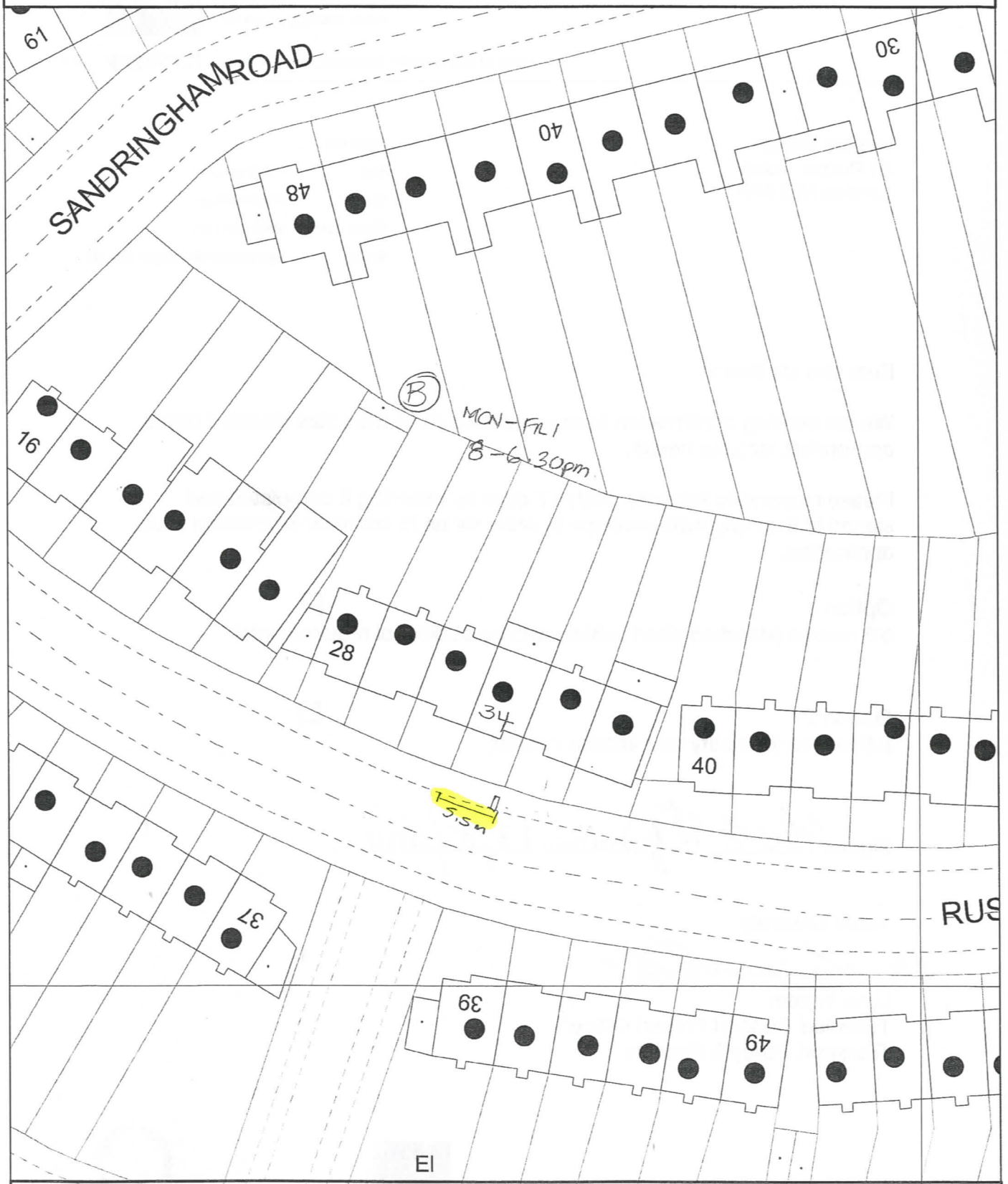

Location: 34 RUSPER ROAD N22

Based upon the Ordnance Survey map with the permission of the Controller of Her Majesty's Stationery Office
Crown copyright reserved. Licence No. 100019199 2007

Section: Highways, Street Scene

Date: 14/04/2011

Scale: 1:500

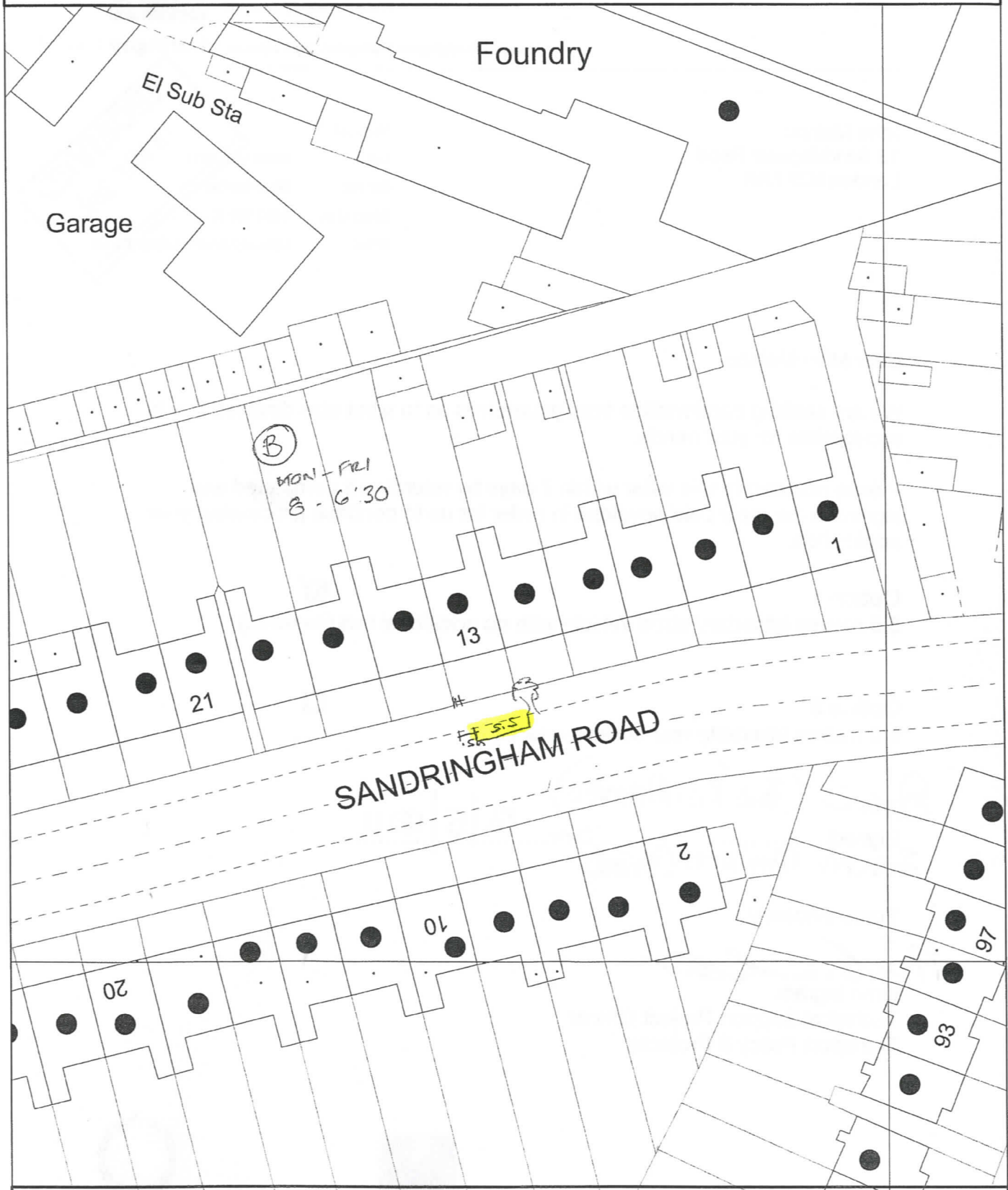

Location: 13 SANDRINGHAM ROAD N22

Based upon the Ordnance Survey map with the permission of the Controller of Her Majesty's Stationery Office
Crown copyright reserved. Licence No. 100019199 2007

Section: Highways, Street Scene

Date: 04/05/2011

Scale: 1:500

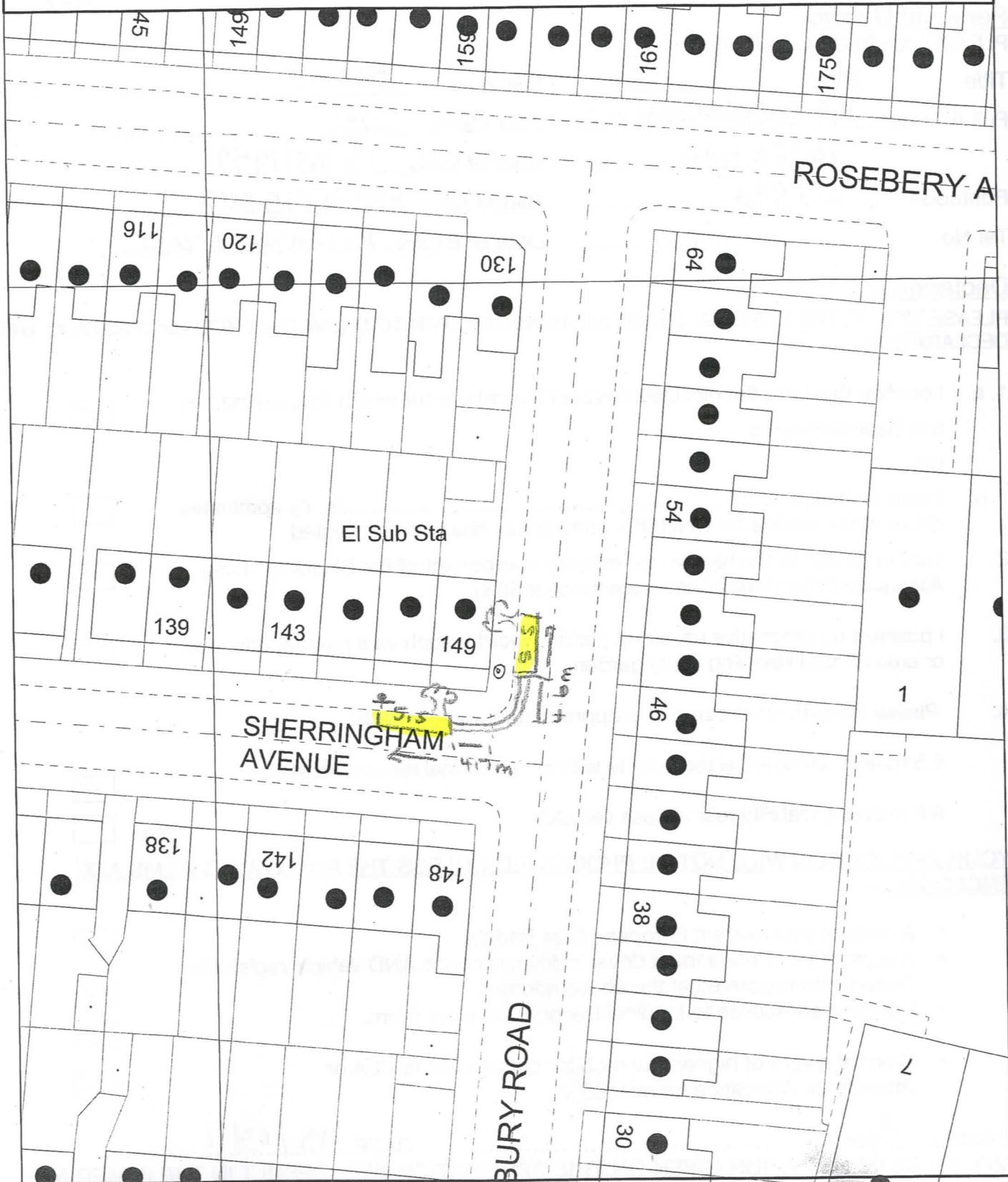

Location: 149 Sherringham Avenue N17

Based upon the Ordnance Survey map with the permission of the Controller of Her Majesty's Stationery Office
Crown copyright reserved. Licence No. 100019199 2007

Section: Highways, Street Scene

Date: 14/04/2011

Scale: 1:500



Location: 4 SOUTH GROVE N15

Based upon the Ordnance Survey map with the permission of the Controller of Her Majesty's Stationery Office
Crown copyright reserved. Licence No. 100019199 2007

Section: Highways, Street Scene

Date: 14/04/2011

Scale: 1:500

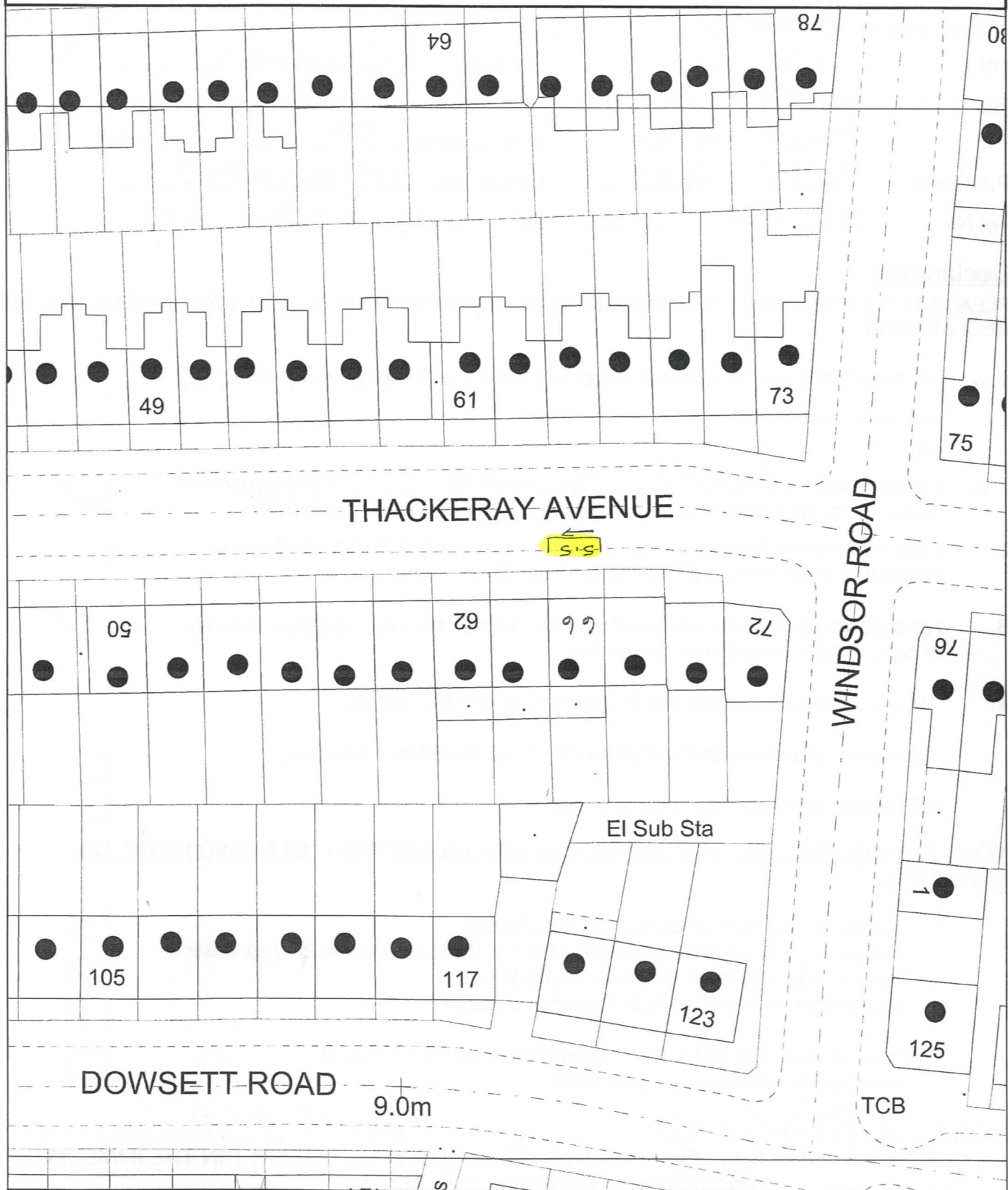

Location: 66 THACKERAY AVENUE N17

Based upon the Ordnance Survey map with the permission of the Controller of Her Majesty's Stationery Office
Crown copyright reserved. Licence No. 100019199 2007

Section: Highways, Street Scene

Date: 14/04/2011

Scale: 1:500

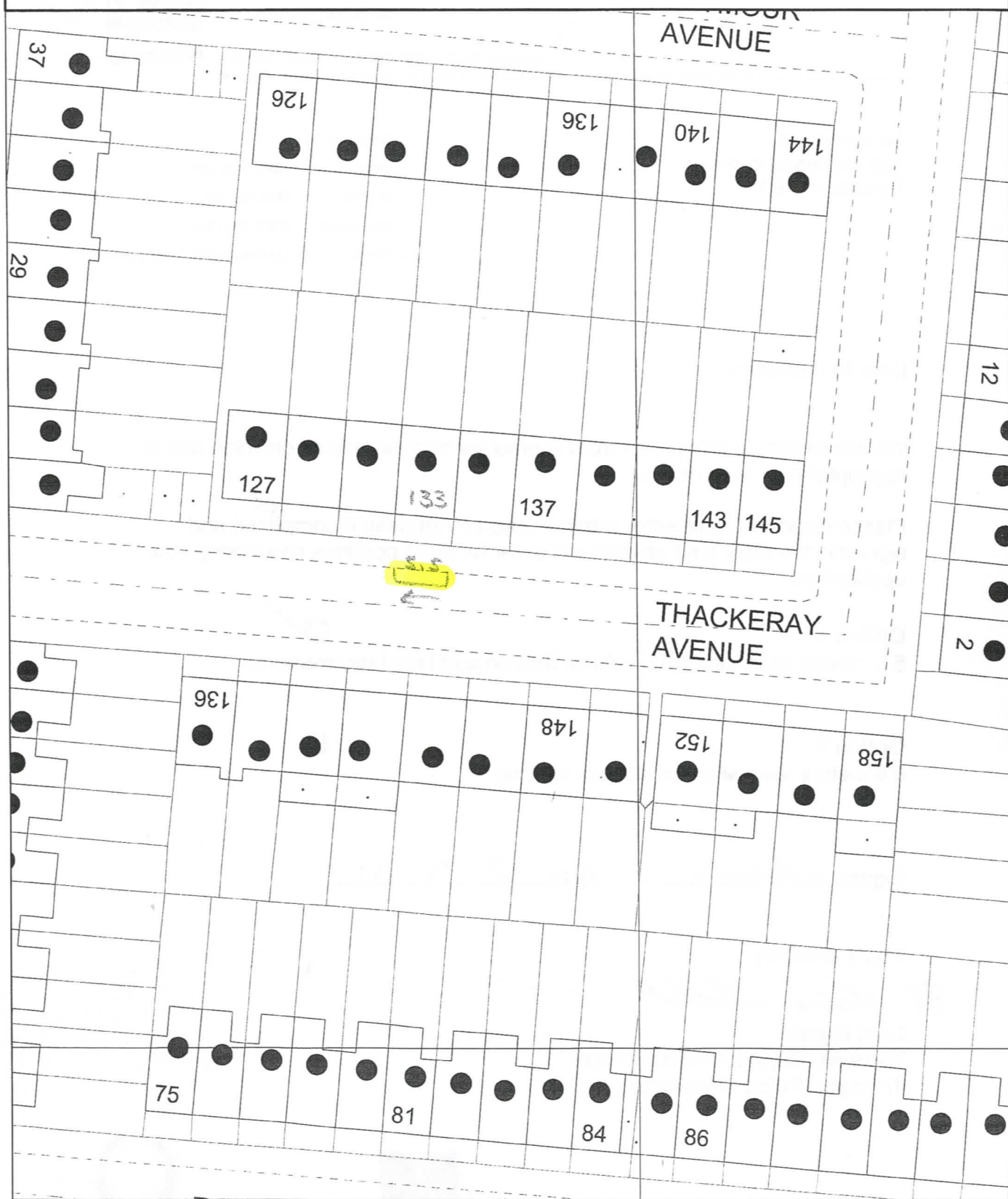

Location: 133 THACKERAY AVENUE N17

Based upon the Ordnance Survey map with the permission of the Controller of Her Majesty's Stationery Office
Crown copyright reserved. Licence No. 100019199 2007

Section: Highways, Street Scene

Date: 14/04/2011

Scale: 1:500



Location: 72 Tottenham Lane N8

Based upon the Ordnance Survey map with the permission of the Controller of Her Majesty's Stationery Office
Crown copyright reserved. Licence No. 100019199 2007

Section: Highways, Street Scene

Date: 07/06/2011

Scale: 1:500

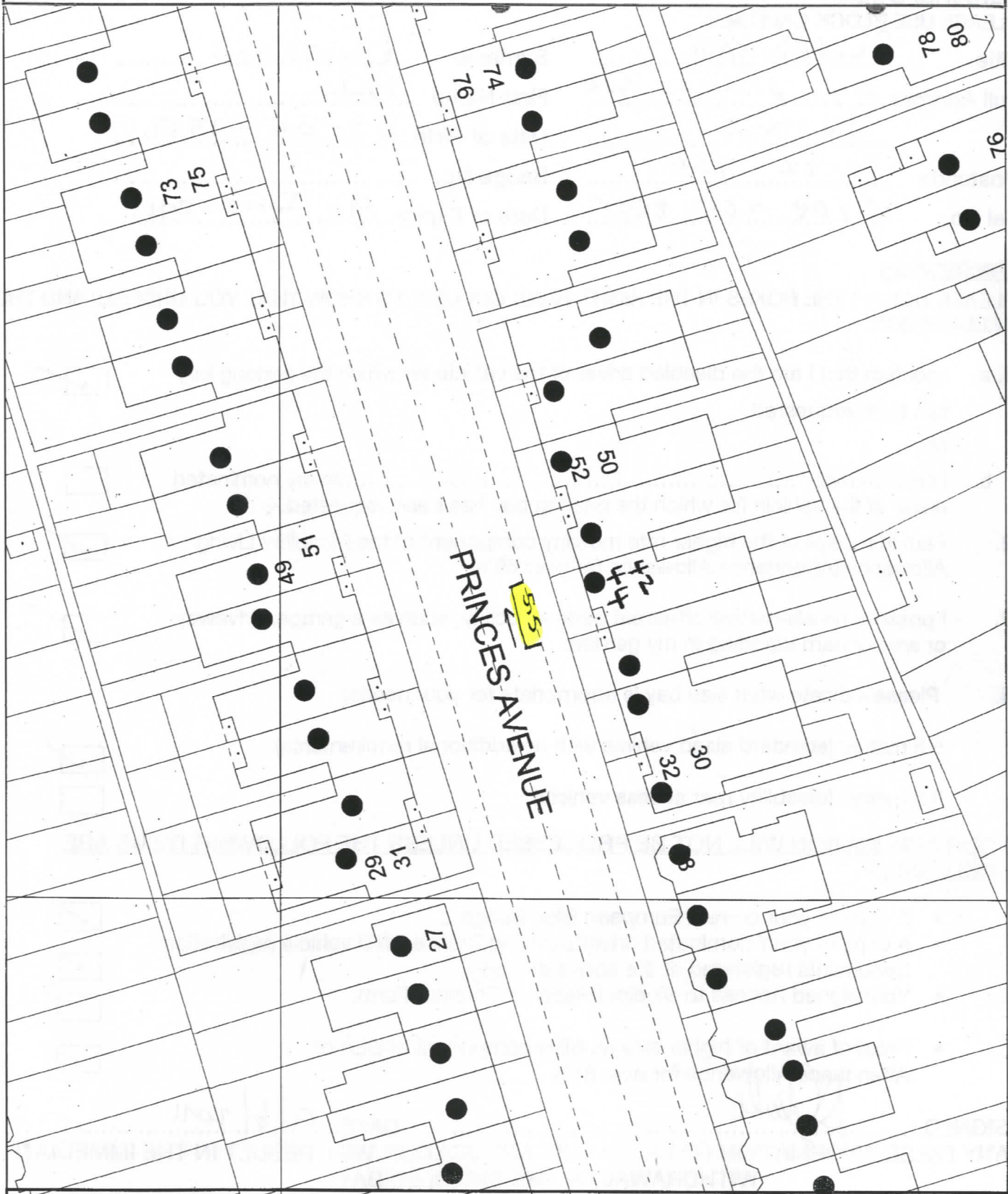

Location: 44 Princes Avenue N22

Based upon the Ordnance Survey map with the permission of the Controller of Her Majesty's Stationery Office
Crown copyright reserved. Licence No. 100019199 2007

Section: Highways, Street Scene

Date: 14/04/2011

Scale: 1:500

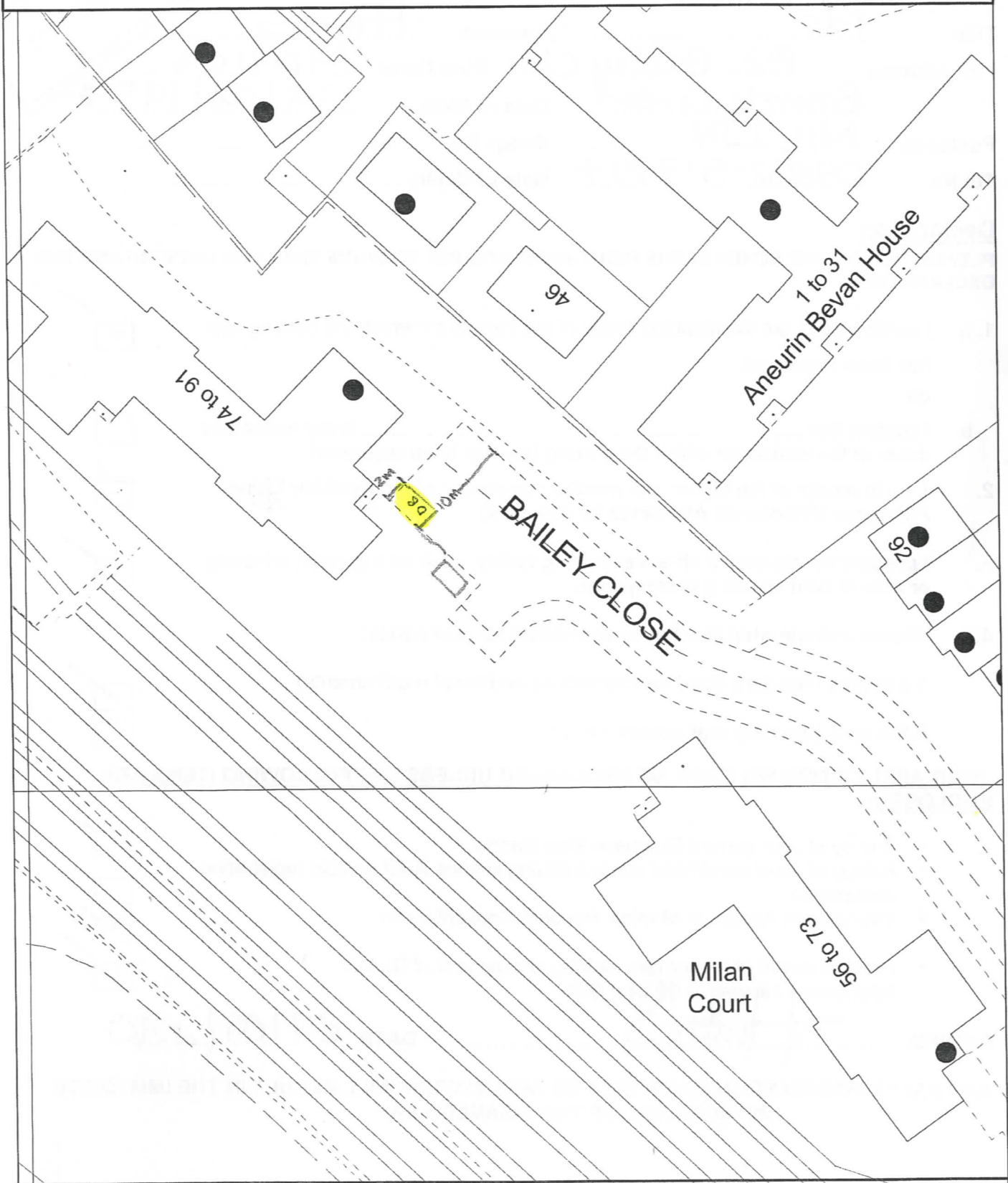

Location: 82 BAILEY CLOSE N11

Based upon the Ordnance Survey map with the permission of the Controller of Her Majesty's Stationery Office
Crown copyright reserved. Licence No. 100019199 2007

D-muncher on map