



GT50/122/0006

**ROAD TRAFFIC REGULATION ACT 1984 – SECTIONS 64 AND 65
AUTHORISATION OF TRAFFIC SIGNS AND SPECIAL DIRECTIONS**

The Secretary of State for Transport, in exercise of his powers under Sections 64 and 65 of the Road Traffic Regulation Act 1984, and of all other powers enabling him in that behalf, for the purpose of informing road users of the presence of time over distance safety cameras on Shapters Road, Embankment Road and Gydnia Way, Plymouth, hereby:-

1. authorises the erection at the sites on the said roads indicated by a green cross on the attached plan numbered GT50/122/0006-1 of a traffic sign (hereinafter referred to as "the authorised sign") conforming as to size, colour and character with that shown on the attached drawing numbered NP 878.1; and
2. directs, without prejudice to any statutory provision to the like effect, that it is a condition of this authorisation that the erection of the authorised sign at or near the said sites shall continue to have effect only until such day as may be appointed by one month's notice given by the Secretary of State in writing to the traffic authority for the removal or alteration of the authorised sign and on that day the said authorisation shall, without prejudice to the giving of any further authorisation or direction, cease to have effect.



GT50/122/0006

The provisions of Regulations 12, 18 and 19 of the Traffic Signs Regulations 2002 (Part I of SI 2002/3113) shall apply to the authorised sign in the same manner as they apply to the sign shown in diagram 878 in Schedule 4 to those Regulations.

Dated.....28 July.....2011

Signed by authority of the Secretary of State

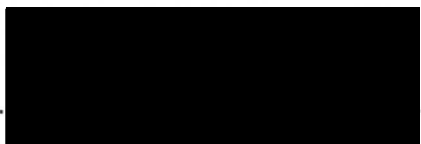

A Delegated Official of the Department for Transport

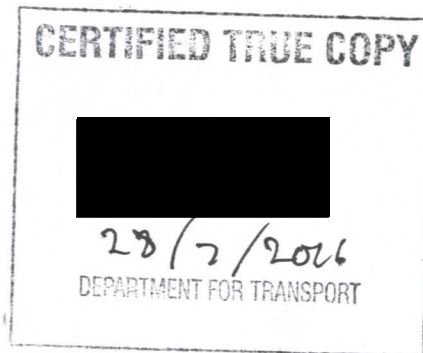

Drawing No.

NP 878.1

Related drawing

S 58

© CROWN COPYRIGHT

- NOTES:— 1. The legend is from the Transport Heavy alphabet at the x-heights shown.
2. Details of the camera symbol are given on drawing S 58.
3. The tile outlines do not form part of the sign.
4. COLOURS : Legend, Symbol & Border --- BLACK
Background ----- WHITE
5. DIMENSIONS : x-heights are in millimetres, other dimensions are in stroke widths. (4sw = x-height)

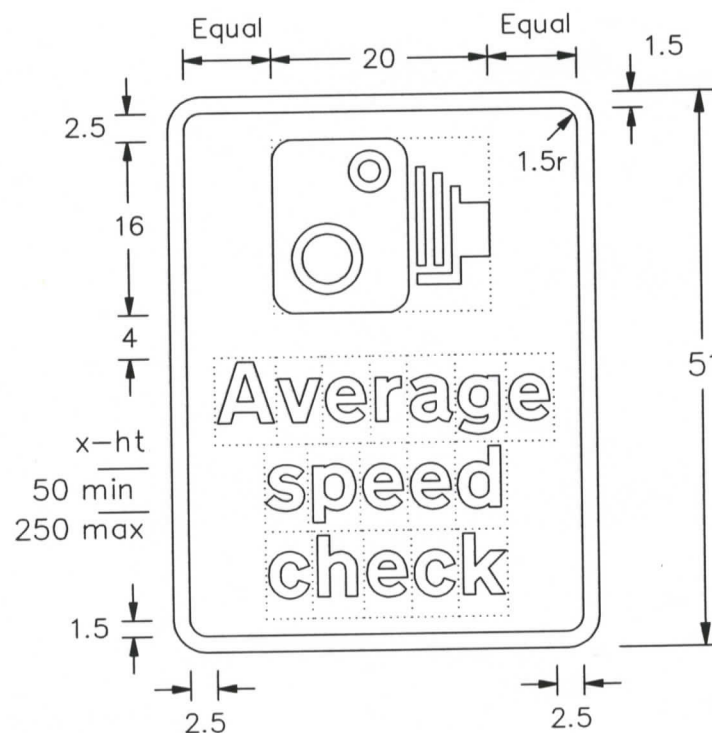

Before using this drawing, confirm that it has not been superseded.

NP878x1

Department for
Transport

Title:

Informatory Sign

AVERAGE SPEED CHECK

Issue: Date:

A: 30.6.05

B:

C:

Drawn by:

L.W.

Approved by:

R.M.

Dimensions:

SEE
NOTE 5

Drawing No.

NP 878.1

File ref.: p:\p1th major projects\409822 - east end of scheme\0 cad - drawings\work area\highways\1 live drawings\012 traffic signs\superseded\409822-con-1200-006 (0) traffic sign authorisations.dwg
 External references within this drawing:
 P:\P1TH MAJOR PROJECTS\409822 - EAST END OF SCHEME\0 CAD - DRAWINGS\WORK AREA\HIGHWAYS\0XREFS\SURVEYS\409822 TOPO SURVEY XREF AND SES SURVEY XREF 002.DWG
 P:\P1TH MAJOR PROJECTS\409822 - EAST END OF SCHEME\0 CAD - DRAWINGS\WORK AREA\HIGHWAYS\0XREFS\OS DATA\CURRENT (DOCTORED FOR SURVEY)\409822 OS MAP XREF 003.DWG
 P:\P1TH MAJOR PROJECTS\409822 - EAST END OF SCHEME\0 CAD - DRAWINGS\WORK AREA\HIGHWAYS\0XREFS\OS DATA\CONSTRUCTION XREF 005.DWG

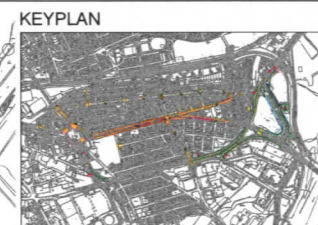
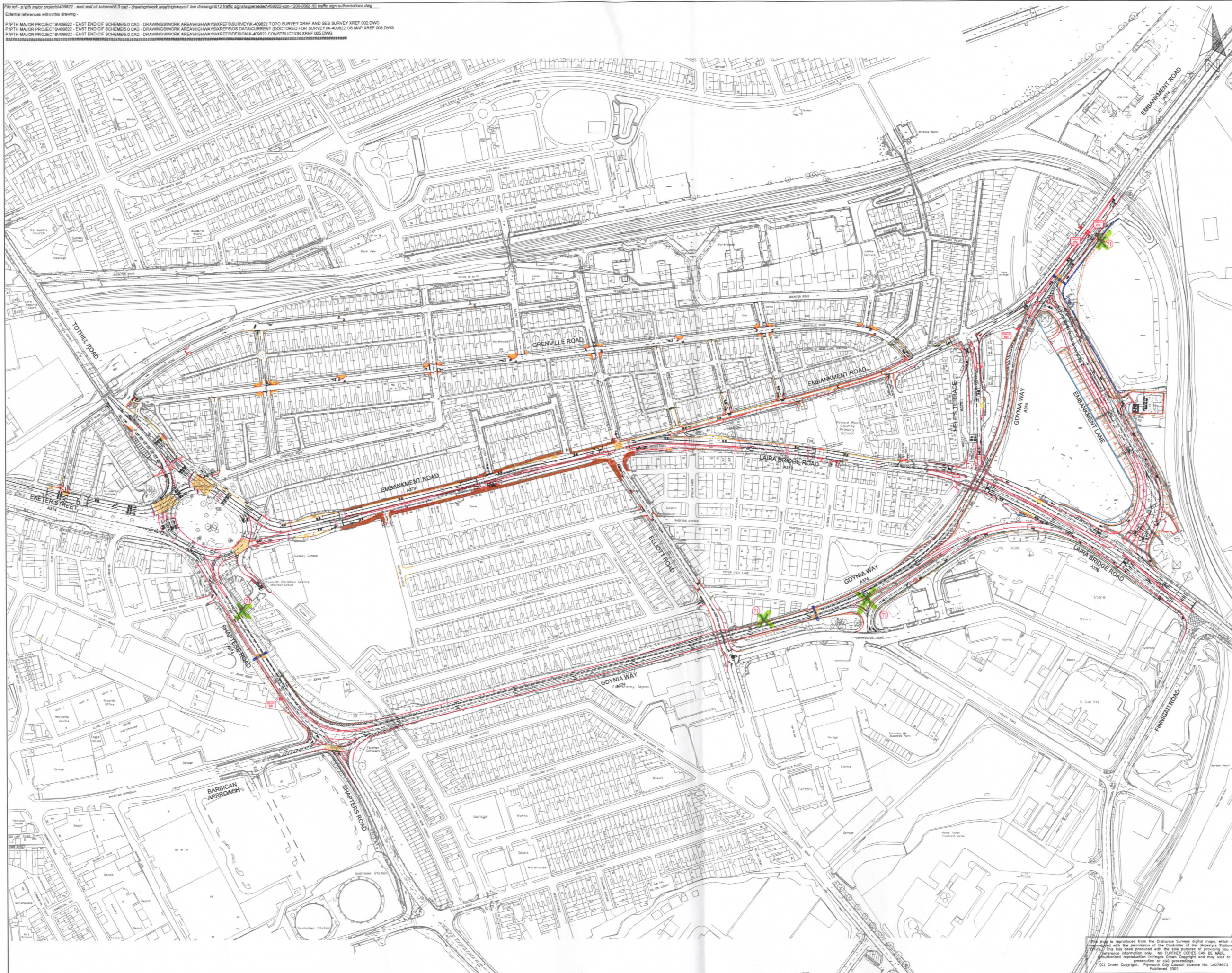

- NOTES**
- Diagram Numbers refer to The Traffic Signs Regulations and General Directions 2002.
 - Proposed signs for authorisation consist of:-

71 ADG 107 1 Average Speed Cameras 4 no.

- KEY**
- 71 Proposed new sign to be authorised (with reference number)
 - ADG 107 Adjacent relevant traffic signs (with Diag. No.)
 - Average Speed Camera Gantry

Department for Transport
 Date 27/7/2011
 No. GTSQ/122/0006-1

B	Detail clarified for drawing re-issue	ADC	ADC	26/06/11
A	Initial issue	ADC	ADC	11/10/10
Rev	Revision details	Chd	Appd	Date
Drawn	K.L.I.			Preliminary
Design	K.L.I.			For comment
Chd	A.D.C.			For tender
Appd	A.D.C.			For construction
Date	11/10/2010			As constructed
				Other



Project Name
EAST END COMMUNITY TRANSPORT IMPROVEMENTS SCHEME

Drawing Title
TRAFFIC SIGN AUTHORISATIONS - SITE PLAN (SHEET 0)

Original Drawing Size
 Scale 1:1250
 Dimensions m

Drawing No
409822-CON-1200-006 (0)

Rev
B

This plan is reproduced from the Ordnance Survey digital map, which was prepared with the permission of the Controller of Her Majesty's Stationery Office. This has been produced with the sole purpose of providing you with reference information only. NO FURTHER COPIES CAN BE MADE.
 Unauthorised reproduction infringes Crown Copyright and may lead to prosecution or civil proceedings.
 (C) Crown Copyright. Plymouth City Council Licence No. LA078972
 Published 2001