



GT50/186/0003

**ROAD TRAFFIC REGULATION ACT 1984 – SECTIONS 64 AND 65
AUTHORISATION OF TRAFFIC SIGNS AND SPECIAL DIRECTIONS**

The Secretary of State for Transport, in exercise of his powers under Sections 64 and 65 of the Road Traffic Regulation Act 1984, and of all other powers enabling him in that behalf, for the purpose of informing road users of various restrictions in Birkenhead Tunnel and Wallasey Tunnel including restricting the tunnels use by heavy goods vehicles carrying tunnel category D dangerous goods (defined by The Carriage of Dangerous Goods and the Use of Transportable Pressure Equipment Regulations (SI 2009 No.1348)) on roads for which Wirral Borough Council is the traffic authority, hereby:-

1. authorises the erection at or within 5 metres of the site marked with a red cross in the attached set of plans numbered GT50/186/0003-1 of a traffic sign (hereinafter referred to as "the authorised sign A") conforming as to size, colour and character with that shown at A on the attached set of drawings numbered GT50/186/0003-2 ; and
2. authorises the erection at or within 5 metres of the site marked with a green cross in the said set of plans of a traffic sign (hereinafter referred to as "the authorised sign B") conforming as to size, colour and character with that shown at B on the said set of drawings; and
3. authorises the erection at or within 5 metres of the site marked with a blue cross in the said set of plans of a traffic sign (hereinafter referred to as "the authorised sign C") conforming as to size, colour and character with that shown at C on the said set of drawings; and
4. authorises the erection at or within 5 metres of the site marked with a orange cross in the said set of plans of a traffic sign (hereinafter referred to as "the authorised sign D") conforming as to size, colour and character with that shown at D on the said set of drawings; and



GT50/186/0003

5. authorises the erection at or within 10 metres of the site marked with a brown cross in the said set of plans of a traffic sign (hereinafter referred to as "the authorised sign E") conforming as to size, colour and character with that shown at E on the said set of drawings; and
6. directs, without prejudice to any statutory provision to the like effect, that it is a condition of this authorisation that the erection of the authorised signs A, B, C, D, and E at or near the said sites shall continue to have effect only until such day as may be appointed by one month's notice given by the Secretary of State in writing to the traffic authority for the removal or alteration of the authorised signs A, B, C, D and E and on that day the said authorisation shall, without prejudice to the giving of any further authorisation or direction, cease to have effect.

This authorisation replaces the earlier one dated 2nd August 2011 under reference GT50/186/0002 which is hereby revoked.

The provisions of Regulations 12, 18 and 19 of the Traffic Signs Regulations 2002 (Part I of SI 2002/3113, "the 2002 Regulations") shall apply to the authorised signs A, B, C, D and E in the same manner as they apply to the sign shown in diagram 818.4 in Schedule 4 to those Regulations.

Dated 9 August 2011

Signed by authority of the Secretary of State

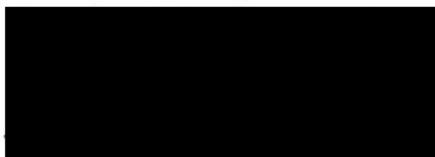

A Delegated Official of the Department for Transport

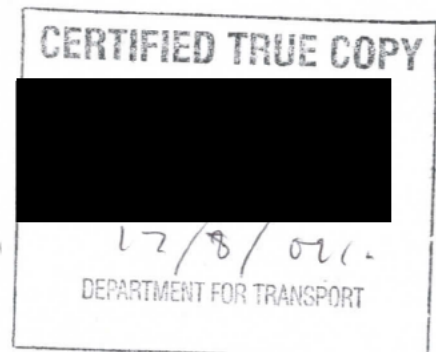

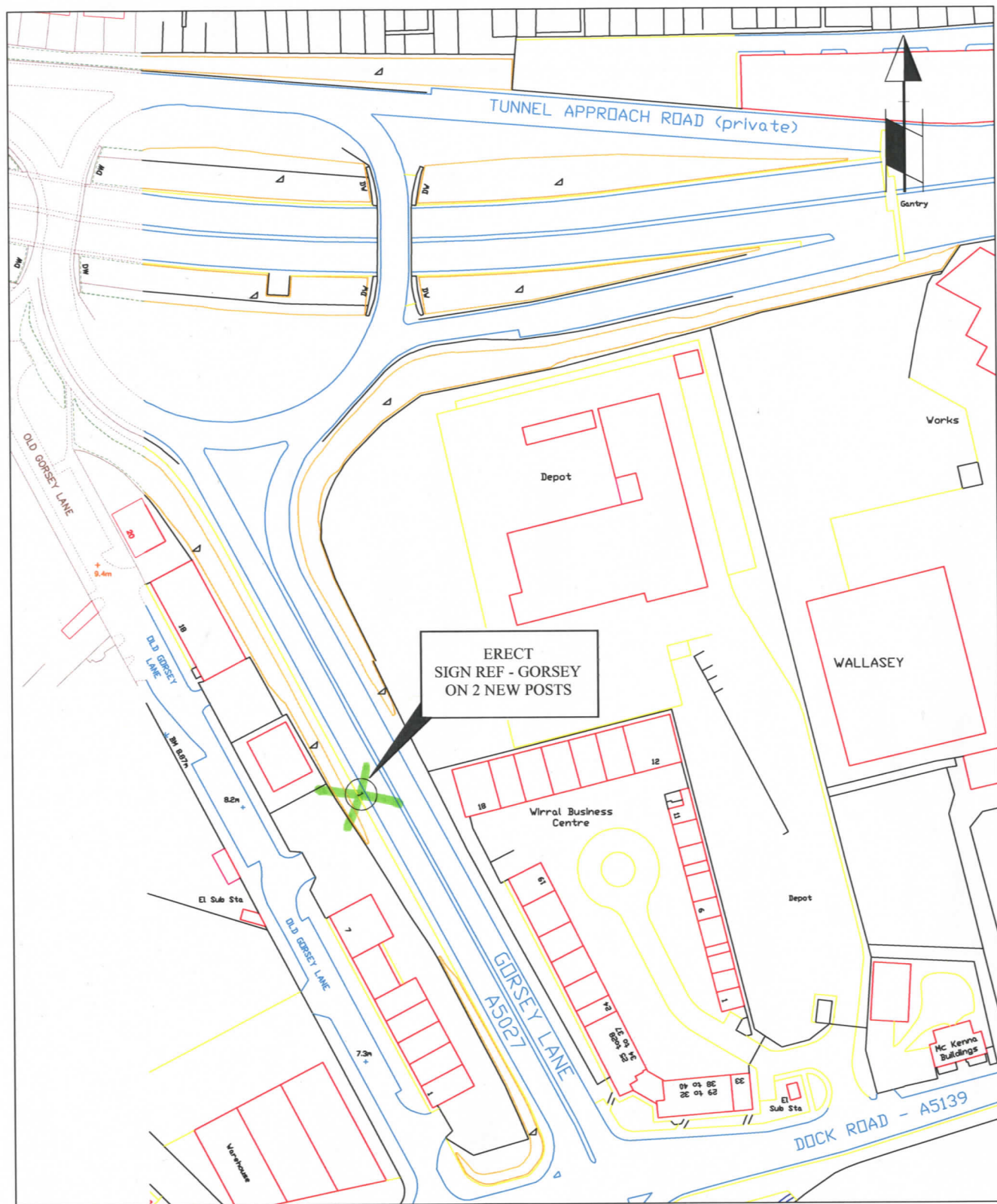

WIRRAL

Technical Services Department

David Green
Director

PROPOSED LOCATION PLAN - ADR RESTRICTION SIGN "GORSEY"
GORSEY LANE
POULTON, WALLASEY

Scale 1:1250 Date NOV 09 Plan Ref No. TB0278h0

Page 2 of 5

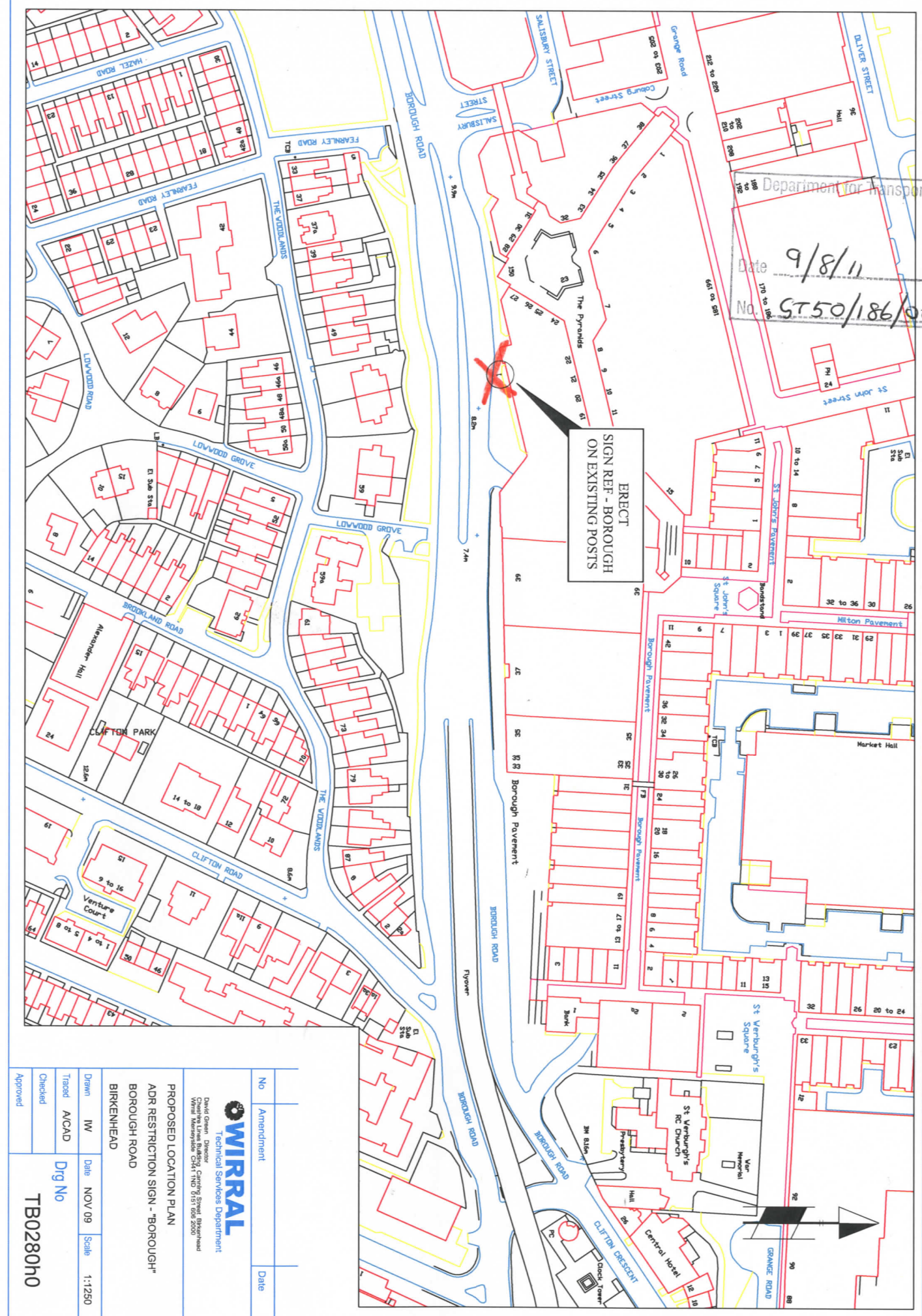

No	Amendment	Date
1	Initial Issue	
2	Revised Issue	
3	Revised Issue	
4	Revised Issue	
5	Revised Issue	
6	Revised Issue	
7	Revised Issue	
8	Revised Issue	
9	Revised Issue	
10	Revised Issue	
11	Revised Issue	
12	Revised Issue	
13	Revised Issue	
14	Revised Issue	
15	Revised Issue	
16	Revised Issue	
17	Revised Issue	
18	Revised Issue	
19	Revised Issue	
20	Revised Issue	
21	Revised Issue	
22	Revised Issue	
23	Revised Issue	
24	Revised Issue	
25	Revised Issue	
26	Revised Issue	
27	Revised Issue	
28	Revised Issue	
29	Revised Issue	
30	Revised Issue	
31	Revised Issue	
32	Revised Issue	
33	Revised Issue	
34	Revised Issue	
35	Revised Issue	
36	Revised Issue	
37	Revised Issue	
38	Revised Issue	
39	Revised Issue	
40	Revised Issue	
41	Revised Issue	
42	Revised Issue	
43	Revised Issue	
44	Revised Issue	
45	Revised Issue	
46	Revised Issue	
47	Revised Issue	
48	Revised Issue	
49	Revised Issue	
50	Revised Issue	
51	Revised Issue	
52	Revised Issue	
53	Revised Issue	
54	Revised Issue	
55	Revised Issue	
56	Revised Issue	
57	Revised Issue	
58	Revised Issue	
59	Revised Issue	
60	Revised Issue	
61	Revised Issue	
62	Revised Issue	
63	Revised Issue	
64	Revised Issue	
65	Revised Issue	
66	Revised Issue	
67	Revised Issue	
68	Revised Issue	
69	Revised Issue	
70	Revised Issue	
71	Revised Issue	
72	Revised Issue	
73	Revised Issue	
74	Revised Issue	
75	Revised Issue	
76	Revised Issue	
77	Revised Issue	
78	Revised Issue	
79	Revised Issue	
80	Revised Issue	
81	Revised Issue	
82	Revised Issue	
83	Revised Issue	
84	Revised Issue	
85	Revised Issue	
86	Revised Issue	
87	Revised Issue	
88	Revised Issue	
89	Revised Issue	
90	Revised Issue	
91	Revised Issue	
92	Revised Issue	
93	Revised Issue	
94	Revised Issue	
95	Revised Issue	
96	Revised Issue	
97	Revised Issue	
98	Revised Issue	
99	Revised Issue	
100	Revised Issue	

Page 1 of 5

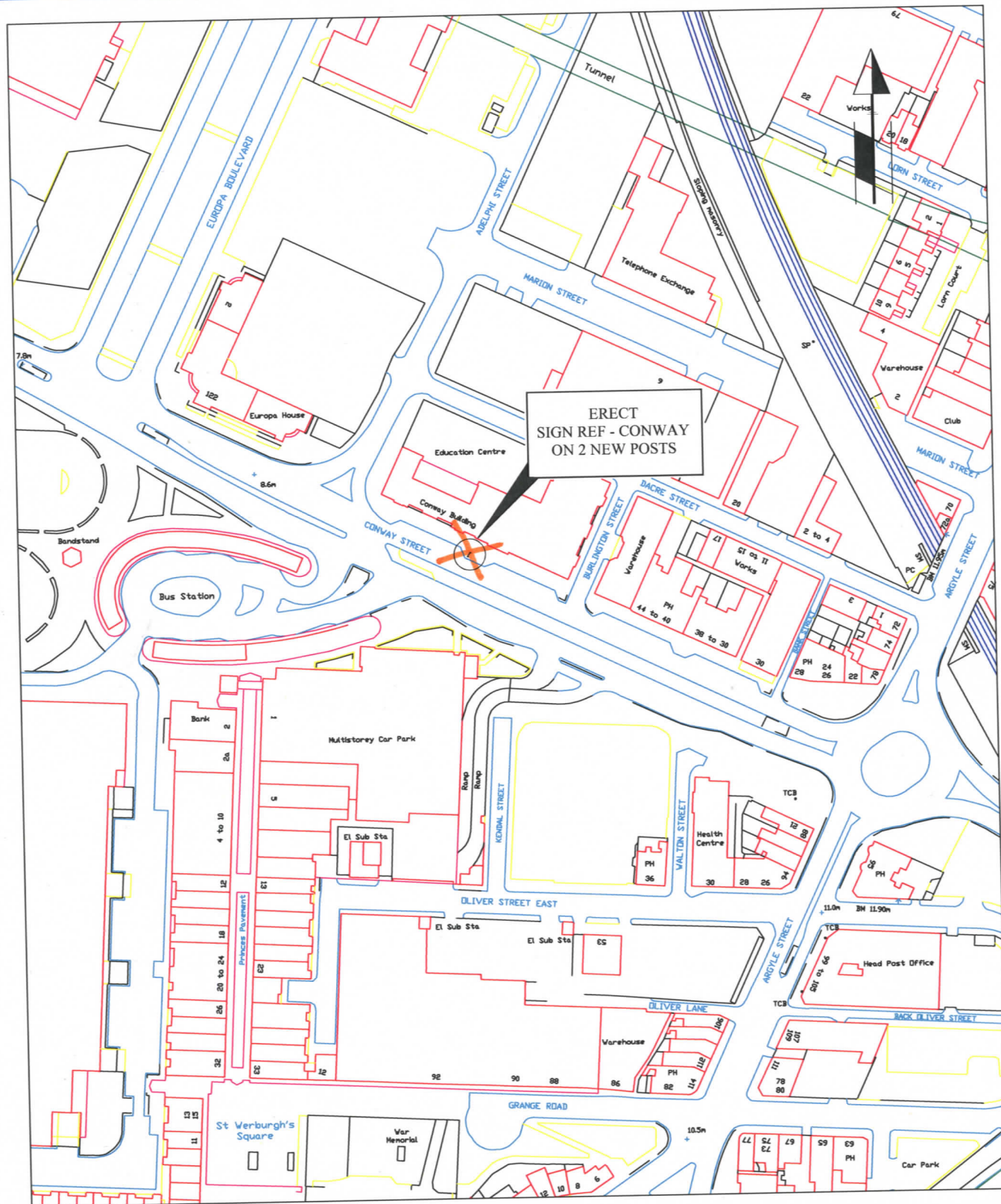

WIRRAL

Technical Services Department

David Green
Director

PROPOSED LOCATION PLAN - ADR RESTRICTION SIGN "CONWAY"
CONWAY STREET
BIRKENHEAD

Scale

1:1250

Date

NOV 09

Plan Ref No.

TB0279h0

Page 4 of 5

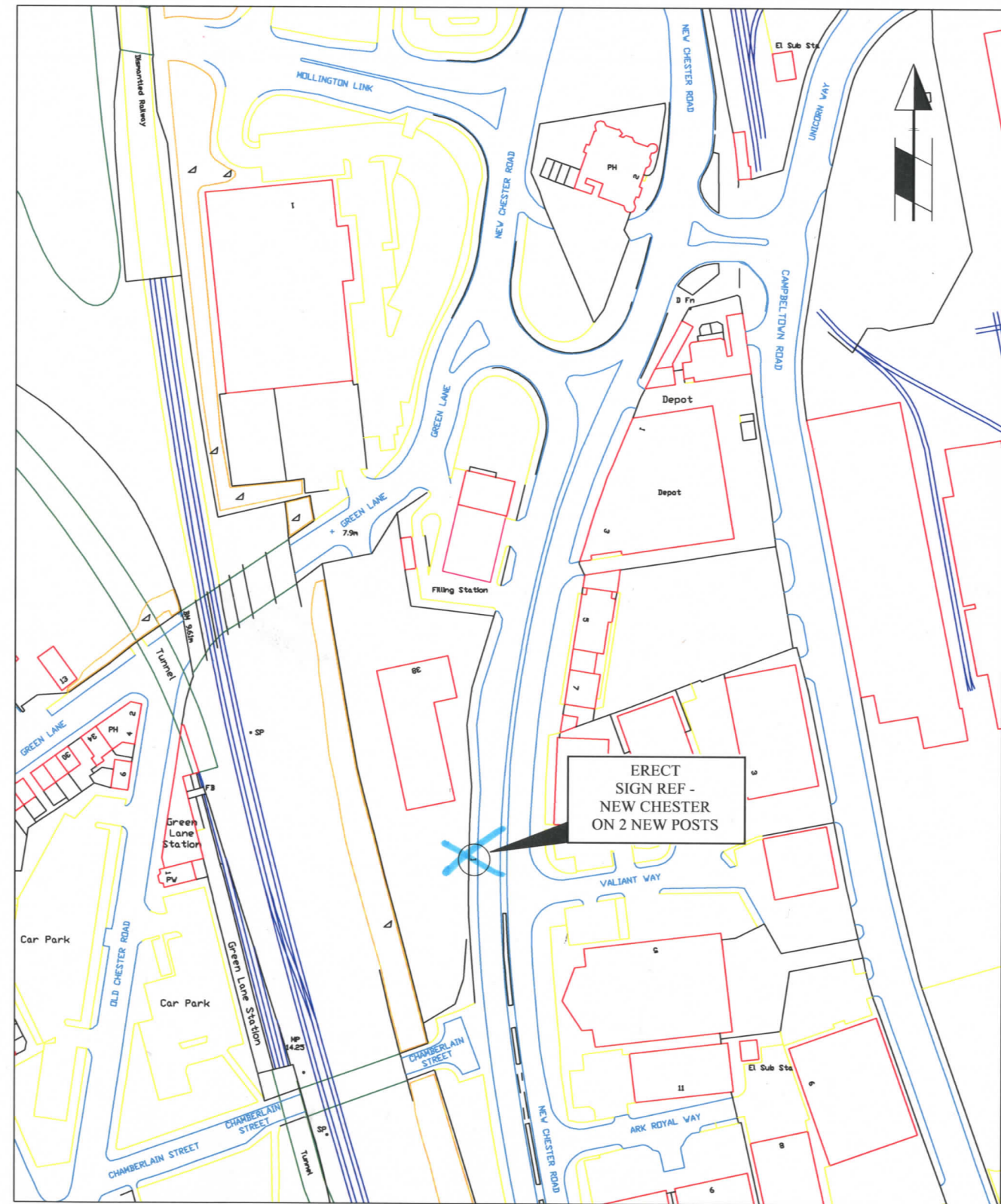

WIRRAL

Technical Services Department

David Green
Director

PROPOSED LOCATION PLAN - ADR RESTRICTION SIGN "NEW CHESTER"
NEW CHESTER ROAD
TRANMERE

Scale

1:1250

Date

NOV 09

Plan Ref No.

TB0281h0

Page 3 of 5

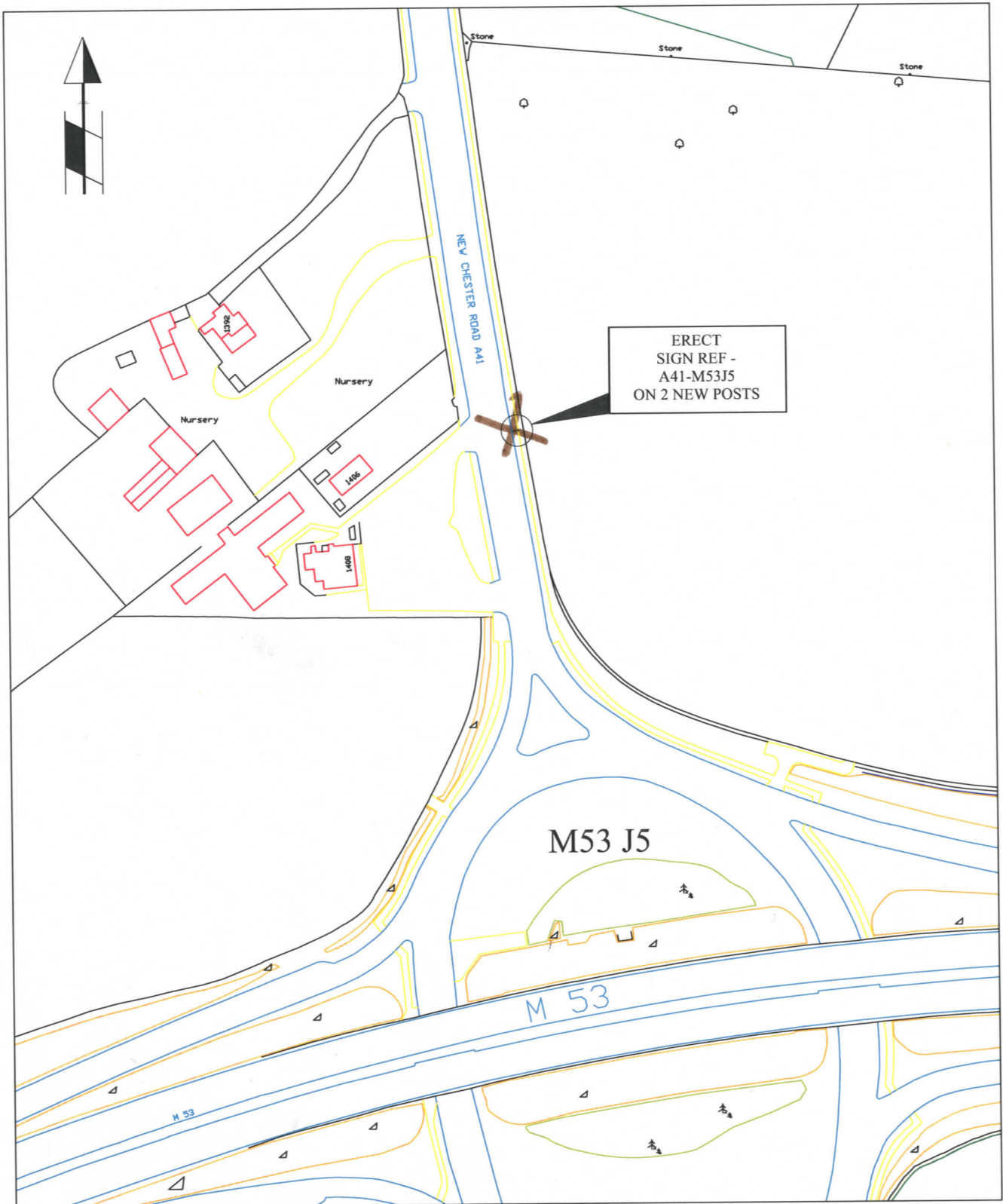

WIRRAL

Technical Services Department

David Green
Director

PROPOSED LOCATION PLAN - ADR RESTRICTION SIGN "A41-M53J5"
NEW CHESTER ROAD
EASTHAM

Scale

1:1250

Date

NOV 09

Plan Ref No.

TB0282h0

Page 5 of 5

A



Scheme Ref.		
Sign Ref.	BOROUGH	x-height 75.0
Letter colour	WHITE	SIGN FACE
Background	BLUE	Width 1670mm
Border	WHITE	Height 1445mm
Material	Microprismatic	Area 2.41sq.m

SIGN REF - BOROUGH

B



Scheme Ref.		
Sign Ref.	GORSEY	x-height 80.0
Letter colour	WHITE	SIGN FACE
Background	BLUE	Width 1875mm
Border	WHITE	Height 1720mm
Material	Microprismatic	Area 3.22sq.m

SIGN REF - GORSEY

C



Scheme Ref.		
Sign Ref.	NEW CHESTER	x-height 90.0
Letter colour	WHITE	SIGN FACE
Background	BLUE	Width 2240mm
Border	WHITE	Height 1780mm
Material	Microprismatic	Area 3.98sq.m

SIGN REF -
NEWCHESTER

Scheme Ref. ADR TUNNEL RESTRICTIONS		
Sign Ref.	A41M53J5	x-height 100.0
Letter colour	WHITE	SIGN FACE
Background	BLACK	Width 2105mm
Border	WHITE	Height 1545mm
Material	Microprismatic	Area 3.25sq.m

SIGN REF - A41M53J5

D



Scheme Ref.		
Sign Ref.	CONWAY	x-height 75.0
Letter colour	WHITE	SIGN FACE
Background	BLUE	Width 1670mm
Border	WHITE	Height 1445mm
Material	Microprismatic	Area 2.41sq.m

SIGN REF -
CONWAY

Department for Transport		
Date	26 July 2011	
No.	6-50/0186/0003-2	
WIRRAL Technical Services Department		
David Green Director Cheshire Lines Building, Canning Street, Birkenhead Wirral, Merseyside CH41 1ND 0151 606 2000		
PROPOSED SIGN SCHEDULES ADR RESTRICTION SIGNS WIRRAL		
Drawn	IW	Date MAY 10 Scale NTS
Traced	A/CAD	Drg No
Checked		TB0283m0
Approved		

E

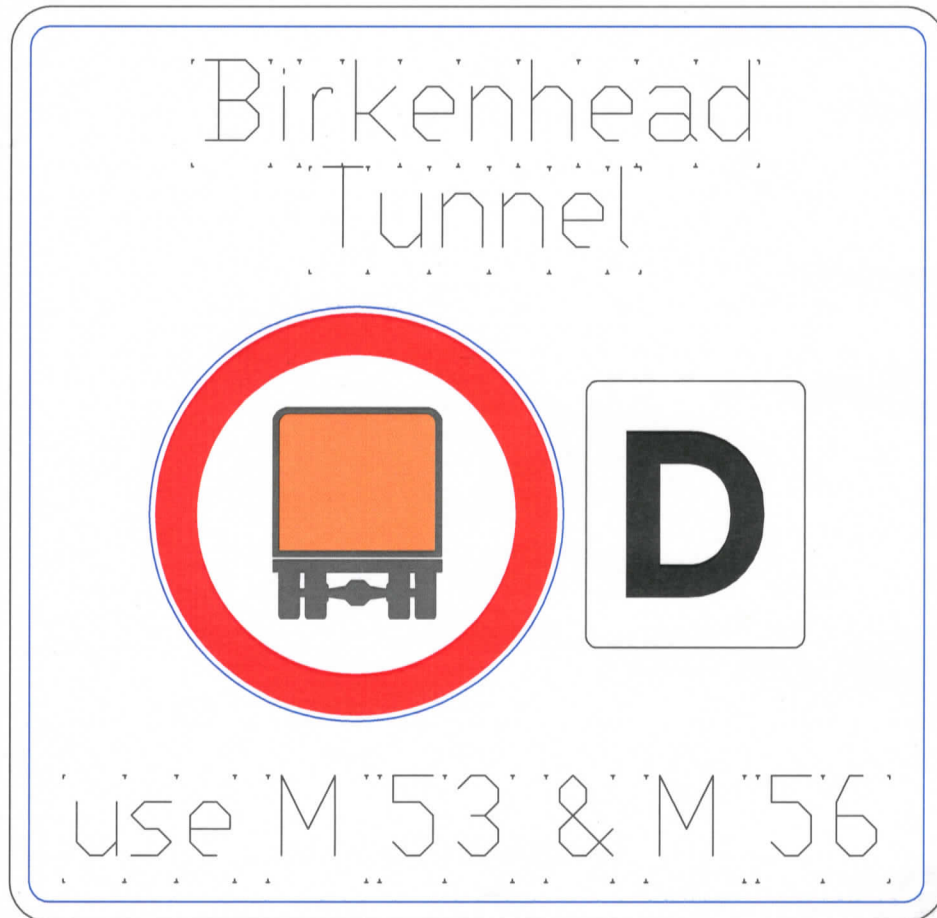

Scheme Ref.			
Sign	Ref. A41M53	x-height	125.0
Letter colour	WHITE	SIGN FACE	
Background	BLUE	Width	2185mm
Border	WHITE	Height	2140mm
Material	Microprismatic	Area	4.68sq.m