



GT50/073/0013

**ROAD TRAFFIC REGULATION ACT 1984 – SECTIONS 64 AND 65
AUTHORISATION OF TRAFFIC SIGNS AND SPECIAL DIRECTIONS**

The Secretary of State for Transport, in exercise of her powers under Sections 64 and 65 of the Road Traffic Regulation Act 1984 and of all other powers enabling her in that behalf, for the purpose of indicating parking places for disabled persons on roads for which the London Borough of Brent is the traffic authority, hereby:-

1. authorises the placing at the locations shown in the attached set of plans numbered GT50/073/0013-1 of a traffic sign consisting of a road marking (hereinafter referred to as "the authorised marking") conforming as to size, colour and character with that to diagram 1028.3 in Schedule 6 to the Traffic Signs Regulations 2002 (Part I of SI 2002/3113, "the 2002 Regulations") save that the length of the bays shall be as shown in the said set of plans; and
2. directs that, notwithstanding the provisions of Direction 24(1) of the Traffic Signs General Directions 2002 (Part II of SI 2002/3113), the authorised marking shall only be used with the sign to diagram 661A in Schedule 2 to the 2002 Regulations; and
3. directs that it is a condition of this authorisation that the authorised marking may be placed only to indicate the effect of a corresponding Traffic Order; and



GT50/073/0013

4. directs, without prejudice to any statutory provision to the like effect, that it is a condition of this authorisation that the placing of the authorised marking on the said roads shall continue to have effect only until such day as may be appointed by one month's notice given by the Secretary of State in writing to the traffic authority for the removal or alteration of the authorised marking and on that day the said authorisation shall, without prejudice to the giving of any further authorisation or direction, cease to have effect.

The provisions of Regulations 12 and 31 of the 2002 Regulations shall apply to the authorised marking in the same manner as they apply to the road marking to diagram 1028.3 in Schedule 6 to those Regulations.

Dated 28 February 2012

Signed by authority of the Secretary of State

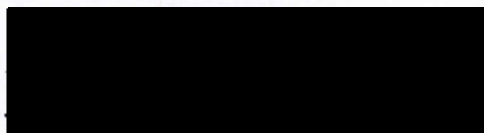
.....

A Delegated Official of the Department for Transport

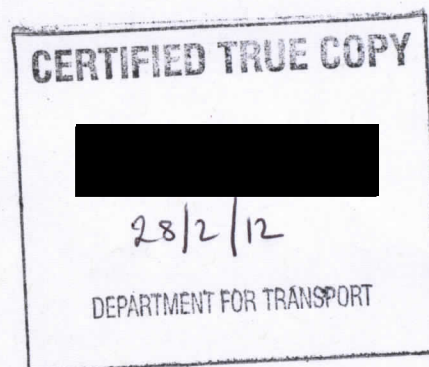

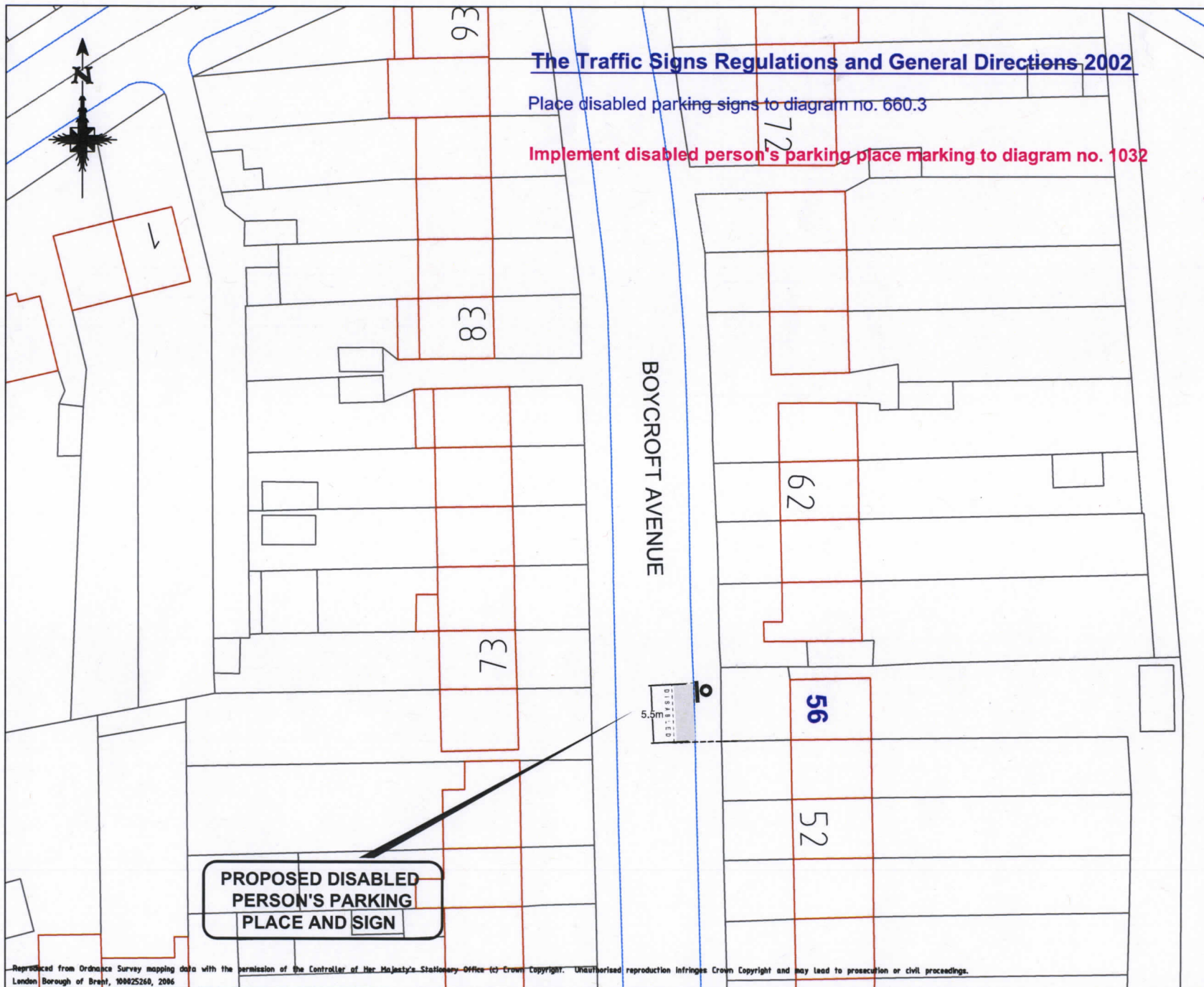

KEY



----- Reference Line

Department for Transport

Date 27/2/2012

No. GT50/073/0013-1

London Borough of Brent
Environment & Culture
Transportation Unit
Brent House, 349-357 High Road
Wembley, Middlesex, HA9 6BZ

Job Title
DISABLED PERSON'S
PARKING PLACE

Drawing Title
56 Boycroft Avenue
NW9 8AP

Scale 1:500	Designed EH Drawn EH
Date created 7/12/11	Checked AH Approved AH

Drawing No. D4785/1196	Rev.
------------------------	------

CAD Ref. S:\TG1\March - September 11

The Traffic Signs Regulations and General Directions 2002

Place disabled parking signs to diagram no. 661A

Implement disabled person's parking place marking to diagram no. 1032



KEY



Reference Line

London Borough of Brent
Environment & Culture
Transportation Unit
Brent House, 348-357 High Road
Wembley, Middlesex, HA9 6XX

Job Title
DISABLED PERSON'S
PARKING PLACE

Drawing Title
21 Dawson Court
Atlip Road
HA0 4GD

Scale 1:500	Designed EH
	Drawn EH
Date created 05/12/11	Checked AH
	Approved AH

Drawing No. D4785/1198	Rev.
CAD Ref.	S\YG1\March - September 11

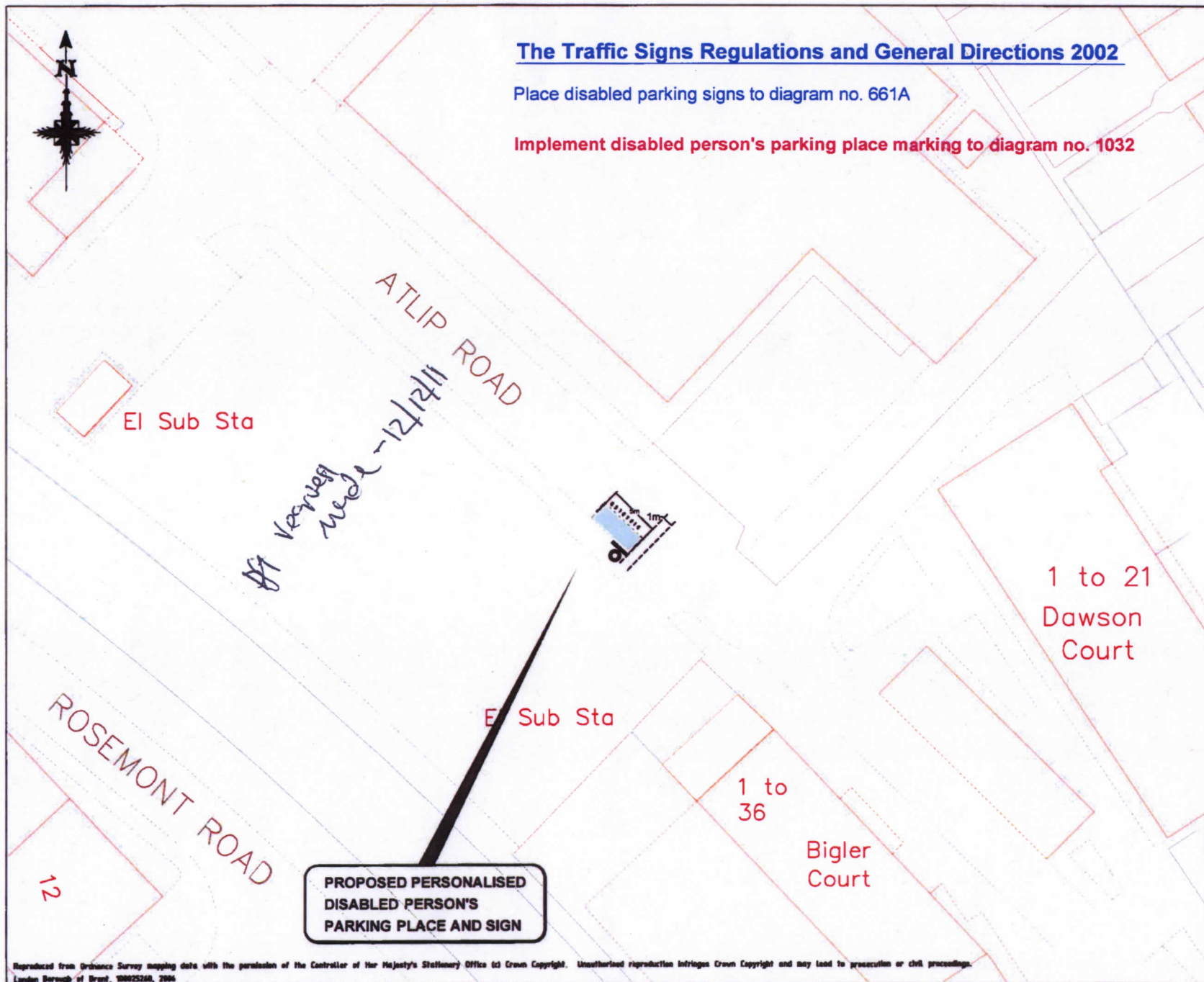

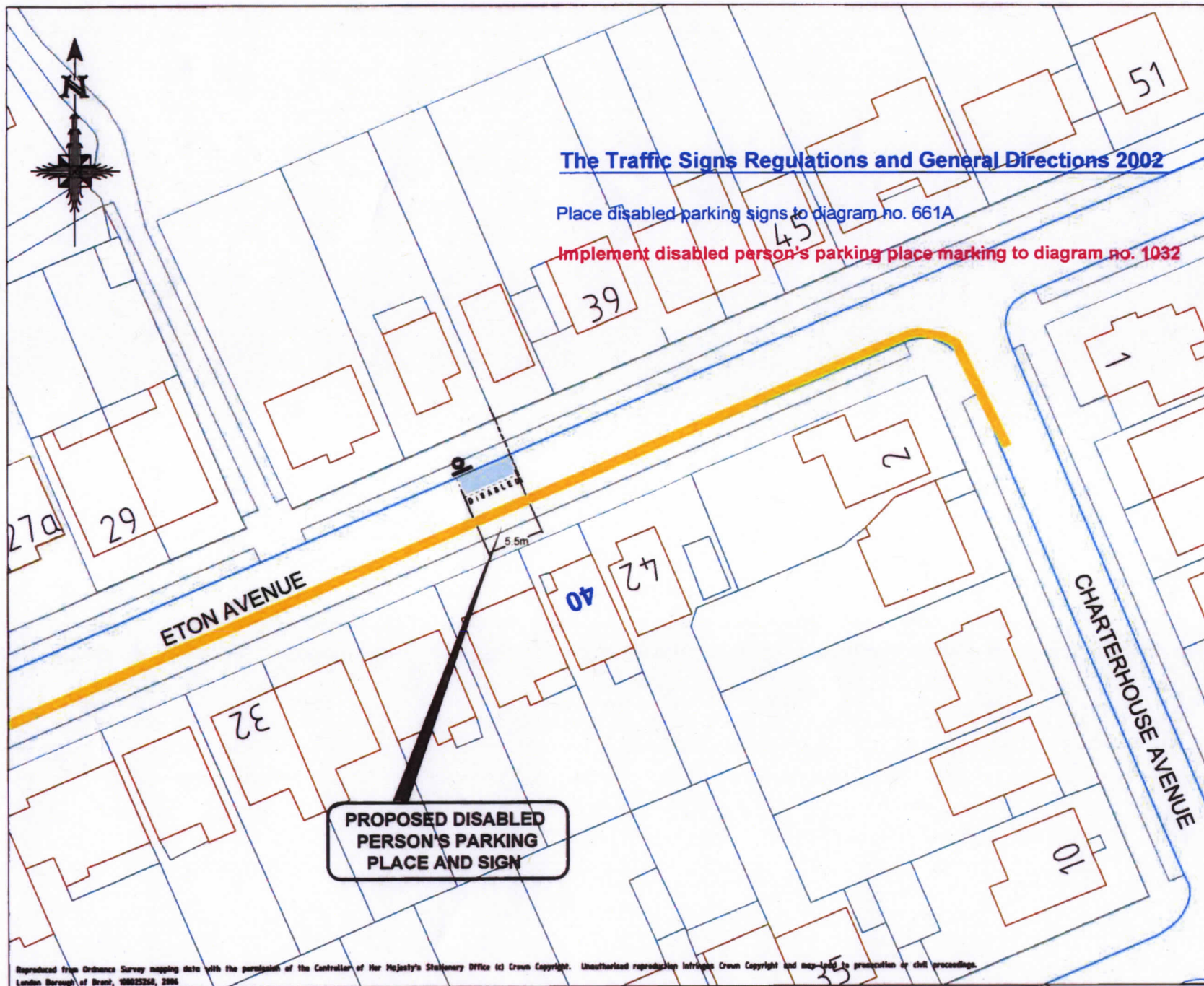

KEY



Reference Line

Existing double yellow lines

London Borough of Brent
Environment & Culture
Transportation Unit
Brent House, 348-357 High Road
Wembley, Middlesex, HA9 6EZ

Job Title
DISABLED PERSON'S
PARKING PLACE

Drawing Title
40 Eton Avenue
HA0 3AX

Scale	Designed EH
1:500	Drawn EH
Date created	Checked AH
21/11/11	Approved AH

Drawing No. D4785/1200 Rev.

CAD Ref. S:\TG1\March - September 11

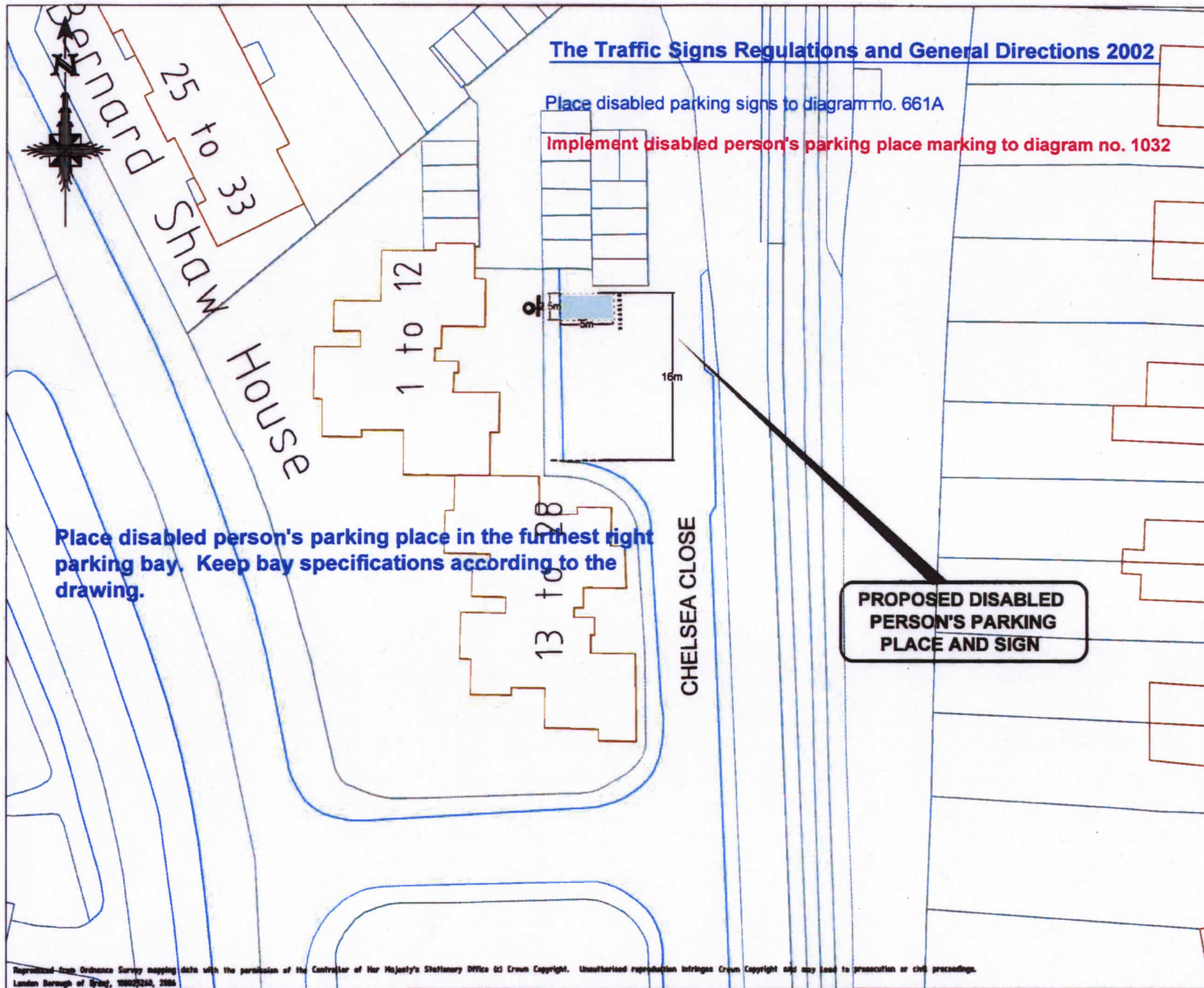

KEY



Reference Line

London Borough of Brent
Environment & Culture
Transportation Unit
Brent House, 349-357 High Road
Wembley, Middlesex, HA9 6EZ

Job Title
DISABLED PERSON'S
PARKING PLACE

Drawing Title
12 Chelsea Close
NW10 8XD

Scale	Designed EH
1:500	Drawn EH

Date created	Checked AH
28/11/11	Approved AH

Drawing No. D4785/1204	Rev.
------------------------	------

CAD Ref. S:1TG11March - September 11

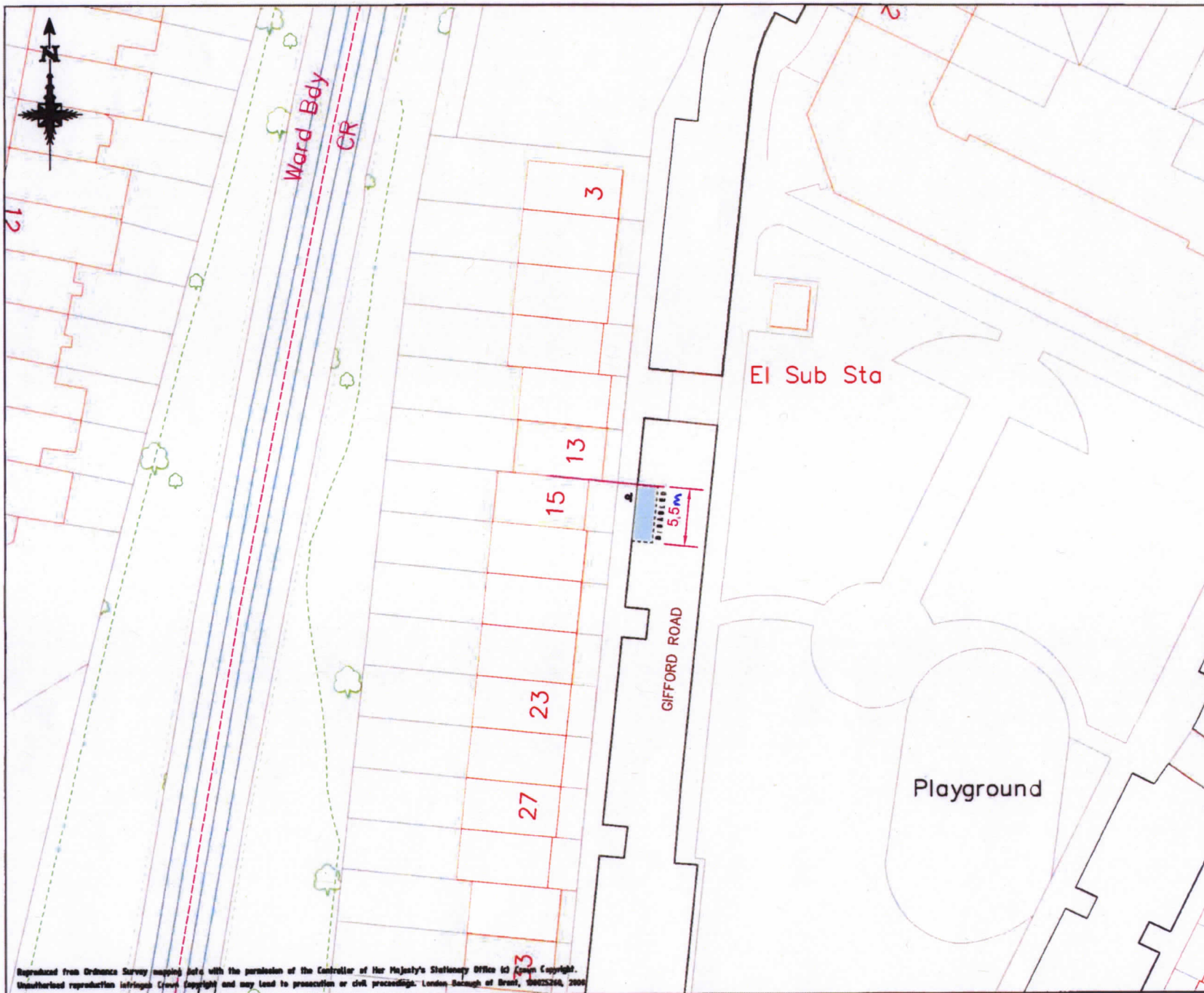

Reproduced from Ordnance Survey mapping data with the permission of the Controller of Her Majesty's Stationery Office to whom Copyright.
Unauthorized reproduction infringes Crown Copyright and may lead to prosecution or civil proceedings. London Borough of Brent, 10025260, 2000



Notes



DISABLED

--- Reference Line

Rev	Revision Note	Date

London Borough of Brent
Environment & Neighbourhood Services
Highway and Transport Delivery
Brent House, 349-357 High Road
Wembley, Middlesex, HA9 6BZ

Job Title
Disabled Person's
Parking Place

Drawing Title
15 Gifford Road NW10 9ED

Scale	A4	Designed SD
1:500		Drawn SD
Date created	Checked	
	Approved	
Drawing No.		Rev. A
CAD Ref.		

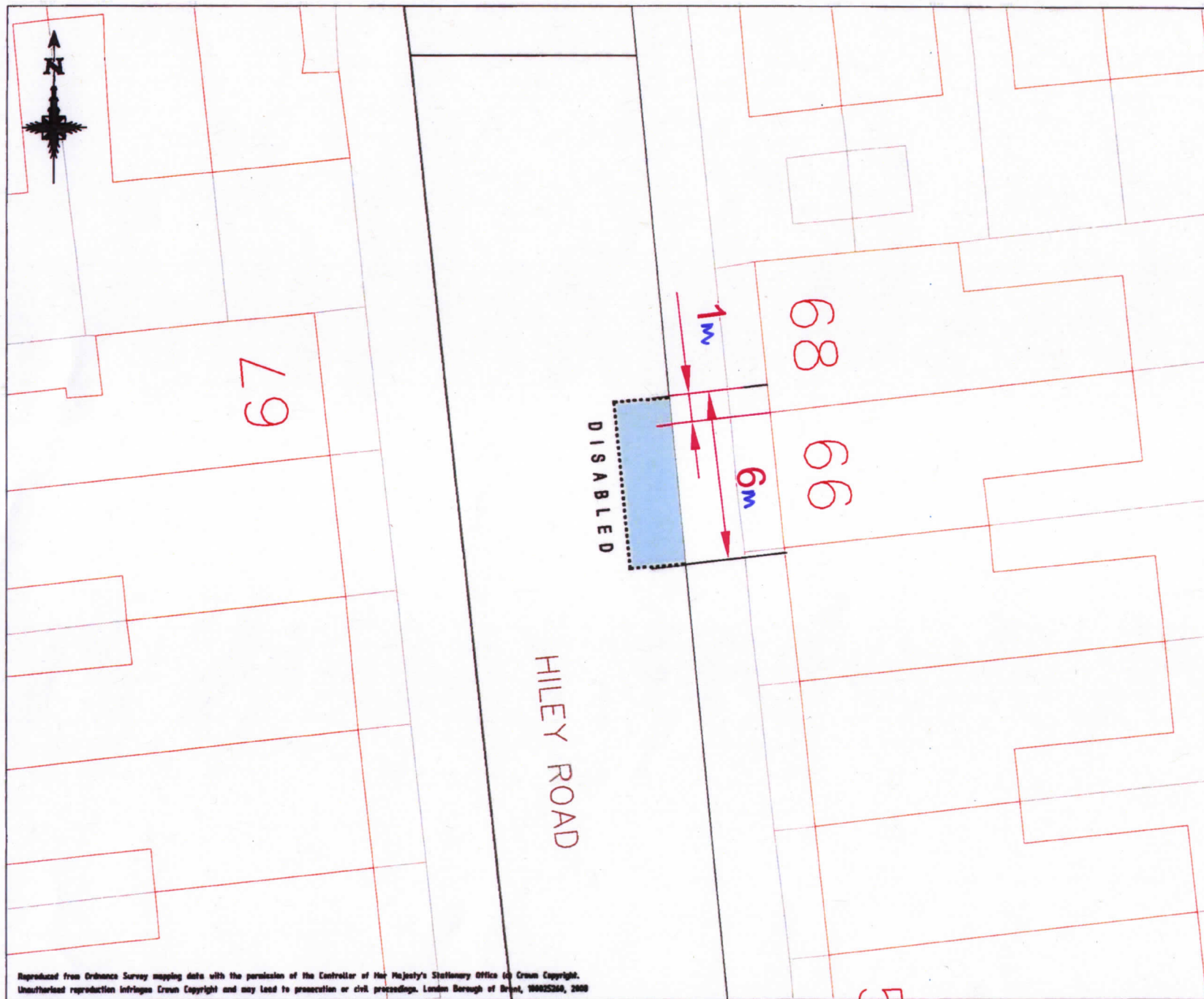

Notes



Reference Line

Rev	Revision Note	Date

London Borough of Brent
Environment & Neighbourhood Services
Highway and Transport Delivery
Brent House, 349-357 High Road
Wembley, Middlesex, HA9 6EZ

Job Title
Disabled Person's
Parking Place

Drawing Title
66 Hiley Road NW10 5PS

Scale 1:500	A4	Designed SD
		Drawn SD
Date created		Checked
		Approved

Drawing No.	Rev. A
CAD Ref.	

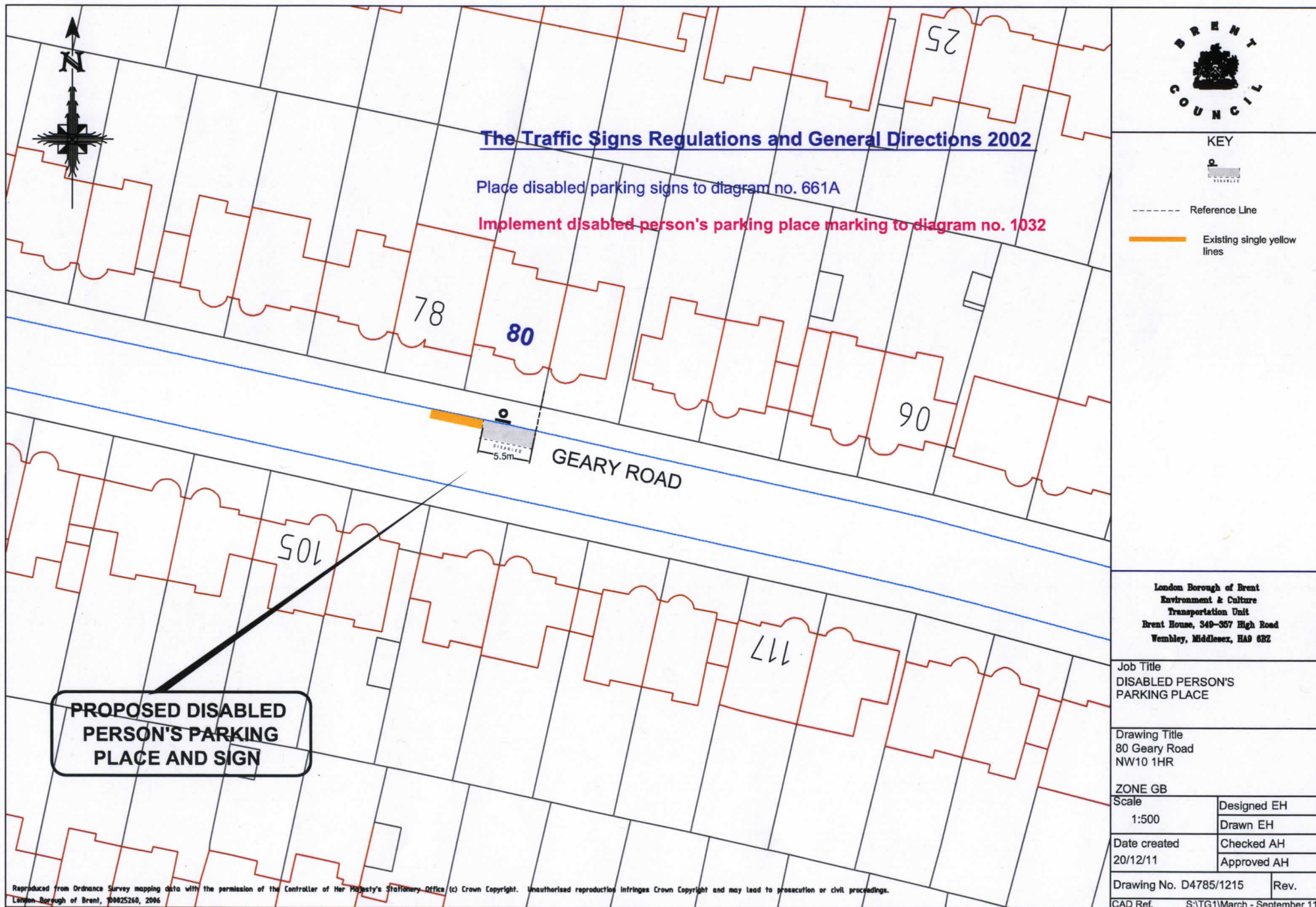

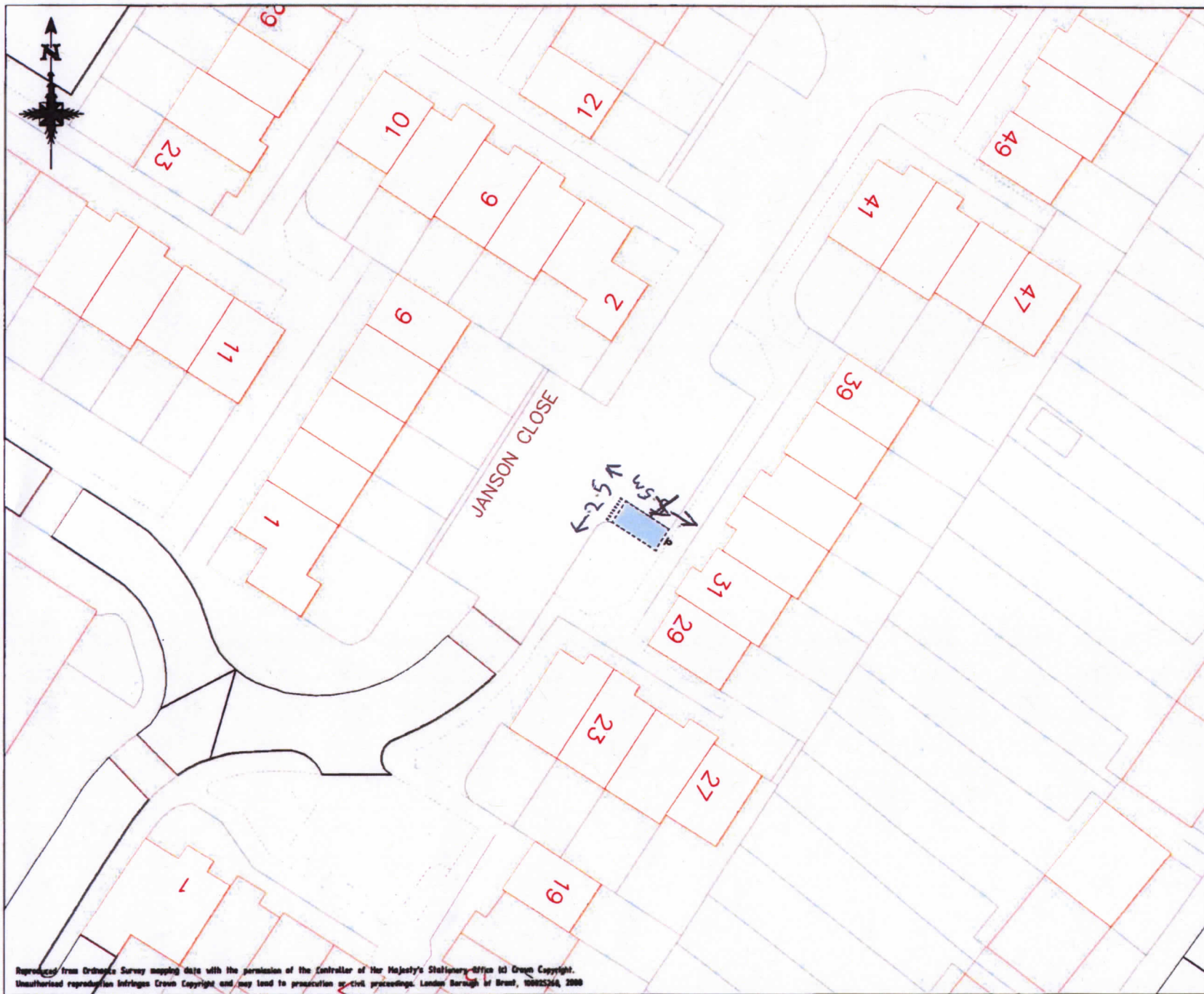

Notes



Reference Line

Rev	Revision Note	Date
1		
2		
3		
4		
5		

London Borough of Brent
Environment & Neighbourhood Services
Highway and Transport Delivery
Brent House, 349-357 High Road
Wembley, Middlesex, HA9 6BZ

Job Title
Disabled Person's
Parking Place

Drawing Title
23 Janson Close NW10 0EG

Scale	A4	Designed SD
1:500		Drawn SD
Date created	Checked EH	Approved HA

Drawing No. Rev. A

CAD Ref.