



GT50/150/0014

**ROAD TRAFFIC REGULATION ACT 1984 – SECTIONS 64 AND 65
AUTHORISATION OF TRAFFIC SIGNS AND SPECIAL DIRECTIONS**

The Secretary of State for Transport, in exercise of her powers under Sections 64 and 65 of the Road Traffic Regulation Act 1984 and of all other powers enabling her in that behalf, for the purpose of indicating parking places for disabled persons on roads for which Southampton City Council is the traffic authority, hereby:-

1. authorises the placing at the locations shown in the attached set of plans numbered GT50/150/0014-1 of a traffic sign consisting of a road marking (hereinafter referred to as “the authorised marking”) conforming as to size, colour and character with that to diagram 1028.3 in the Traffic Signs Regulations 2002 (Part I of SI 2002/3113, “the 2002 Regulations”) save that the length of the bays shall be as shown in the attached schedule numbered GT50/150/0014-2; and
2. directs that, notwithstanding the provisions of Direction 24(1) of the Traffic Signs General Directions 2002 (Part II of SI 2002/3113), the authorised marking shall only be used with the sign to diagram 661A in Schedule 2 to the 2002 Regulations; and
3. directs that it is a condition of this authorisation that the authorised marking may be placed only to indicate the effect of a corresponding Traffic Regulation Order; and



GT50/150/0014

4. directs, without prejudice to any statutory provision to the like effect, that it is a condition of this authorisation that the placing of the authorised marking on the said roads shall continue to have effect only until such day as may be appointed by one month's notice given by the Secretary of State in writing to the traffic authority for the removal or alteration of the authorised marking and on that day the said authorisation shall, without prejudice to the giving of any further authorisation or direction, cease to have effect.

The provisions of Regulations 12 and 31 of the 2002 Regulations shall apply to the authorised marking in the same manner as they apply to the road marking to diagram 1028.3 in Schedule 6 to those Regulations.

Dated 29 February 2012

Signed by authority of the Secretary of State

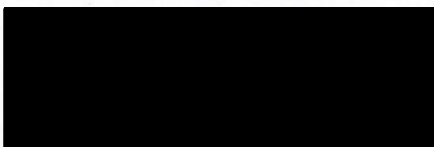
.....

A Delegated Official of the Department for Transport

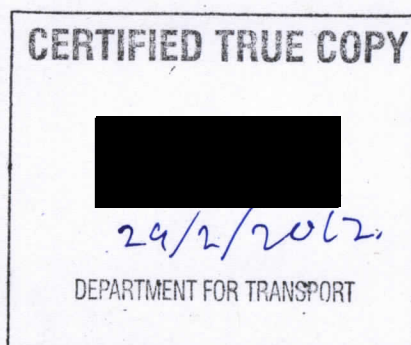

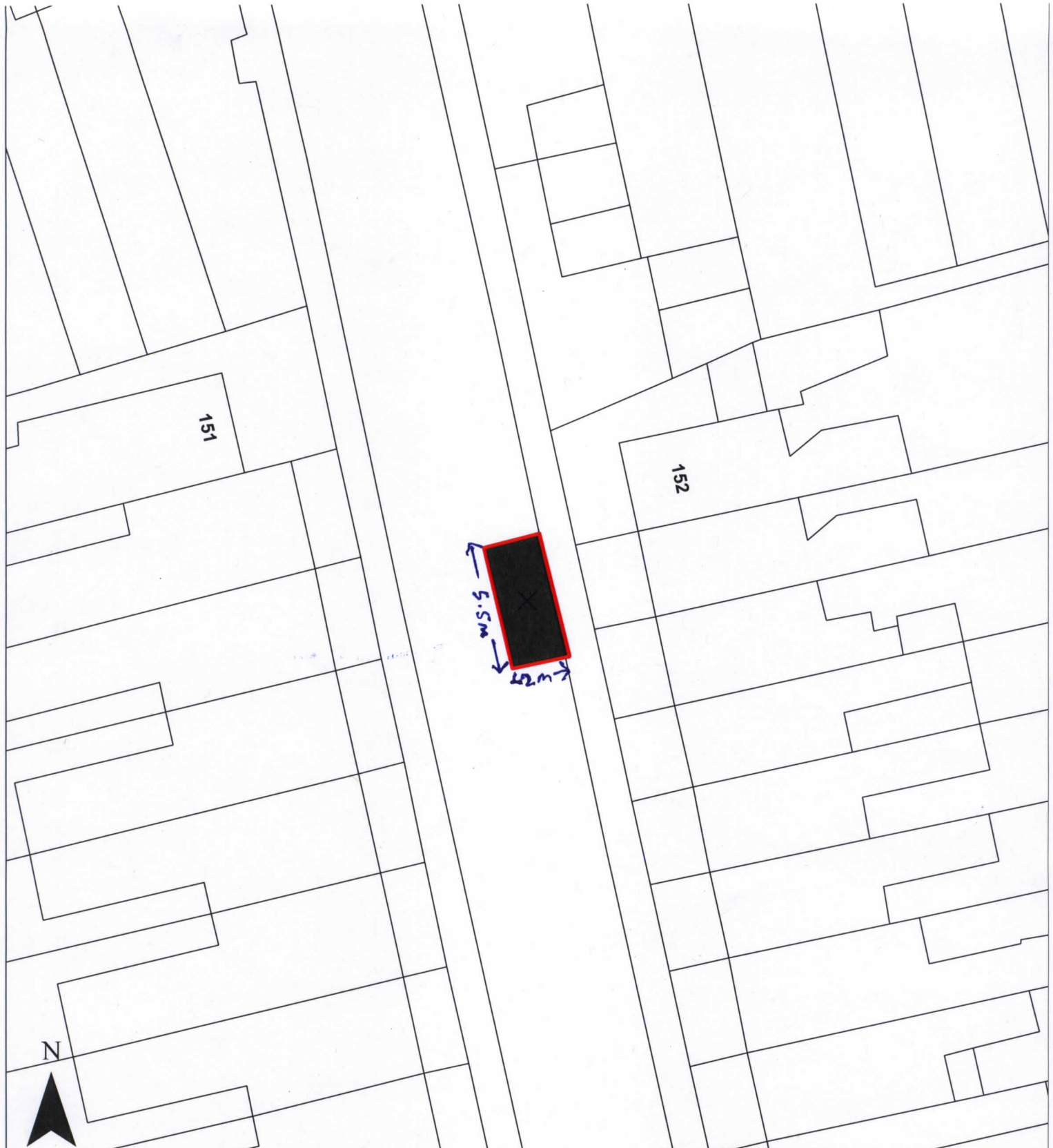

Based on the Ordnance Survey's 2010 Map with the permission of the Controller of Her Majesty's Stationery Office Crown Copyright Reserved
Unauthorised reproduction infringes Crown Copyright and may lead to prosecution of civil proceeding, Southampton City Council Licence No 100019679, 2010

Highways Service Partnership
Michael Scevity, Traffic Management
City Depot & Recycling Park
First Avenue, Millbrook
SO15 0LJ. Tel: 023 8079 8066
Mob: 07966 895206



INSTRUCTIONS:

Re-line disabled bay outside 150 Earls Road
Portswood, to .5m x 2m, as per map above

Department for Transport	
Date	27/2/2012
No.	GTSD/150/0044-1

CONFIRM NO: 102470

DATE: 19/12/2011

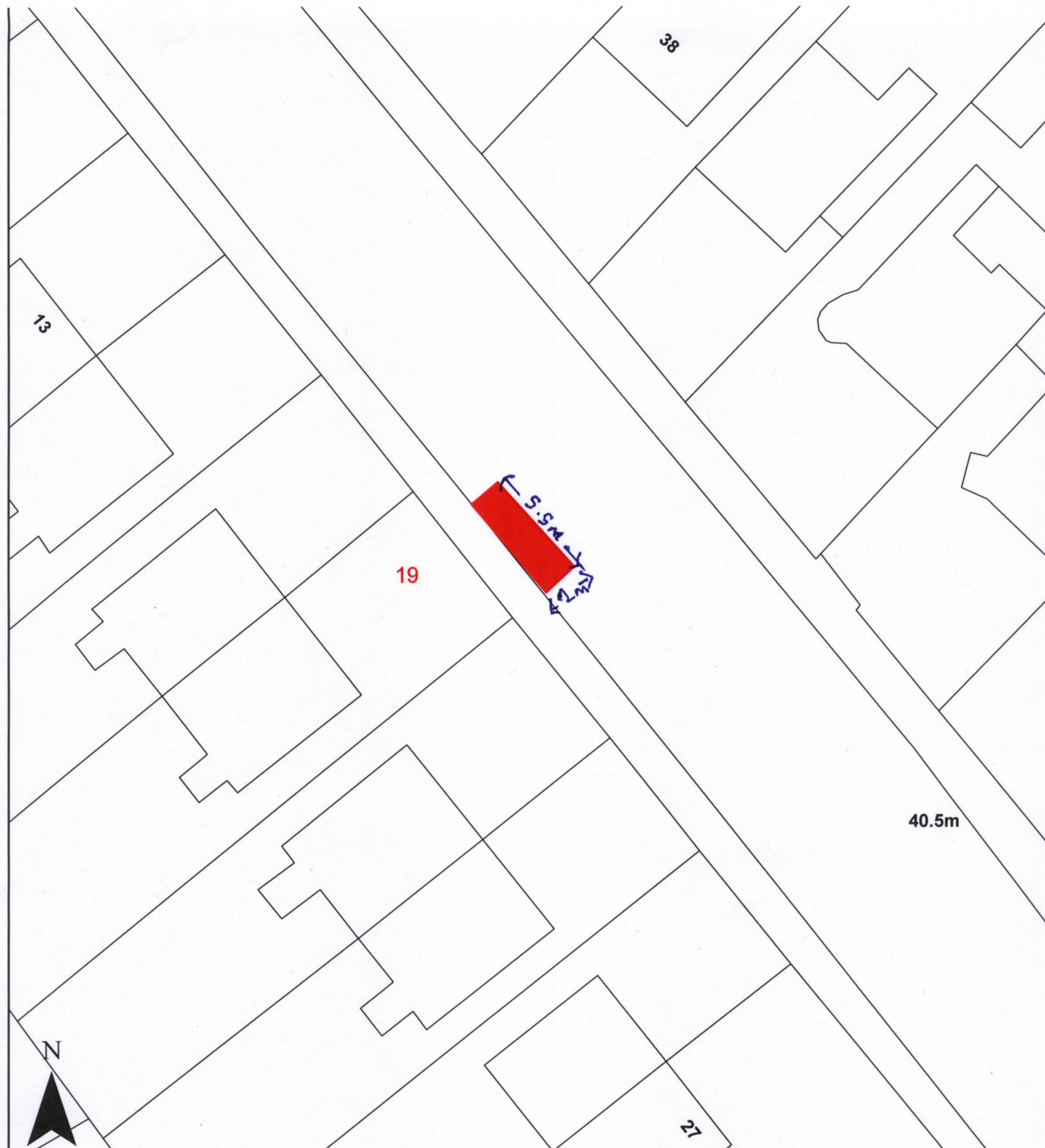

Based on the Ordnance Survey's 2010 Map with the permission of the Controller of Her Majesty's Stationery Office Crown Copyright Reserved
Unauthorised reproduction infringes Crown Copyright and may lead to prosecution of civil proceeding, Southampton City Council Licence No 100019679, 2010

Highways Service Partnership
Michael Scevity, Traffic Management
City Depot & Recycling Park
First Avenue, Millbrook
SO15 0LJ. Tel: 023 8079 8066
Mob: 07966 895206

INSTRUCTIONS:

Install disabled bay outside 19 Spring Road, Sholing
As per map above.

Affix sign to lamppost on boundary with No 21

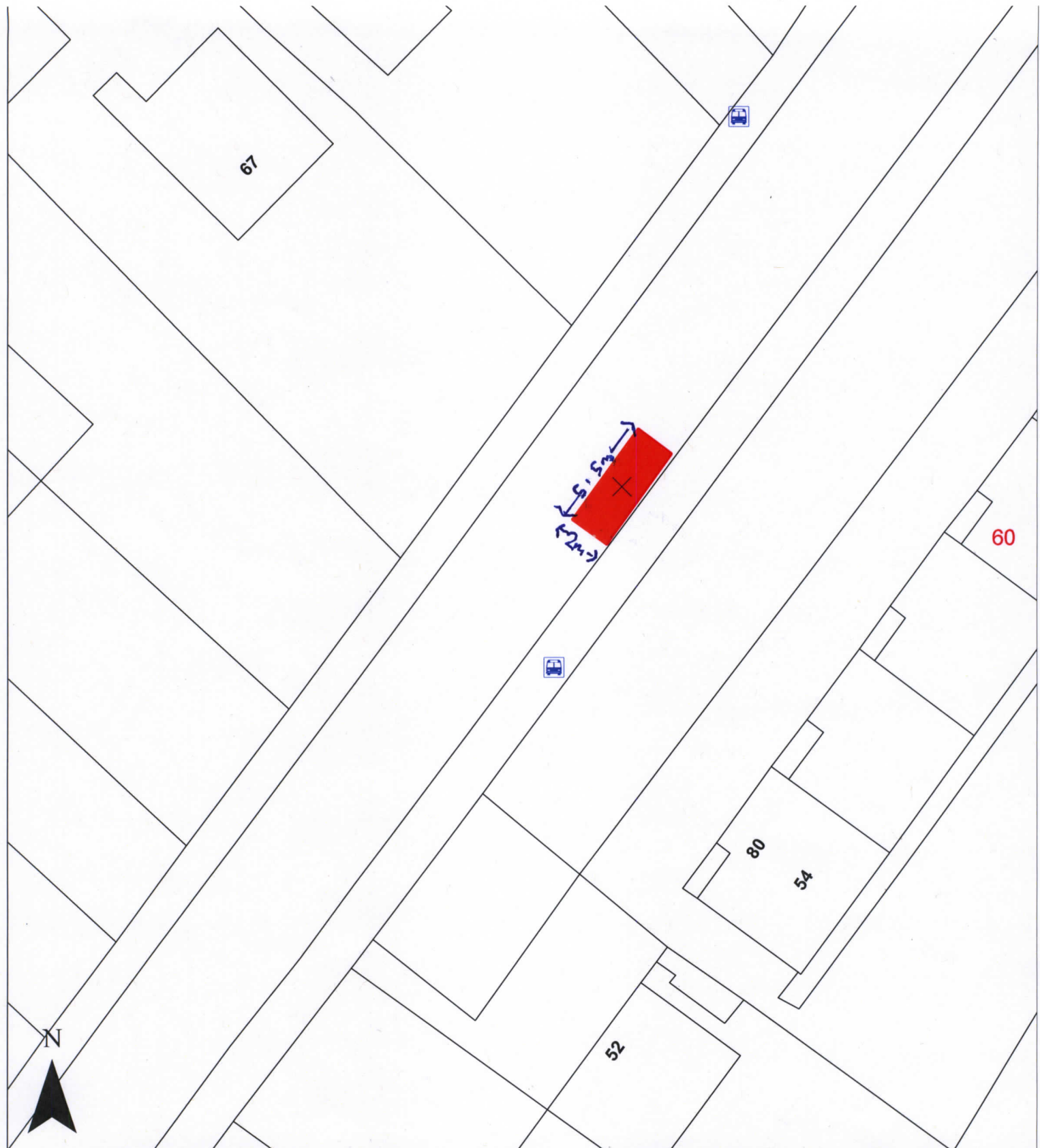

Based on the Ordnance Survey's 2010 Map with the permission of the Controller of Her Majesty's Stationery Office Crown Copyright Reserved
Unauthorised reproduction infringes Crown Copyright and may lead to prosecution of civil proceeding, Southampton City Council Licence No 100619679, 2010

Highways Service Partnership
Michael Scevity, Traffic Management
City Depot & Recycling Park
First Avenue, Millbrook
SO15 0LJ. Tel: 023 8079 8066
Mob: 07966 895206



INSTRUCTIONS:

Install disabled bay in North East Road, Sholing
for a resident at No 60.

Bay size 5.5m x 2.0m. Pole required for sign.
Start bay at end of Bus Stop Clearway on southside of North
East Road for 5.5m North East.

CONFIRM NO: 102612

DATE: 13/12/2011

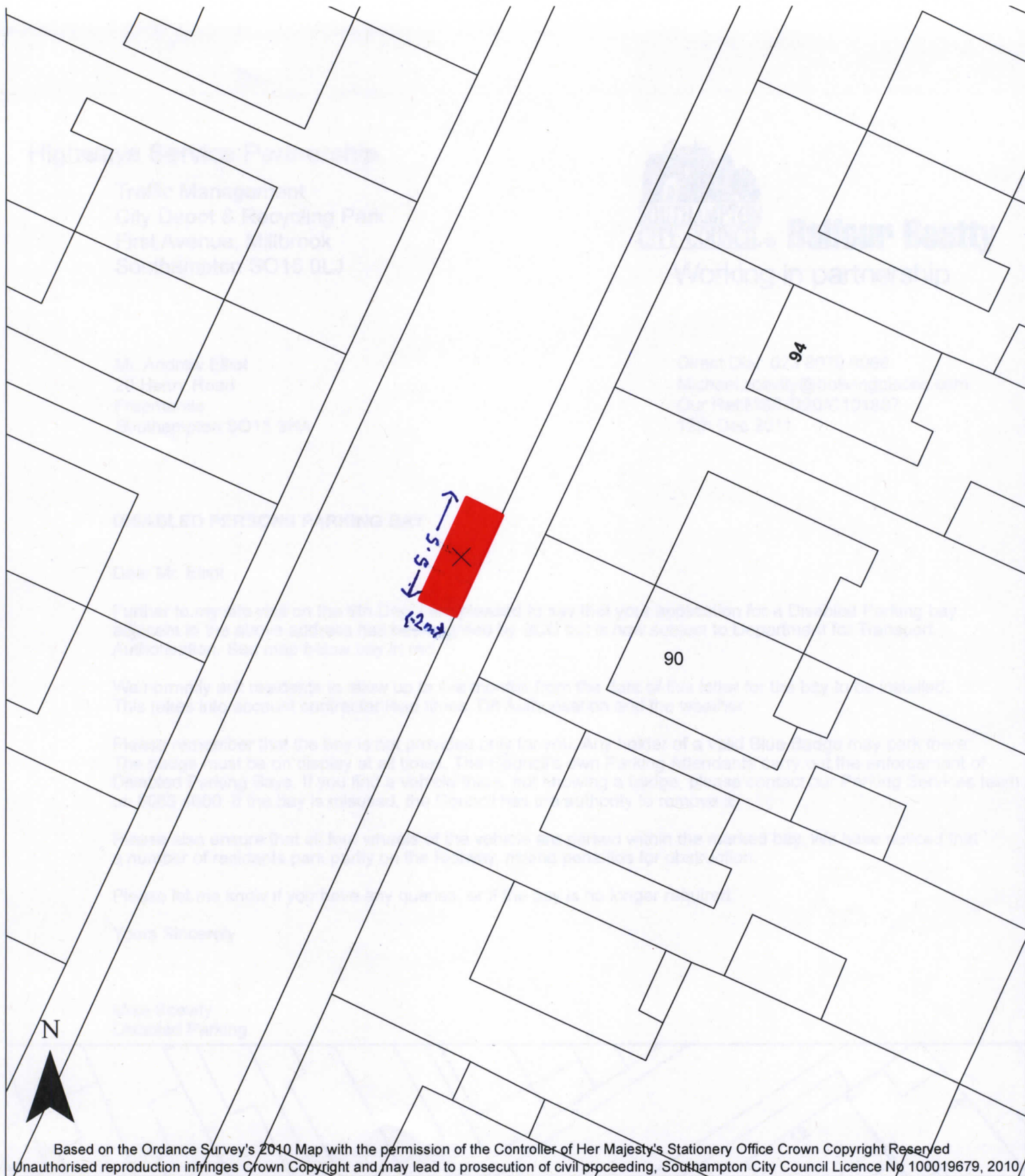

Based on the Ordnance Survey's 2010 Map with the permission of the Controller of Her Majesty's Stationery Office Crown Copyright Reserved
 Unauthorised reproduction infringes Crown Copyright and may lead to prosecution of civil proceeding, Southampton City Council Licence No 100019679, 2010/

Highways Service Partnership
 Michael Scevity, Traffic Management
 City Depot & Recycling Park
 First Avenue, Millbrook
 SO15 0LJ. Tel: 023 8079 8066
 Mob: 07966 895206

INSTRUCTIONS:

Install disabled bay outside 90 Prince of Wales Avenue,
 Regents Park.

Bay size 5.5m x 2.0m. Pole required for sign, as per map above



Balfour Beatty

Working in partnership

CONFIRM NO: 102700

DATE: 12/12/2011



GT50/150/0014-2

SCHEDULE

CITY OF SOUTHAMPTON

VARIATIONS TO DISABLED PERSONS' PARKING BAYS

Location

Variation to Dimensions

- | | |
|--|------------------|
| 1. 150 Earls Road, Bevois SO14 6TL | 5.5m L x 2.0m W. |
| 2. 19 Spring Road, Sholing SO19 2B | 5.5m L x 2.0m W. |
| 3. 60 North East Road, Sholing SO19 8AE | 5.5m L x 2.0m W. |
| 4. 90 Prince of Wales Avenue, Regents Park SO15 4 LU | 5.5m L x 2.0m W. |
| 5. 20 Henry Road, Freemantle SO15 3HA | 5.5m L x 2.0m W. |