



GT50/015/0012

**ROAD TRAFFIC REGULATION ACT 1984 – SECTIONS 64 AND 65
AUTHORISATION OF TRAFFIC SIGNS AND SPECIAL DIRECTIONS**

The Secretary of State for Transport, in exercise of her powers under Sections 64 and 65 of the Road Traffic Regulation Act 1984, and of all other powers enabling her in that behalf, for the purpose of informing road users of the conditions of a bus lane on the A4 Portway, Bristol, hereby:-

1. authorises the erection at or within 5 metres of the site indicated with a red cross in the attached set of plans numbered GT50/015/0012-1 of a traffic sign (hereinafter referred to as "the authorised sign A") conforming as to size, colour and character with that shown at A on the attached drawing numbered GT50/015/0012-2; and
2. authorises the erection at or within 5 metres of the sites indicated with a black cross in the said set of plans of a traffic sign (hereinafter referred to as "the authorised sign B") conforming as to size, colour and character with that shown at B on the said drawing; and
3. authorises the placing at or within the sites indicated with a blue cross in the said set of plans of a traffic sign consisting of a road marking (hereinafter referred to as "the authorised marking C") conforming as to size, colour and character with that shown at C on the said drawing; and
4. directs that, notwithstanding the provisions of Direction 18(3) of the Traffic Signs General Directions 2002 (Part II of SI 2002/3113, "the 2002 Directions"), the authorised sign A may be used with the road marking to diagram 1010 in Schedule 6 to the Traffic Signs Regulations 2002 (Part I of SI 2002/3113, "the 2002 Regulations") laid diagonally across the carriageway; and



GT50/015/0012

5. directs that, notwithstanding the provisions of Direction 18(3) of the 2002 Directions, the authorised sign B shall be used with the authorised marking C and with the road marking at diagram 1049 in Schedule 6 to the 2002 Regulations; and
6. directs that it is a condition of this authorisation that the authorised signs A and B and the authorised marking C may be placed only to indicate the effect of a corresponding Traffic Regulation Order; and
7. directs, without prejudice to any statutory provision to the like effect, that it is a condition of this authorisation that the erection of the authorised signs A and B and the authorised marking C at or near the said sites shall continue to have effect only until such day as may be appointed by one month's notice given by the Secretary of State in writing to the traffic authority for the removal or alteration of the authorised signs A and B and the authorised marking C and on that day the said authorisation shall, without prejudice to the giving of any further authorisation or direction, cease to have effect.

The provisions of Regulations 12, 18 and 19 of the 2002 Regulations shall apply to the authorised sign A in the same manner as they apply to the sign to diagram 958 in Schedule 5 to those Regulations.

The provisions of Regulations 12, 18 and 19 of the 2002 Regulations shall apply to the authorised sign B in the same manner as they apply to the sign to diagram 959 in Schedule 5 to those Regulations.



GT50/015/0012

The provisions of Regulations 12, 18 and 19 of the 2002 Regulations shall apply to the authorised marking C in the same manner as they apply to diagram 1048 in Schedule 6 to those Regulations

Dated *28 March* 2012

Signed by authority of the Secretary of State

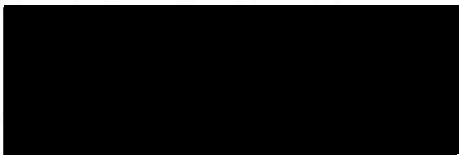
.....

A Delegated Official of the Department for Transport



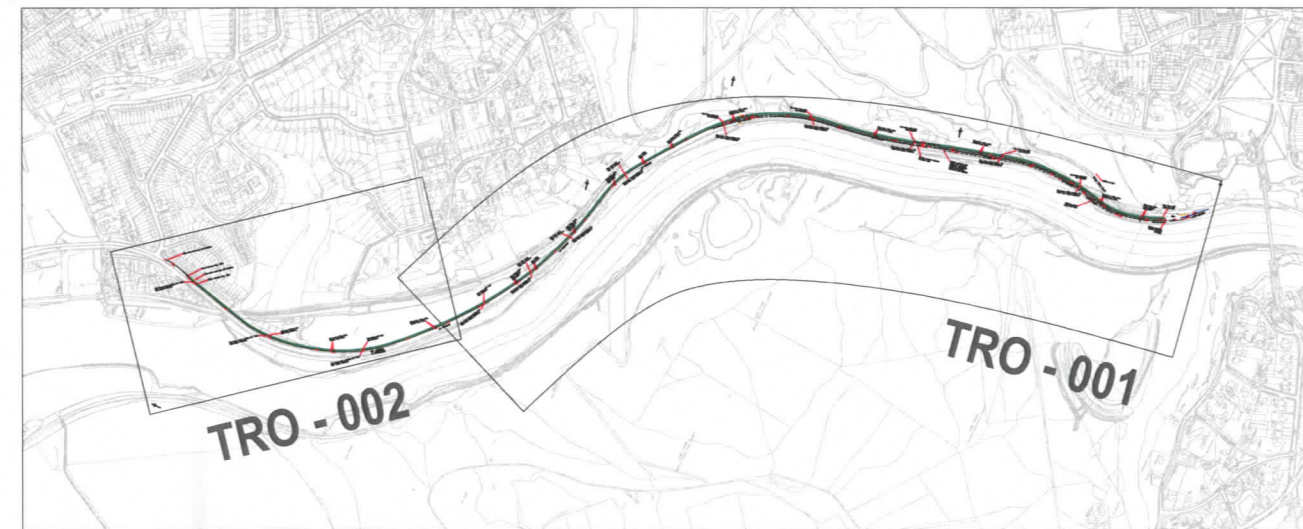

- Key to TRO
- Bus Lane renewed & extended
 - Anti skid surfacing
 - Advance stop for cyclists

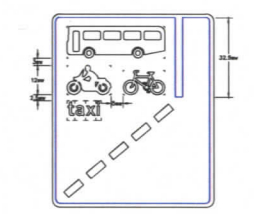

Scheme Ref. NP 958.4	
Sign Ref. BUS2	Sign Ref. BUS2
Letter colour white	Sign face
Background BLUE	Width 1237mm
Border white	Height 1460mm
Material Class Ref 2 (12889-1-2001)	Area 1.8sq.m.

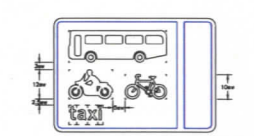

Scheme Ref. NP 958.4	
Sign Ref. BUS2	Sign Ref. BUS2
Letter colour white	Sign face
Background BLUE	Width 1237mm
Border white	Height 870mm
Material Class Ref 2 (12889-1-2001)	Area 1.07sq.m.

**BUS
LANE**

**BRISTOL
CITY COUNCIL**

**BRISTOL
ENGINEERING
CONSULTANCY**

Kings House, Bond Street, Bristol BS1 3AE

Tel: 0117 9222000 Fax: 0117 9222060/9223765
E-mail: engineering_consultancy@bristol-city.gov.uk

Rev.	Date	Description	By
F	26/03/12	Sign name amended	HMD
E	20/12/11	Sign locations amended	HMD
D	29/08/08	Sign sizes amended	GDL
C	13/08/08	Road marking and sign locations amended	GDL
B	11/06/08	Road markings amended	GDL
A	25/03/08	Sign details added	GDL

Project
A4 Portway Bus Lane

Title
**A4 Portway Bus Lane
Traffic Regulation Order Plan
Sheet 2 of 2**

Client
Public Transport

Project Manager
Mike McNamara
Telephone Number
0117 922 3124

Scale
1:1250 @ A1
Checked by
HMD
Date Issued
Dec 2011

Drawn by
HMD
Date Drawn
Dec 2011

STATUS

☒ Preliminary ☐ Tender ☐ Construction ☐ As Built

DRAWING NUMBER

Project Number
DG0284

Drawing
-TRO/002-

Revision
F

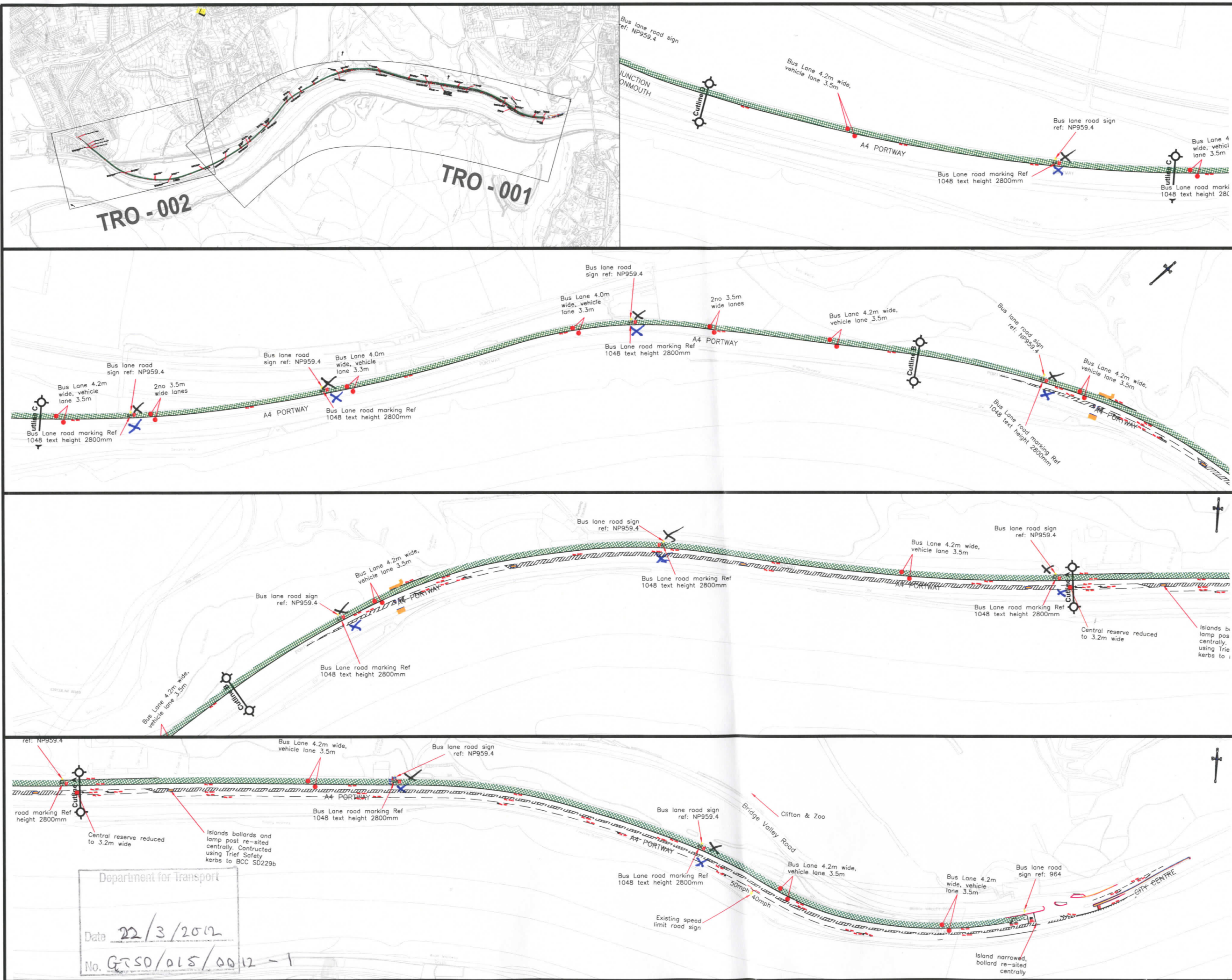

Key to TRO

- Bus Lane renewed & extended
- Anti skid surfacing
- Advance stop for cyclists

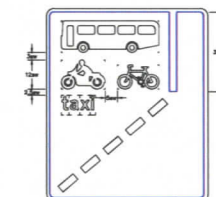

Scheme Ref: NP 959.4	Sign Ref: NP 959.4	Sign Size: 750
Letter colour: WHITE	Sign FACE: BLUE	Width: 1237mm
Background: BLUE	Height: 1400mm	Material: Class Ref 2 (2899-1-2007) Area: 1.84sqm

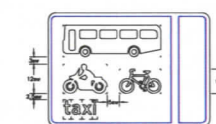

Scheme Ref: NP 959.4	Sign Ref: NP 959.4	Sign Size: 750
Letter colour: WHITE	Sign FACE: BLUE	Width: 1237mm
Background: BLUE	Height: 1400mm	Material: Class Ref 2 (2899-1-2007) Area: 1.84sqm

**BUS
LANE**

**BRISTOL
ENGINEERING
CONSULTANCY**

Kings House, Bond Street, Bristol BS1 3AE

Tel: 0117 9222000 Fax: 0117 9222060/9223765
E-mail: engineering_consultancy@bristol-city.gov.uk

Rev.	Date	Description	By
E	20/12/11	Sign locations amended.	HMD
D	03/09/08	Sign sizes amended.	GDL
C	13/08/08	Road marking and sign locations amended.	GDL
B	11/06/08	Road markings amended.	GDL
A	25/03/08	Sign details added.	GDL

Project
A4 Portway Bus Lane

Title
**A4 Portway Bus Lane
Traffic Regulation Order Plan
Sheet 1 of 2**

Client
Public Transport

Project Manager Mike McNamara	Scale 1:1250 @ A1
Telephone Number 0117 922 3124	Checked by
Drawn by HMD	Date issued
Date Drawn Dec 2011	Issued by

STATUS
☒ Preliminary ☐ Tender ☐ Construction ☐ As Built

DRAWING NUMBER

Project Number
DG0284

Drawing
-TRO/001-

Revision
E

Department for Transport
Date **22/3/2012**
No. **GTSO/015/0012-1**



BRISTOL ENGINEERING CONSULTANCY

Kings House, Bond Street, Bristol BS1 3AE

Tel: 0117 9222000 Fax: 0117 9223765
E-mail: engineering.consultancy@bristol.gov.uk

'This map is reproduced from Ordnance Survey material with permission of Ordnance Survey on behalf of the Controller of Her Majesty's Stationary Office (c) Crown copyright. Unauthorised reproductions infringes Crown copyright and may lead to prosecution or civil proceedings. Bristol City Council, Licence No. 100023406.'

Project

A4 Portway Bus Lane Bus Lane Extension

Title

Bus Lane Sign and Legend Details

Client

Public Transport

Project Manager

Mike McNamara

Telephone Number

0117 9223124

Drawn by

HMD

Date Drawn

10/01/12

Scale

N.T.S

Checked by

Date Issued

10/01/12

Issued by

STATUS

☐ Preliminary ☐ Tender ☐ Construction ☐ As Built

DRAWING NUMBER

Project Number

DG0284

Drawing

011

Revision

A

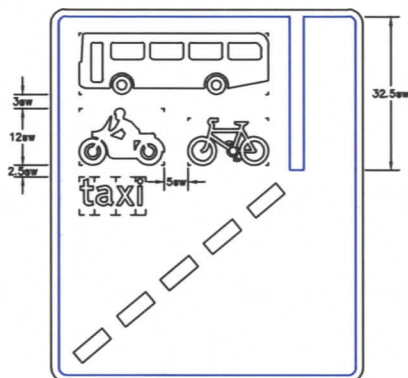

Scheme Ref. NP 958.4			
Sign	Ref. BUS2	x-height	75.0
Letter colour	WHITE	SIGN FACE	
Background	BLUE	Width	1237mm
Border	WHITE	Height	1485mm
Material	Class Ref 2 (12899-1:2001)	Area	1.84sq.m

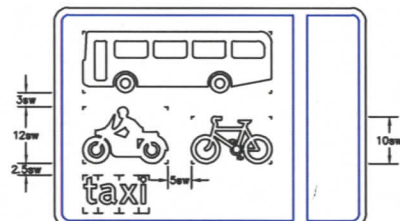

Scheme Ref. NP 959.4			
Sign	Ref. BUS1	x-height	75.0
Letter colour	WHITE	SIGN FACE	
Background	BLUE	Width	1237mm
Border	WHITE	Height	870mm
Material	Class Ref 2 (12899-1:2001)	Area	1.07sq.m

BUS LANE

