



**ROAD TRAFFIC REGULATION ACT 1984 - SECTION 64**  
**AUTHORISATION OF TRAFFIC SIGNS**

The Secretary of State for Transport, in exercise of her powers under Section 64 of the Road Traffic Regulation Act 1984, and of all other powers enabling her in that behalf, for the purpose of informing road users of a lane available for Official Olympic Vehicles and buses southbound on the M4 Heathrow Airport Spur Road; hereby:-

1. authorises the erection at or within 5 metres of the site shown by a green cross in the set of plans numbered GT50/162/0006-1 of a traffic sign (hereinafter referred as the "the authorised sign A") conforming as to size, colour and character with that shown, with two alternate faces, on the attached drawing numbered GT50/162/0006-2; and
2. authorises the erection at or within 5 metres of the sites shown by blue crosses in the said set of plans of a traffic sign (hereinafter referred as the "the authorised sign B") conforming as to size, colour and character with that shown, with two alternate faces, on the attached drawing numbered GT50/162/0006-3; and
3. specifies that it is a condition of this authorisation that the authorised signs A and B may be placed only to indicate the effect of The M4 Motorway (Junctions 1-4A) (Temporary Restriction and Prohibition of Traffic) Order 2012; and



4. specifies, without prejudice to any statutory provisions to the like effect, that it is a condition of this authorisation that the erection of the authorised signs A and B at or near the said sites shall continue to have effect only until such day as may be appointed by one month's notice given by the Secretary of State in writing to the traffic authority for the removal or alteration of the authorised signs A and B and on that day the said authorisation shall, without prejudice to the giving of any further authorisation or direction, cease to have effect; and
5. specifies that, notwithstanding anything to the contrary contained in the preceding paragraph the authorised signs shall be retained for no later than 9 October 2013 .

The provisions of Regulations 12, 18 and 19 of The Traffic Signs Regulations 2002 (Part I of SI 2002/3113) shall apply to the authorised signs A and B in the same manner as they apply to the sign shown in diagram 2904.1 in Schedule 7 to those Regulations.

Dated..... 2 March ..... 2012

Signed by authority of the Secretary of State

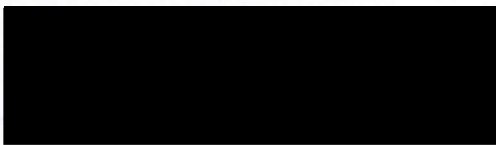

A Delegated Official of the Department for Transport

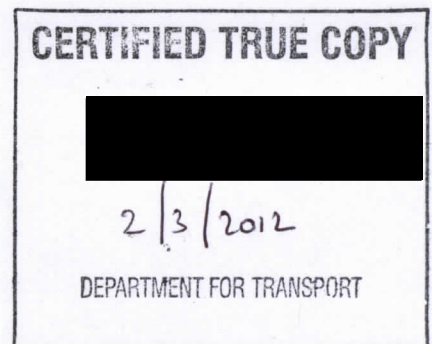



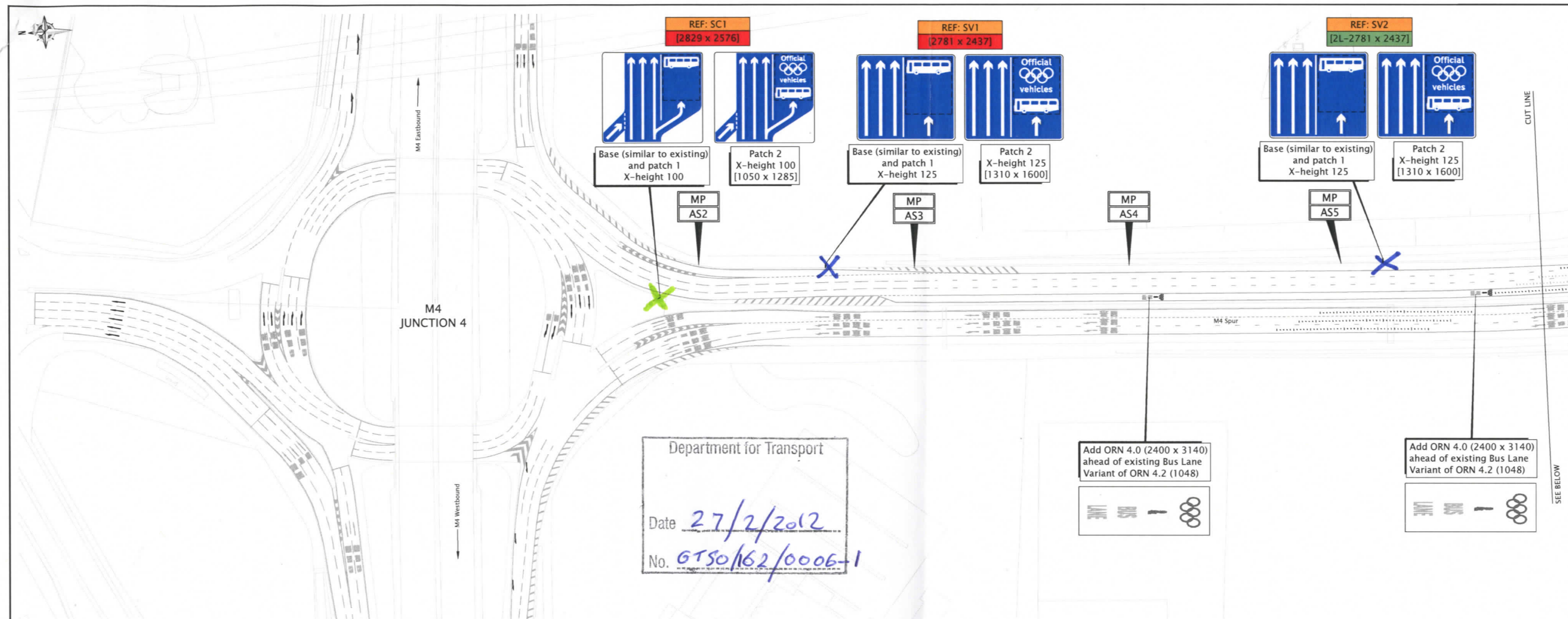

REFERENCE:  
Do not scale from this drawing, use stated dimensions only.

Reproduced by permission of Ordnance Survey on behalf of HMSO.  
© Crown copyright and database right 2009. All rights reserved.  
Ordnance Survey Licence number 100018928.

Location plan

Key:

REF: SCx Existing sign - Central Reserve  
REF: SVx Existing sign - NS Verge  
REF: SCx Proposed sign - Central Reserve  
REF: SVx Proposed sign - NS Verge  
REF: SGx Proposed sign - Gantry

REF: SPCx Existing posts - Central Reserve (with or without sign plate)  
REF: SPVx Existing posts - NS Verge (with or without sign plate)

[xL-1970 x 1950]  
Illuminated sign (x=no. of lanterns)  
Dimensions refer to proposed sign  
If Green < existing sign area  
If Red > existing sign area

Notes:

- Proposed signs based upon ORN Traffic Signs and markings Design Guide or DfT authorisation GT50/162/0002.
- Remove 5no. existing signs for recycling. (signs SC1 & SV1-4).

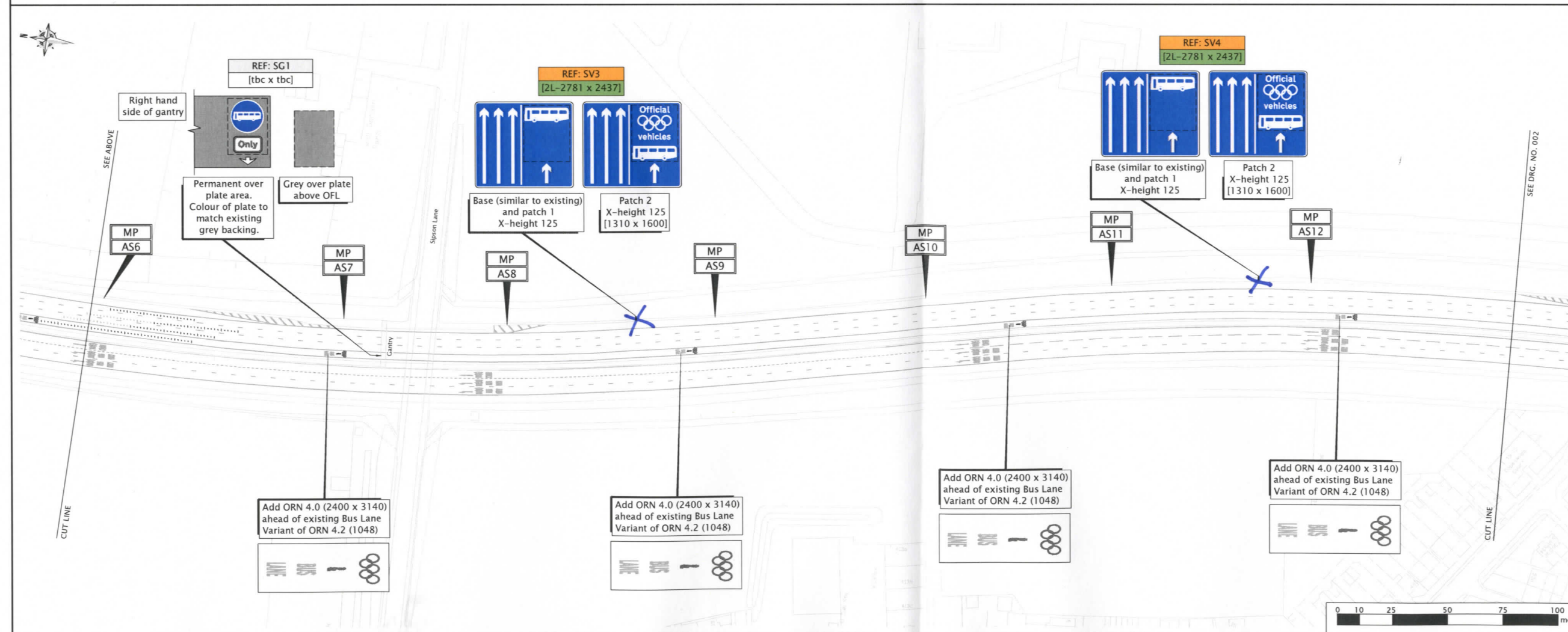

Notes:

- Proposed signs based upon ORN Traffic Signs and markings Design Guide or DfT authorisation GT50/162/0002.
- Remove 5no. existing signs for recycling. (signs SC1 & SV1-4).

REV	DESCRIPTION	SIGNED	DATE
A	NPS application set	JDW	14/02/12
REV	DESCRIPTION	MYH	14/02/12

AGENT

Connect Plus  
Connect Plus Services  
Connect Plus House  
St Albans Road  
South Mimms  
Potters Bar  
Hertfordshire  
EN6 3NP  
Tel: 020 3386 8500  
Fax: 020 3386 8501

CLIENT

HIGHWAYS AGENCY

PROJECT

M4 Junction 4 to Junction 4a  
Olympic Family Lane

TITLE

Proposed Signs and Road Markings

Sheet 1 of 2

SCALE: 1:1000

DRAWING No: IMP/519184/OFL/009

REV: A

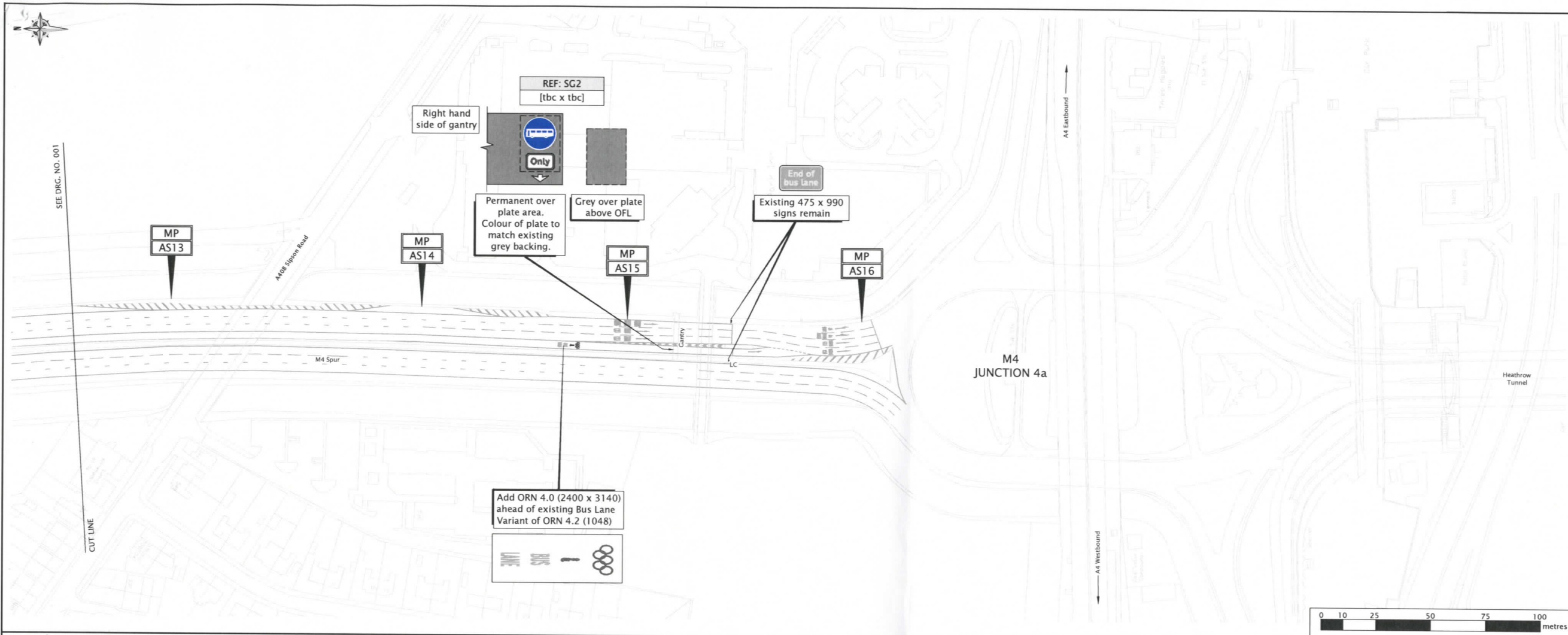

REFERENCE:  
Do not scale from this drawing, use stated dimensions only

Reproduced by permission of Ordnance Survey on behalf of HMSO.  
© Crown copyright and database right 2009. All rights reserved.  
Ordnance Survey Licence number 100018928.

Location plan

Key.

REF: SCx	Existing sign - Central Reserve
REF: SVx	Existing sign - NS Verge
REF: SCx	Proposed sign - Central Reserve
REF: SVx	Proposed sign - NS Verge
REF: SGx	Proposed sign - Gantry
REF: SPCx	Existing posts - Central Reserve (with or without sign plate)
REF: SPVx	Existing posts - NS Verge (with or without sign plate)

[xL-1970 x 1950]  
Illuminated sign (x=no. of lanterns) Dimensions refer to proposed sign

If Green < existing sign area  
If Red > existing sign area

Notes.

- Proposed signs based upon ORN Traffic Signs and markings Design Guide or DfT authorisation GT50/162/0002.
- Remove 5no. existing signs for recycling. (signs SC1 & SV1-4).

A	NPS application set	JDW/14/02/12
REV	DESCRIPTION	SIGNED/DATE

	SIGNED	DATE
DRAWN:	NBH	14/02/12
DESIGN:	JDW	14/02/12
CHECKED:	JDW	14/02/12
APPROVED:	JDW	14/02/12

AGENT

**Connect Plus**

Connect Plus Services  
Connect Plus House  
St Albans Road  
South Mimms  
Potters Bar  
Hertfordshire  
EN6 3NP  
Tel: 020 3386 8500  
Fax: 020 3386 8501

CLIENT

**HA HIGHWAYS AGENCY**

PROJECT

M4 Junction 4 to Junction 4a  
Olympic Family Lane

TITLE

Proposed Signs and  
Road Markings

Sheet 2 of 2

SCALE:	1:1000	A1
DRAWING No:	IMP/519184/OFL/010	REV:
		A



# PRE & POST GAMES

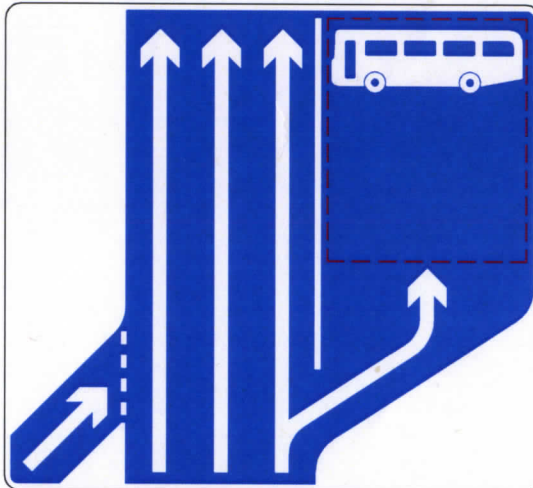

Client Name LAFARGE CONTRACTING		
Sign Reference Y882/SC1	x-height	100.0
Letter colour WHITE	Single Sided	
Background BLUE	Width	2829mm
Border WHITE	Height	2576mm
Material Class RA2 (12899-1:2007)	Area	7.29sq.m
Radius corner 7	Quantity	1
Number of bars	Channel bars	MEDIUM
Metal	Layout	Dispatch

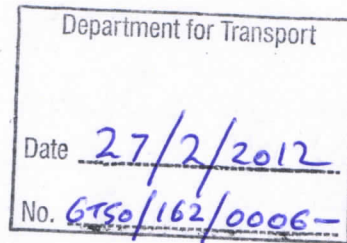

## SELF-ADHESIVE OVERLAY

Client Name LAFARGE CONTRACTING		
Sign Reference Y882/SC1 Overlay	x-height	100.0
Letter colour WHITE	Single Sided	
Background BLUE	Width	1050mm
Border N/A	Height	1285mm
Material Class RA2 (12899-1:2007)	Area	1.35sq.m
Radius corner N/A	Quantity	1
Number of bars N/A	Channel bars	N/A
Metal	Layout	Dispatch

# GAMES DURATION



Aluminium

Channel

Rivets

Black

White

Yellow

Red

Blue

Green

Brown

Grey

P.O.F.

Plate Material

Reverse Colour

Approved By

Date

Drawn Date

09/02/2012 08:52:09

Please ensure that all sign details, including dimensions, are checked thoroughly before approving these designs as we may have intentionally altered your requested signface layouts and/or dimensions to be more compliant with the guidelines laid out in the TSRGD 2002 and Chapter 7 of the Traffic Signs Manual 2003.

# PRE & POST GAMES

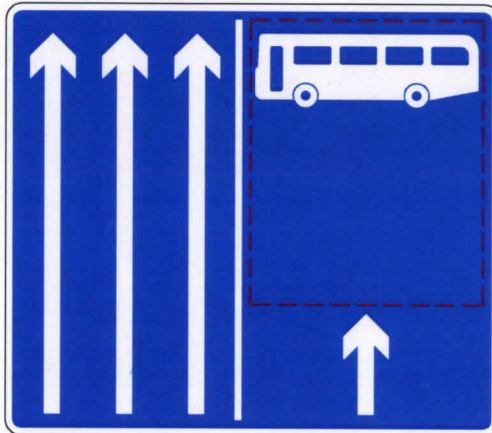

Client Name	LAFARGE CONTRACTING
Sign Reference	Y882/SV2
Letter colour	WHITE
Background	BLUE
Border	WHITE
Material	Class RA2 (12899-1:2007)
Radius corner	TEMPLATE XHT
Number of bars	Channel bars
Metal	Layout
x-height	125.0
Single Sided	
Width	2781mm
Height	2437mm
Area	6.78sq.m
Quantity	1
Medium	
Dispatch	

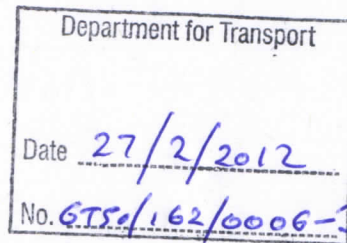

Client Name	LAFARGE CONTRACTING
Sign Reference	Y882/SV2 Overlay
Letter colour	WHITE
Background	BLUE
Border	N/A
Material	Class RA2 (12899-1:2007)
Radius corner	N/A
Number of bars	N/A
Metal	Layout
x-height	125.0
Single Sided	
Width	1310mm
Height	1600mm
Area	2.10sq.m
Quantity	1
Medium	
Dispatch	

## SELF-ADHESIVE OVERLAY

# GAMES DURATION

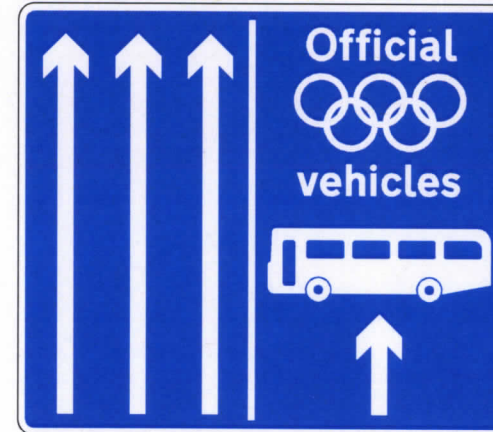

Aluminium

Channel

Rivets

Black

White

Yellow

Red

Blue

Green

Brown

Grey

P.O.F.

Plate Material

Reverse Colour

Approved By

Date

Drawn Date

09/02/2012 08:52:37

Please ensure that all sign details, including dimensions, are checked thoroughly before approving these designs as we may have intentionally altered your requested signface layouts and/or dimensions to be more compliant with the guidelines laid out in the TSRGD 2002 and Chapter 7 of the Traffic Signs Manual 2003.