



GT50/004/0006

**ROAD TRAFFIC REGULATION ACT 1984 – SECTIONS 64 AND 65
AUTHORISATION OF TRAFFIC SIGNS AND SPECIAL DIRECTIONS**

The Secretary of State for Transport, in exercise of her powers under Sections 64 and 65 of the Road Traffic Regulation Act 1984, and of all other powers enabling her in that behalf, for the purpose of indicating to cyclists a route across a signal controlled junction at Dame Alice Street and Harpur Street in Bedford, hereby:-

1. authorises the placing at the site highlighted in yellow on the attached plan numbered GT50/004/0006-1 of a road marking (hereinafter referred to as "the authorised marking") conforming as to size, colour and character with that shown on the attached drawing WBM (R) 294, save that the authorised marking may be reflectorised; and
2. directs, without prejudice to any statutory provision to the like effect, that it is a condition of this authorisation that the placing of the authorised marking, at or near the said site shall continue to have effect only until such day as may be appointed by one month's notice given by the Secretary of State in writing to the traffic authority for the removal or alteration of the authorised marking and on that day the said authorisation shall, without prejudice to the giving of any further authorisation or direction, cease to have effect.



GT50/004/0006

The provisions of Regulation 12 of the Traffic Signs Regulations 2002 (SI 2002/3113) shall apply to the authorised marking in the same manner as they apply to the road marking shown in diagram 1003.3 in Schedule 6 to those Regulations.

Dated.....8 May.....2012

Signed by authority of the Secretary of State



A Delegated Official of the Department for Transport

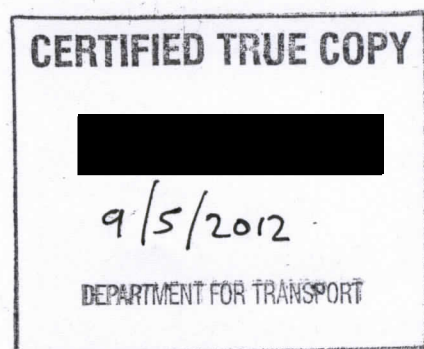

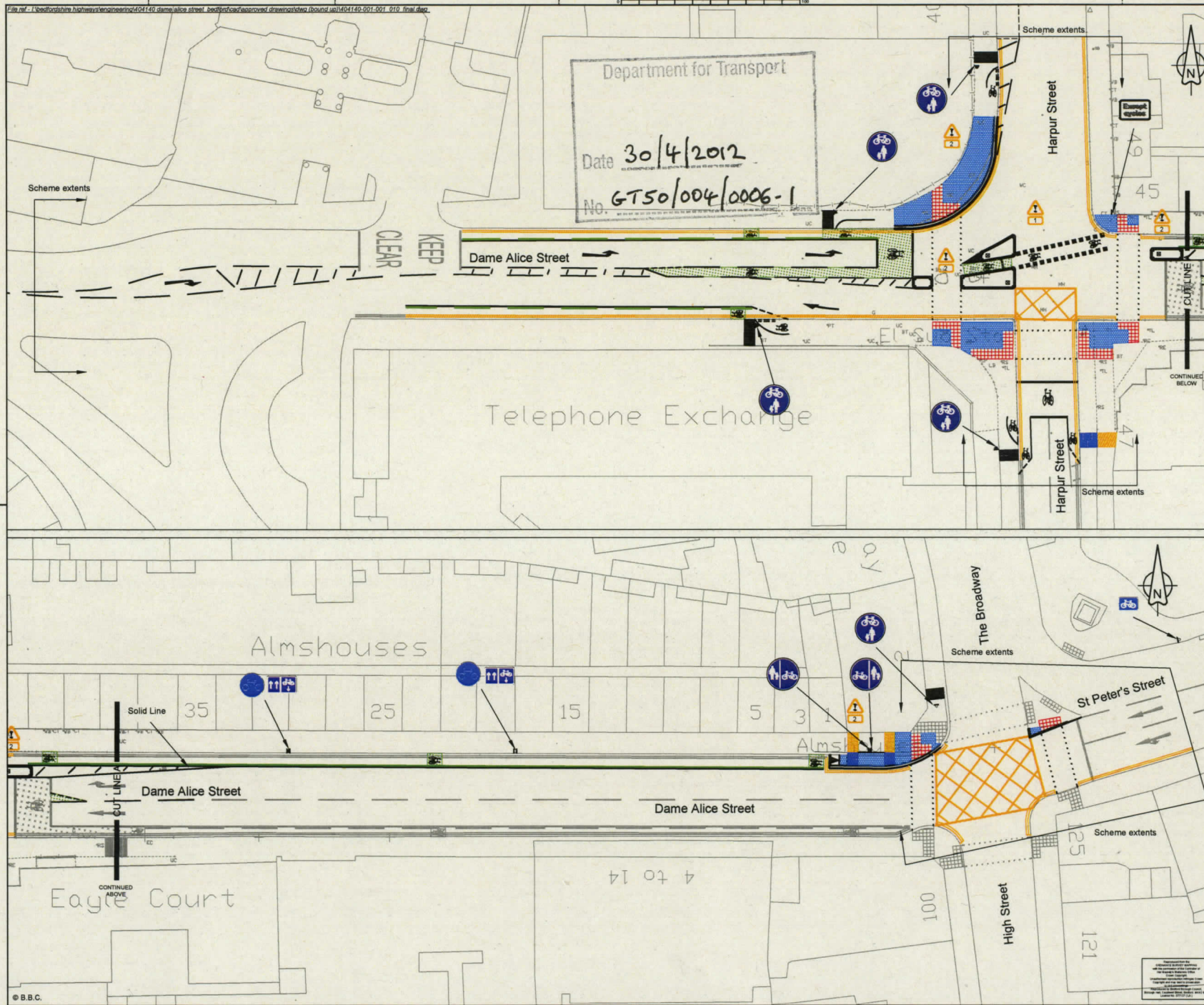

RESIDUAL DESIGN HAZARDS
(The following information has been collected from Preconstruction Information and Arvey Process PLC-H&S-201 - Hazard Management for Designers.)
1. 11kV cable.
2. Lifting operations.

- KEY:**
- PROPOSED 400x400x65mm RED COLOUR TACTILE PAVING
 - PROPOSED 400x400x65mm CORDUROY TACTILE PAVING
 - PROPOSED KERBS
 - EXISTING ROAD MARKINGS TO REMAIN UNDISTURBED
 - EXISTING YELLOW COLOUR ROAD MARKINGS TO BE RENEWED
 - PROPOSED WHITE COLOUR ROAD MARKINGS
 - PROPOSED SIGN AND POST
 - PROPOSED RETROREFLECTIVE BOLLARD
 - PROPOSED GREEN COLOUR SURFACING WITHIN CYCLE LANES
 - GREEN SURFACING TO BE PROVIDED ALONG THE EDGE OF CYCLE LANE MARKINGS
 - NEW FOOTWAY SURFACING TO MATCH EXISTING
 - PROPOSED 400x400x65mm LADDER TACTILE PAVING
 - PROPOSED 400x400x65mm TRAMLINE TACTILE PAVING

A	Minor changes	NOL	NOL	30/03/11
Rev	Revision details	Chief	Appd	Date
Drawn	PB			Preliminary
Design	PB			For comment
Chief	SL/CH			For tender
Appd	NOL			For construction
Date	15/11/2010			As constructed
				Other



Client
Bedford Borough Council

Project Name
Dame Alice Street, Bedford

Drawing Title
**BH - Transportation
General Arrangements**

Original Drawing Size: A1
Scale: 1:200
Dimensions:

Drawing No: **404140-001-001**
Rev: **A**

Drwg. No.

WBM (R) 294

NOTES:-

1. © CROWN COPYRIGHT. This drawing must NOT be reproduced. Further copies may be obtained from the Department of Transport, (Traffic Signs drawing office).
2. The markings shall be white.
3. All dimensions are given in millimetres.

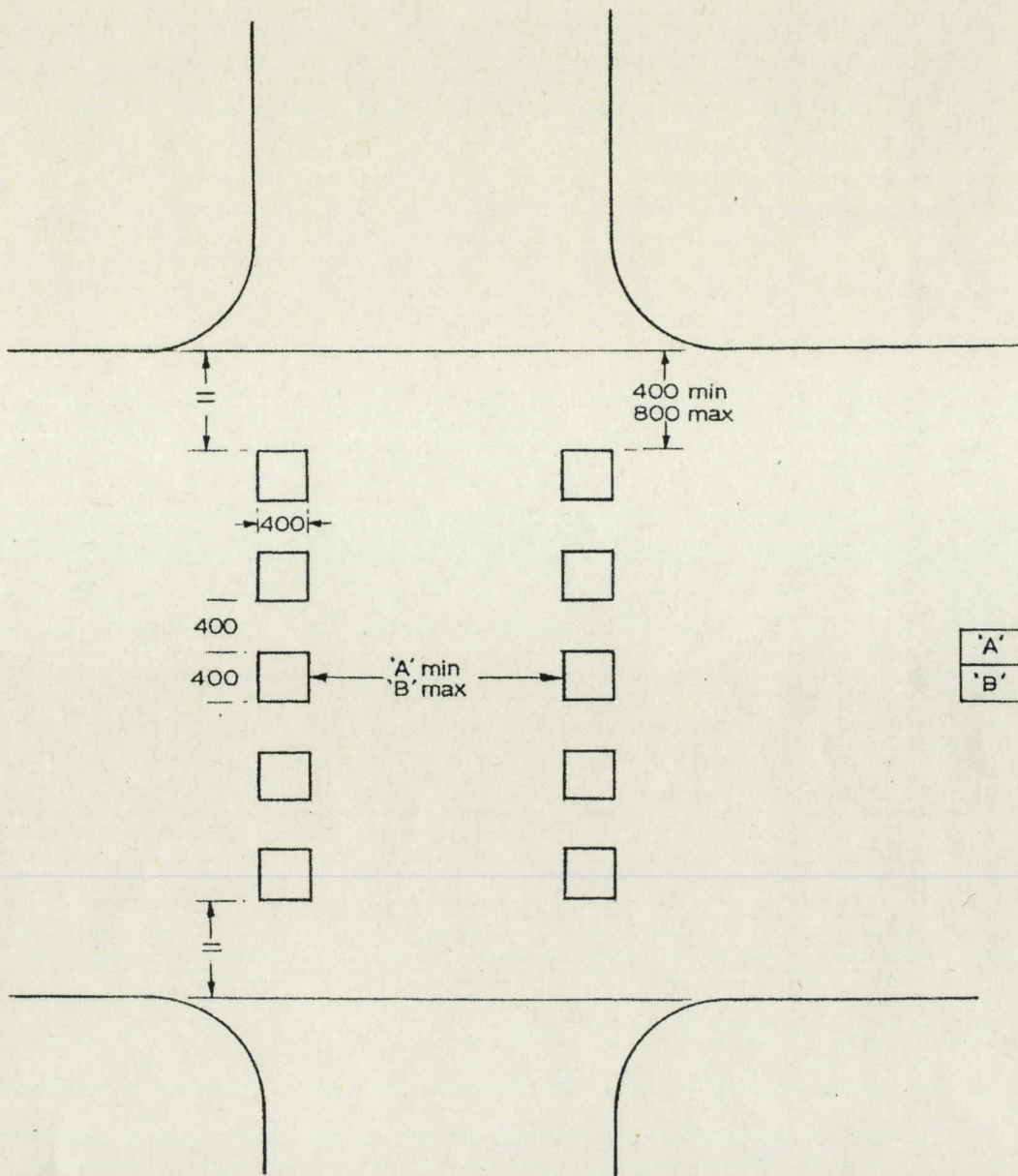

REVISIONS

1.	Regional Authorisation (R) added.	6-8-1

Before using this drawing, confirm with Traff Eng.Division that it has not been superseded.

Drn: S.P. Appd: W. J. C

Chkd: - Appl. date: 16.11.11

Issue: 6-8-87

Scale: PHOTO-REDUCED

Title: Road Markings
CYCLE LANE
CROSSING

DEPARTMENT OF TRANSPORT

Drwg. No.

WBM (R) 294