



ROAD TRAFFIC REGULATION ACT 1984 - SECTIONS 64 AND 65

AUTHORISATION OF TRAFFIC SIGNS AND SPECIAL DIRECTIONS

The Secretary of State for Transport, in exercise of his powers under Sections 64 and 65 of the Road Traffic Regulation Act 1984, and of all other powers enabling him in that behalf, for the purpose of informing road users that they are entering the Nidderdale Area of Outstanding Natural Beauty in North Yorkshire, hereby:-

1. authorises the erection within the vicinity of the sites marked with a black cross in the attached set of plans numbered GT50/113/0009-1 of a traffic sign (hereinafter referred to as "the authorised sign A") conforming as to size, colour and character with the sign shown at A in the attached set of drawings numbered GT50/113/0009-2; and
2. authorises the erection within the vicinity of the site marked with a green cross in the said set of plans of a traffic sign (hereinafter referred to as "the authorised sign B") confirming as to size, colour and character with the sign shown at B in the said set of drawings; and
3. directs, without prejudice to any statutory provision to the like effect, that it is a condition of this authorisation that the erection of the authorised signs A and B at or near the said sites shall continue to have effect only until such day as may be appointed by one month's notice given by the Secretary of State in writing to the traffic authority for the removal or alteration of the authorised signs and on that day the said authorisation shall, without prejudice to the giving of any further authorisation or direction, cease to have effect.



Department
for Transport

GT50/113/0009

The provisions of Regulations 12, 18 and 19 of the Traffic Signs Regulations 2002 (Part I of SI 2002/3113) shall apply to the authorised signs A and B in the same manner as they apply to the sign shown in diagram 2403.1 in Schedule 7 to those Regulations.

This authorisation replaces the one issued by this office under reference GT46/12/24 on 3 March 2006 which is hereby revoked.

Dated 15 November 2012

Signed by authority of the Secretary of State

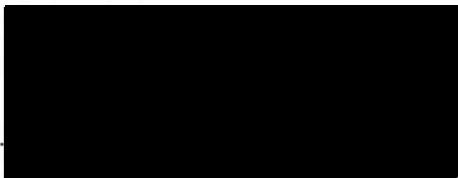

.....
A Delegated Official of the Department for Transport

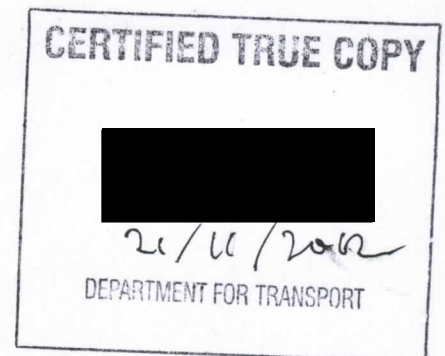

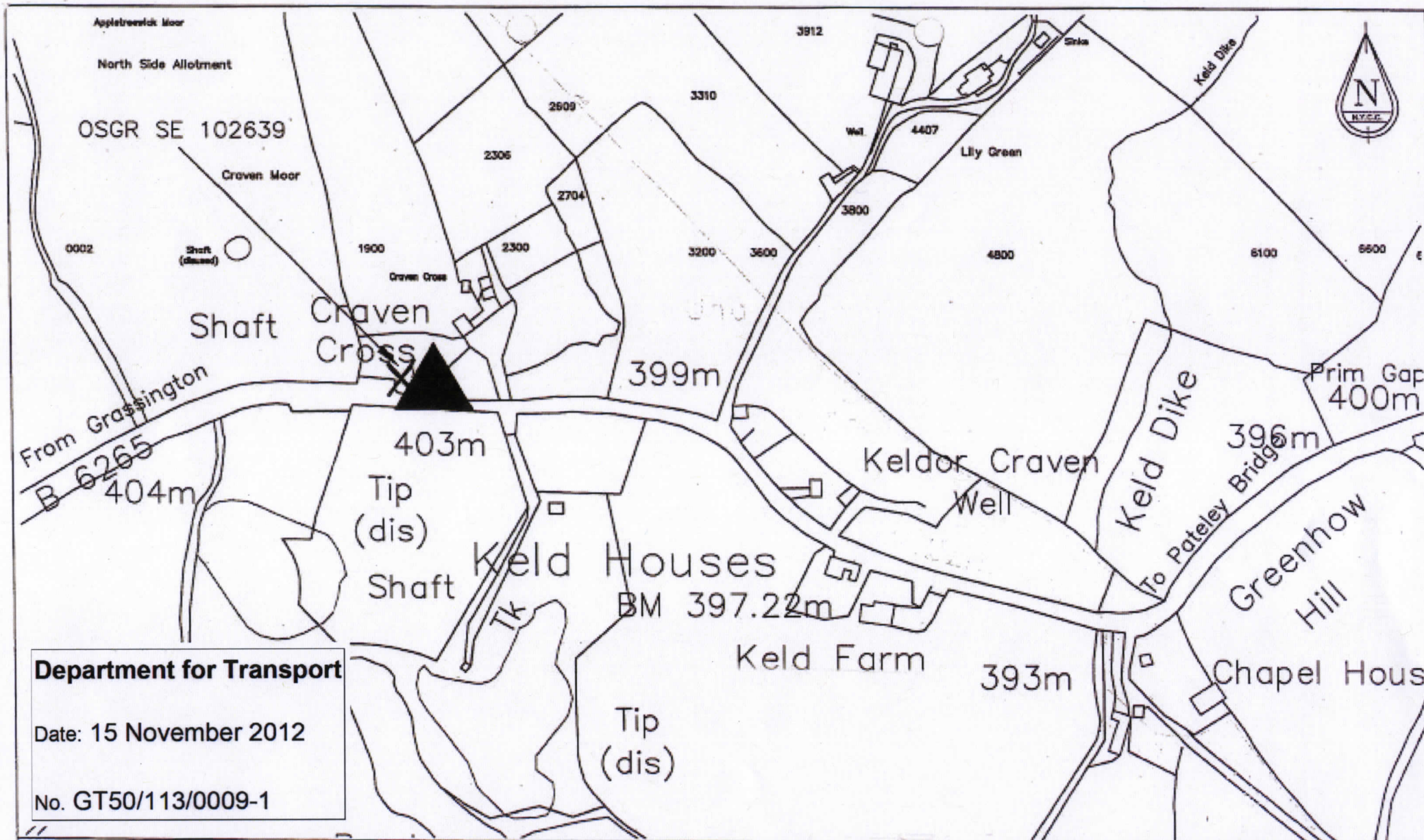

Department for Transport

Date: 15 November 2012

No. GT50/113/0009-1



North Yorkshire County Council
 Environmental Services
 Director: M O Moore OBE CEng FICE FIHT DMS



PROJECT:

Nidderdale AONB Boundary Signs

DRAWING TITLE:

Greenhow Village – Location for Sign A2

AREA: 3 DIVISION: 6

DATE: 20/01/05

SCALE: 1/2500

DRAWING NO.: 1287/A2



North Yorkshire County Council
 Environmental Services
 Director: M O Moore OBE CEEng FICE FIHT DMS

highways
 NORTH YORKSHIRE

PROJECT:

Nidderdale AONB Boundary Signs

DRAWING TITLE:

Pace Gate – Location for Sign B1

AREA: 3 DIVISION: 6

DATE: 20/01/05

SCALE: 1/2500

DRAWING NO.: 1287/B1

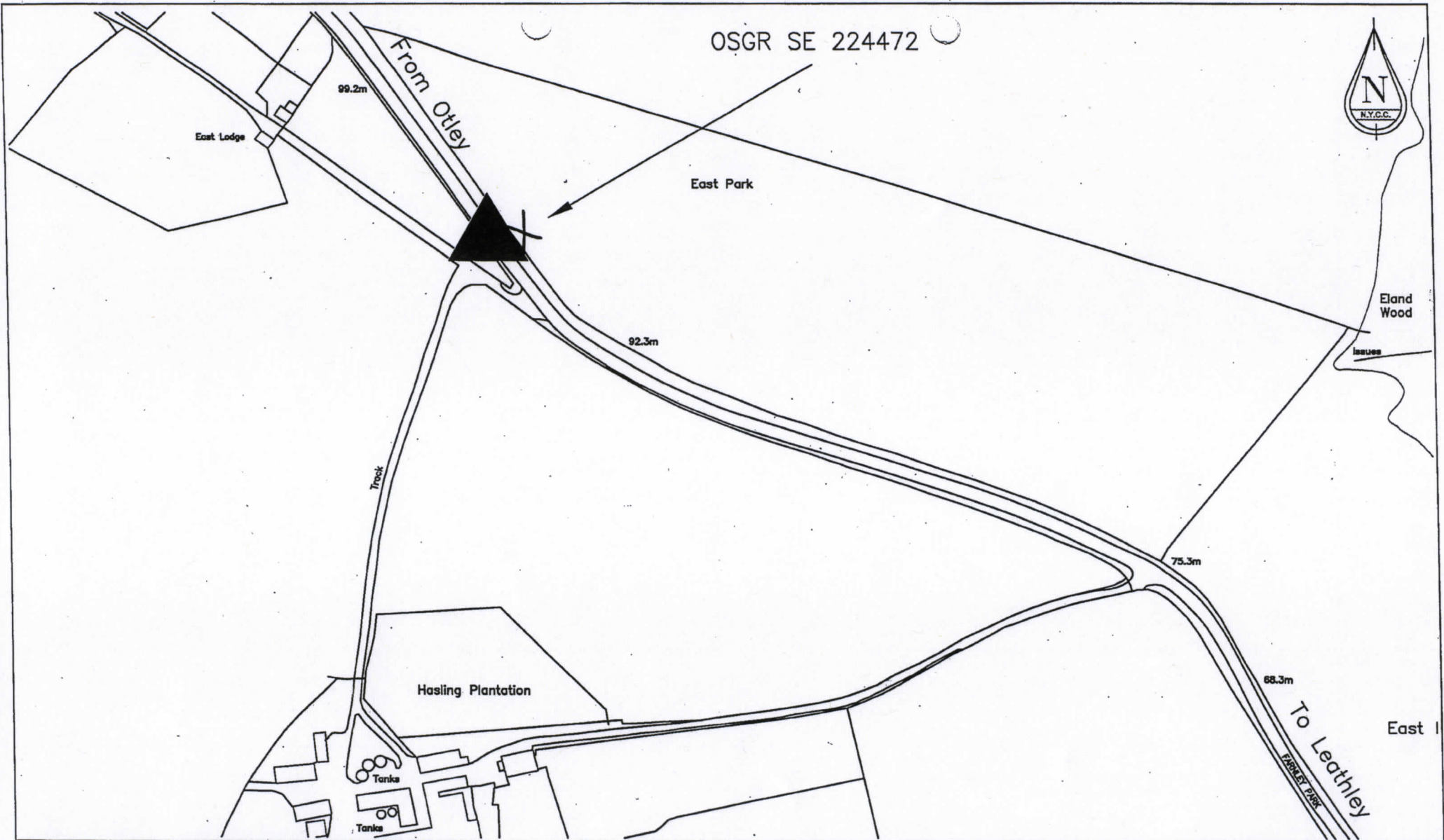

North Yorkshire County Council
 Environmental Services
 Director: M O Moore OBE CEng FICE FIHT DMS

highways
 NORTH YORKSHIRE

PROJECT:

Nidderdale AONB Boundary Signs

DRAWING TITLE:

Farnley Park – Location for Sign D1

AREA: 3 DIVISION: 6

DATE: 20/01/05

SCALE: 1/2500

DRAWING NO.: 1287/D1

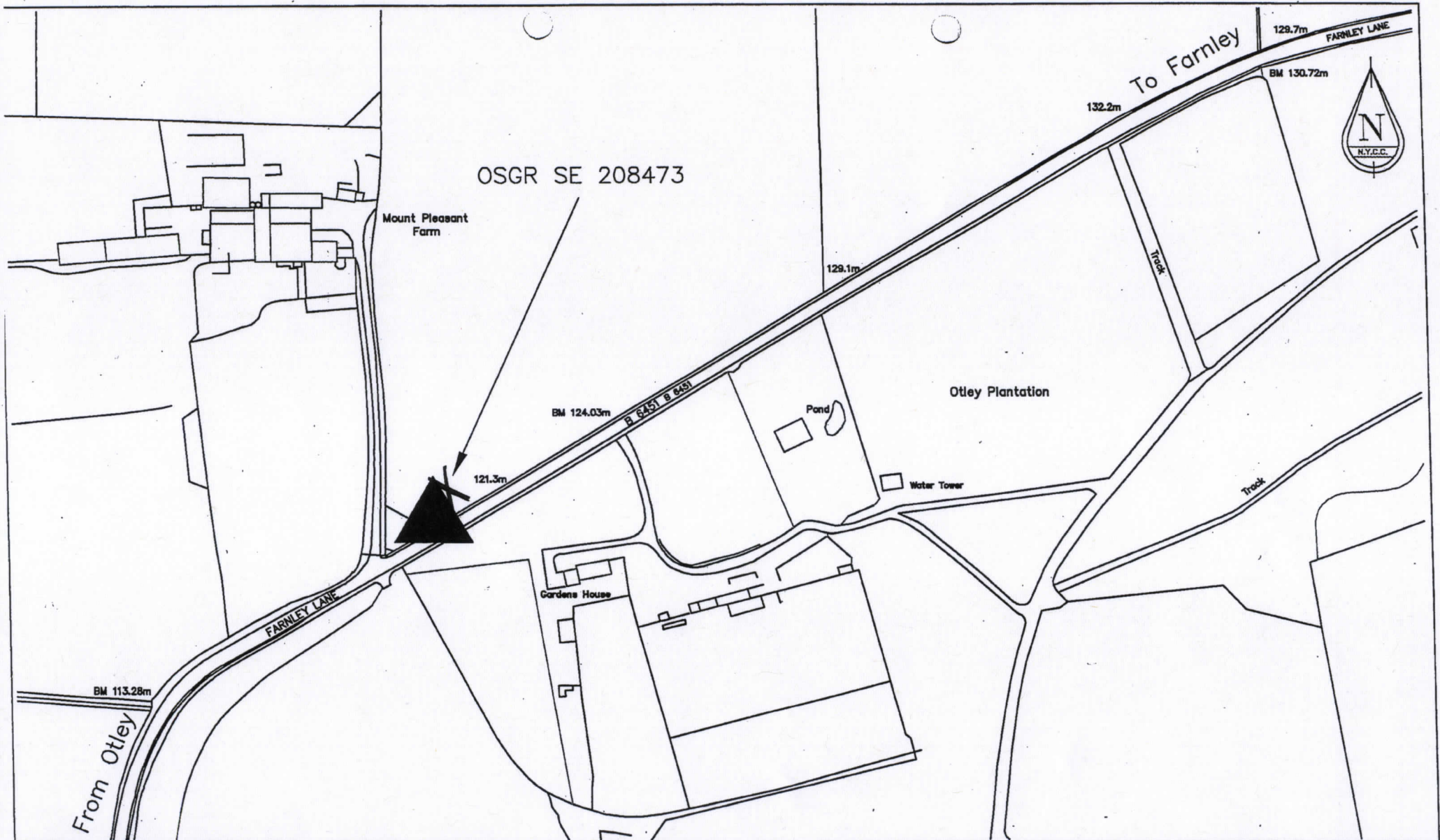

North Yorkshire County Council
 Environmental Services
 Director: M O Moore OBE CEng FICE FIHT DMS

highways
 NORTH YORKSHIRE

PROJECT:

Nidderdale AONB Boundary Signs

DRAWING TITLE:

Farnley Lane – Location for Sign E2

AREA: 3 DIVISION: 6

DATE: 20/01/05

SCALE: 1/2500

DRAWING NO.: 1287/E2

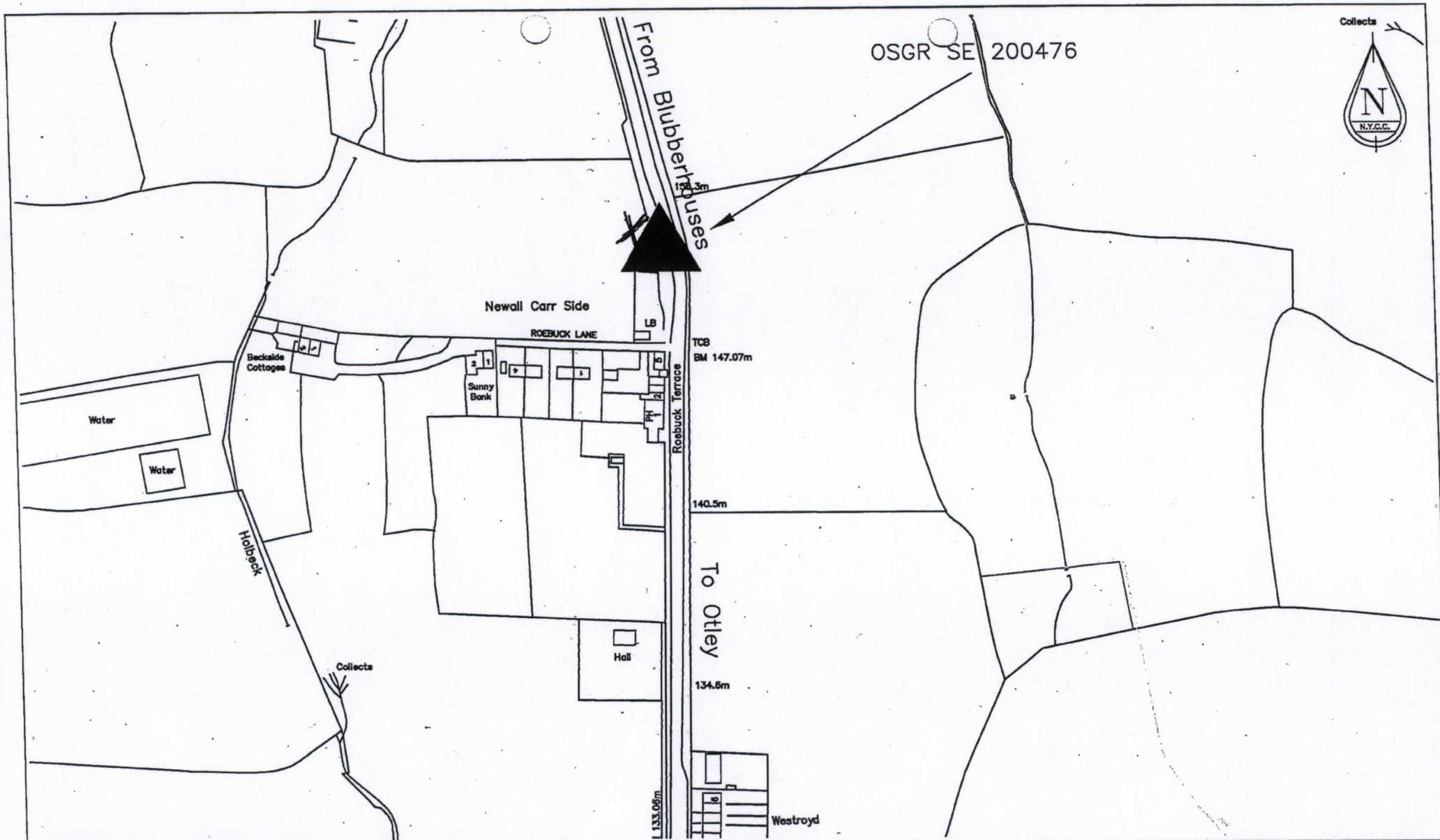

North Yorkshire County Council
 Environmental Services
 Director: M O Moore OBE CEng FICE FIHT DMS

PROJECT: **Nidderdale AONB Boundary Signs**
 DRAWING TITLE: **Newall Carr Road – Location for Sign F1**

AREA: 3	DIVISION: 6
DATE: 20/01/05	
SCALE: 1/2500	
DRAWING NO.: 1287/F1	

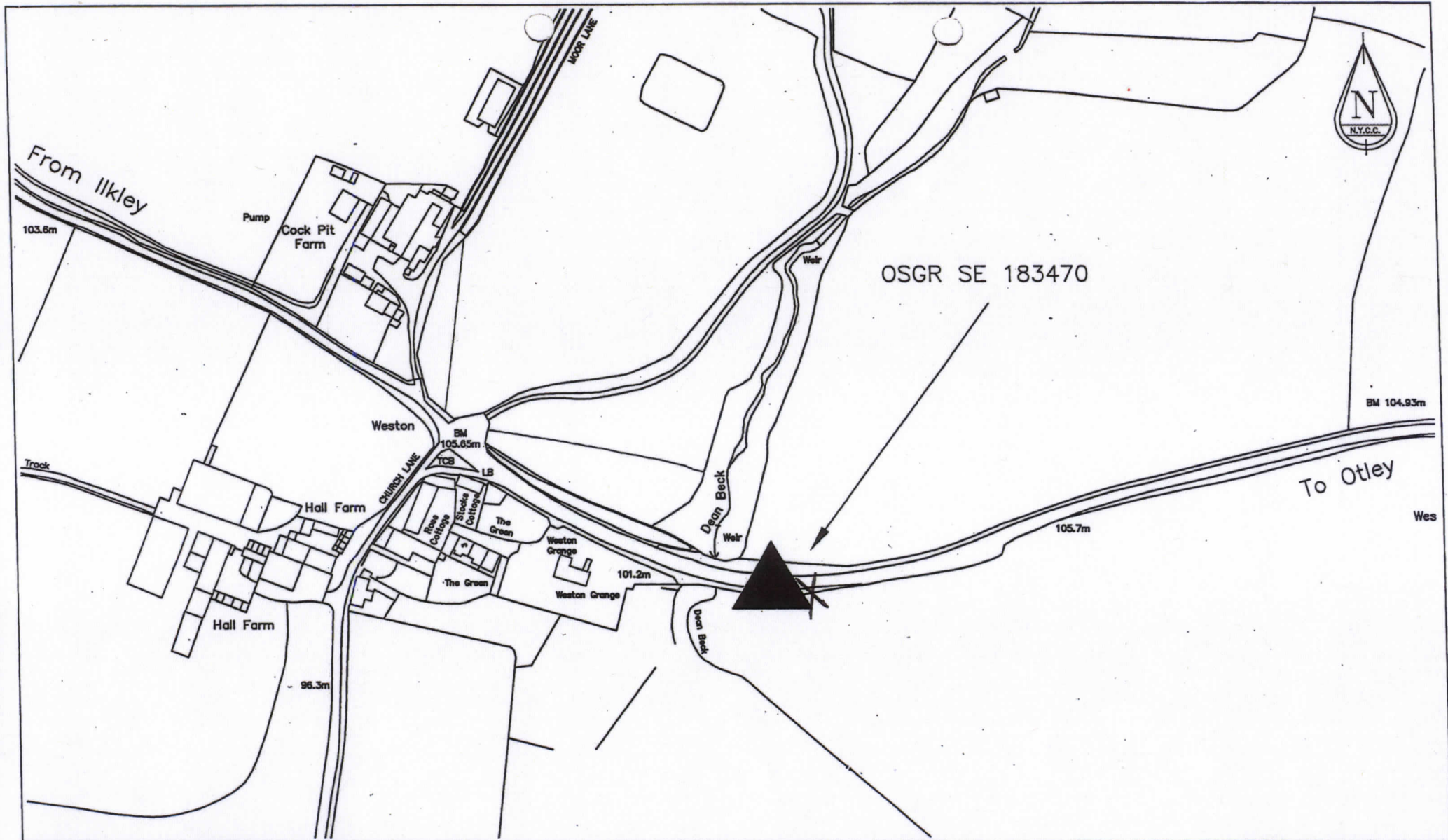

North Yorkshire County Council
 Environmental Services
 Director: M O Moore OBE CEng FICE FIHT DMS

highways
 NORTH YORKSHIRE

PROJECT:

Nidderdale AONB Boundary Signs

DRAWING TITLE:

Weston Lane – Location for Sign G1

AREA: 3 DIVISION: 6

DATE: 20/01/05

SCALE: 1/2500

DRAWING NO.: 1287/G1

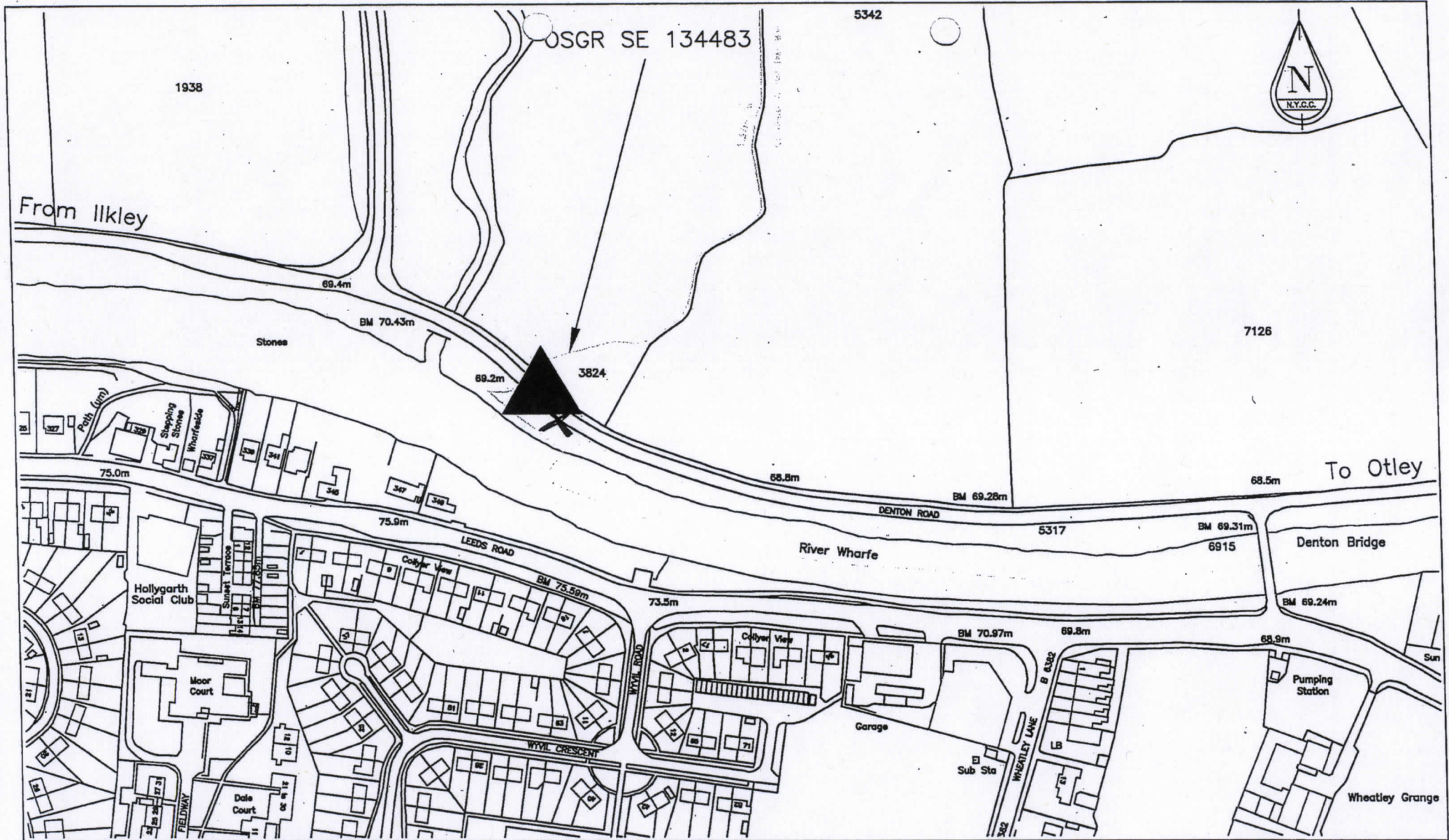

North Yorkshire County Council
 Environmental Services
 Director: M O Moore OBE CEng FICE FIHT DMS

highways
 NORTH YORKSHIRE

PROJECT:

Nidderdale AONB Boundary Signs

DRAWING TITLE:

Denton Road – Location for Sign H1

AREA: 3 DIVISION: 6

DATE: 20/01/05

SCALE: 1/2500

DRAWING NO.: 1287/H1

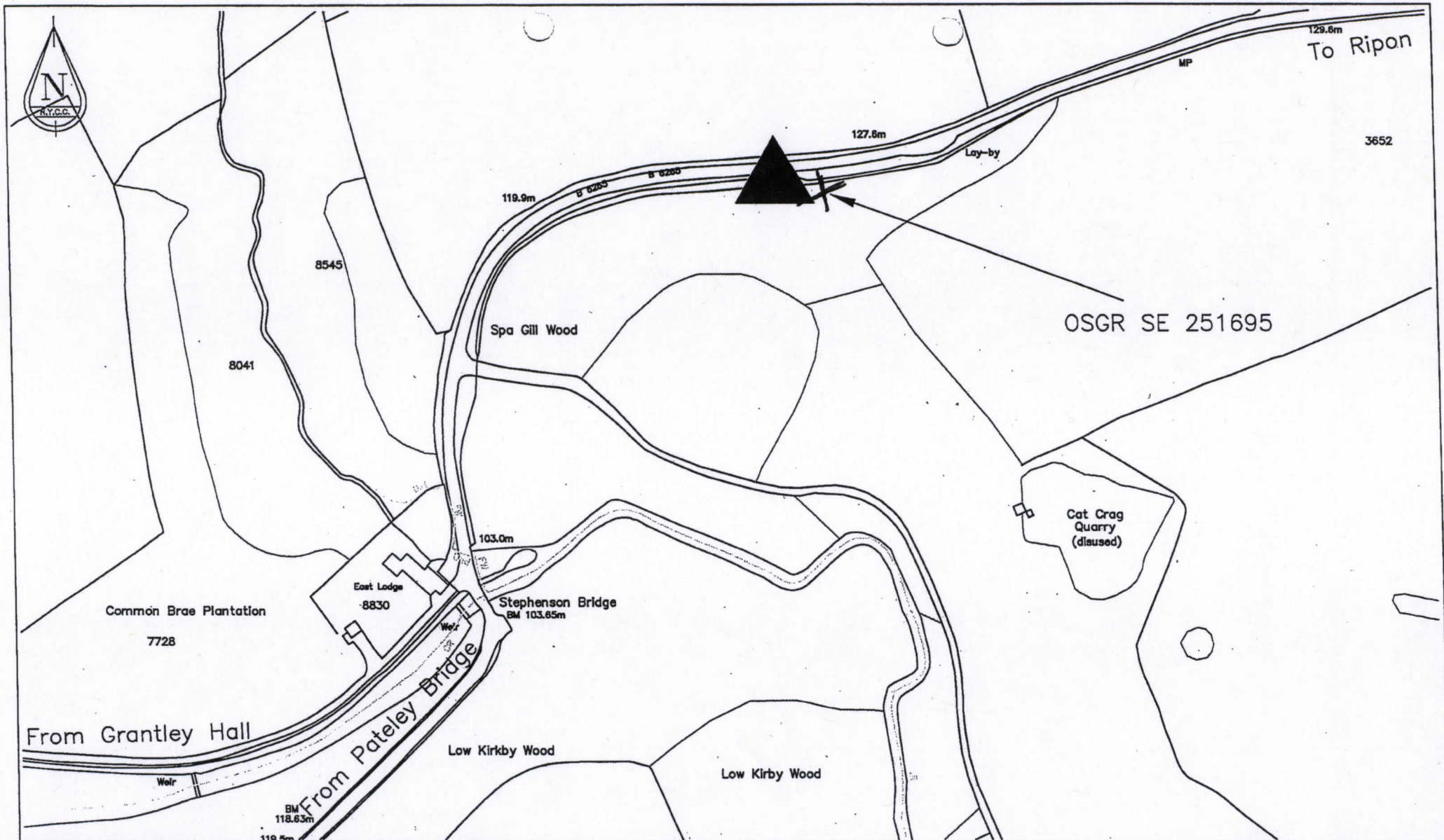

North Yorkshire County Council
 Environmental Services
 Director: M O Moore OBE CEng FICE FIHT DMS

highways
 NORTH YORKSHIRE

PROJECT:

Nidderdale AONB Boundary Signs

DRAWING TITLE:

Grantley Hall – Location for Sign 11

AREA: 3 DIVISION: 6

DATE: 20/01/05

SCALE: 1/2500

DRAWING NO.: 1287/11

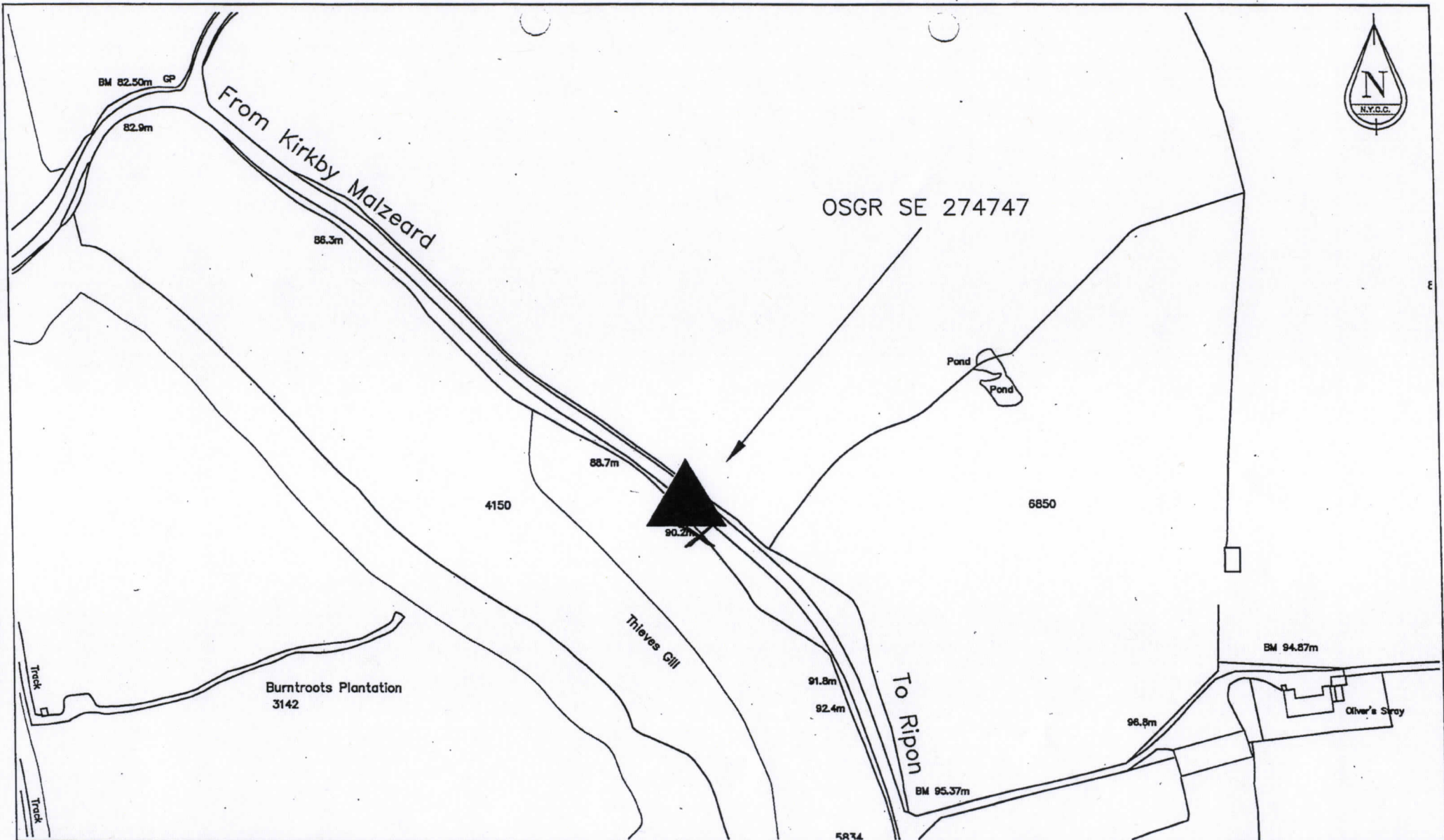

North Yorkshire County Council
 Environmental Services
 Director: M O Moore OBE CEng FICE FIHT DMS

highways
 NORTH YORKSHIRE

PROJECT:

Nidderdale AONB Boundary Signs

DRAWING TITLE:

Kirkby Road, Sutton Grange – Location for Sign K1

AREA: 3 DIMSION: 6

DATE: 20/01/05

SCALE: 1/2500

DRAWING NO.: 1287/K1

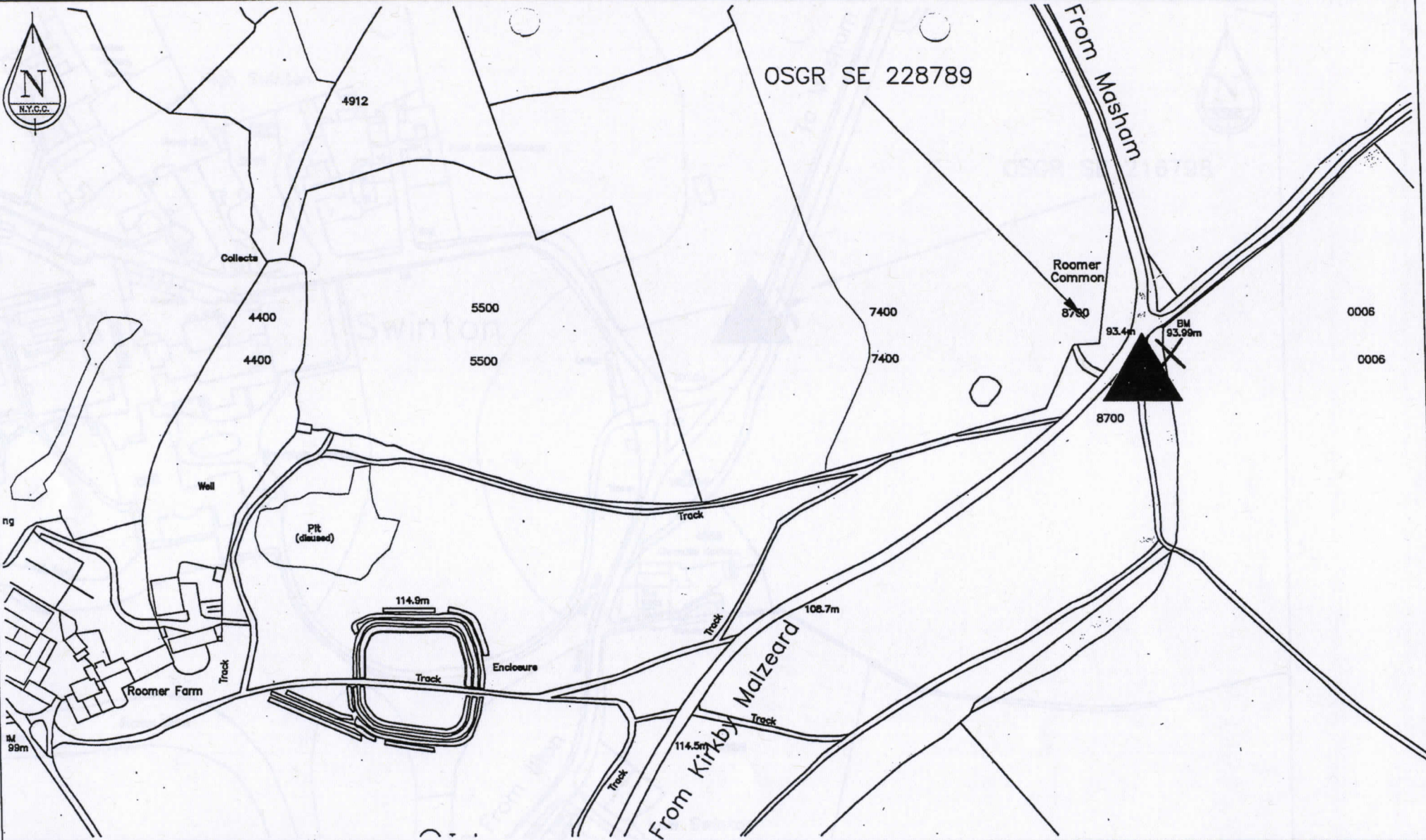

North Yorkshire County Council
 Environmental Services
 Director: M O Moore OBE CEng FICE FIHT DMS



PROJECT: Nidderdale AONB Boundary Signs

DRAWING TITLE: Thorpe Road, Roamer Common – Location for Sign L1

AREA: 3	DIVISION: 6
DATE: 20/01/05	
SCALE: 1/2500	
DRAWING NO.: 1287/L1	

SIGN A

Department for Transport

Date: 15 November 2012

No. GT50/113/0009-2

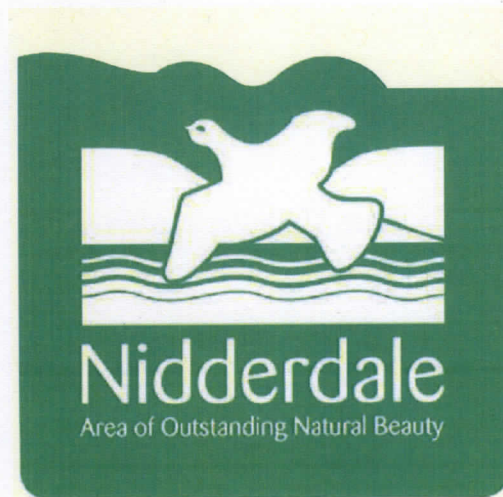

Nidderdale AONB logo

] 100mm x-height
≡ 30mm x-height

Scheme Ref. Nidderdale AONB	
Sign Ref. 2458/1	x-height 100.0
Letter colour WHITE	SIGN FACE
Background GREEN *	Width 1100mm
Border N/A	Height 1000mm
Material High Intensity Prismatic **	Area 1.10sq.m

* background colour is CYAN 100

Alphabet used is Barmeno Regular

** to BS EN 12899-1:2007 Class RA2



North Yorkshire County Council
Business & Environmental Services
Corporate Director: David Bowe

HNY AREA: 5

DATE: 09/07/12

SCALE: N.T.S.

DRAWING NO.: 2458/S1

PROJECT: Nidderdale AONB

DRAWING TITLE: Sign Design

ORIGINAL DRAWING SIZE A4

SIGN B

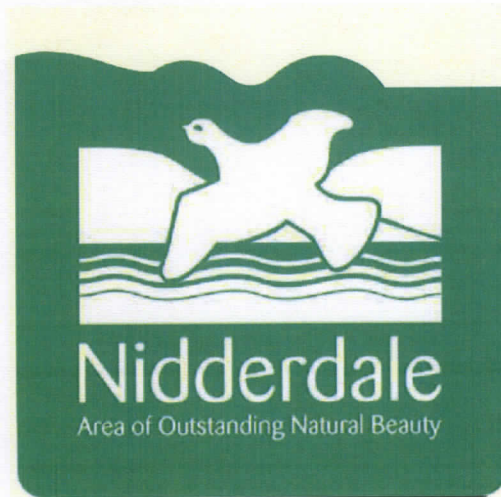

Nidderdale AONB logo

} 75mm x-height
⌊ 24mm x-height

Scheme Ref. Nidderdale AONB	
Sign Ref. 2458/2	x-height 75.0
Letter colour WHITE	SIGN FACE
Background GREEN *	Width 825mm
Border N/A	Height 750mm
Material High Intensity Prismatic **	Area 0.62sq.m

* background colour is CYAN 100

Alphabet used is Barmeno Regular

** to BS EN 12899-1:2007 Class RA2



North Yorkshire County Council
Business & Environmental Services
 Corporate Director: David Bowe

HNY AREA: 5

DATE: 09/07/12

SCALE: N.T.S.

DRAWING NO.: 2458/S2

PROJECT:

Nidderdale AONB

DRAWING TITLE:

Sign Design

ORIGINAL DRAWING SIZE A4