



**ROAD TRAFFIC REGULATION ACT 1984 – SECTIONS 64 AND 65  
AUTHORISATION OF TRAFFIC SIGNS AND SPECIAL DIRECTIONS**

The Secretary of State for Transport, in exercise of his powers under Sections 64 and 65 of the Road Traffic Regulation Act 1984, and of all other powers enabling him in that behalf, for the purpose of informing road users of a double diagonal pedestrian crossing at the junction of Alcester Road, St Mary's Row and Salisbury Road, Moseley in the City of Birmingham, hereby:-

1. authorises the placing at or within the vicinity of the site shown schematically on the attached plan numbered GT50/006/0018-1 of a traffic sign consisting of a road marking (hereinafter referred to as "the authorised marking") conforming as to size, colour and character with that to diagram 1055.1 in Schedule 6 to the Traffic Signs Regulations 2002 (Part I of SI 2002/3113, "the 2002 Regulations"), save that the overall size and shape of the authorised marking shall be as shown on the said plan; and
2. directs, without prejudice to any statutory provision to the like effect that it is a condition of this authorisation that the placing of the authorised marking at or near the said site shall continue to have effect only until such day as may be appointed by one month's notice given by the Secretary of State in writing to the traffic authority for the removal or alteration of the authorised marking and on that day the said authorisation shall, without prejudice to the giving of any further authorisation or direction, cease to have effect.



Department  
for Transport

GT50/006/0018

The provisions of Regulations 12 and 31 of the 2002 Regulations shall apply to the authorised marking in the same manner as they apply to the marking to diagram 1055.1 shown in Schedule 6 to those Regulations.

Dated 19 February 2013

Signed by authority of the Secretary of State



.....  
A Delegated Official of the Department for Transport

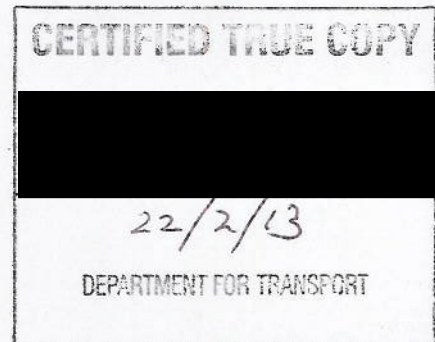

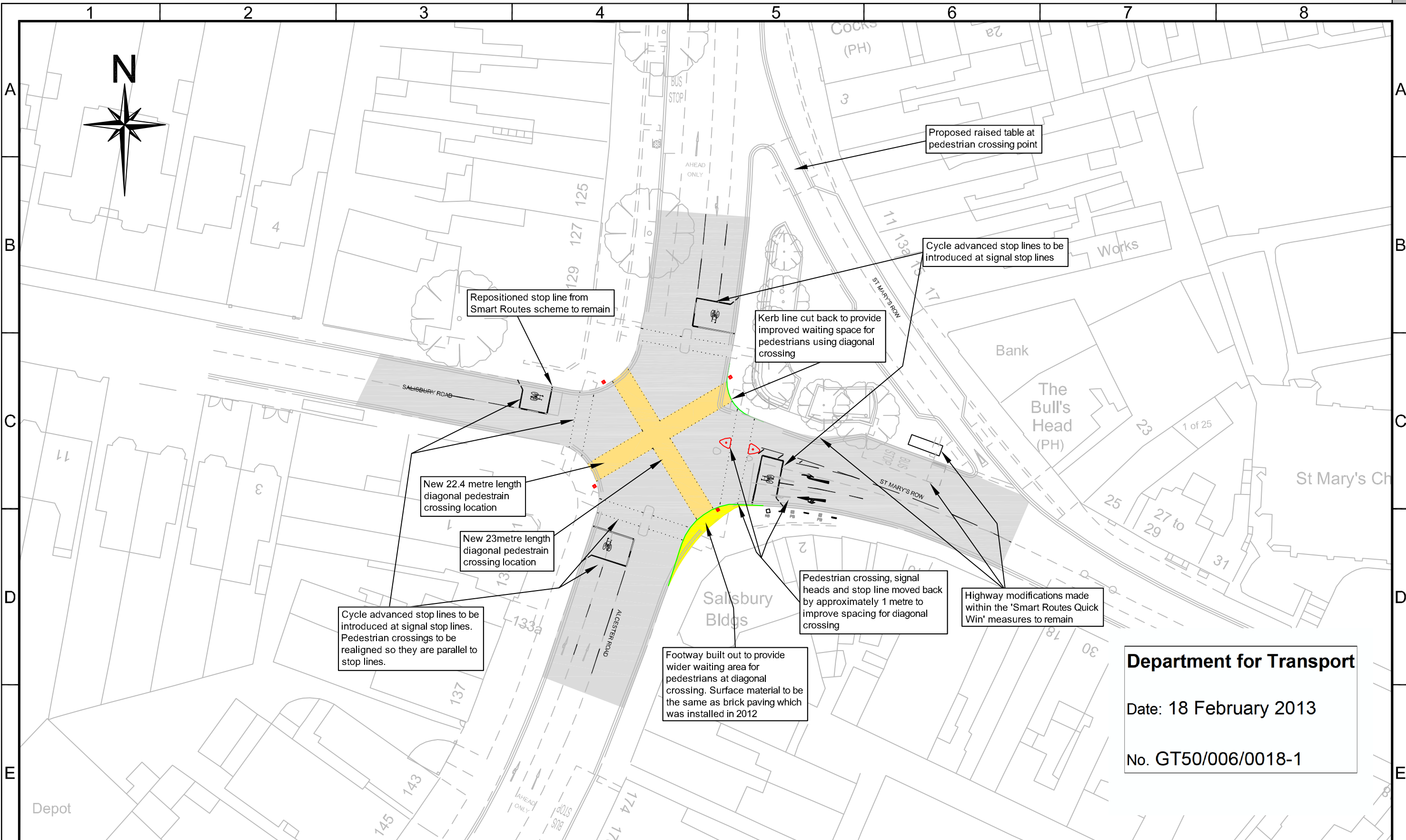
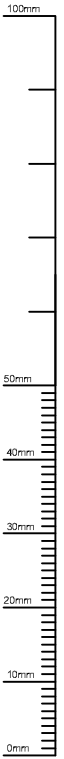

**Department for Transport**  
 Date: 18 February 2013  
 No. GT50/006/0018-1

Key	
	Proposed new kerblines
	Proposed road markings
	Existing road marking
	Proposed new/modified signal pole locations
	Proposed cycle stand
	Proposed coloured surfacing
	Proposed footway area
	Existing cycle stand
	Existing rubbish bin

**Birmingham City Council**  
 DAVID BULL  
 ASSISTANT DIRECTOR  
 DEVELOPMENT STRATEGY  
 1 LANCASTER CIRCUS  
 BIRMINGHAM B4 7DQ



SCHEME  
 MOSELEY LOCAL CENTRE

DRAWING  
 PRELIMINARY DESIGN

DATE	REV.	DESIGNER	DRN	PM
08/08/12	1	AG	AG	AG
DRAWING STATUS				REVISION
GENERAL				-
DWG. No				SCALE
CA-02456_S1_002				1:500

This map is based upon Ordnance Survey material with the permission of Ordnance Survey on behalf of the Controller of Her Majesty's Stationary Office Crown copyright. Unauthorised reproduction infringes Crown copyright and may lead to prosecution or civil proceedings. B.C.C. Licence No 100021326 Date 2012