



**ROAD TRAFFIC REGULATION ACT 1984 – SECTIONS 64 AND 65
AUTHORISATION OF TRAFFIC SIGNS AND SPECIAL DIRECTIONS**

The Secretary of State for Transport, in exercise of his powers under Sections 64 and 65 of the Road Traffic Regulation Act 1984, and of all other powers enabling him in that behalf, for the purpose of informing road users of access restrictions in the Central area of Barnstaple in the county of Devon, hereby:-

1. authorises the erection at or within 5 metres of the sites shown schematically on the attached plan numbered GT50/035/0040-1 of a traffic sign (hereinafter referred to as “the authorised sign A”) conforming as to size, colour and character with that referenced A in the attached set of drawings numbered GT50/035/0040-2; save that a reference to the time of day or the day of the week may be added; and
2. authorises the erection at or within 5 metres of the sites shown schematically on the attached plan numbered GT50/035/0040-3 of a traffic sign (hereinafter referred to as “the authorised sign B”) conforming as to size, colour and character with that referenced B in the said set of drawings; save that a reference to the time of the day or the day of the week may be varied; and
3. authorises the erection at or within 5 metres of the sites shown schematically on the attached plan numbered GT50/035/0040-4 of a traffic sign (hereinafter referred to as “the authorised sign C”) conforming as to size, colour and character with that referenced C in the said set of drawings; save that a reference to the time of day or the day of the week may be added; and
4. directs that it is a condition of this authorisation that the authorised signs A, B, and C may be placed only to indicate the effect of a corresponding Traffic Regulation Order; and



Department
for Transport

GT50/0035/0040

5. directs, without prejudice to any statutory provision to the like effect, that it is a condition of this authorisation that the erection of the authorised signs A, B, and C at or near the said sites shall continue to have effect only until such day as may be appointed by one month's notice given by the Secretary of State in writing to the traffic authority for the removal or alteration of the authorised signs A, B, and C, and on that day the said authorisation shall, without prejudice to the giving of any further authorisation or direction, cease to have effect.

The provisions of Regulations 12, 18 and 19 of the 2002 Regulations shall apply to the authorised signs A, B and C in the same manner as they apply to the sign to diagram 618.3 in Schedule 2 to those Regulations.

Dated *4 July* 2013

Signed by authority of the Secretary of State

.....

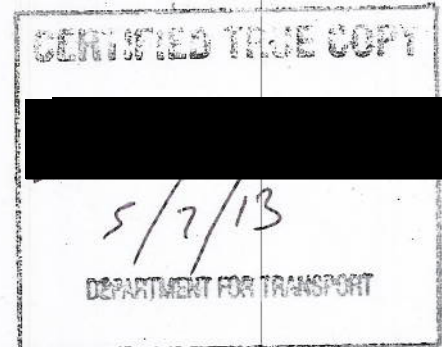

A Delegated Official of the Department for Transport



Department for Transport

Date: 3 July 2013

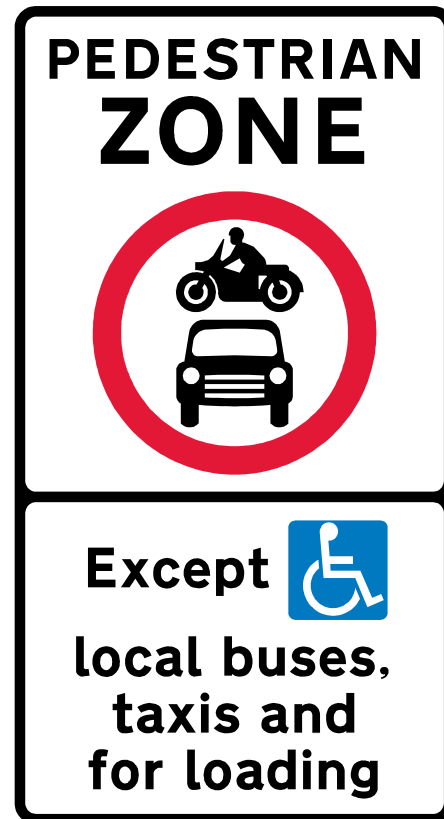
No. GT50/0035/0040-2



ORDER No: 5263

SCHEME:

Barnstaple Town Centre
Moving Traffic Regulation

Road Number:

Road Name: Boutport Street

Sign Ref: BMTO-001

Diag. No: NP618.2

Dimensions (mm):

Width: 582, Height: 1083

x-Heights: 37.5, 62.5 Area: 0.63 sq m

Colours:

black on white

Reflectivity Class: Class 2

DEVON COUNTY COUNCIL
HIGHWAYS & TRAFFIC
MANAGEMENT
TRAFFIC ORDERS & POLICY

Drawing No:001

Sheet No:1 of 3

Scale 1:10

FILE: TRO BLOCK: Sch5

N.B. The colour reference number does NOT
form part of the sign

NO REPRODUCTION WITHOUT WRITTEN PERMISSION

SignPlot v2.80aDv



ORDER No: 5263

SCHEME:

Barnstaple Town Centre
Moving Traffic Regulation

Road Number:

Road Name: Castle Street

Sign Ref: BMTO-002

Diag. No: NP618.2

Dimensions (mm):

Width: 582, Height: 1453

x-Heights: 37.5, 62.5 Area: 0.85 sq m

Colours:

black on white

Reflectivity Class: Class 2

DEVON COUNTY COUNCIL
HIGHWAYS & TRAFFIC
MANAGEMENT
TRAFFIC ORDERS & POLICY

Drawing No:002

Sheet No:2 of 3

Scale 1:10

FILE: TRO BLOCK: Sch6c

N.B. The colour reference number does NOT
form part of the sign

NO REPRODUCTION WITHOUT WRITTEN PERMISSION

SignPlot v2.80aDv



ORDER No: 5263

SCHEME:

Barnstaple Town Centre
Moving Traffic Regulation

Road Number:

Road Name: Mermaid Walk

Sign Ref: BMTO-003A

Diag. No: NP618.2

Dimensions (mm):

Width: 582, Height: 1294

x-Heights: 37.5, 62.5 Area: 0.75 sq m

Colours:

- black on white
- black on yellow

Reflectivity Class: 2

DEVON COUNTY COUNCIL
HIGHWAYS & TRAFFIC
MANAGEMENT
TRAFFIC ORDERS & POLICY

Drawing No:003A

Sheet No:4 of 4

Scale 1:10

FILE: TRO BLOCK: Part16a

N.B. The colour reference number does NOT
form part of the sign

NO REPRODUCTION WITHOUT WRITTEN PERMISSION

SignPlot v2.80aDv

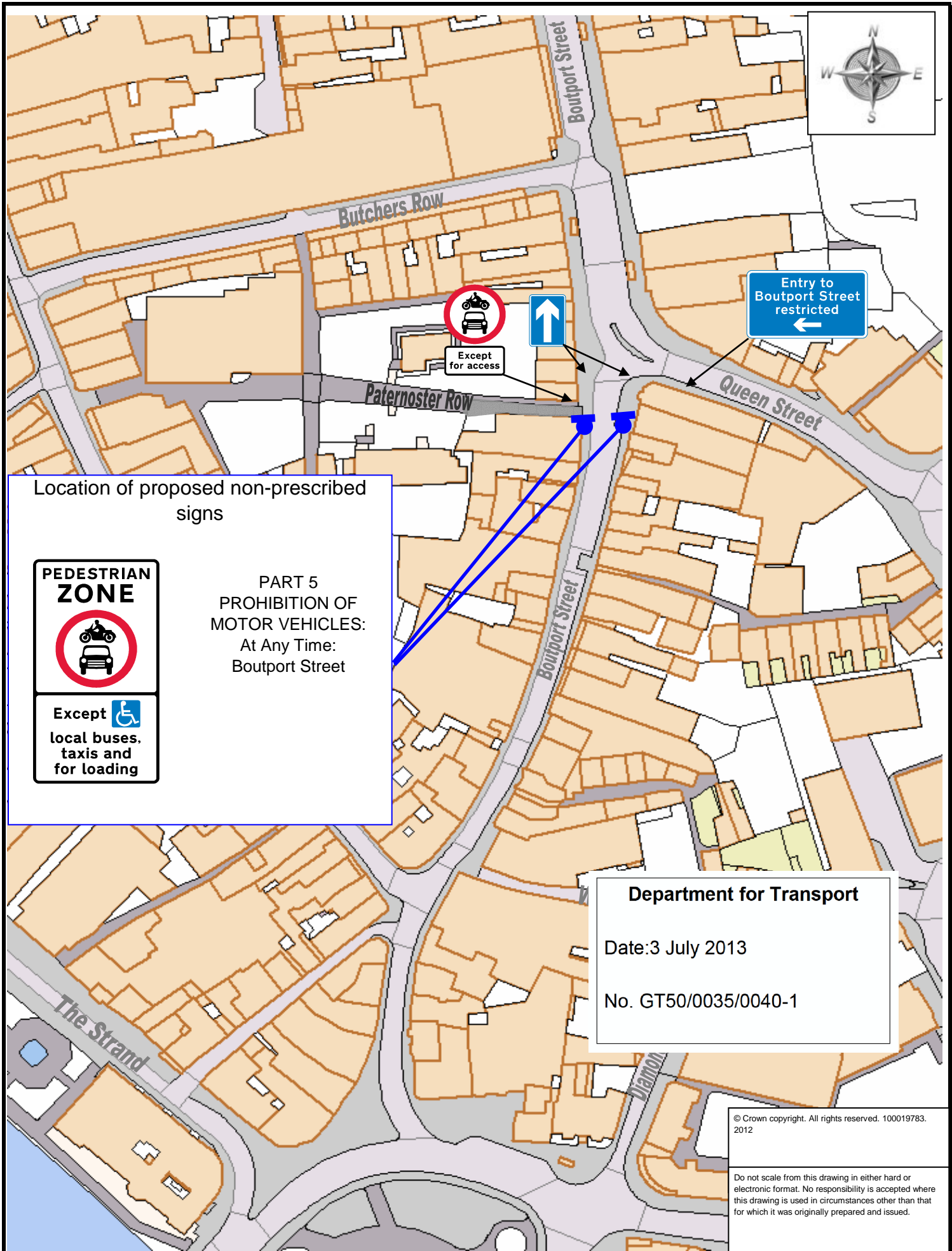

Location of proposed non-prescribed signs

PEDESTRIAN ZONE



Except  local buses, taxis and for loading

PART 5
PROHIBITION OF
MOTOR VEHICLES:
At Any Time:
Boutport Street

Department for Transport

Date: 3 July 2013

No. GT50/0035/0040-1

© Crown copyright. All rights reserved. 100019783. 2012

Do not scale from this drawing in either hard or electronic format. No responsibility is accepted where this drawing is used in circumstances other than that for which it was originally prepared and issued.



Lester Wilmington
Head of Highways Management
TRAFFIC ORDERS & POLICY TEAM
DEVON COUNTY COUNCIL
HIGHWAY MANAGEMENT
PO BOX 494
NEWTON ABBOT
TQ12 9GL
Telephone 0845 155 1004

SCHEME
BARNSTAPLE TOWN CENTRE LTP SCHEME

DRAWING
NON-PREScribed SIGNS (BMTO-001)
BOUTPORT STREET

drawn by CJP	scale N.T.S
date 12-Dec-2012	O.S.Ref 255692, 133140
drawing number ENV5263/2 (A)	

Department for Transport

Date: 3 July 2013

No. GT50/0035/0040-3

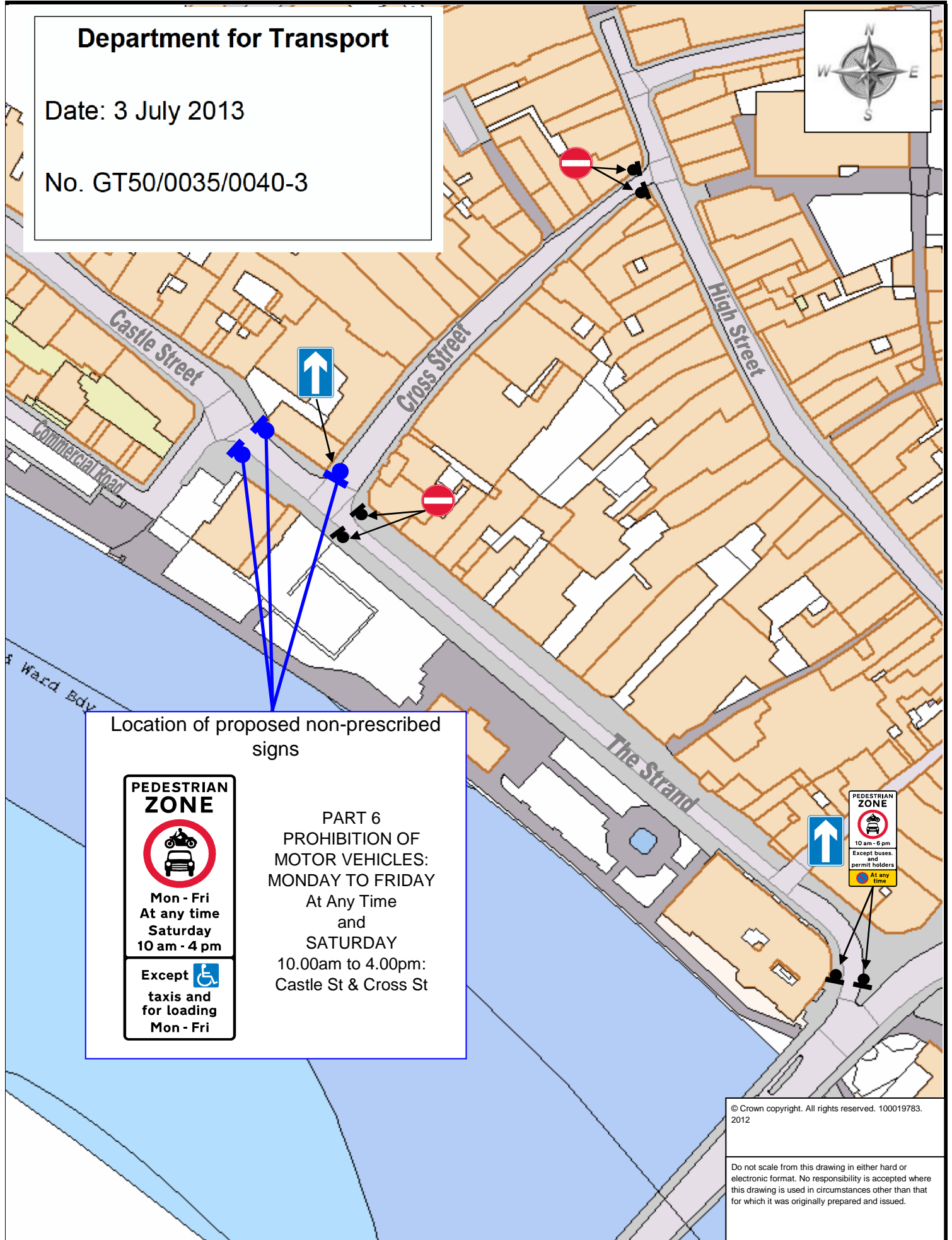

Location of proposed non-prescribed signs

PEDESTRIAN ZONE

Mon - Fri
At any time
Saturday
10 am - 4 pm

Except taxis and for loading
Mon - Fri

**PART 6
PROHIBITION OF
MOTOR VEHICLES:
MONDAY TO FRIDAY
At Any Time
and
SATURDAY
10.00am to 4.00pm:
Castle St & Cross St**

PEDESTRIAN ZONE

10 am - 6 pm
Except buses, and permit holders
At any time

© Crown copyright. All rights reserved. 100019783. 2012

Do not scale from this drawing in either hard or electronic format. No responsibility is accepted where this drawing is used in circumstances other than that for which it was originally prepared and issued.

Lester Wilmington
Head of Highways Management
TRAFFIC ORDERS & POLICY TEAM
DEVON COUNTY COUNCIL
HIGHWAY MANAGEMENT
PO BOX 494
NEWTON ABBOT
TQ12 9GL
Telephone 0845 155 1004

SCHEME
BARNSTAPLE TOWN CENTRE LTP SCHEME

DRAWING
NON-PRESCRIBED SIGNS (BMT0-002)
CASTLE STREET

drawn by CJP	scale N.T.S
date 12-Dec-2012	O.S.Ref 255692, 133140
drawing number ENV5263/3 (A)	

Department for Transport

Date: 3 July 2013

No. GT50/0035/0040-4

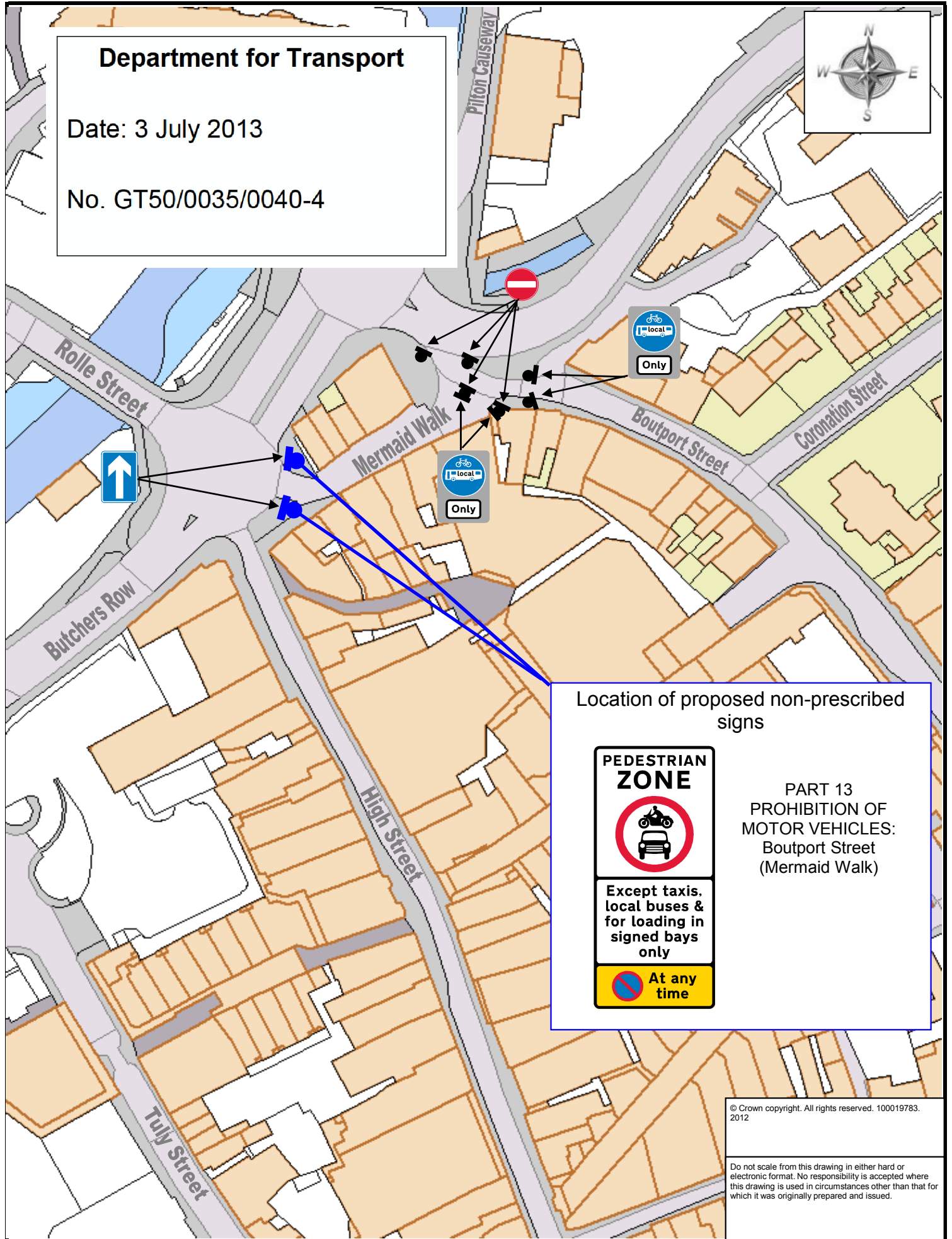

Location of proposed non-prescribed signs

PEDESTRIAN ZONE

Except taxis, local buses & for loading in signed bays only

At any time

**PART 13
PROHIBITION OF
MOTOR VEHICLES:
Boutport Street
(Mermaid Walk)**

© Crown copyright. All rights reserved. 100019783. 2012

Do not scale from this drawing in either hard or electronic format. No responsibility is accepted where this drawing is used in circumstances other than that for which it was originally prepared and issued.

Lester Wilmington
Head of Highways Management

TRAFFIC ORDERS & POLICY TEAM
DEVON COUNTY COUNCIL
HIGHWAY MANAGEMENT
PO BOX 494
NEWTON ABBOT
TQ12 9GL
Telephone 0845 155 1004

SCHEME
BARNSTAPLE TOWN CENTRE LTP SCHEME

DRAWING
NON-PRESCRIBED SIGNS (BMTO-003A)
MERMAID WALK

drawn by
CJP

scale
N.T.S

date
14-Jun-2013

O.S.Ref
255692, 133140

drawing number
ENV5263/4 (B)