



**ROAD TRAFFIC REGULATION ACT 1984 - SECTIONS 64 AND 65
AUTHORISATION OF TRAFFIC SIGNS AND SPECIAL DIRECTIONS**

The Secretary of State for Transport, in exercise of his powers under Sections 64 and 65 of the Road Traffic Regulation Act 1984, and of all other powers enabling him in that behalf, for the purpose of assisting in the free flow of vehicular traffic at the junction of High Road Wood Green, Station Road, and Lordship Lane in the London Borough of Haringey hereby:-

1. authorises the placing at or within the vicinity of the site indicated schematically in the attached plan numbered GT50/082/0016-1 of a traffic sign consisting of a road marking (hereinafter referred to as “the authorised box marking”) conforming as to size, colour and character with that shown in diagram 1043 in Schedule 6 to the Traffic Signs Regulations 2002 (Part I of SI 2002/3113, “the 2002 Regulations”), save that,
 - a) the overall size and overall shape of the authorised box marking shall be as shown in the said plan; and
 - b) the authorised box marking shall incorporate a road marking (hereinafter referred to as “the authorised crossing marking”) conforming as to size, colour and character with that shown in diagram 1055.1 in Schedule 6 to the 2002 Regulations save that the overall size and shape shall be as shown on the said plan; and



2. directs, without prejudice to any statutory provisions to the like effect, that it is a condition of this authorisation that the placing of the authorised box marking and authorised crossing marking at or near the said site shall continue to have effect only until such day as may be appointed by one month's notice given by the Secretary of State in writing to the traffic authority for the removal or alteration of the authorised box marking and authorised crossing marking and on that day the said authorisation shall, without prejudice to the giving of any further authorisation or direction, cease to have effect.

Section 36 of the Road Traffic Act 1988 shall apply to the authorised box marking as it applies to the marking shown in diagram 1043 in Schedule 6 to the 2002 Regulations.

The provisions of Regulations 12 and 31 of the 2002 Regulations shall apply to the authorised box marking in the same manner as they apply to the marking shown in diagram 1043 in Schedule 6 to the 2002 Regulations.

The provisions of Regulations 12 and 31 of the 2002 Regulations shall apply to the authorised crossing marking in the same manner as they apply to the marking shown in diagram 1055.1 in Schedule 6 to the 2002 Regulations.

Dated.....*12 March*.....2013

Signed by authority of the Secretary of State

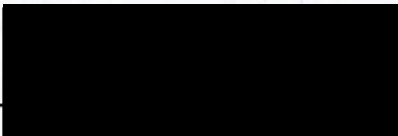
.....

A Delegated Official of the Department of Transport



This product includes mapping data licensed from Ordnance Survey with the permission of HMSO © Crown Copyright LBH 2007. All rights reserved.
License number 100019199.

NOTES:

The junction facilitates a diagonal pedestrian crossing which is designated with a contrasting coloured surface.

Linear dimensions are in millimetres.

Dimensions as set out in TSRGD2002.

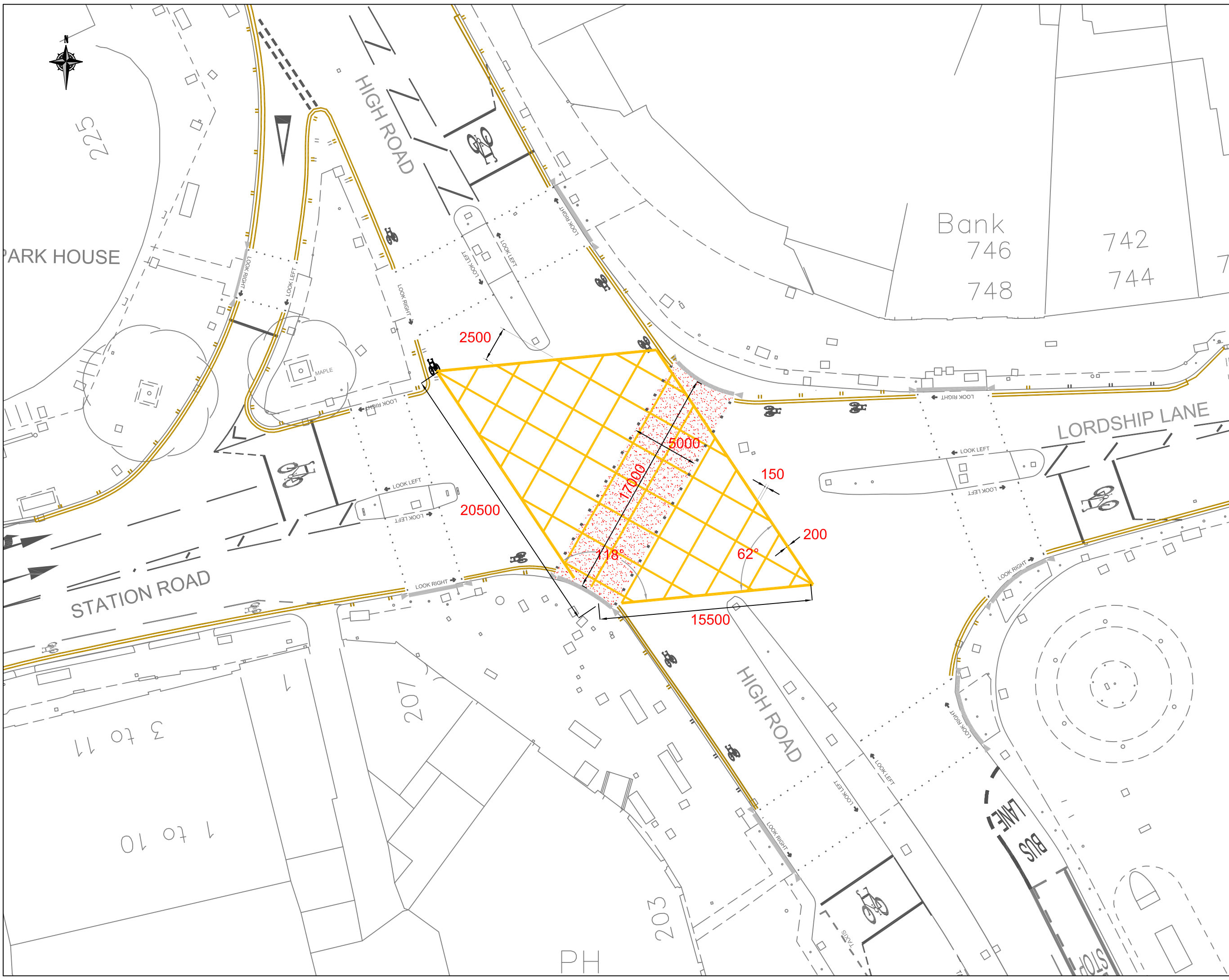

Rev	Description	Checked	Date

Project:
HIGH ROAD, WOOD GREEN, N22

Title:
YELLOW BOX JUNCTION FOR DfT APPROVAL

Designed: BC Drawn: BC Checked: CRW

Scale: 1:250 @ A3 Date Drawing Created: SEPT 2012

Org. No: Rev: **PLACE & SUSTAINABILITY SINGLE FRONTLINE**