



**ROAD TRAFFIC REGULATION ACT 1984 - SECTIONS 64 AND 65
AUTHORISATION OF TRAFFIC SIGNS AND SPECIAL DIRECTIONS**

The Secretary of State for Transport, in exercise of his powers under Sections 64 and 65 of the Road Traffic Regulation Act 1984, and of all other powers enabling him in that behalf, for the purpose of indicating parking places for disabled persons at 45 Clovelly Road, Southampton, hereby:-

1. authorises the placing at the location shown on the attached plan numbered GT50/150/0032-1 of a traffic sign consisting of a road marking (hereinafter referred to as "the authorised marking") conforming as to size, colour and character with that to diagram 1028.3 in the Traffic Signs Regulations 2002 (Part I of SI 2002/3113, "the 2002 Regulations") save that the length of the bay shall be as shown on the said plan; and
2. directs that, notwithstanding the provisions of Direction 24(1) of the Traffic Signs General Directions 2002 (Part II of SI 2002/3113), the authorised marking shall only be used with the sign to diagram 661A in Schedule 2 to the 2002 Regulations; and
3. directs that it is a condition of this authorisation that the authorised marking may be placed only to indicate the effect of a corresponding Traffic Regulation Order; and
4. directs, without prejudice to any statutory provision to the like effect, that it is a condition of this authorisation that the placing of the authorised marking on the said road shall continue to have effect only until such day as may be appointed by one month's notice given by the Secretary of State in writing to the traffic authority for the removal or alteration of the authorised marking and on that day the said authorisation shall, without prejudice to the giving of any further authorisation or direction, cease to have effect.



Department
for Transport

GT50/150/0032

The provisions of Regulation 12 of the 2002 Regulations shall apply to the authorised marking in the same manner as they apply to the road marking to diagram 1028.3 in Schedule 6 to those Regulations.

Dated 4 July 2013

Signed by authority of the Secretary of State

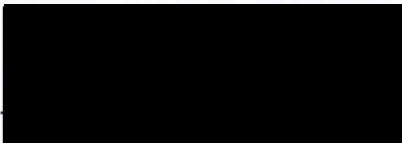

.....
A Delegated Official of the Department for Transport

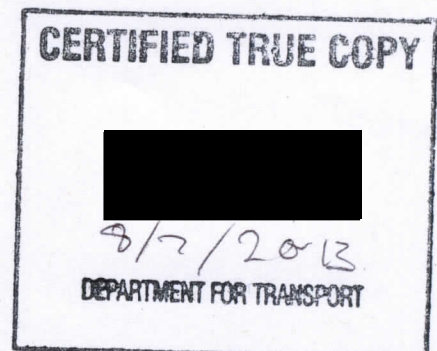

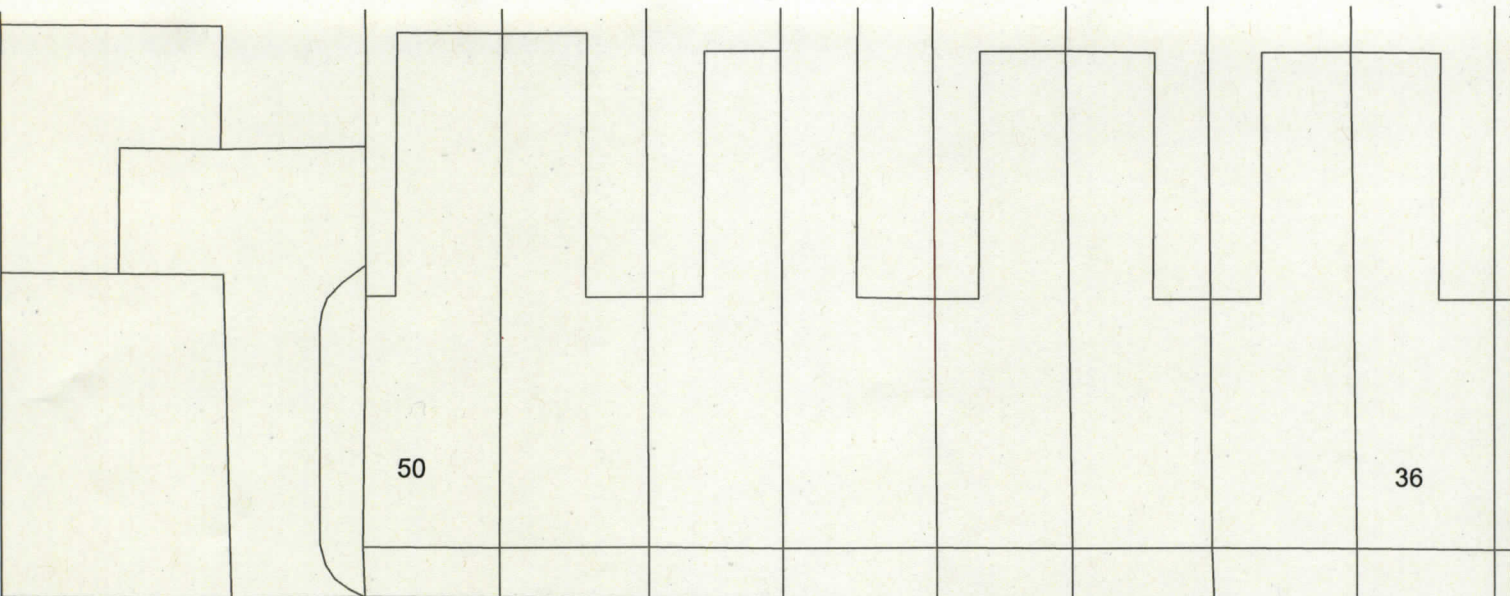

50

36

CLOVELLY ROAD

< 5.5M >



< 2M >

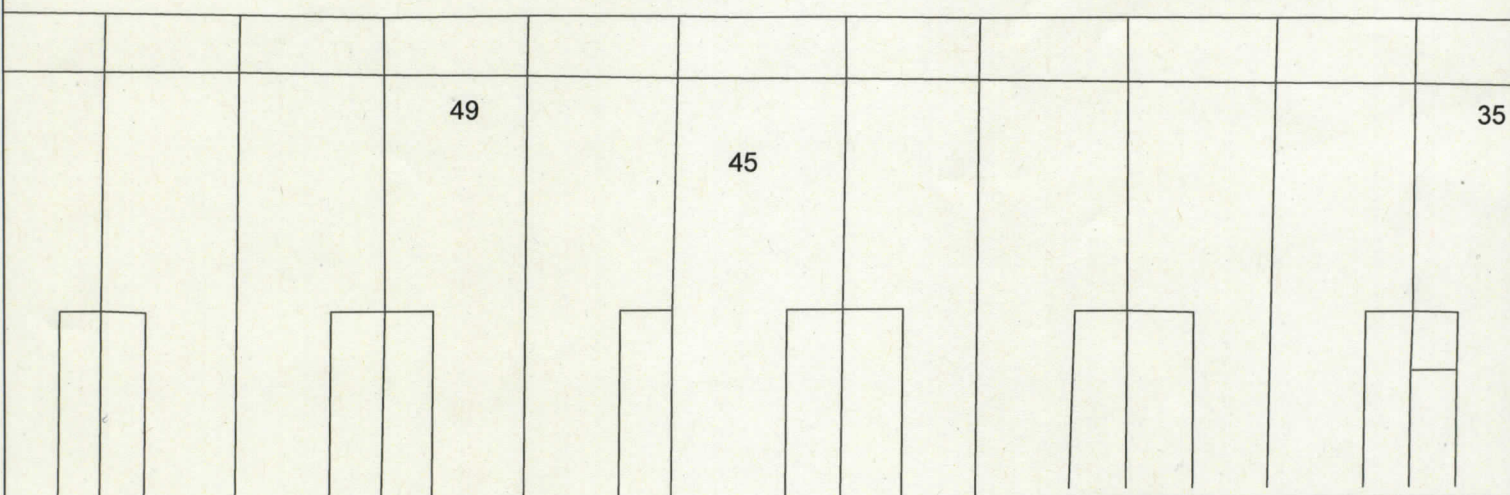
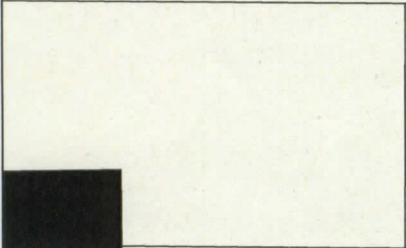

49

45

35



Department for Transport

Date: 3 July 2013

No. GT50/150/0032-1

Based on the Ordnance Survey's 2010 Map with the permission of the Controller of Her Majesty's Stationery Office. Unauthorised reproduction infringes Crown Copyright and may lead to prosecution of civil proceeding, South

Highways Service Partnership
 Michael Scevity, Traffic Management
 City Depot & Recycling Park
 First Avenue, Millbrook
 SO15 0LJ. Tel: 023 8079 8066
 Mob: 07966 895206



Balfour Beatty

Working in partnership

INSTRUCTIONS:

Install disabled bay outside 45 clovelly Road, Newtown
 Bay size 5.5m x 2.0m. Post required for sign,
 as per map above

CONFIRM NO: 113274

DATE: 16/5/2013