



**ROAD TRAFFIC REGULATION ACT 1984 – SECTIONS 64 AND 65
AUTHORISATION OF TRAFFIC SIGNS AND SPECIAL DIRECTIONS**

The Secretary of State for Transport, in exercise of his powers under Sections 64 and 65 of the Road Traffic Regulation Act 1984, and of all other powers enabling him in that behalf, for the purpose of informing road users of a mandatory U-turn for buses at the junction of Forest Hill Road and Wood Vale in the London Borough of Southwark, hereby:-

1. authorises the erection at or within 2 metres of the sites referenced "U TURN BUSES" on the attached plan numbered GT50/139/0113-1 of a traffic sign (hereinafter referred to as "the authorised sign") conforming as to size, colour and character with that shown in the attached drawing numbered GT50/139/0113-2, and
2. directs that it is a condition of this authorisation that the authorised sign may be placed only to indicate the effect of a corresponding Traffic Order; and
3. directs, without prejudice to any statutory provision to the like effect, that it is a condition of this authorisation that the erection of the authorised sign at or near the said sites shall continue to have effect only until such day as may be appointed by one month's notice given by the Secretary of State in writing to the traffic authority for the removal or alteration of the authorised sign, and on that day the said authorisation shall, without prejudice to the giving of any further authorisation or direction, cease to have effect.

The provisions of Regulations 12, 18 and 19 of the Traffic Signs Regulations 2002 (S.I. 3113/2002) shall apply to the authorised sign in the same manner as they apply to the sign to diagram 606 in Schedule 2 to those Regulations.

Dated 11 September 2013

Signed by authority of the Secretary of State

[Redacted signature]

A Delegated Official of the Department for Transport

CERTIFIED TRUE COPY

22/10/2013

DEPARTMENT FOR TRANSPORT

Department for Transport

Date: 11 September 2013

No. GT50/139/0113-2

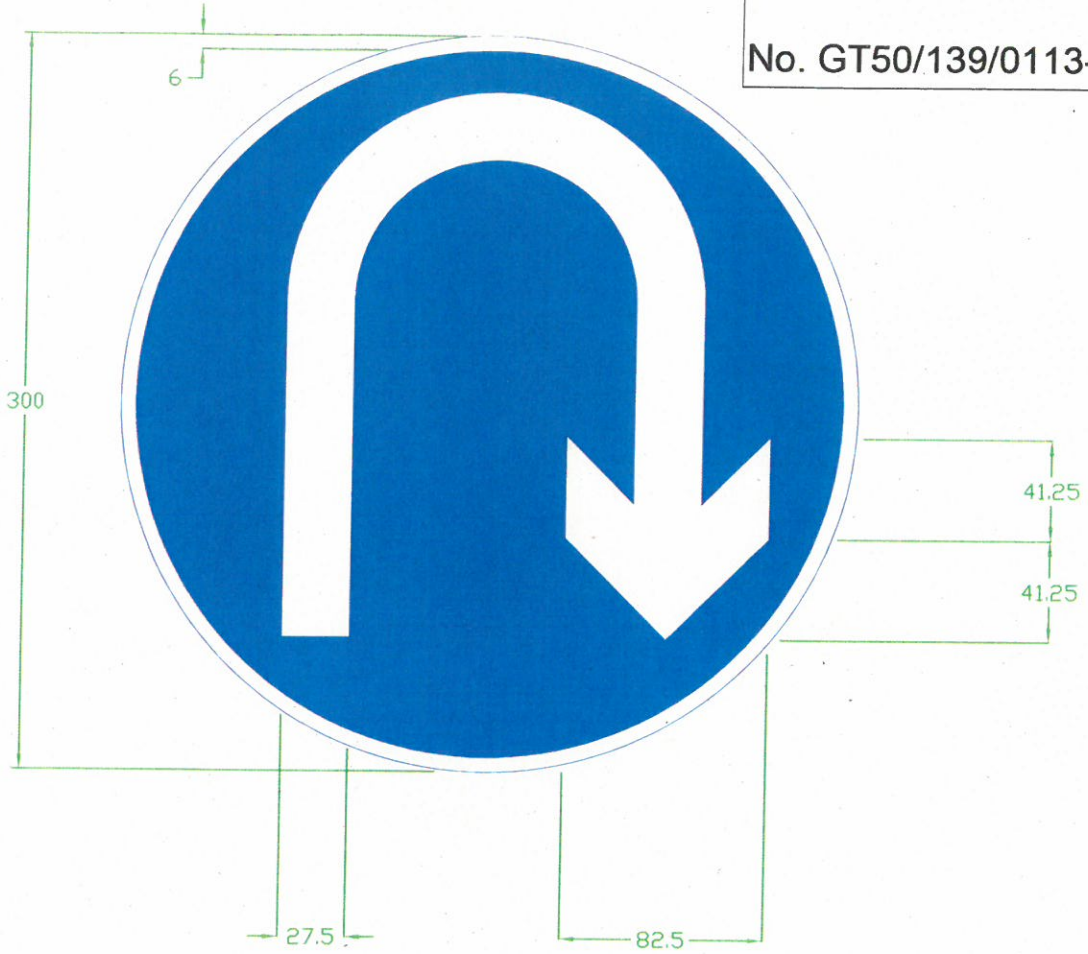

Transport for London
Street Management



**Traffic Technology
Services**

Windsor House
42-50 Victoria Street
LONDON SW1H 0TL
Telephone 020 7343 5000

scale	A4	date	ALT	ALT	IAH
NTS		MAR 07	drn	eng	chk

scheme
PROPOSED TRAFFIC SIGN
FOR INCORPORATION
WITHIN TRAFFIC SIGNALS

NO SIG/GEN/U TURN SIGN

This map is reproduced from Ordnance Survey material with the permission of Ordnance Survey on behalf of the Controller of Her Majesty's Stationery Office © Crown copyright. Unauthorised reproduction infringes Crown copyright and may lead to prosecution or civil proceedings. (GLA)(100032379) (2002).

- NOTES**
- 1 ALL WORKS TO BE CARRIED OUT TO THE RELEVANT TFL SPECIFICATION
 - 2 ALL LOOPS ARE SHOWN IN OPTIMUM POSITION. THEY ARE SUBJECT TO SITE CONDITIONS
 - 3 EXISTING DUCT, CONDITION UNKNOWN ---
 - 4 EXISTING DUCTS #
 - 5 PROPOSED DUCTS #
 - 6 30mm Ø DUCTS MARKED "TRAFFIC SIGNALS"
 - 7 50mm Ø DUCTS MARKED "TRAFFIC SIGNALS"
 - 8 DUCT LAYOUT IS INDICATIVE ONLY & SUBJECT TO SITE CONDITIONS
 - 9 30mm DUCT FROM CONTROLLER TO ESP
 - 10 FROM KEB TO ALL SIGNAL HEADS
 - 11 ANTI-SKID SURFACING, TACTILE PAVING, GUARDRAILING & ROAD MARKINGS DESIGNED & INSTALLED BY THIRD PARTY, INDICATE WHERE SHOWN
 - 12 PUSHBUTTONS TO BE MOUNTED DIRECTLY INTO GROUND
 - 13 TACTILE WARNING CONES TO BE MOUNTED AT 80 TO KEBS ON POLES 1, 2, 5, 7, 10 & 11 AS PER FLE 1
 - 14 TACTILE WARNING CONES TO BE MOUNTED AT 80 TO KEBS ON POLES 3, 4, 8, 9, 12 & 13
 - 15 POLES ARE BACK IN COLOUR
 - 16 50mm Ø BUS KEYS
 - 17 50mm Ø BUS KEYS MOUNTED ON POLE 1

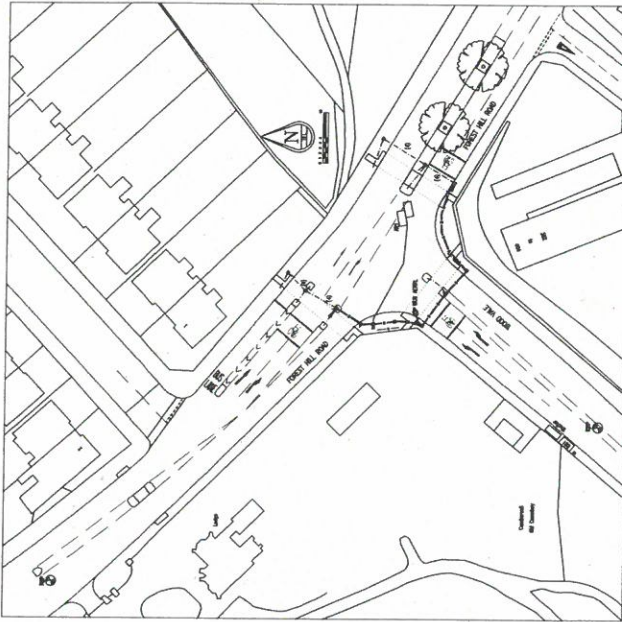
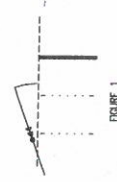

LOOP, DUCTING AND DETECTION POINT PLAN
SCALE 1:500

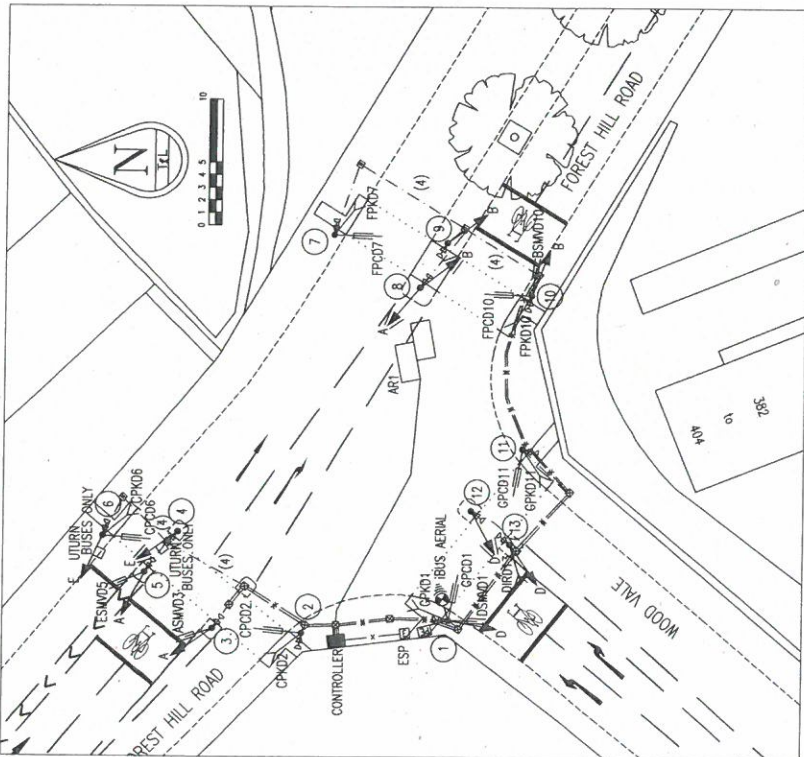

SCHEME PLAN
SCALE 1:200

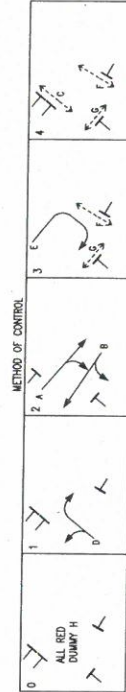

IBUS STOP REFERENCE POINT ON DRAWING	LOCATION	FLAG TO STOPLINE (METRES)	SHIELDING STOPLINE (METRES)	LENGTH OF SHIELDING (METRES)
IB1	WOOD VALE (E/B)	31.9	28.1	2.8

DETECTOR NAME	IBUS JUNCTION ID	DETECTOR REFERENCE POINT	DISTANCE FROM STOP LINE	STOP CONDITION	MAX DISTANCE OFFSET	FROM STREET	DIRECTION	TO STREET	DIRECTION
JABP	1119	A1 ACCESS ROAD FOREST HILL ROAD S/B	68.0	0	N/A	FOREST HILL ROAD	S/B	WOOD VALE	W/B
DBP	1119	A1 FLAG OF IB1 - WOOD VALE U/B	33.9	2	20	WOOD VALE	E/B	FOREST HILL ROAD	N/B

Department for Transport
Date: 11 September 2013
No. GT50/1390/113-1

A1 AUG 12 REVZ MARKED
Scale: AS SHOWN JUN 12
KSC: em
DJB: eng
GMP: em
GMP: em
GMP: em
CHK: em

Surface Transport

scheme L B OF SOUTHARK
FOREST HILL ROAD /
WOOD VALE

PROPOSED MODIFICATIONS TO TRAFFIC SIGNALS
N O PRO/08/126/03A

12BPC/M

0925 07/09/12 KCH/DMS

Directorate of
Traffic Operations
100 Victoria Road
Exeter EX1 1DT
Telephone 01392 7222 5600

We have reproduced these drawings using the permission of Ordnance Survey on behalf of the Controller
of Her Britannic Majesty's Stationery Office. No other reproduction or translation is permitted without the prior
written permission of the Controller.