



**ROAD TRAFFIC REGULATION ACT 1984 - SECTIONS 64 AND 65
AUTHORISATION OF TRAFFIC SIGNS AND SPECIAL DIRECTIONS**

The Secretary of State for Transport, in exercise of his powers under Sections 64 and 65 of the Road Traffic Regulation Act 1984, and of all other powers enabling him in that behalf, for the purpose of controlling traffic flow at the junction of Wilmslow Road and Wilbraham Road in Manchester, hereby:-

1. authorises the erection at or within 2 metres of the sites marked schematically on the attached plan numbered GT50/100/0019-1 of a light signal (hereinafter referred to as "the authorised light signal") conforming as to size, colour and character with the light signal to diagram 3000.9 in Schedule 8 to the Traffic Signs Regulations 2002 (Part I of S.I. 2002/3113, "the 2002 Regulations"), save that the authorised light signal shall include at signal position number 2 a green cycle symbol as shown in diagram 3000.2 in Schedule 8 to the 2002 Regulations; and
2. directs that the authorised light signal may only be placed at the said sites if the apparatus (including the content of all instructions stored in it) used in connection with it is of a type which has been approved by the Secretary of State as appropriate to the site and application; and
3. directs, without prejudice to any statutory provision to the like effect, that it is a condition of this authorisation that the erection of the authorised light signal at or near the said sites shall continue to have effect only until such day as may be appointed by one month's notice given by the Secretary of State in writing to the traffic authority for the removal or alteration of the authorised light signal and on that day the said authorisation shall, without prejudice to the giving of any further authorisation or direction, cease to have effect; and
4. directs that, notwithstanding anything to the contrary contained in the preceding paragraph, the authorised light signal shall be retained no later than 12 months from the date of this authorisation.



Department
for Transport

GT50/100/0019

The provisions of Regulations 12 and 33 of the 2002 Regulations shall apply to the authorised light signal in the same manner as they apply to the light signal to diagram 3000.9 in Schedule 8 to those Regulations.

Dated 9 December 2013

Signed by authority of the Secretary of State

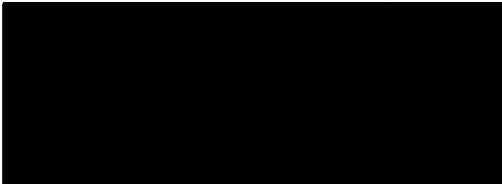

.....
A Delegated Official of the Department for Transport

CERTIFIED TRUE COPY

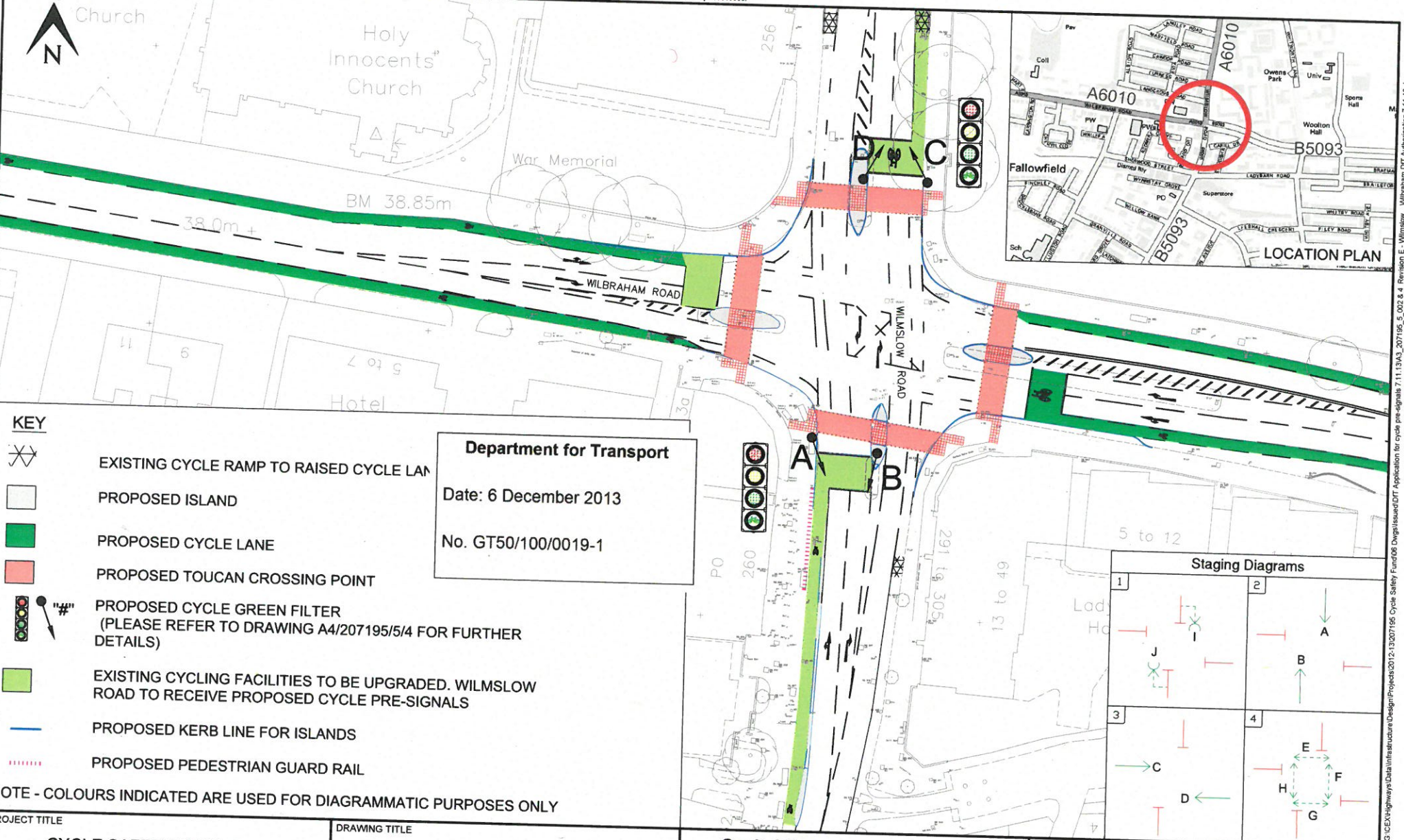
9/12/13
DEPARTMENT FOR TRANSPORT

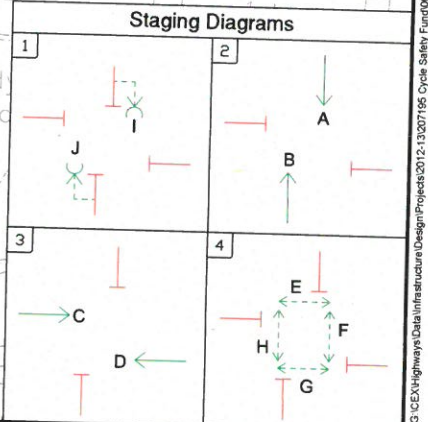

- KEY**
- EXISTING CYCLE RAMP TO RAISED CYCLE LAN
 - PROPOSED ISLAND
 - PROPOSED CYCLE LANE
 - PROPOSED TOUCAN CROSSING POINT
 - PROPOSED CYCLE GREEN FILTER
(PLEASE REFER TO DRAWING A4/207195/5/4 FOR FURTHER DETAILS)
 - EXISTING CYCLING FACILITIES TO BE UPGRADED. WILMSLOW ROAD TO RECEIVE PROPOSED CYCLE PRE-SIGNALS
 - PROPOSED KERB LINE FOR ISLANDS
 - PROPOSED PEDESTRIAN GUARD RAIL

Department for Transport
 Date: 6 December 2013
 No. GT50/100/0019-1



NOTE - COLOURS INDICATED ARE USED FOR DIAGRAMMATIC PURPOSES ONLY

PROJECT TITLE
**CYCLE SAFETY FUND AND
 CYCLE CITY AMBITION GRANT**

DRAWING TITLE
**WILMSLOW ROAD
 WILBRAHAM ROAD**

Capital Programmes & Property
 Growth & Neighbourhoods Directorate
 PO Box 532
 Town Hall
 Manchester M60 2LA



SIZE	SCALE	DATE	DRAWN	CHECKED	APPROVED
A3	1:500	07.11.13	SPM	MJS	PDC

DRAWING NUMBER	REV
A3/207195/5/002	E