



**ROAD TRAFFIC REGULATION ACT 1984 – SECTIONS 64 AND 65
AUTHORISATION OF TRAFFIC SIGNS AND SPECIAL DIRECTIONS**

The Secretary of State for Transport, in exercise of his powers under Sections 64 and 65 of the Road Traffic Regulation Act 1984, and of all other powers enabling him in that behalf, for the purpose of informing road users of left turn and right turn prohibitions on roads for which Staffordshire County Council is the traffic authority, hereby:-

1. authorises the erection at or within 5 metres of the sites shown schematically on the attached plans numbered GT50/138/0021-1, GT50/138/0021-2 and GT50/138/0021-3 of a traffic sign consisting of a plate (hereinafter referred to as “the authorised plate”) conforming as to size, colour and character with that shown as “AUTH PLATE” on the attached drawing numbered GT50/138/0021-4; and
2. directs that the authorised plate shall only be used with the signs to diagram 612 in Schedule 3, Part 2, Item 7 of the Traffic Signs Regulations 2016 (Part 1 of S.I. 2016/362, “the 2016 Regulations”) and diagram 613 in Schedule 3, Part 2, Item 8 of those regulations; and
3. directs that it is a condition of this authorisation that the authorised plate may be placed only to indicate the effect of a corresponding Traffic Regulation Order; and
4. directs, without prejudice to any statutory provision to the like effect, that it is a condition of this authorisation that the erection of the authorised plate at or near the said sites shall continue to have effect only until such day as may be appointed by one month’s notice given by the Secretary of State in writing to the traffic authority for the removal or alteration of the authorised plate and on that day the said authorisation shall, without prejudice to the giving of any further authorisation or direction, cease to have effect.



Department
for Transport



GT50/138/0021

The provisions of Regulations 7 and 8 of the 2016 Regulations shall apply to the authorised plate in the same manner as they apply to the plate described in Schedule 3, Part 3, Item 3 of those Regulations.

Dated *17th October* 2018

Signed by authority of the Secretary of State

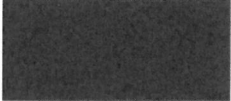

CERTIFIED TRUE COPY	
	
	Date:
Department for Transport	30/10/2018

.....
A Delegated Official of the Department for Transport

© Crown copyright and database rights 2018 Ordnance Survey 100019422
 You are not permitted to copy, sub-license, distribute or sell any of this data to third parties in any form.
 Produced by Staffordshire County Council, 2018.

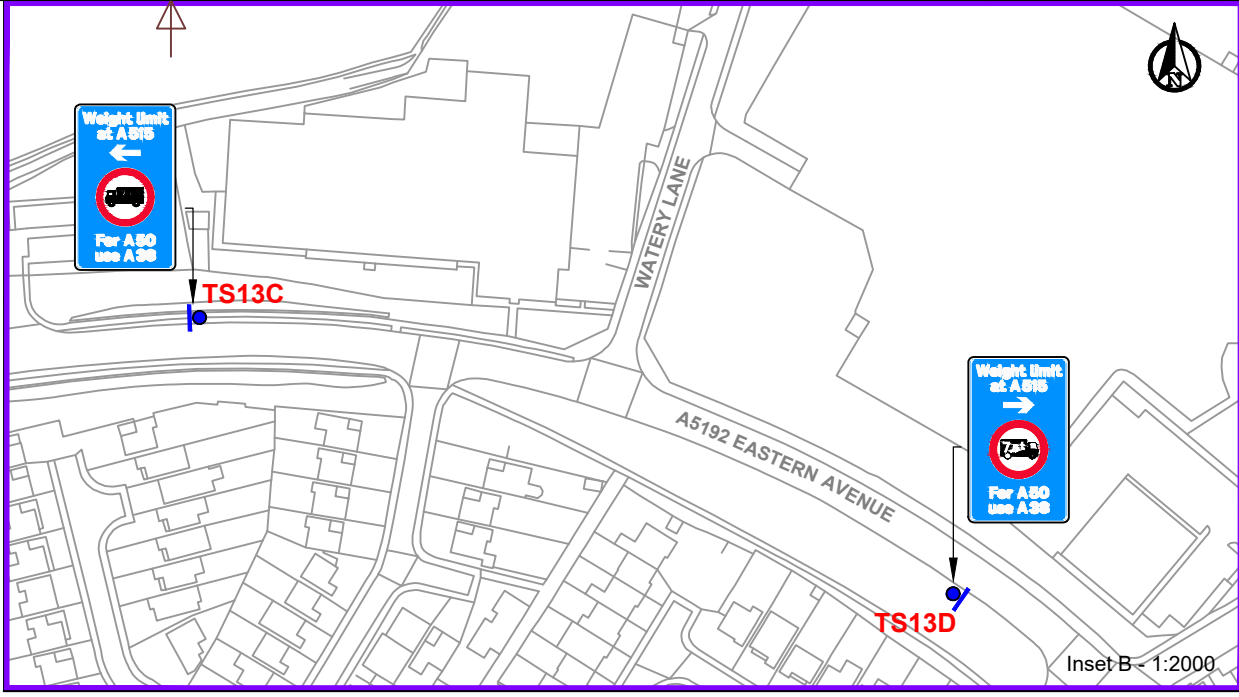
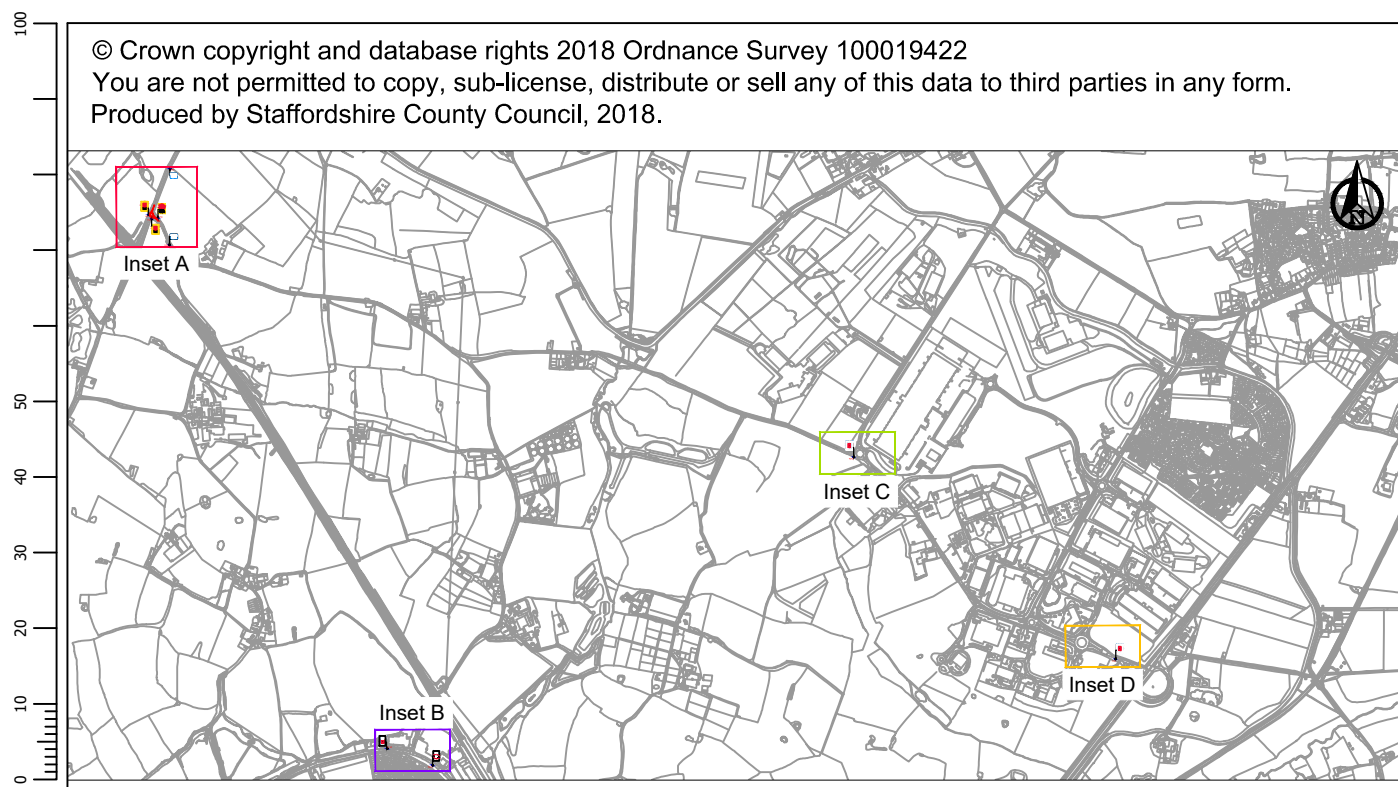

KEY:
 Proposed sign to be mounted to new posts
 Proposed prohibited HGV movement

NOTES:

- To be read in conjunction with *Traffic Signs Schedule* drawing reference D6662T/R12/04-06/P1.
- All road signs and markings to be in accordance with the *Traffic Sign Regulations and General Directions 2016* and all subsequent amendments.
- All signs to have a 2300mm mounting height measured from bottom of sign faceplate to top of finished surface level unless stated otherwise.
- All post and foundation designs to be as per SCC Standard Detail Reference Number HWD-12-54-1-4 unless stated otherwise in *Traffic Sign Schedule* drawing reference: D6662T/R12/04-06/P1.

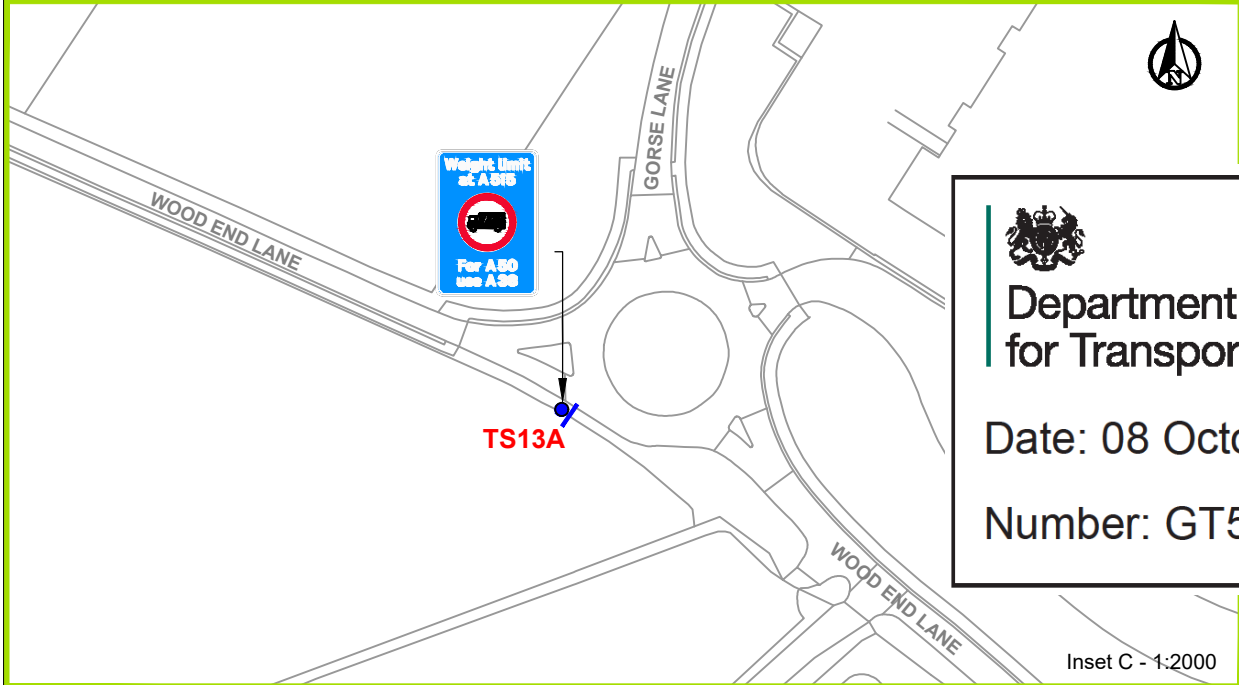
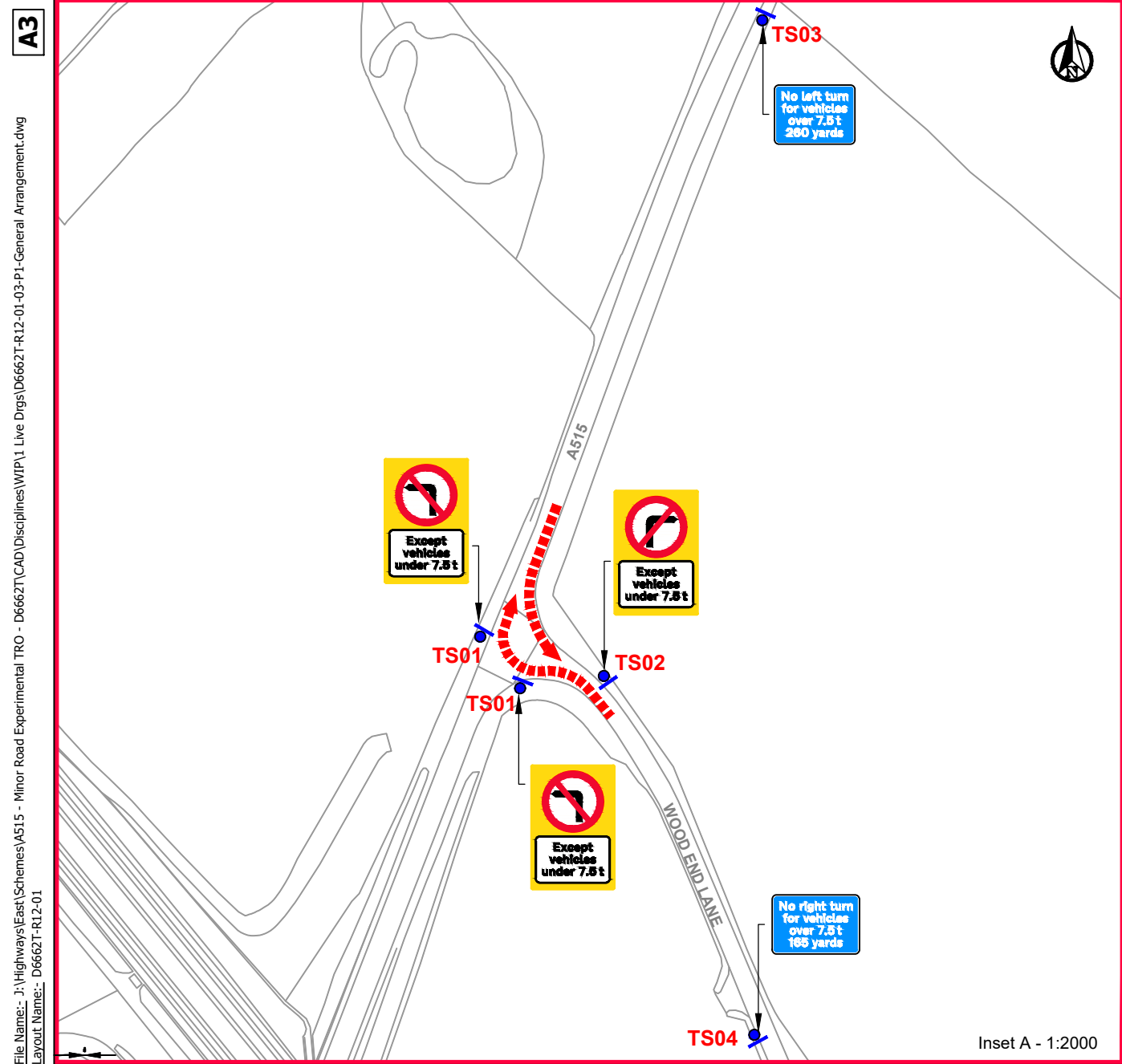

Department for Transport

Date: 08 October 2018

Number: GT50/138/0021-1

Drawn: EHE	For tender
Design: EHE	For construction
Date: June 2018	As constructed
	Other

Checked by:-

Staffordshire County Council

working with

www.staffordshire.gov.uk www.amey.co.uk

Project Name A515 Experimental Traffic Regulation Order	
Drawing Title CONSULTING Sign Locations Wood End Lane/A515	
Grid reference: ---	
Original Drawing Size: A3	Dimensions: m
Scale: 1:2000	Copyright © Amey
Drawing No D6662T/R12/01	Rev P1

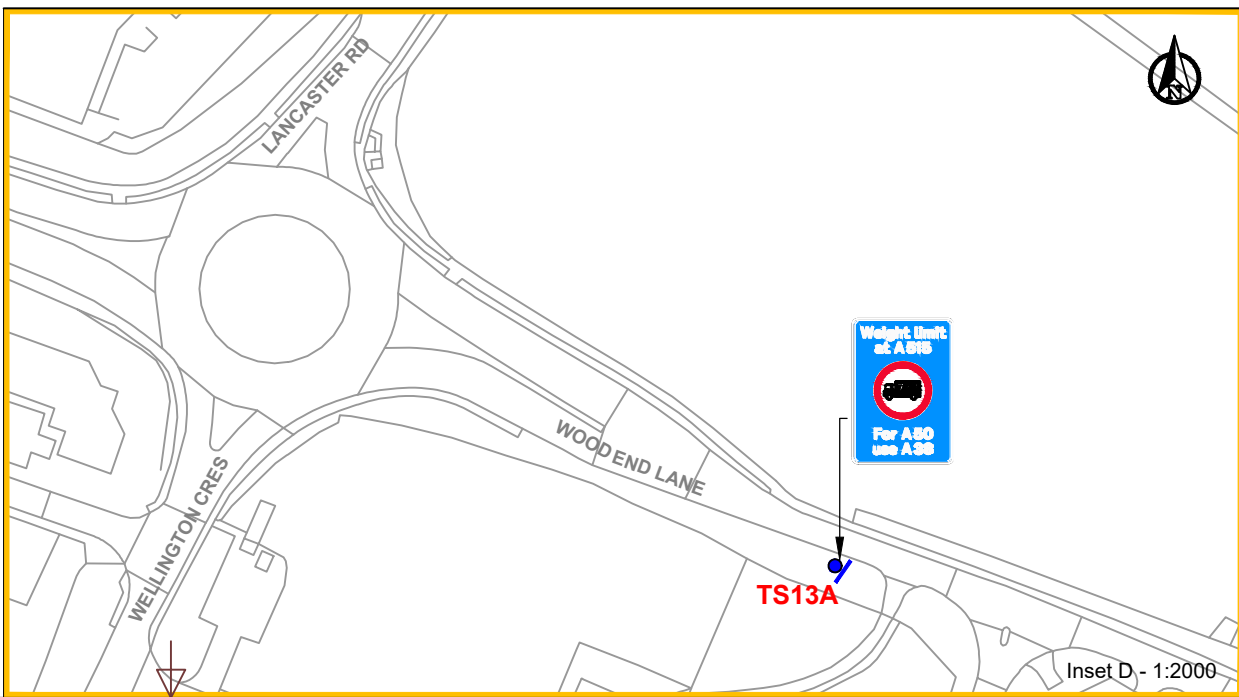

File Name: J:\Highways\East\Schemes\A515 - Minor Road Experimental TRO - D6662T\CAD\Disciplines\WIP\1 Live Drgs\D6662T\R12-01-03-P1-General Arrangement.dwg
 Layout Name: D6662T-R12-01

© Crown copyright and database rights 2018 Ordnance Survey 100019422
 You are not permitted to copy, sub-license, distribute or sell any of this data to third parties in any form.
 Produced by Staffordshire County Council, 2018.

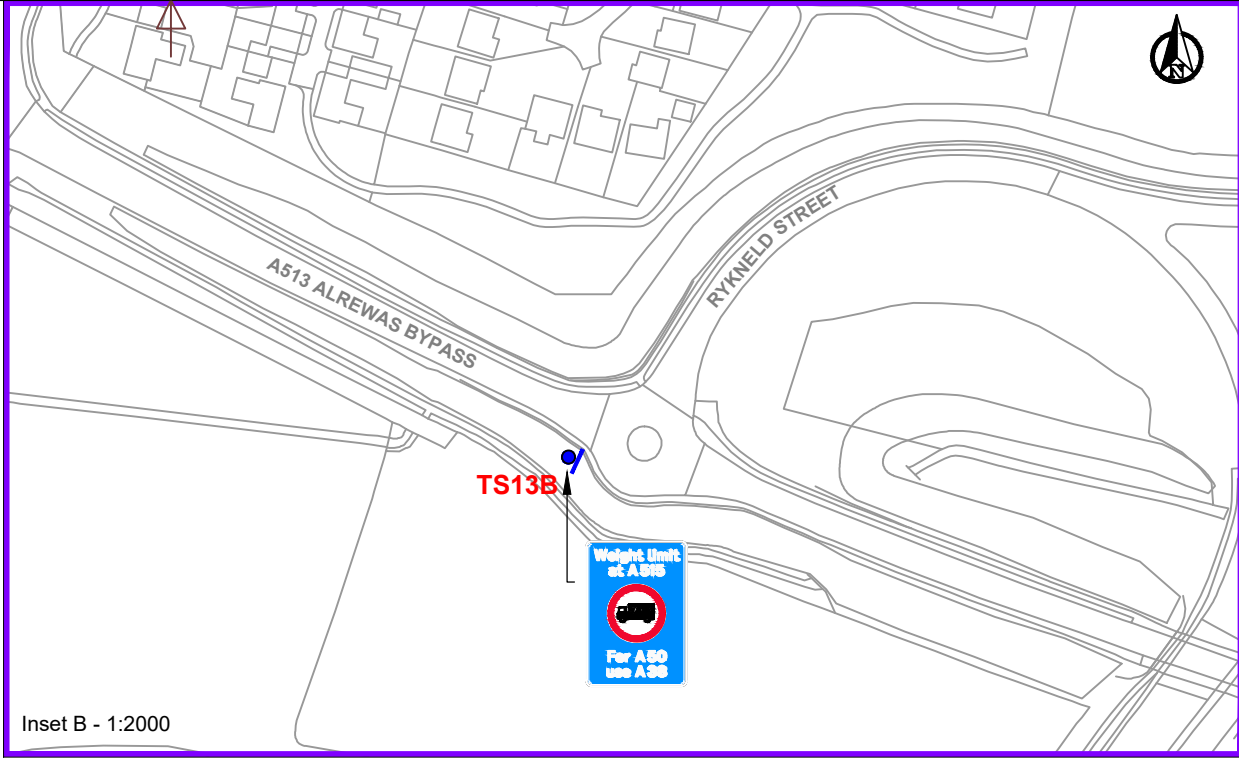

- KEY:**
- Proposed sign to be mounted to new posts
 - Proposed prohibited HGV movement
- NOTES:**
1. To be read in conjunction with *Traffic Signs Schedule* drawing reference D6662T/R12/04-06/P1.
 2. All road signs and markings to be in accordance with the *Traffic Sign Regulations and General Directions 2016* and all subsequent amendments.
 3. All signs to have a 2300mm mounting height measured from bottom of sign faceplate to top of finished surface level unless stated otherwise.
 4. All post and foundation designs to be as per SCC Standard Detail Reference Number HWD-12-54-1-4 unless stated otherwise in *Traffic Sign Schedule* drawing reference: D6662T/R12/04-06/P1.

A3

File Name: J:\Highways\East\Schemes\A515 - Minor Road Experimental TRO - D6662T\CAD\Disciplines\WIP\1 Live Drgs\D6662T-R12-01-03-P1-General Arrangement.dwg
 Layout Name: D6662T-R12-02

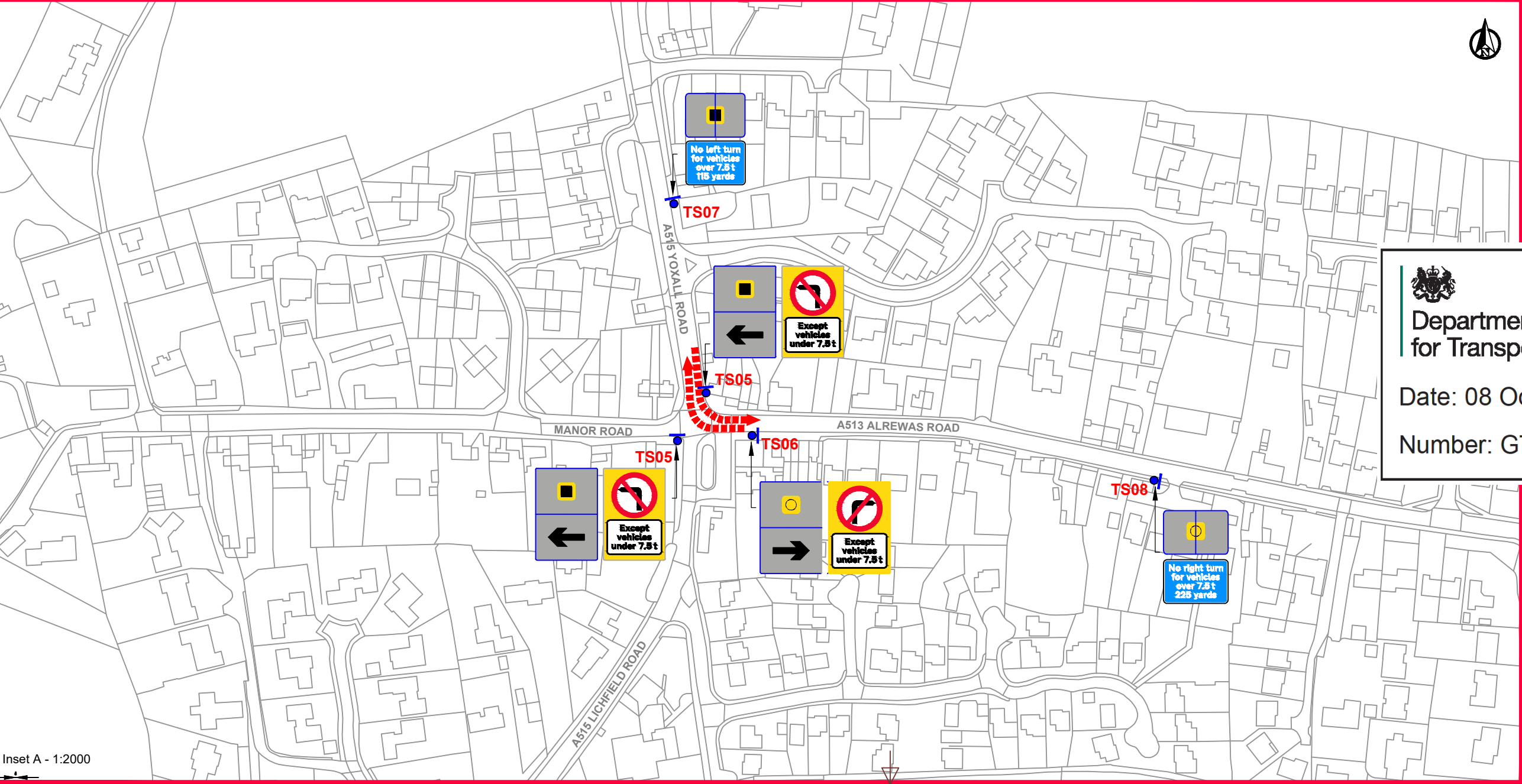

P1	Revised in line with DfT comments and RSA	JP	14/08/2018
----	-------------------------------------------	----	------------

Department for Transport

Date: 08 October 2018

Number: GT50/138/0021-2

Staffordshire County Council
 working with amey

Project Name
 A515 Experimental Traffic Regulation Order

Drawing Title
 CONSULTING
 Sign Locations
 A513/A515 Kings Bromley

Grid reference : ---	
Original Drawing Size : A3 Dimensions : m	
Scale : 1:2000 Copyright © Amey	
Drawing No D6662T/R12/02	Rev P1

Inset A - 1:2000

Inset B - 1:2000

© Crown copyright and database rights 2018 Ordnance Survey 100019422
 You are not permitted to copy, sub-license, distribute or sell any of this data to third parties in any form.
 Produced by Staffordshire County Council, 2018.

100
50
40
30
20
10
0

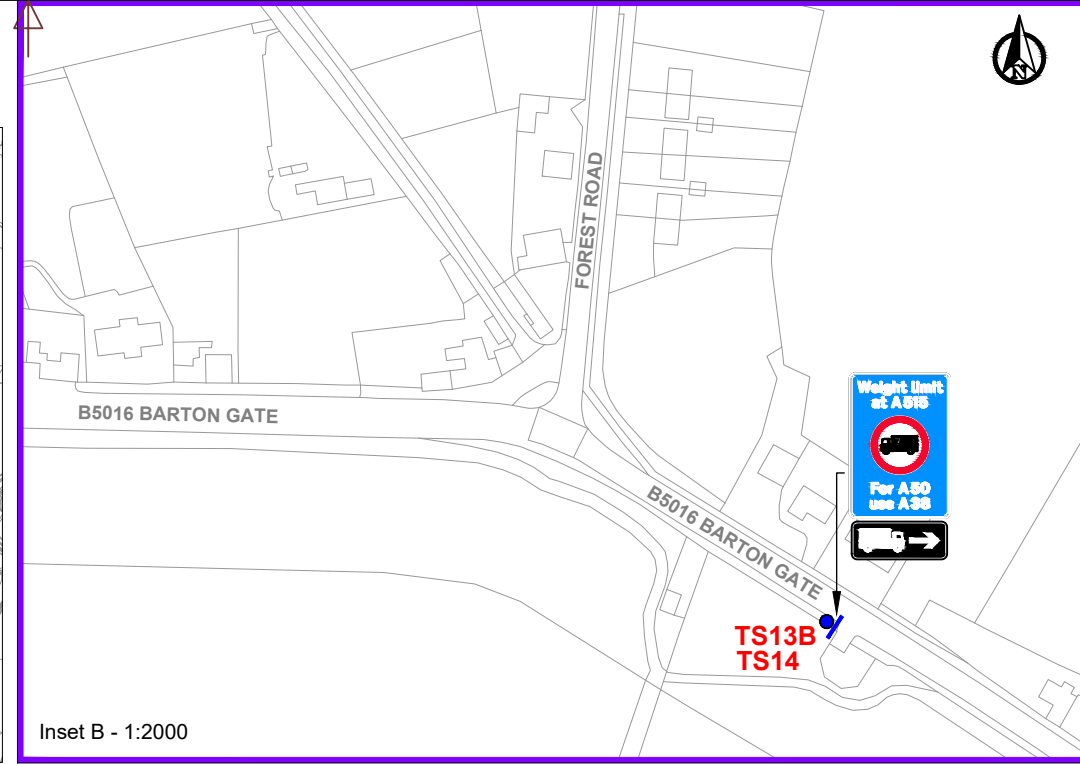
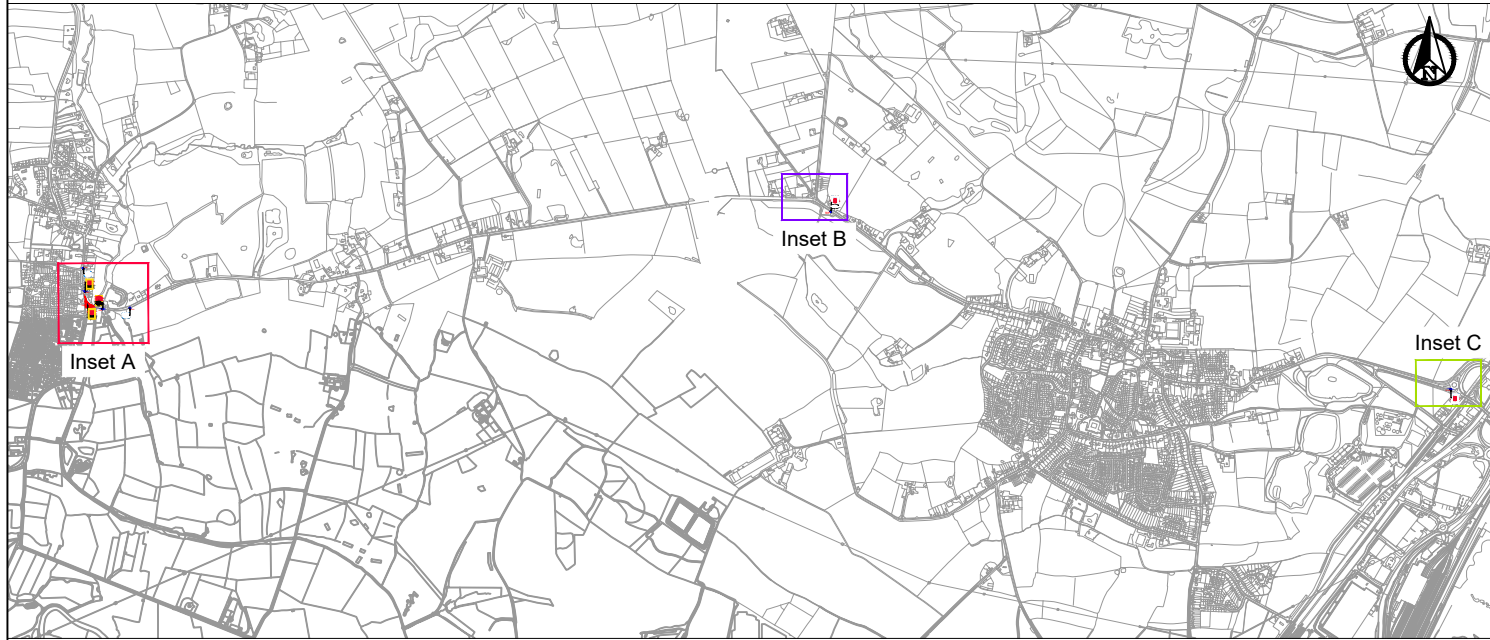

KEY:
 Proposed sign to be mounted to new posts
 Proposed prohibited HGV movement

NOTES:
 1. To be read in conjunction with *Traffic Signs Schedule* drawing reference D6662T/R12/04-06/P1.
 2. All road signs and markings to be in accordance with the *Traffic Sign Regulations and General Directions 2016* and all subsequent amendments.
 3. All signs to have a 2300mm mounting height measured from bottom of sign faceplate to top of finished surface level unless stated otherwise.
 4. All post and foundation designs to be as per SCC Standard Detail Reference Number HWD-12-54-1-4 unless stated otherwise in *Traffic Sign Schedule* drawing reference: D6662T/R12/04-06/P1.

A3

File Name: J:\Highways\East\Schemes\A515 - Minor Road Experimental TRO - D6662T\CAD\Disciplines\WIP\1 Live Drgs\D6662T\R12-01-03-P1-General Arrangement.dwg
 Layout Name: D6662T-R12-03

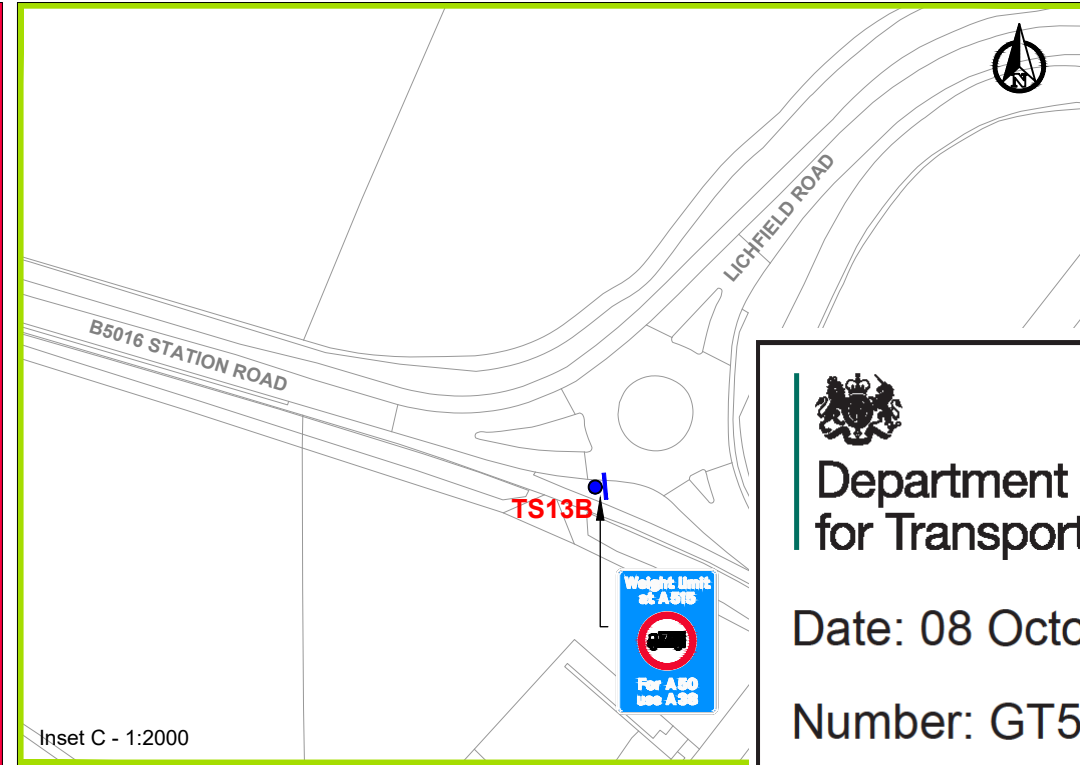
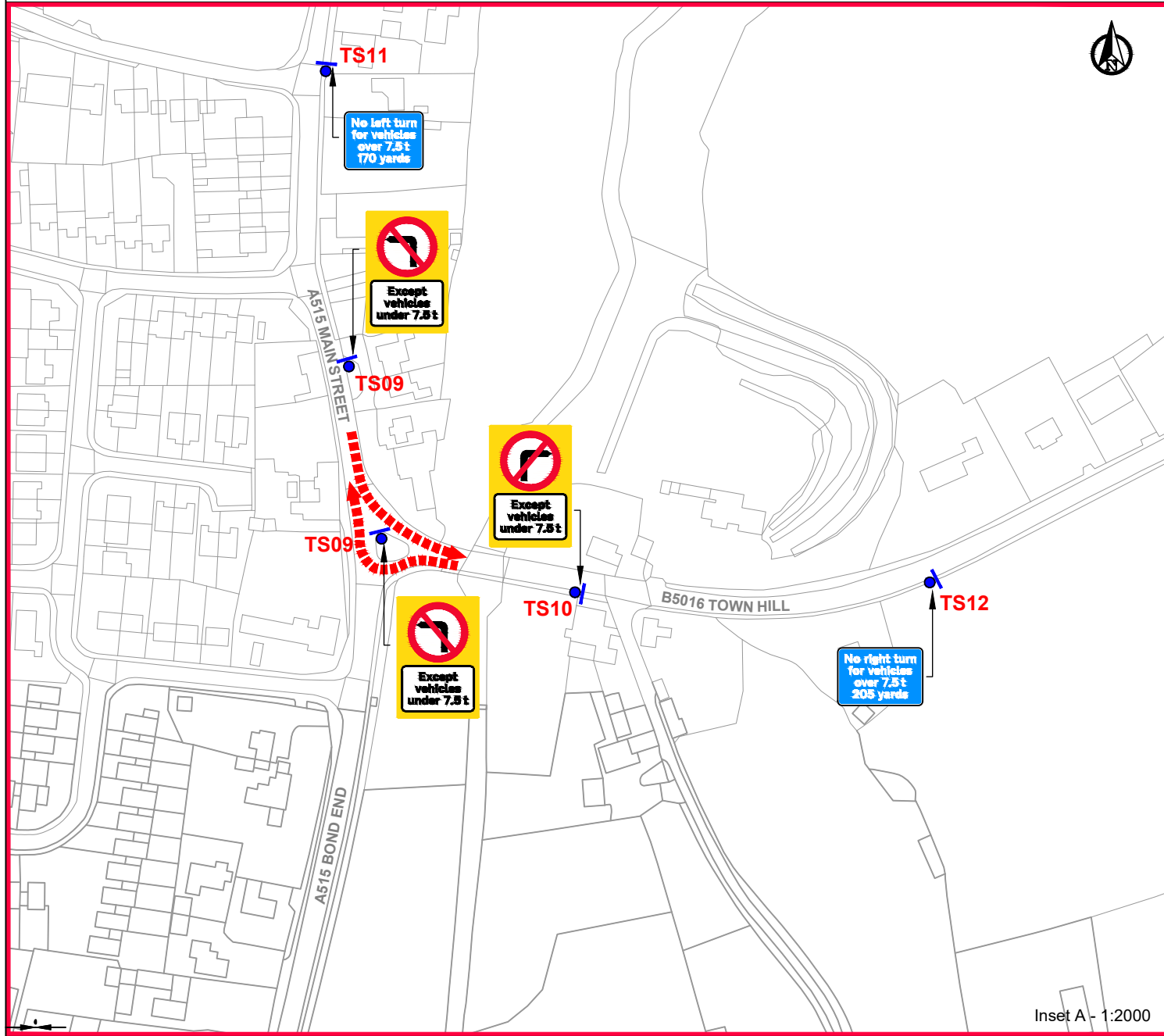

Department for Transport
 Date: 08 October 2018
 Number: GT50/138/0021-3

Staffordshire County Council
 working with
 www.staffordshire.gov.uk www.amey.co.uk

Project Name A515 Experimental Traffic Regulation Order	
Drawing Title CONSULTING Sign Locations B5016/A515 Yoxall	
Grid reference : ---	Original Drawing Size : A3 Dimensions : m
Scale : 1:2000	Copyright © Amey
Drawing No D6662T/R12/03	Rev P1

A3



Sign Reference	TS01 - 613
Height	750mm
Width	750mm
Area	0.44 m ²
Material	Class RA2 (12899-1:2007)
Mount Height	2300

AUTH PLATE	
Scheme Ref.	A515 Experimental TRO
Sign Ref.	TS01 - 613 Sub Plate
Letter colour	BLACK
Background	WHITE
Border	BLACK
Material	Class RA2 (12899-1:2007)
x-height	75.0
SIGN FACE	
Width	923mm
Height	581mm
Area	0.54m ²

Scheme Ref.	A515 Experimental TRO
Sign Ref.	TS01 - 613 Yellow BB
Letter colour	N/A
Background	YELLOW
Border	N/A
Material	Class NR
x-height	75.0
SIGN FACE	
Width	1035mm
Height	1540mm
Area	1.59m ²

Sign Reference - TS01
 Number Required - 4
 (2no. signs mounted as per foundation detail opposite, 2 no. as per TS09 foundation detail)

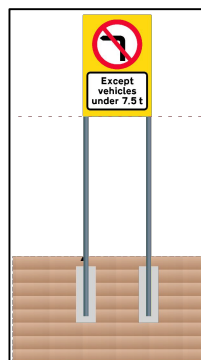

POST(S) & FOUNDATIONS	
Scheme Reference	D6662T
Proposal Name	A515 TS01 613 YBB
Proposal Reference	D6662T
Author	GAP
Description	
Illumination	No
Mounting Height	2100mm
Post Manufacturer	(Unspecified)
Post Model	Steel Round Post/GenericS275SCHS
Post Type	Steel/S275/S275J2H/A570
Further post info	
Post Shape	Circle
Post Size	76.1mm diam x 3.2mm thickness.
Number	2
Centres	938.9mm
Length	Total = 4487.5mm, above ground = 3588mm
No. of Foundations	2
Foundation Depth	850.0mm
Foundation Width	300.0mm diameter
Foundation Length	Circular
Foundation Volume	0.06m ³ each, Total = 0.12m ³
Earth Cover	150.0mm



Scheme Ref.	A515 Experimental TRO
Sign Ref.	TS03
Letter colour	WHITE
Background	BLUE
Border	WHITE
Material	Class RA2 (12899-1:2007)
x-height	100.0
SIGN FACE	
Width	1326mm
Height	975mm
Area	1.29m ²

Sign Reference - TS03
 Number Required - 1

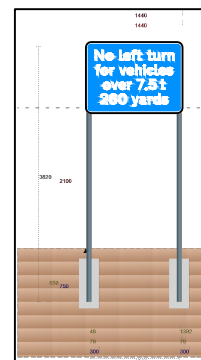

POST(S) & FOUNDATIONS	
Scheme Reference	D6662T
Proposal Name	A515 - TS03
Proposal Reference	D6662T
Author	GAP
Description	
Illumination	No
Mounting Height	1800mm
Post Manufacturer	(Unspecified)
Post Model	Steel Round Post/GenericS275SCHS
Post Type	Steel/S275/S275J2H/A570
Further post info	
Post Shape	Circle
Post Size	76.1mm diam x 3.2mm thickness.
Number	2
Centres	614.9mm
Length	Total = 3425.0mm, above ground = 2725mm
No. of Foundations	2
Foundation Depth	650.0mm
Foundation Width	300.0mm diameter
Foundation Length	Circular
Foundation Volume	0.046m ³ each, Total = 0.09m ³
Earth Cover	150.0mm

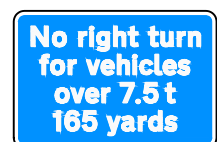

Scheme Ref.	A515 Experimental TRO
Sign Ref.	TS04
Letter colour	WHITE
Background	BLUE
Border	WHITE
Material	Class RA2 (12899-1:2007)
x-height	100.0
SIGN FACE	
Width	1440mm
Height	975mm
Area	1.40m ²

Sign Reference - TS04
 Number Required - 1

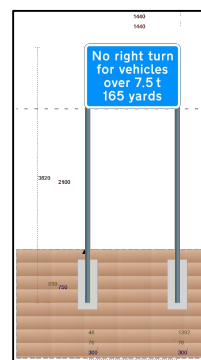

POST(S) & FOUNDATIONS	
Scheme Reference	J:\Highways\East\Schemes\A515 - Minor Ro
Proposal Name	A515 TS04
Proposal Reference	J:\Highways\East\Schemes\A515 - Minor Ro
Author	GAP
Description	
Illumination	No
Mounting Height	2100mm
Post Manufacturer	(Unspecified)
Post Model	Steel Round Post/GenericS275SCHS
Post Type	Steel/S275/S275J2H/A570
Further post info	
Post Shape	Circle
Post Size	76.1mm diam x 3.2mm thickness.
Number	2
Centres	1343.9mm
Length	Total = 3819.5mm, above ground = 3020mm
No. of Foundations	2
Foundation Depth	750.0mm
Foundation Width	300.0mm diameter
Foundation Length	Circular
Foundation Volume	0.046m ³ each, Total = 0.09m ³
Earth Cover	150.0mm



Sign Reference	TS02 - 612
Height	750mm
Width	750mm
Area	0.44 m ²
Material	Class RA2 (12899-1:2007)
Mount Height	2300

Scheme Ref.	A515 Experimental TRO
Sign Ref.	TS02 - 612 Sub Plate
Letter colour	BLACK
Background	WHITE
Border	BLACK
Material	Class RA2 (12899-1:2007)
x-height	75.0
SIGN FACE	
Width	923mm
Height	581mm
Area	0.54m ²

Scheme Ref.	A515 Experimental TRO
Sign Ref.	TS02 - 612 Yellow BB
Letter colour	N/A
Background	YELLOW
Border	N/A
Material	Class NR
x-height	75.0
SIGN FACE	
Width	1035mm
Height	1540mm
Area	1.59m ²

Sign Reference - TS02
 Number Required - 2
 (1no. sign mounted as per foundation design opposite, 1 no. as per TS10 foundation detail)

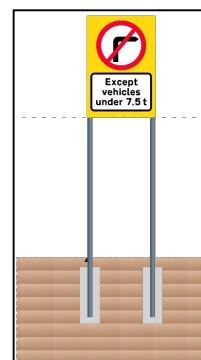

POST(S) & FOUNDATIONS	
Scheme Reference	D6662T
Proposal Name	A515 TS02 612 YBB
Proposal Reference	D6662T
Author	GAP
Description	
Illumination	No
Mounting Height	2100mm
Post Manufacturer	(Unspecified)
Post Model	Steel Round Post/GenericS275SCHS
Post Type	Steel/S275/S275J2H/A570
Further post info	
Post Shape	Circle
Post Size	76.1mm diam x 3.2mm thickness.
Number	2
Centres	938.9mm
Length	Total = 4487.5mm, above ground = 3588mm
No. of Foundations	2
Foundation Depth	850.0mm
Foundation Width	300.0mm diameter
Foundation Length	Circular
Foundation Volume	0.06m ³ each, Total = 0.12m ³
Earth Cover	150.0mm



Scheme Ref.	A515 Experimental TRO
Sign Ref.	TS13A
Letter colour	WHITE
Background	BLUE
Border	WHITE
Material	Class RA2 (12899-1:2007)
x-height	125.0
SIGN FACE	
Width	1663mm
Height	2391mm
Area	3.98m ²

Sign Reference - TS13A
 Number Required - 2

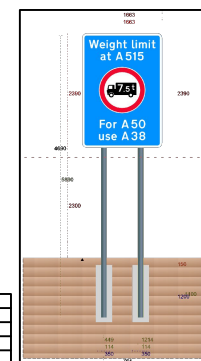

POST(S) & FOUNDATIONS	
Scheme Reference	D6662T
Proposal Name	A515 TS13A
Proposal Reference	D6662T
Author	GAP
Description	
Illumination	No
Mounting Height	2300mm
Post Manufacturer	(Unspecified)
Post Model	Steel Round Post/GenericS275SCHS
Post Type	Steel/S275/S275J2H/A570
Further post info	
Post Shape	Circle
Post Size	114.3mm diam x 3.6mm thickness.
Number	2
Centres	764.3mm
Length	Total = 5890.0mm, above ground = 4640mm
No. of Foundations	2
Foundation Depth	1200.0mm
Foundation Width	350.0mm diameter
Foundation Length	Circular
Foundation Volume	0.115m ³ each, Total = 0.23m ³
Earth Cover	150.0mm



Scheme Ref.	A515 Experimental TRO
Sign Ref.	TS 13C B18.4L
Letter colour	WHITE
Background	BLUE
Border	WHITE
Material	Class RA2 (12899-1:2007)
x-height	100.0
SIGN FACE	
Width	1330mm
Height	2190mm
Area	2.91m ²

Sign Reference - TS13C
 Number Required - 1



Scheme Ref.	A515 Experimental TRO
Sign Ref.	TS 13D B18.4R
Letter colour	WHITE
Background	BLUE
Border	WHITE
Material	Class RA2 (12899-1:2007)
x-height	100.0
SIGN FACE	
Width	1330mm
Height	2190mm
Area	2.91m ²

Sign Reference - TS13D
 Number Required - 1



POST(S) & FOUNDATIONS	
Scheme Reference	D6662T
Proposal Name	A515 - TS13C and D
Proposal Reference	D6662T
Author	JP
Description	
Illumination	No
Mounting Height	2310mm
Post Manufacturer	(Unspecified)
Post Model	Steel Round Post/GenericS275SCHS
Post Type	Steel/S275/S275J2H/A570
Further post info	
Post Shape	Circle
Post Size	114.3mm diam x 5.0mm thickness.
Number	2
Centres	598.3mm
Length	Total = 5737.5mm, above ground = 4448mm
No. of Foundations	2
Foundation Depth	1250.0mm
Foundation Width	350.0mm diameter
Foundation Length	Circular
Foundation Volume	0.120m ³ each, Total = 0.24m ³
Earth Cover	140.0mm

- NOTES:**
- To be read in conjunction with Sign Locations drawing reference D6662T/R12/01-03/P1.
 - All road signs and markings to be in accordance with the Traffic Sign Regulations and General Directions 2016 and all subsequent amendments.
 - All signs to have a 2300mm mounting height measured from bottom of sign faceplate to top of finished surface level unless stated otherwise.
 - All post and foundation designs to be as per SCC Standard Detail Reference Number HWD-12-54-1-4 unless stated otherwise in Traffic Sign Schedule drawing reference: D6662T/R12/04-06/P1.
 - EDR symbol is indicative only and to be confirmed with Highways England.

P1	Revised in line with DFT comments and RSA	JP	15/08/2018
Rev	Detail	By	Date
Revisions			
Original Version		Preliminary	✓
		For comment	
		For tender	
		For construction	
		As constructed	
		Other	
Date:	June 2018		

Department for Transport
 Date: 08 October 2018
 Number: GT50/138/0021-4

Drawing Title	
CONSULTING Sign Schedule Wood End Lane/A515	
Grid reference:	N/A
Original Drawing Size:	A3
Scale:	NTS
Dimensions:	m
Copyright:	© Arney
Drawing No	D6662T/R12/04
Rev	P1