



Department
for Transport

Road Traffic Regulation Act 1984 Sections 64 and 65

Authorisation of traffic signs and special directions

Accessible transcript

Secretary of State for Transport's traffic authorisation of signs/markings for the purpose of informing road users of the current operating conditions of ferries in the Isle of Wight authorises the display of the following legends on variable message signs (VMS).

The following pages contain a copy of the text from the Secretary of State for Transport's traffic authorisation regarding the above sign/marking.

A scanned copy of the signed authorisation and supporting signs/markings from the application are appended to this letter. The supporting material is submitted to the Department for Transport by a third party. You should refer to the party involved for accessible copies of the supporting material.



ROAD TRAFFIC REGULATION ACT 1984 – SECTIONS 64 AND 65
AUTHORISATION OF TRAFFIC SIGNS AND SPECIAL DIRECTIONS

The Secretary of State for Transport, in exercise of his powers under Sections 64 and 65 of the Road Traffic Regulation Act 1984, and of all other powers enabling him in that behalf, for the purpose of informing road users of the current operating conditions of ferries in the Isle of Wight; hereby:-

1. authorises at or within 5 metres of the locations shown in the attached set of plans numbered GT50/059/0019-1, GT50/059/0019-2, GT50/059/0019-3 and GT50/059/0019-4 for which the Isle of Wight Council is the traffic authority, the display of the following legends (hereinafter referred to as “the authorised legends”) on variable message signs (VMS) as defined in Schedule 1 of The Traffic Signs Regulations 2016 (Part 1 of S.I. 2016/362, “the 2016 Regulations”):
 - i. Ferries Now Running to Timetable
 - ii. No Access to Ferry Terminal until 45 Min Before Departure
 - iii. No Access to Ferry Terminal until 1 Hour Before Departure
 - iv. 15-Minute Delay to Car Ferry Service
 - v. 30-Minute Delay to Car Ferry Service
 - vi. 45-Minute Delay to Car Ferry Service
 - vii. 60-Minute Delay to Car Ferry Service
 - viii. 90-Minute Delay to Car Ferry Service
 - ix. 2-Hour Delay to Car Ferry Service



- x. No Vehicle Access to Car Ferry Terminal
 - xi. Car Ferry Service Suspended
 - xii. Hi-Speed Service Suspended
 - xiii. Floating Bridge - Service Suspended
 - xiv. Floating Bridge - Limited Service
 - xv. Floating Bridge - Foot Passengers Only
 - xvi. Floating Bridge - Now Operating Normally
2. directs that the authorised legends may be displayed in upper case text; and
 3. directs that an authorised legend shall be individually displayed only at such times as are appropriate to indicate the conditions it describes apply and that when not showing any of the authorised legends the sign shall display a blank grey or black face; and
 4. directs, without prejudice to any statutory provision to the like effect, that it is a condition of this authorisation that the use of the authorised legends shall continue to have effect only until such day as may be appointed by one month's notice given by the Secretary of State in writing to the traffic authority for the removal or alteration of the authorised legends and on that day the said authorisation shall, without prejudice to the giving of any further authorisation or direction, cease to have effect.



The provisions of Schedule 16 to the 2016 Regulations shall apply to the authorised legends in the same manner as they apply to the legends described in Schedule 16 to those Regulations.

Dated: *06 April 2020*

Signed by authority of the Secretary of State

.....

A Delegated Official of the Department for Transport



Department
for Transport

**SCANNED
AUTHORISATION AND
MAPS / DRAWINGS
FOLLOW**



ROAD TRAFFIC REGULATION ACT 1984 – SECTIONS 64 AND 65
AUTHORISATION OF TRAFFIC SIGNS AND SPECIAL DIRECTIONS

The Secretary of State for Transport, in exercise of his powers under Sections 64 and 65 of the Road Traffic Regulation Act 1984, and of all other powers enabling him in that behalf, for the purpose of informing road users of the current operating conditions of ferries in the Isle of Wight; hereby:-

1. authorises at or within 5 metres of the locations shown in the attached set of plans numbered GT50/059/0019-1, GT50/059/0019-2, GT50/059/0019-3 and GT50/059/0019-4 for which the Isle of Wight Council is the traffic authority, the display of the following legends (hereinafter referred to as “the authorised legends”) on variable message signs (VMS) as defined in Schedule 1 of The Traffic Signs Regulations 2016 (Part 1 of S.I. 2016/362, “the 2016 Regulations”):
 - i. Ferries Now Running to Timetable
 - ii. No Access to Ferry Terminal until 45 Min Before Departure
 - iii. No Access to Ferry Terminal until 1 Hour Before Departure
 - iv. 15-Minute Delay to Car Ferry Service
 - v. 30-Minute Delay to Car Ferry Service
 - vi. 45-Minute Delay to Car Ferry Service
 - vii. 60-Minute Delay to Car Ferry Service
 - viii. 90-Minute Delay to Car Ferry Service
 - ix. 2-Hour Delay to Car Ferry Service



- x. No Vehicle Access to Car Ferry Terminal
 - xi. Car Ferry Service Suspended
 - xii. Hi-Speed Service Suspended
 - xiii. Floating Bridge - Service Suspended
 - xiv. Floating Bridge - Limited Service
 - xv. Floating Bridge - Foot Passengers Only
 - xvi. Floating Bridge - Now Operating Normally
2. directs that the authorised legends may be displayed in upper case text; and
 3. directs that an authorised legend shall be individually displayed only at such times as are appropriate to indicate the conditions it describes apply and that when not showing any of the authorised legends the sign shall display a blank grey or black face; and
 4. directs, without prejudice to any statutory provision to the like effect, that it is a condition of this authorisation that the use of the authorised legends shall continue to have effect only until such day as may be appointed by one month's notice given by the Secretary of State in writing to the traffic authority for the removal or alteration of the authorised legends and on that day the said authorisation shall, without prejudice to the giving of any further authorisation or direction, cease to have effect.



The provisions of Schedule 16 to the 2016 Regulations shall apply to the authorised legends in the same manner as they apply to the legends described in Schedule 16 to those Regulations.

Dated: *06 April 2020*

Signed by authority of the Secretary of State

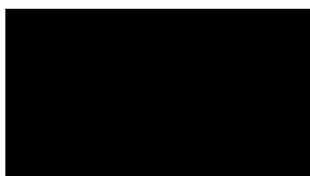
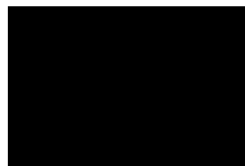

.....
A Delegated Official of the Department for Transport



Department for Transport

Date: 06 April 2020

Number: GT50/059/0019-1

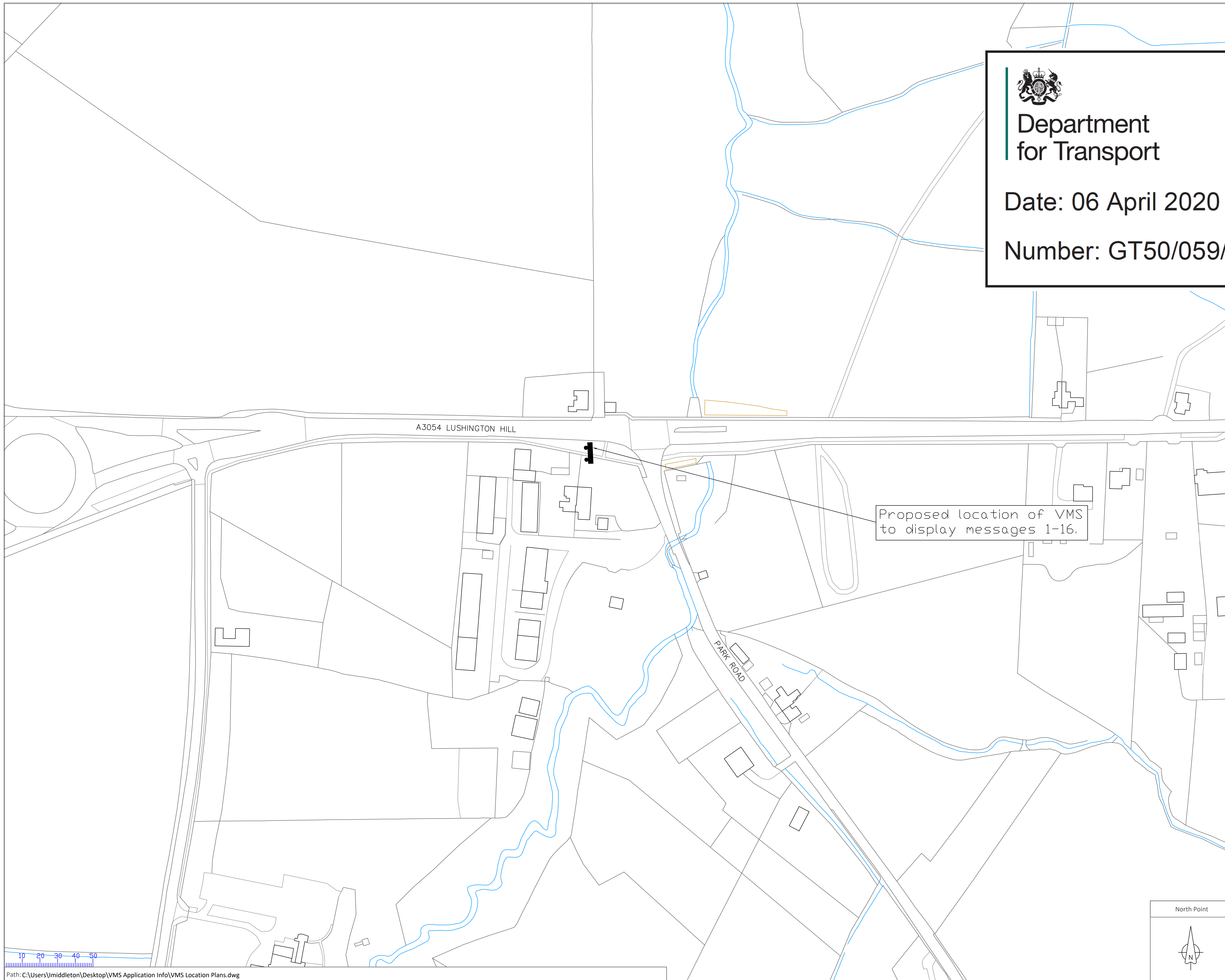

Based upon the Ordnance Survey mapping with permission of the Controller of Her Majesty's Stationery Office. © Crown Copyright Unauthorised reproduction infringes Crown copyright and may lead to prosecution or civil proceedings

Isle of Wight Council Licence No. 100019229.2008

Rev.	Description	Initials	Date

Proposed location of VMS to display messages 1-16.

\\A:\AutoCAD Templates\TVC logo landscape colour.dwg

\\A:\AutoCAD Templates\logo_island-roads.dwg
Island Roads
St. Christopher House
42 Daish Way
Newport
Isle of Wight
PO30 5XJ

Paul Herbert
Service Director, Island Roads

Classification UNMARKED

Presentation

Project
Floating Bridge - Variable Message Signs

Drawing Title
Lushington Hill VMS Location

Drawn	IWM	Date	Mar 2020
Checked		Date	
Approved		Date	
Scale	1:1000@A1	Revision	
Contract Sheet No.		Sheet x of x	
Drawing Number			

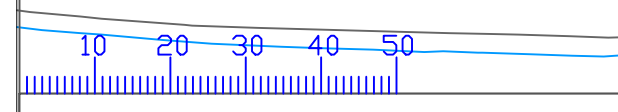
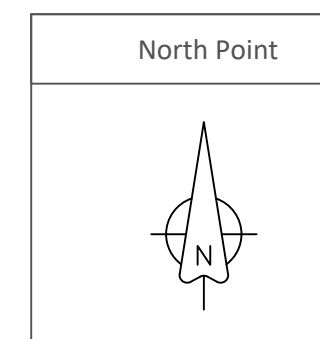



Department for Transport

Date: 06 April 2020

Number: GT50/059/0019-2



Proposed location of VMS to display messages 12-16.

Based upon the Ordnance Survey mapping with permission of the Controller of Her Majesty's Stationery Office. © Crown Copyright Unauthorised reproduction infringes Crown copyright and may lead to prosecution or civil proceedings

Isle of Wight Council Licence No. 100019229.2008

Rev.	Description	Initials	Date

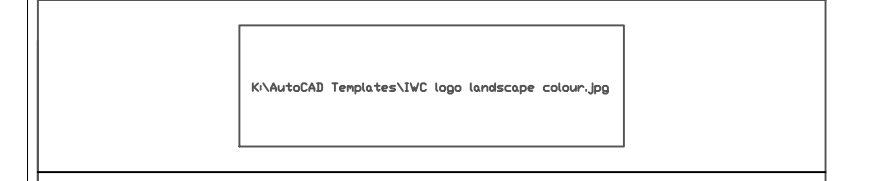

Island Roads
St. Christopher House
42 Daish Way
Newport
Isle of Wight
PO30 5XJ

Paul Herbert
Service Director, Island Roads

Classification UNMARKED

Presentation

Project Floating Bridge Variable Message Signs

Drawing Title Newport Road, Northwood - VMS Location

Drawn	IWM	Date	Mar 2020
Checked		Date	
Approved		Date	
Scale	1:1000@A1	Revision	
Contract Sheet No.		Sheet	x of x
Drawing Number			

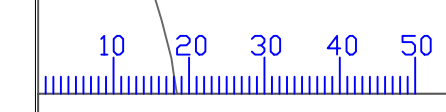
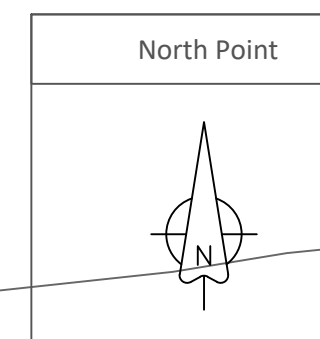



Department for Transport

Date: 06 April 2020

Number: GT50/059/0019-3

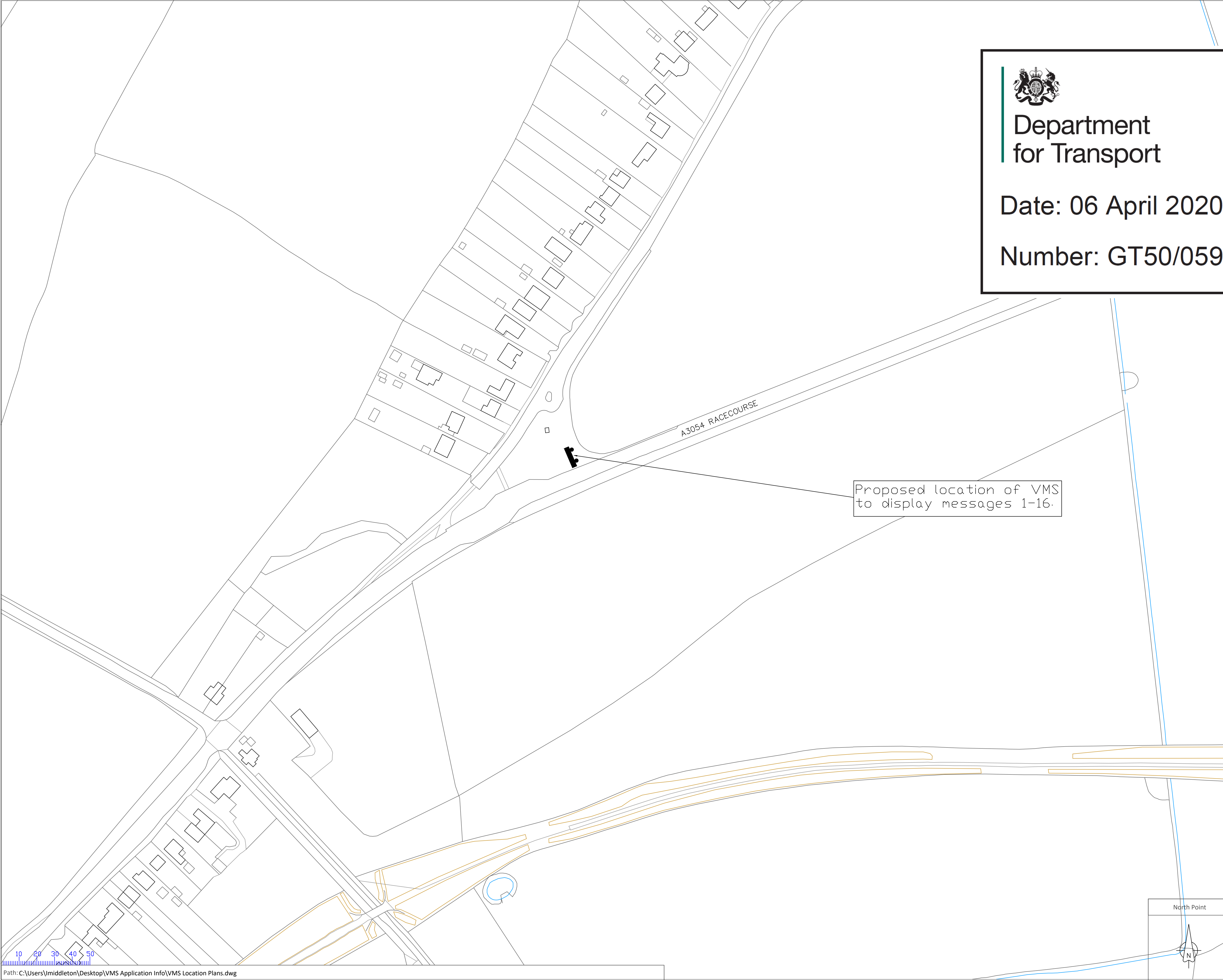

Based upon the Ordnance Survey mapping with permission of the Controller of Her Majesty's Stationery Office. © Crown Copyright Unauthorised reproduction infringes Crown copyright and may lead to prosecution or civil proceedings

Isle of Wight Council Licence No. 100019229.2008

Rev.	Description	Initials	Date



Island Roads
St. Christopher House
42 Daish Way
Newport
Isle of Wight
PO30 5XJ

Paul Herbert
Service Director, Island Roads

Classification UNMARKED

Presentation

Project
Floating Bridge - Variable Message Signs

Drawing Title
Racecourse VMS Location

Drawn	IWM	Date	Mar 2020
Checked		Date	
Approved		Date	
Scale	1:1000@A1	Revision	
Contract Sheet No.		Sheet x of x	
Drawing Number			

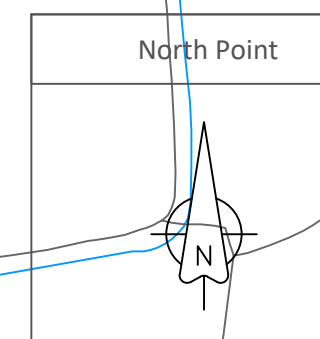



Department for Transport

Date: 06 April 2020

Number: GT50/059/0019-4



Proposed location of VMS to display messages 1-16.

Based upon the Ordnance Survey mapping with permission of the Controller of Her Majesty's Stationery Office. © Crown Copyright Unauthorised reproduction infringes Crown copyright and may lead to prosecution or civil proceedings

Isle of Wight Council Licence No. 100019229.2008

Rev.	Description	Initials	Date



Island Roads
St. Christopher House
42 Daish Way
Newport
Isle of Wight
PO30 5XJ

Paul Herbert
Service Director, Island Roads

Classification UNMARKED

Presentation

Project
Floating Bridge - Variable Message Signs

Drawing Title
Whippingham Road VMS Location

Drawn	IWM	Date	Mar 2020
Checked		Date	
Approved		Date	
Scale	1:1000@A1	Revision	
Contract Sheet No.		Sheet x of x	
Drawing Number			

