



Department
for Transport

Road Traffic Regulation Act 1984 Sections 64 and 65

Authorisation of traffic signs and special directions

Accessible transcript

Secretary of State for Transport's traffic authorisation of signs/markings for the purpose of informing road users of an exception for vehicles less than 7.5t to a right turn prohibition at the junction of Queensway and Inverness Place in London.

The following pages contain a copy of the text from the Secretary of State for Transport's traffic authorisation regarding the above sign/marking.

A scanned copy of the signed authorisation and supporting signs/markings from the application are appended to this letter. The supporting material is submitted to the Department for Transport by a third party. You should refer to the party involved for accessible copies of the supporting material.



**ROAD TRAFFIC REGULATION ACT 1984 – SECTIONS 64 AND 65
AUTHORISATION OF TRAFFIC SIGNS AND SPECIAL DIRECTIONS**

The Secretary of State for Transport, in exercise of his powers under Sections 64 and 65 of the Road Traffic Regulation Act 1984, and of all other powers enabling him in that behalf, for the purpose of informing road users of an exception for vehicles less than 7.5t to a right turn prohibition at the junction of Queensway and Inverness Place in London, hereby:-

1. authorises the erection at or within 5 metres of the site shown schematically on the attached plan numbered GT50/024/0077-1 for which Westminster City Council is the traffic authority of a traffic sign consisting of a plate (hereinafter referred to as “the authorised plate”) conforming as to size, colour and character with that shown as “AUTH PLATE” on the attached drawing numbered GT50/024/0077-2; and
2. directs that the authorised plate shall only be used with the sign to diagram 612 in Schedule 3, Part 2, Item 7 of the Traffic Signs Regulations 2016 (Part 1 of S.I. 2016/362, “the 2016 Regulations”); and
3. directs that it is a condition of this authorisation that the authorised plate may be placed only to indicate the effect of a corresponding Traffic Regulation Order; and
4. directs, without prejudice to any statutory provision to the like effect, that it is a condition of this authorisation that the erection of the authorised plate at or near the said site shall continue to have effect only until such day as may be appointed by one month’s notice given by the Secretary of State in writing to the traffic authority for the removal or alteration of the authorised plate and on that day the said authorisation shall, without prejudice to the giving of any further authorisation or direction, cease to have effect.



The provisions of Regulations 7, 8 and 11 of the 2016 Regulations shall apply to the authorised plate in the same manner as they apply to the plate described in Schedule 3, Part 3, Item 3 of those Regulations.

Dated *17 June 2020*

Signed by authority of the Secretary of State

.....

A Delegated Official of the Department for Transport



Department
for Transport

**SCANNED
AUTHORISATION AND
MAPS / DRAWINGS
FOLLOW**



**ROAD TRAFFIC REGULATION ACT 1984 – SECTIONS 64 AND 65
AUTHORISATION OF TRAFFIC SIGNS AND SPECIAL DIRECTIONS**

The Secretary of State for Transport, in exercise of his powers under Sections 64 and 65 of the Road Traffic Regulation Act 1984, and of all other powers enabling him in that behalf, for the purpose of informing road users of an exception for vehicles less than 7.5t to a right turn prohibition at the junction of Queensway and Inverness Place in London, hereby:-

1. authorises the erection at or within 5 metres of the site shown schematically on the attached plan numbered GT50/024/0077-1 for which Westminster City Council is the traffic authority of a traffic sign consisting of a plate (hereinafter referred to as “the authorised plate”) conforming as to size, colour and character with that shown as “AUTH PLATE” on the attached drawing numbered GT50/024/0077-2; and
2. directs that the authorised plate shall only be used with the sign to diagram 612 in Schedule 3, Part 2, Item 7 of the Traffic Signs Regulations 2016 (Part 1 of S.I. 2016/362, “the 2016 Regulations”); and
3. directs that it is a condition of this authorisation that the authorised plate may be placed only to indicate the effect of a corresponding Traffic Regulation Order; and
4. directs, without prejudice to any statutory provision to the like effect, that it is a condition of this authorisation that the erection of the authorised plate at or near the said site shall continue to have effect only until such day as may be appointed by one month’s notice given by the Secretary of State in writing to the traffic authority for the removal or alteration of the authorised plate and on that day the said authorisation shall, without prejudice to the giving of any further authorisation or direction, cease to have effect.





The provisions of Regulations 7, 8 and 11 of the 2016 Regulations shall apply to the authorised plate in the same manner as they apply to the plate described in Schedule 3, Part 3, Item 3 of those Regulations.

Dated *17 June 2020*

Signed by authority of the Secretary of State



CERTIFIED TRUE COPY	
	
	
Department for Transport	Date: 25/06/2020

.....
A Delegated Official of the Department for Transport

\\uk.wspgroup.com\central_data\Projects\70037081 - Queensway\02_MIP\TO_Traffic_Orders\01_Model\05_For_Construction\70037081-WSP-P05-DFT-02.dwg 15 Jun, 2020 - 5:53pm

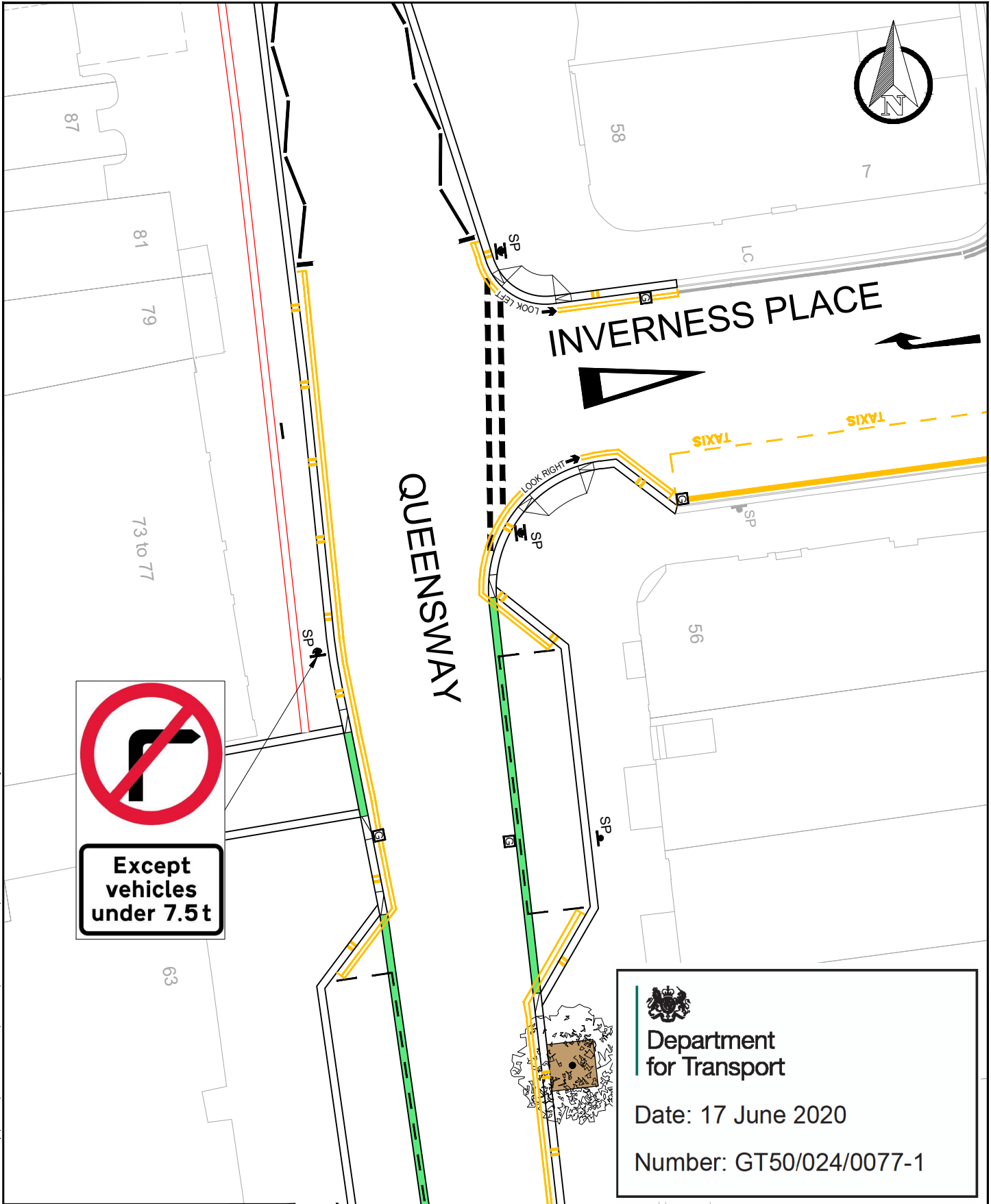

 **Department for Transport**
 Date: 17 June 2020
 Number: GT50/024/0077-1

© Crown copyright. All rights reserved City of Westminster LA 100019597

 25 Mandela Way, London, SE1 5SZ
 www.fmconway.co.uk www.wsp.com

CLIENT:

City of Westminster

DRAWING STATUS:	SKETCH
PROJECT:	QUEENSWAY PUBLIC REALM IMPROVEMENTS
TITLE:	REQUEST FOR DFT APPROVAL QUEENSWAY JUNCTION WITH INVERNESS TERRACE RIGHT TURN BAN - EXCEPT FOR VEHICLES UNDER 7.5T

REV	DATE	BY	DESCRIPTION	CHK	APD
-	DD.MM.YY	ENG	LINE 1 LINE 2	CHKD	APPVD
SCALE @ A4P	DATE	DESIGN/DRN	CHECKED	APPROVED	SHEET
1:200	15.05.2020	MC			A4P
WSP PROJECT No. 70037081	FMC PROJECT No. WWESA1051	WCC PROJECT No. WA1902PT9			
DRAWING No: 70037081-WSP-P05-DFT-02					REV: A



Scale 1:5
Dimensions (in mm):
Width: 600, Height: 600
Width: 609, Height: 388
x-Height: 50
Area: 0.52 sq m
Colours:
 black on white

Queensway
Right turn ban except for
vehicles under 7.5 t

Material: EN 12899 Ref 2 (RA2/R2)
TSRGD 2002 Diag No: 612 & 954
TSRGD 2016 (S.P.I): 3.2.7 & 3.3.3
TSRGD 2016 (S.P.I):

Date: 24-06-19

Design:
Checked:
Approved:

