



Department
for Transport

Road Traffic Regulation Act 1984 Sections 64 and 65

Authorisation of traffic signs and special directions

Accessible transcript

Secretary of State for Transport's traffic authorisation of signs/markings for the purpose of reducing vehicle speeds on the B4100 Banbury Road in Lighthorne Heath, Warwickshire, for which Warwickshire County Council is the traffic authority.

The following pages contain a copy of the text from the Secretary of State for Transport's traffic authorisation regarding the above sign/marking.

A scanned copy of the signed authorisation and supporting signs/markings from the application are appended to this letter. The supporting material is submitted to the Department for Transport by a third party. You should refer to the party involved for accessible copies of the supporting material.



**HIGHWAYS ACT 1980 – SECTION 90
AUTHORISATION OF ROAD HUMPS**

The Secretary of State for Transport, in exercise of his powers under Section 90 of the Highways Act 1980, and of all other powers enabling him in that behalf, for the purpose of reducing vehicle speeds on the B4100 Banbury Road in Lighthorne Heath, Warwickshire, for which Warwickshire County Council is the traffic authority, hereby:-

1. authorises the placing upon a road hump, at or within 5 metres of the site shown schematically on the attached plan numbered GT50/182/0013-1, of a toucan crossing (hereinafter referred to as “the authorised crossing”) as defined within Schedule 1 of the Traffic Signs Regulations and General Directions 2016 (Part 1 of S.I. 2016/362, “the 2016 Regulations”) and conforming as to size, colour and character with that shown on the attached plan numbered GT50/182/0013-2; and
2. directs, without prejudice to any statutory provision to the like effect, that it is a condition of this authorisation that the placing of the authorised crossing at or near the said site shall continue to have effect only until such day as may be appointed by one month’s notice given by the Secretary of State in writing to the traffic authority for the removal or alteration of the authorised hump, and on that day the said authorisation shall, without prejudice to the giving of any further authorisation or direction, cease to have effect.

The provisions of the Highways (Road Humps) Regulations 1999 shall apply to the road hump and the authorised crossing, save that an imaginary line along the centre of the hump from one side of the road to the other need not be in the same position as an imaginary line along the centre of the limits of the crossing from one side of the road to the other as shown in the diagram in Schedule 14, Part 2, Item 51 of the 2016 Regulations.



The provisions of Regulations 5, 7, 9, 10 and 11 of the 2016 Regulations shall apply to the authorised crossing in the same manner as they apply to the marking shown in the diagram in Schedule 14, Part 2, Item 51 of those Regulations.

Dated *09 July 2020*

Signed by authority of the Secretary of State

.....

A Delegated Official of the Department for Transport



Department
for Transport

**SCANNED
AUTHORISATION AND
MAPS / DRAWINGS
FOLLOW**



**HIGHWAYS ACT 1980 – SECTION 90
AUTHORISATION OF ROAD HUMPS**

The Secretary of State for Transport, in exercise of his powers under Section 90 of the Highways Act 1980, and of all other powers enabling him in that behalf, for the purpose of reducing vehicle speeds on the B4100 Banbury Road in Lighthorne Heath, Warwickshire, for which Warwickshire County Council is the traffic authority, hereby:-

1. authorises the placing upon a road hump, at or within 5 metres of the site shown schematically on the attached plan numbered GT50/182/0013-1, of a toucan crossing (hereinafter referred to as “the authorised crossing”) as defined within Schedule 1 of the Traffic Signs Regulations and General Directions 2016 (Part 1 of S.I. 2016/362, “the 2016 Regulations”) and conforming as to size, colour and character with that shown on the attached plan numbered GT50/182/0013-2; and
2. directs, without prejudice to any statutory provision to the like effect, that it is a condition of this authorisation that the placing of the authorised crossing at or near the said site shall continue to have effect only until such day as may be appointed by one month’s notice given by the Secretary of State in writing to the traffic authority for the removal or alteration of the authorised hump, and on that day the said authorisation shall, without prejudice to the giving of any further authorisation or direction, cease to have effect.

The provisions of the Highways (Road Humps) Regulations 1999 shall apply to the road hump and the authorised crossing, save that an imaginary line along the centre of the hump from one side of the road to the other need not be in the same position as an imaginary line along the centre of the limits of the crossing from one side of the road to the other as shown in the diagram in Schedule 14, Part 2, Item 51 of the 2016 Regulations.



The provisions of Regulations 5, 7, 9, 10 and 11 of the 2016 Regulations shall apply to the authorised crossing in the same manner as they apply to the marking shown in the diagram in Schedule 14, Part 2, Item 51 of those Regulations.

Dated *09 July 2020*

Signed by authority of the Secretary of State

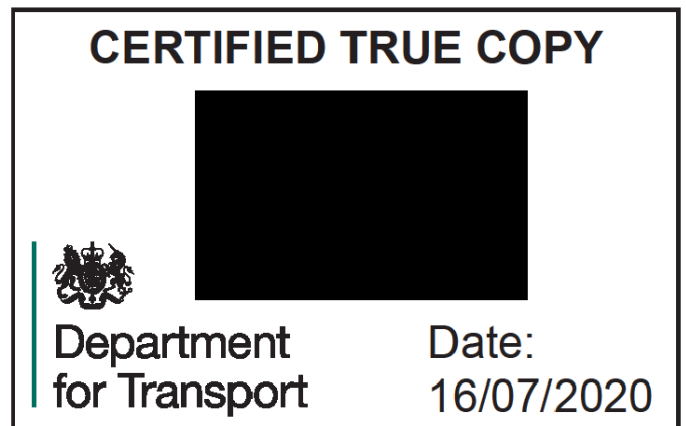
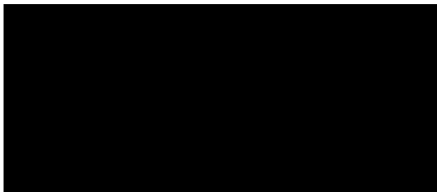

.....
A Delegated Official of the Department for Transport

Location of Proposed Dual Toucan Crossing and Raised Table.

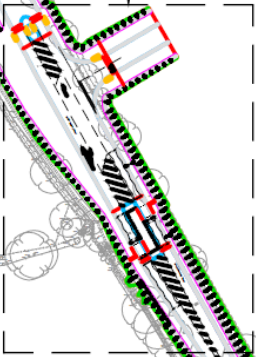

Department
for Transport
Date: 09 July 2020
Number: GT50/182/0013-1

This drawing should not be scaled. Dimensions to be verified on site. Any discrepancies should be referred to the Engineer prior to work being put in hand.
 This drawing is the property of Waterman Infrastructure - Environment Limited, and the drawing is issued on the condition that it is not copied, reproduced, related or disclosed to any unauthorised person, either wholly or in part without the consent in writing of Waterman Infrastructure - Environment Limited.
 Pickfords Wharf, Clink Street, London SE1 9DG 1 020 7928 7888 1 020 7902 0992

GENERAL NOTES

1. THIS DRAWING IS TO BE READ IN CONJUNCTION WITH ALL ENGINEER'S, ARCHITECT'S OR OTHER RELEVANT DRAWINGS AND SPECIFICATIONS.
2. ALL DIMENSIONS AND LEVELS ARE TO BE CHECKED ON SITE BY THE CONTRACTOR PRIOR TO PREPARING ANY WORKING DRAWINGS OR COMMENCING ON SITE.
3. THE CONTRACTOR MUST ENSURE AND WILL BE HELD RESPONSIBLE FOR THE OVERALL STABILITY OF THE BUILDING/STRUCTURE/EXCAVATION AT ALL STAGES OF THE WORK.
4. ALL WORK BY THE CONTRACTOR MUST BE CARRIED OUT IN SUCH A WAY THAT ALL REQUIREMENTS UNDER THE HEALTH AND SAFETY AT WORK ACT ARE SATISFIED.
5. ALL WORK IS TO BE CARRIED OUT IN COMPLIANCE WITH THE REQUIREMENTS OF THE RELEVANT STATUTORY AUTHORITIES AND REGULATIONS.

KEY:

	BLACKTOP CARRIAGEWAY
	BLOCK PAVED CARRIAGEWAY
	COLOURED ASPHALT - DETAILS TBC
	BLACKTOP FOOTWAY
	BLOCK PAVED FOOTWAY
	GRASS VERGE
	TACTILE PAVING
	GUARD RAIL
	EXTENT OF S278 WORKS
	HIGHWAY BOUNDARY

Rev	Date	Description	By
A06	24.06.20	WCC COMMENTS INCORPORATED	DP
A05	20.02.20	WCC COMMENTS INCORPORATED	DP
A04	13.01.20	WCC COMMENTS INCORPORATED	DP
A03	22.11.19	WCC COMMENTS INCORPORATED	DP
A02	04.10.19	WCC COMMENTS INCORPORATED	DP
A01	08.02.19	FIRST ISSUE	DP

Amendments	
Project	KINGSTON GRANGE
Title	SECTION 278 WORKS GENERAL ARRANGEMENT SHEET 2 OF 4
Client	BARRATT WEST MIDLANDS

5th Floor One Cornwall Street Birmingham B3 2DX
 1 0121 212 7700
 mail: waterman@wmg.com www.watermangroup.com

Drawing Status				
PRELIMINARY				
Designed by	SM	Checked by	MN	Project No
Drawn by	JG	Date	FEB 2109	WIE14591
Scalcs	A1	1:500	Computer File No	
Publisher		Zone	Category	Number
WIE		SA	S278	102
				A06

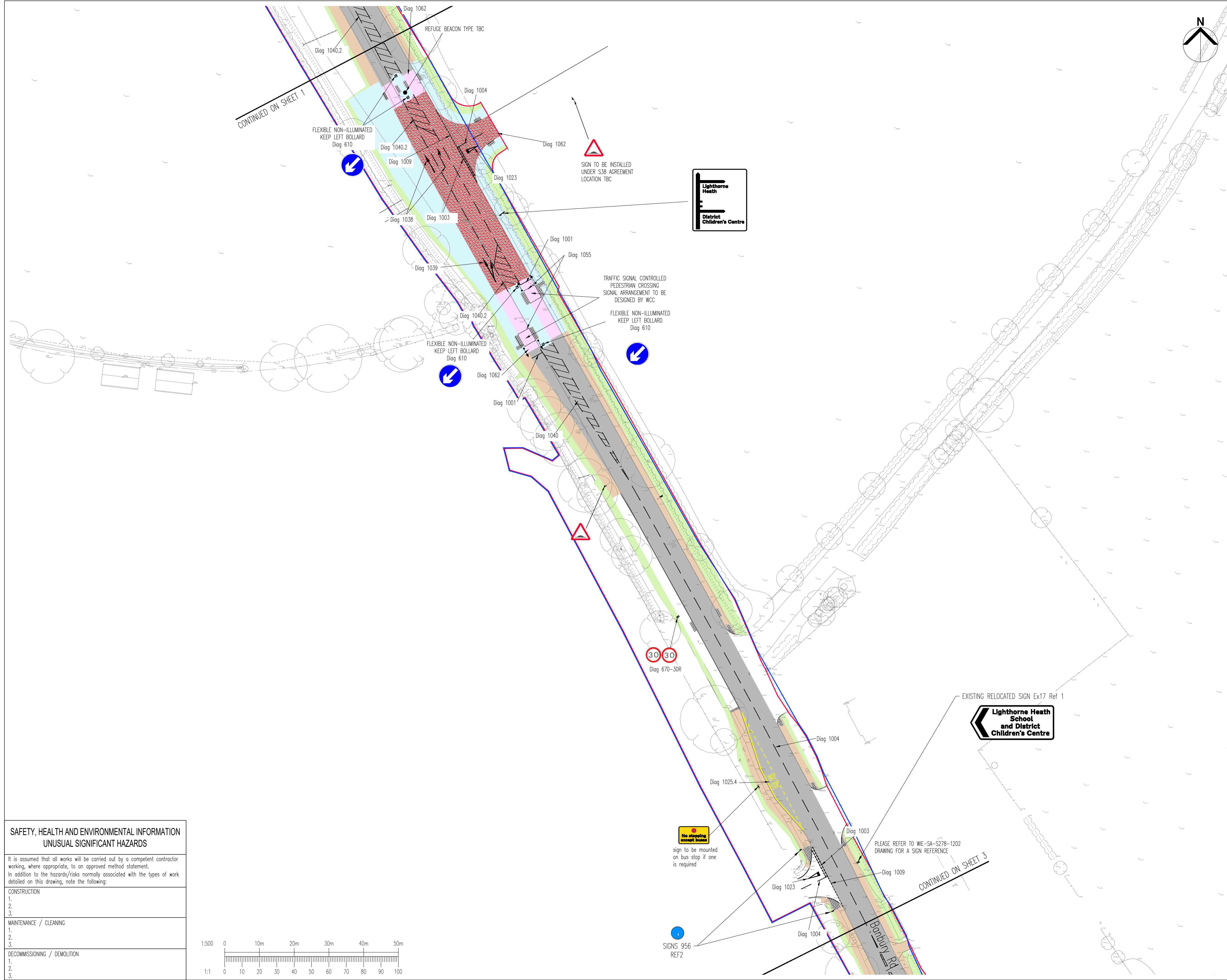

SAFETY, HEALTH AND ENVIRONMENTAL INFORMATION UNUSUAL SIGNIFICANT HAZARDS

It is assumed that all works will be carried out by a competent contractor working, where appropriate, to an approved method statement. In addition to the hazards/risks normally associated with the types of work detailed on this drawing, note the following:

CONSTRUCTION
1.
2.
3.
MAINTENANCE / CLEANING
1.
2.
3.
DECOMMISSIONING / DEMOLITION
1.
2.
3.

File Path: 3-Barratt West Midlands Kingston Grange-2017-2018-2019 WORKS

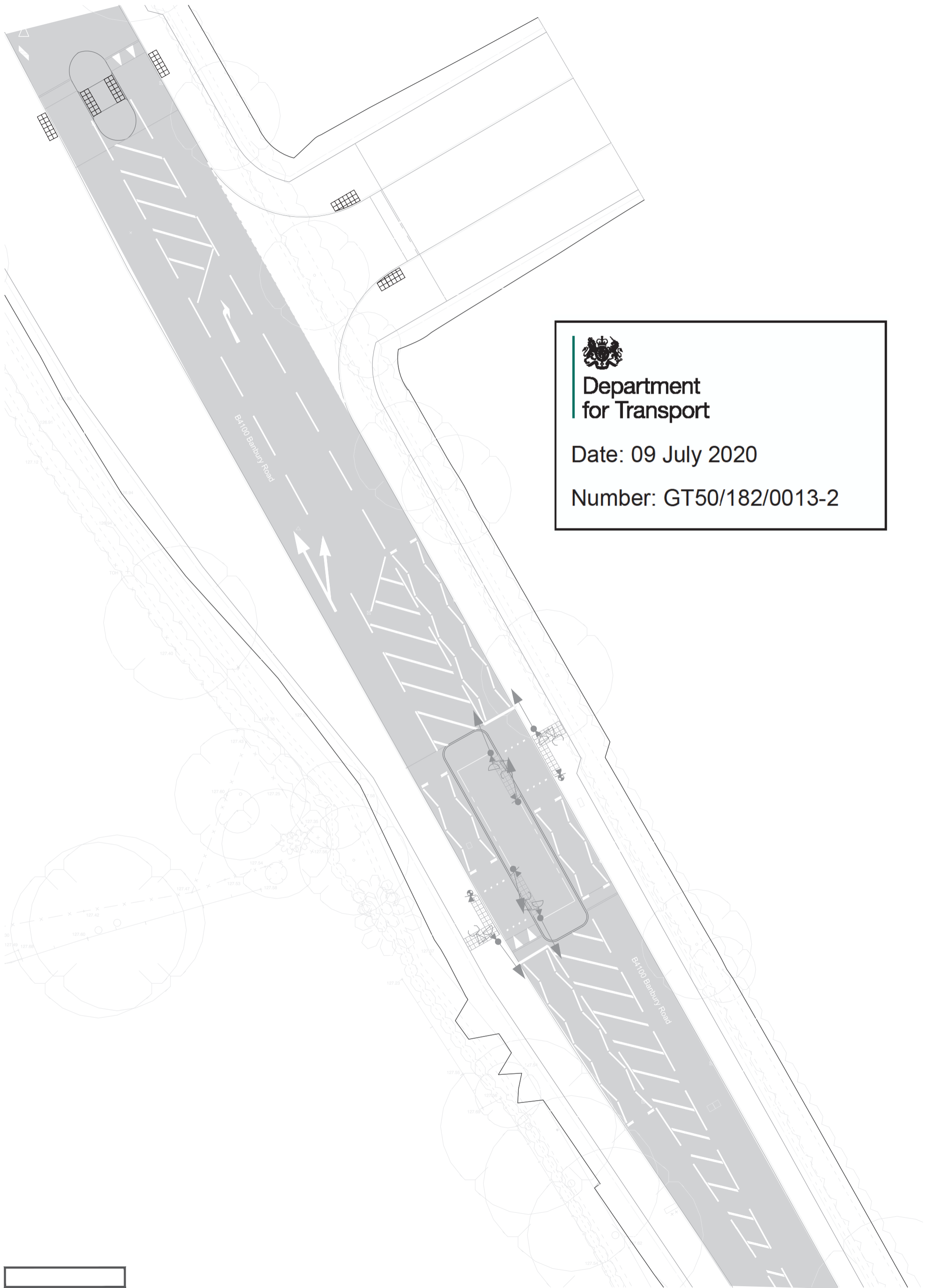

Department
for Transport

Date: 09 July 2020

Number: GT50/182/0013-2



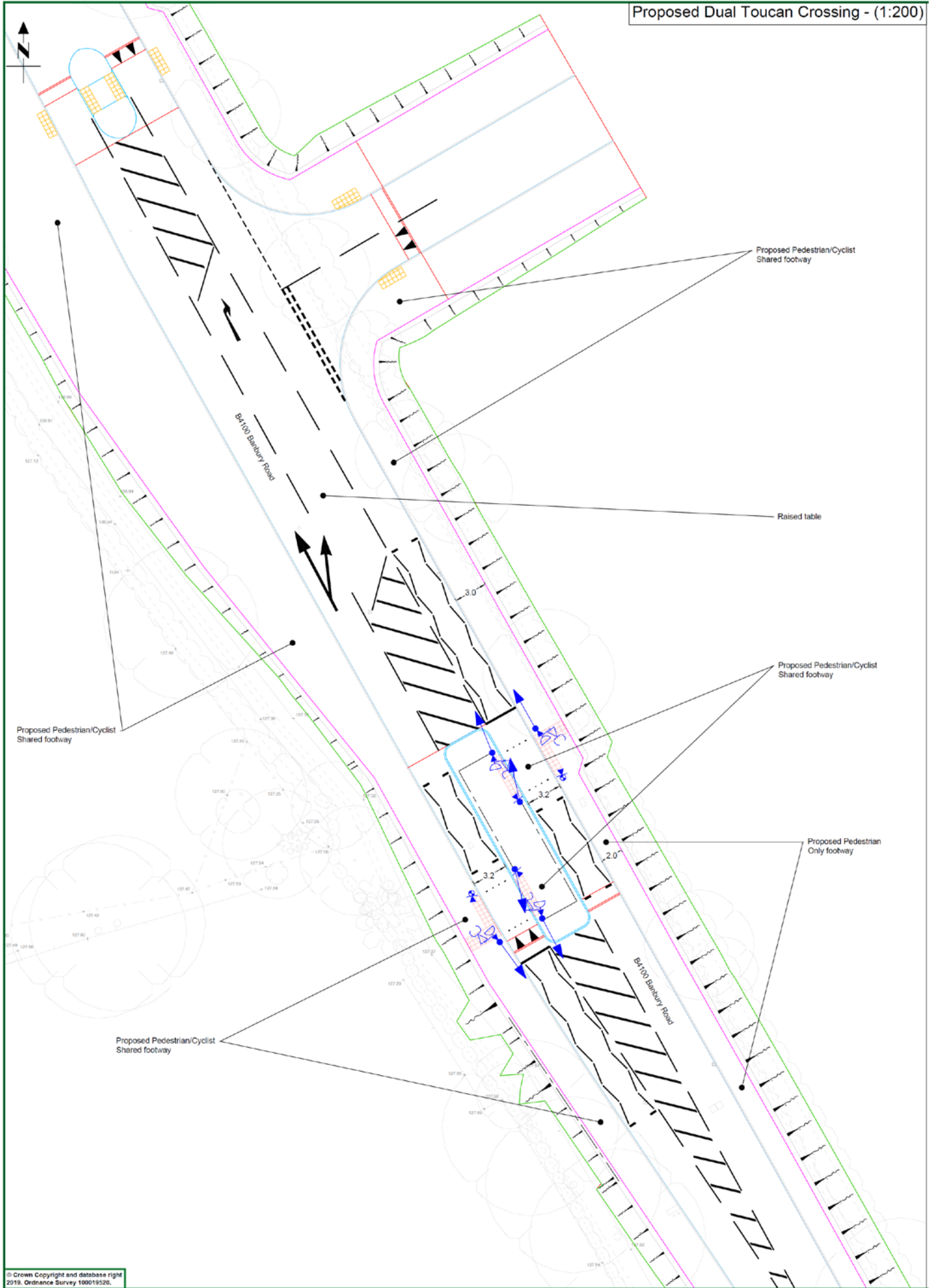

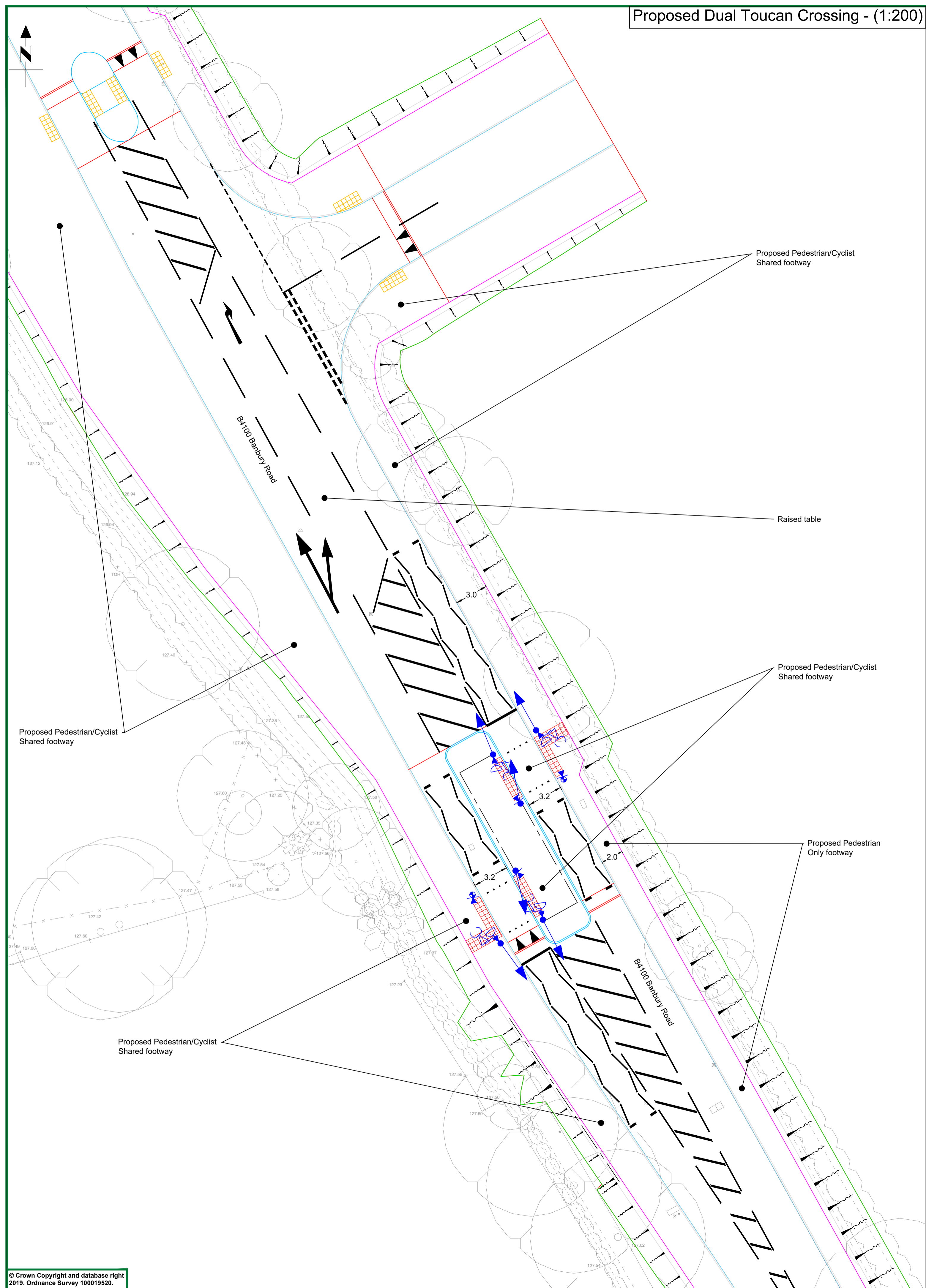

Proposed Dual Toucan Crossing - (1:200)

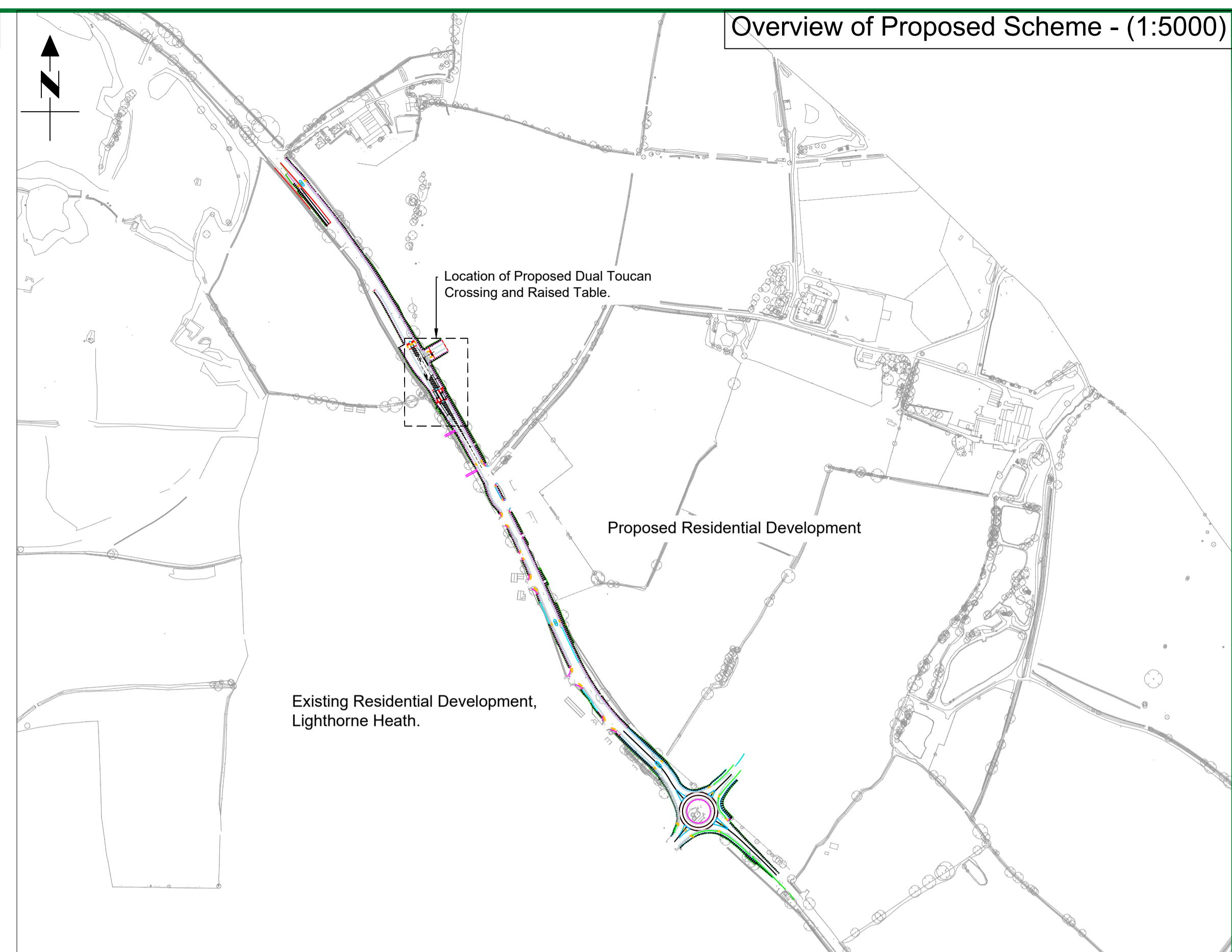

Overview of Proposed Scheme - (1:5000)

- ### Traffic Signal Equipment Key
- 3 aspect LED 'red/yellow/green' traffic signal head with primary cowls
 - 2m Black Signal Pole with Welded Top fitted with NAL socket system OR EQUIVALENT TYPE APPROVED BY WCC and associated Pole Number
 - 4m Black Straight Signal Pole fitted in NAL socket system OR EQUIVALENT TYPE APPROVED BY WCC and associated Pole Number
 - Extra Low Voltage Pedestrian Small Push Button Unit (48V) (including tactile units and audios) with lateral adjustment housing. AGD 941 OR EQUIVALENT TYPE APPROVED BY WCC
 - Pedestrian - Cycle nearside LED indicator (red man - cycle / green man - cycle) with integrated push button unit. NFOV optics with lateral adjustment housing, tactile device and audios. AGD 947 OR EQUIVALENT TYPE APPROVED BY WCC.
 - Red Tactile Paving (400mm x 400mm) - refer to Tactile Paving Detail. Any cut slabs to minimum of 150mm wide.
 - Buff Tactile Paving (400mm x 400mm) - refer to Tactile Paving Detail. Any cut slabs to minimum of 150mm wide.

NOTES

A	EM	To include drawing number	28/05/20
REV	DRN	AMENDMENT	DATE



Engineering Design Services
 Environment Services, Communities
 Shire Hall Post Room
 Warwick
 CV34 4SP
 Tel: 01926 410410
 Web: www.warwickshire.gov.uk



PROJECT
B4100 - Banbury Road Lighthorne Heath Dual Toucan Crossing

TITLE
General Arrangement

Purpose of Drawing: Feasibility

Dim	EM	CK'd	GD	App'd	GD
Date	20-05-20	Date	28-05-20	Date	28-05-20

Status
Approved (Level 1)

Scale
As Shown

Sheet size
A1

DRG. NO.
24.2---328-001

Rev.
A

Overview of Proposed Scheme - (1:5000)

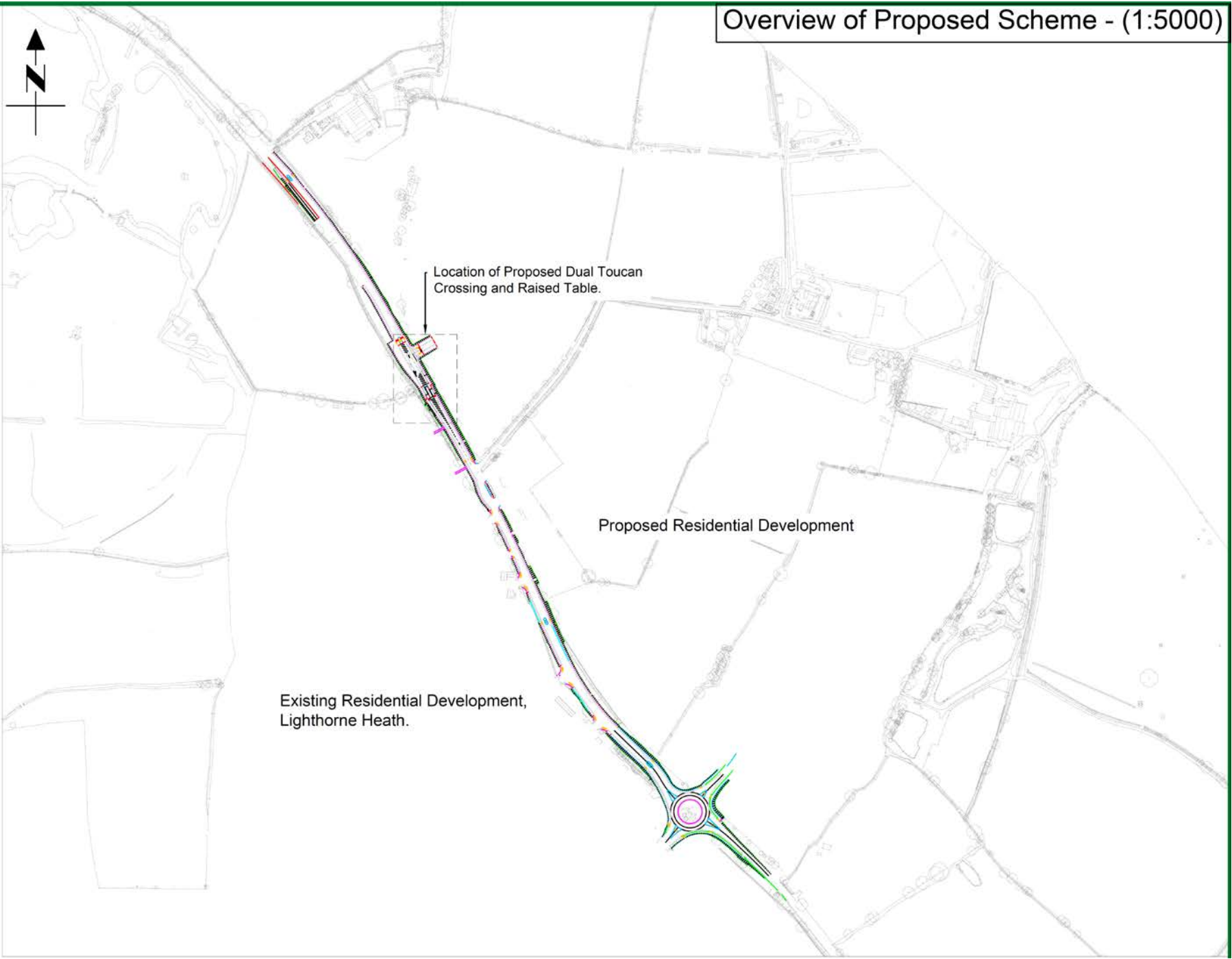

Location of Proposed Dual Toucan Crossing and Raised Table.

Proposed Residential Development

Existing Residential Development, Lighthorne Heath.