



Department  
for Transport

## **Road Traffic Regulation Act 1984**

### **Sections 64 and 65**

## **Authorisation of traffic signs and special directions**

### **Accessible transcript**

Secretary of State for Transport's traffic authorisation of signs/markings for the purpose of controlling traffic in the vicinity of the level crossing in Teston Lane, Teston, Maidstone and for which the traffic authority permits the placing of traffic signs by Network Rail.

The following pages contain a copy of the text from the Secretary of State for Transport's traffic authorisation regarding the above sign/marking.

A scanned copy of the signed authorisation and supporting signs/markings from the application are appended to this letter. The supporting material is submitted to the Department for Transport by a third party. You should refer to the party involved for accessible copies of the supporting material.



**ROAD TRAFFIC REGULATION ACT 1984 – SECTIONS 64 AND 65  
AUTHORISATION OF TRAFFIC SIGNS AND SPECIAL DIRECTIONS**

The Secretary of State for Transport, in exercise of his powers under Sections 64 and 65 of the Road Traffic Regulation Act 1984, and of all other powers enabling him in that behalf, for the purpose of controlling traffic in the vicinity of the level crossing in Teston Lane, Teston, Maidstone and for which the traffic authority permits the placing of traffic signs by Network Rail, hereby:-

1. authorises the erection at or within 5 metres of the site marked schematically on the attached plan numbered GT50/060/0030-1 for which Kent County Council is the traffic authority, of a light signal (hereinafter referred to as “the authorised signal”) conforming as to size, colour and character with that shown in the attached drawing numbered NP 3015; and
2. directs that the authorised signal may only be placed at the said sites if the apparatus (including the contents of all instructions stored in it) used in connection with it meets the requirements of Schedule 14, General Direction 46 of the Traffic Signs General Directions 2016 (Part 2 of S.I. 2016/362); and
3. directs, without prejudice to any statutory provision to the like effect, that it is a condition of this authorisation that the erection of the authorised signal at or near the said site shall continue to have effect only until such day as may be appointed by one month’s notice given by the Secretary of State in writing to the traffic authority for the removal or alteration of the authorised signal and on that day the said authorisation shall, without prejudice to the giving of any further authorisation or direction, cease to have effect.

Section 36 of the Road Traffic Act 1988 shall apply to the authorised signal as it applies to the signal to diagram 3014 in Schedule 14, Part 2, Item 5 of the Traffic Signs Regulations 2016 (Part 1 of S.I. 2016/362, “the 2016 Regulations”).



The provisions of Regulation 7 and Schedule 14, Part 1, Paragraph 8 of the 2016 Regulations shall apply to the authorised signal in the same manner as they apply to the signal to diagram 3014 in Schedule 14, Part 2, Item 5 of those Regulations.

Dated *05 October 2020*

Signed by authority of the Secretary of State

.....

A Delegated Official of the Department for Transport

**SCANNED  
AUTHORISATION  
AND SUPPORTING  
DOCUMENTS  
FOLLOW**



**ROAD TRAFFIC REGULATION ACT 1984 – SECTIONS 64 AND 65  
AUTHORISATION OF TRAFFIC SIGNS AND SPECIAL DIRECTIONS**

The Secretary of State for Transport, in exercise of his powers under Sections 64 and 65 of the Road Traffic Regulation Act 1984, and of all other powers enabling him in that behalf, for the purpose of controlling traffic in the vicinity of the level crossing in Teston Lane, Teston, Maidstone and for which the traffic authority permits the placing of traffic signs by Network Rail, hereby:-

1. authorises the erection at or within 5 metres of the site marked schematically on the attached plan numbered GT50/060/0030-1 for which Kent County Council is the traffic authority, of a light signal (hereinafter referred to as “the authorised signal”) conforming as to size, colour and character with that shown in the attached drawing numbered NP 3015; and
2. directs that the authorised signal may only be placed at the said sites if the apparatus (including the contents of all instructions stored in it) used in connection with it meets the requirements of Schedule 14, General Direction 46 of the Traffic Signs General Directions 2016 (Part 2 of S.I. 2016/362); and
3. directs, without prejudice to any statutory provision to the like effect, that it is a condition of this authorisation that the erection of the authorised signal at or near the said site shall continue to have effect only until such day as may be appointed by one month’s notice given by the Secretary of State in writing to the traffic authority for the removal or alteration of the authorised signal and on that day the said authorisation shall, without prejudice to the giving of any further authorisation or direction, cease to have effect.

Section 36 of the Road Traffic Act 1988 shall apply to the authorised signal as it applies to the signal to diagram 3014 in Schedule 14, Part 2, Item 5 of the Traffic Signs Regulations 2016 (Part 1 of S.I. 2016/362, “the 2016 Regulations”).



The provisions of Regulation 7 and Schedule 14, Part 1, Paragraph 8 of the 2016 Regulations shall apply to the authorised signal in the same manner as they apply to the signal to diagram 3014 in Schedule 14, Part 2, Item 5 of those Regulations.

Dated *05 October 2020*

Signed by authority of the Secretary of State



**CERTIFIED TRUE COPY**



Department  
for Transport

Date:  
05/10/2020

.....  
A Delegated Official of the Department for Transport

Sign Location

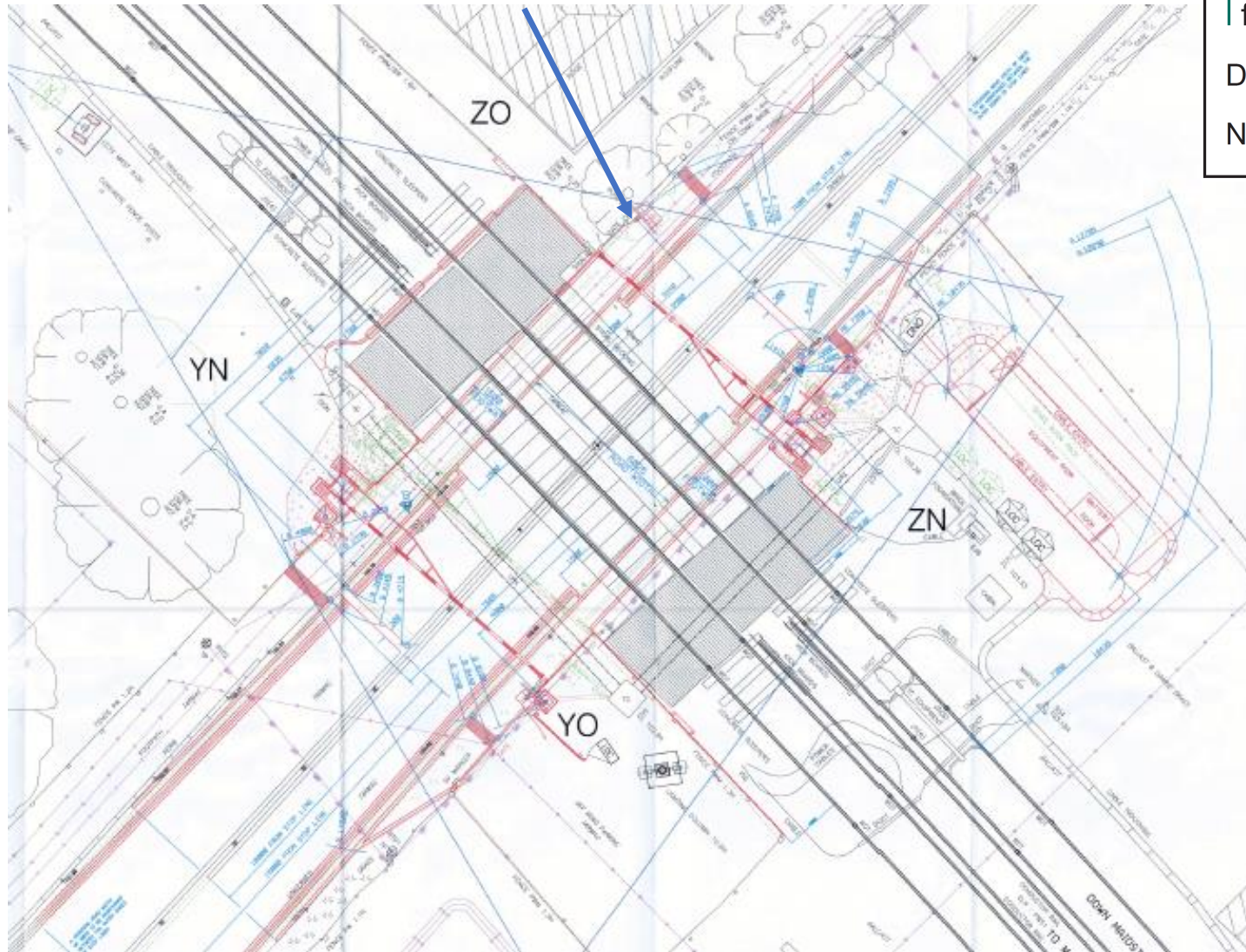

Department  
for Transport

Date: 11 September 2020

Number: GT50/060/0030-1



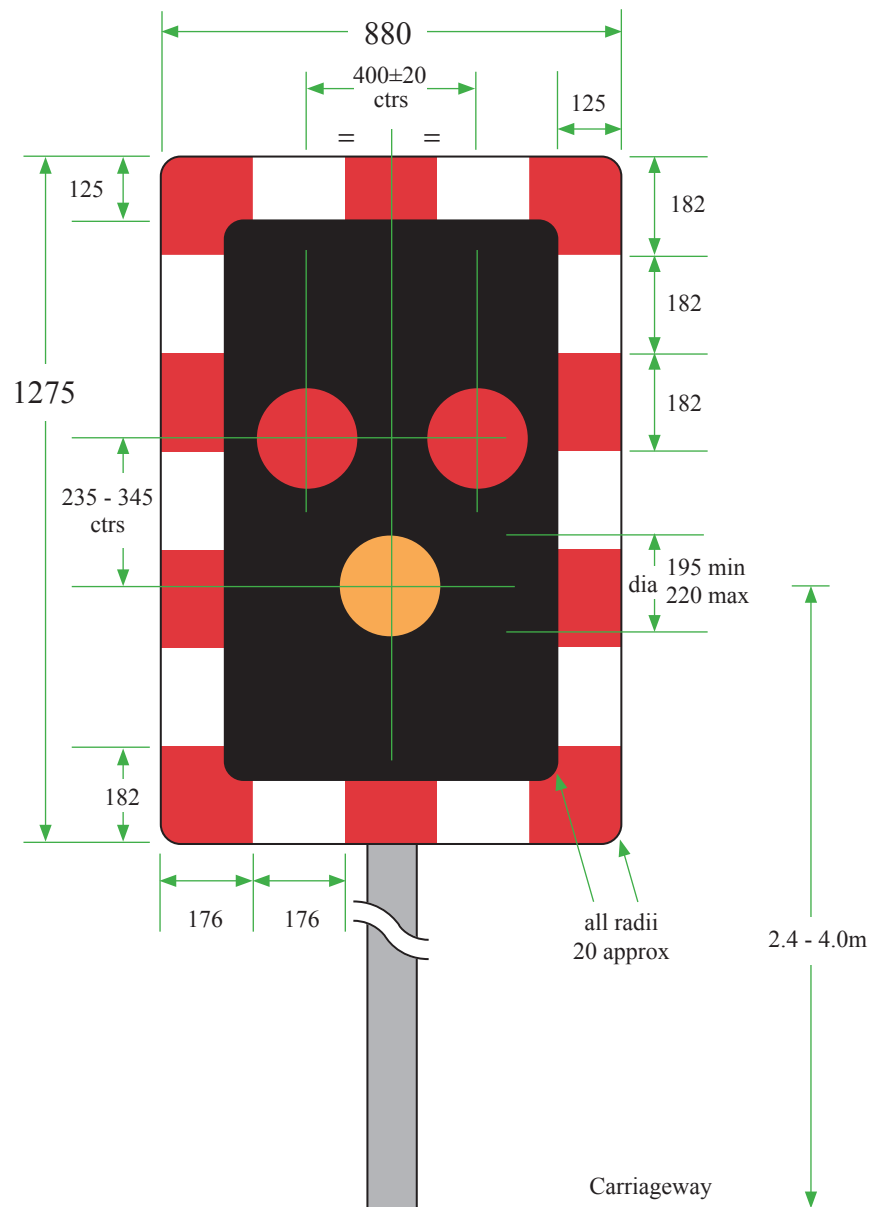

#### NOTES:

1. The signals may not be used on the public highway without authorisation from the Secretary of State for Transport.
2. The signals shall comply with the requirements of schedule 14 of the Traffic Signs Regulations and General Directions 2016, as they apply to diagram 3014.
3. The red and white chequered border shall be reflectorised.
4. All dimensions are in millimetres.



Department  
for Transport

Light Signals

**WIG-WAG SIGNAL**

Narrow Central Reserves and Level Crossings

Issue:

A: 19.11.1990

B: 17.10.2016

C:

Date:

Drawn by:

AK

Approved by:

JB

Dimensions:

SEE NOTE 4

Drawing No.

**NP 3015**



#### LEVEL, ENDING LAYER PLAN

