



Department
for Transport

Road Traffic Regulation Act 1984 Sections 64 and 65

Authorisation of traffic signs and special directions

Accessible transcript

Secretary of State for Transport's traffic authorisation of traffic signs for the purpose of informing road users of parking provisions in Dover.

The following pages contain a copy of the text from the Secretary of State for Transport's traffic authorisation regarding the above traffic signs.

A scanned copy of the signed authorisation and supporting documents from the application are appended to this letter. The supporting material is submitted to the Department for Transport by a third party. You should refer to the party involved for accessible copies of the supporting material.



ROAD TRAFFIC REGULATION ACT 1984 – SECTIONS 64 AND 65
AUTHORISATION OF TRAFFIC SIGNS AND SPECIAL DIRECTIONS

The Secretary of State for Transport, in exercise of his powers under Sections 64 and 65 of the Road Traffic Regulation Act 1984, and of all other powers enabling him in that behalf, for the purpose of informing road users of parking provisions in Dover, hereby:-

1. authorises the erection at appropriate sites in Marine Parade and Waterloo Crescent for which Kent County Council is the traffic authority of a traffic sign (hereinafter referred to as “the authorised sign”) conforming as to size, colour and character with that shown in the attached drawing numbered GT50/060/0031-1, save that (a) the time period may be varied; (b) the parking expression may be varied; (c) a type or types of user may be included and, where the user is a type of permit holder, a permit identifier may be included; and (d) the name of the traffic authority may be added in a panel above the top panel; and
2. directs that it is a condition of this authorisation that the authorised sign may only be placed to indicate the effect of a corresponding Traffic Regulation Order; and
3. directs, without prejudice to any statutory provision to the like effect, that it is a condition of this authorisation that the erection of the authorised sign at or near the said sites shall continue to have effect only until such day as may be appointed by one month’s notice given by the Secretary of State in writing to the traffic authority for the removal or alteration of the authorised sign and on that day the said authorisation shall, without prejudice to the giving of any further authorisation or direction, cease to have effect.



The provisions of Regulations 5, 6, 7, 8 and 11 of the Traffic Signs Regulations 2016 (Part 1 of S.I. 2016/362, “the 2016 Regulations”) shall apply to the authorised sign in the same manner as they apply to the sign shown in Schedule 4, Part 4, Item 7 of those Regulations.

The provisions of Schedule 4, Parts 2, 4, 5 and 6 of the 2016 Regulations shall apply to the authorised sign in the same manner as they apply to the sign shown in Schedule 4, Part 4, Item 7 of those Regulations.

Dated *02 December 2020*

Signed by authority of the Secretary of State

.....

A Delegated Official of the Department for Transport

**SCANNED
AUTHORISATION
AND SUPPORTING
DOCUMENTS
FOLLOW**



ROAD TRAFFIC REGULATION ACT 1984 – SECTIONS 64 AND 65

AUTHORISATION OF TRAFFIC SIGNS AND SPECIAL DIRECTIONS

The Secretary of State for Transport, in exercise of his powers under Sections 64 and 65 of the Road Traffic Regulation Act 1984, and of all other powers enabling him in that behalf, for the purpose of informing road users of parking provisions in Dover, hereby:-

1. authorises the erection at appropriate sites in Marine Parade and Waterloo Crescent for which Kent County Council is the traffic authority of a traffic sign (hereinafter referred to as “the authorised sign”) conforming as to size, colour and character with that shown in the attached drawing numbered GT50/060/0031-1, save that (a) the time period may be varied; (b) the parking expression may be varied; (c) a type or types of user may be included and, where the user is a type of permit holder, a permit identifier may be included; and (d) the name of the traffic authority may be added in a panel above the top panel; and
2. directs that it is a condition of this authorisation that the authorised sign may only be placed to indicate the effect of a corresponding Traffic Regulation Order; and
3. directs, without prejudice to any statutory provision to the like effect, that it is a condition of this authorisation that the erection of the authorised sign at or near the said sites shall continue to have effect only until such day as may be appointed by one month’s notice given by the Secretary of State in writing to the traffic authority for the removal or alteration of the authorised sign and on that day the said authorisation shall, without prejudice to the giving of any further authorisation or direction, cease to have effect.



The provisions of Regulations 5, 6, 7, 8 and 11 of the Traffic Signs Regulations 2016 (Part 1 of S.I. 2016/362, "the 2016 Regulations") shall apply to the authorised sign in the same manner as they apply to the sign shown in Schedule 4, Part 4, Item 7 of those Regulations.

The provisions of Schedule 4, Parts 2, 4, 5 and 6 of the 2016 Regulations shall apply to the authorised sign in the same manner as they apply to the sign shown in Schedule 4, Part 4, Item 7 of those Regulations.

Dated *02 December 2020*

Signed by authority of the Secretary of State

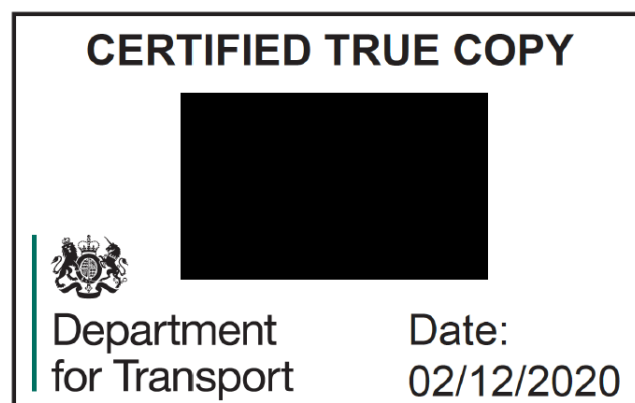
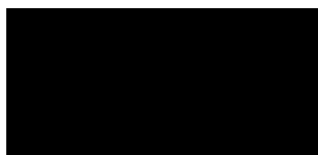

.....
A Delegated Official of the Department for Transport



Dover Seafront Parking Restriction Sign

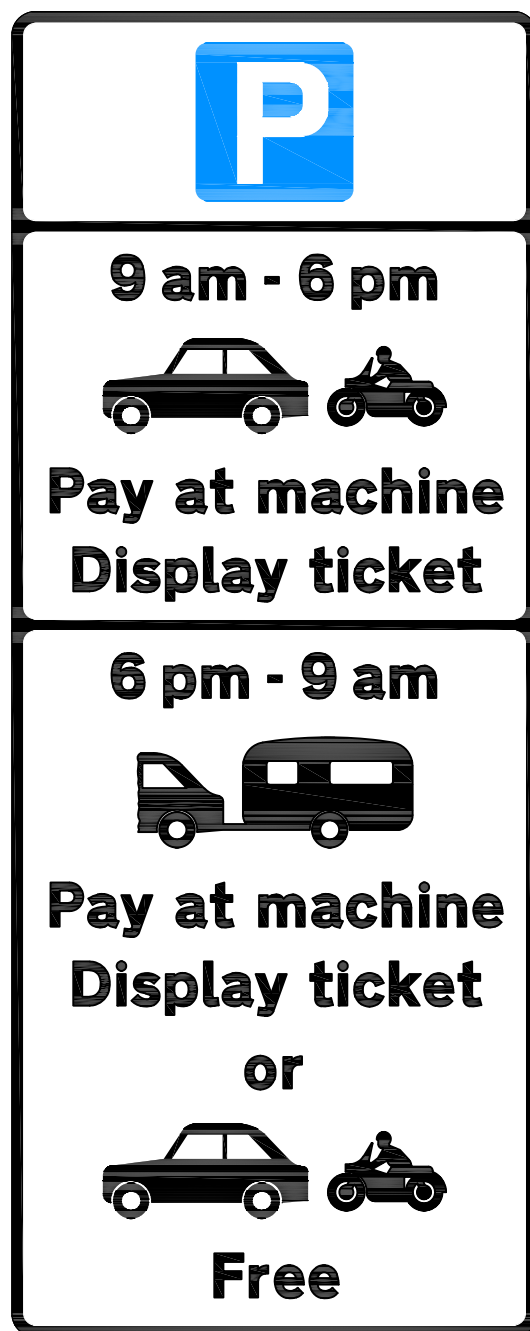

Department
for Transport

Date: 11 November 2020

Number: GT50/060/0031-1

Scheme Ref.	Dover Seafront		
Sign Ref.	Parking Restrictions	x-height	20.0
Letter colour	BLACK	SIGN FACE	
Background	WHITE	Width	330 mm
Border	BLACK	Height	840 mm
Material	Class NR	Area	0.28 m ²

xx No. signs similar to dia 660.6 of the TSR&GD 2016 Manual except endorsed as shown. Class NR face. Grey-backed and fitted with channeling suitable for fixing to Ø76mm galvanised traffic posts. Material either to be 3mm aluminium or composite as per DfT approval. All other details as above and as per the TSR&GD, 2016 S.I. Manual.



9 am - 6 pm



**Pay at machine
Display ticket**

6 pm - 9 am



**Pay at machine
Display ticket**

or



Free

This map is reproduced from Ordnance Survey material with the permission of Ordnance Survey on behalf of the Controller of Her Majesty's Stationery Office © Crown copyright. Unauthorised reproduction infringes Crown copyright and may lead to prosecution or civil proceedings. Dover District Council licence no. 100019780 published 2020.

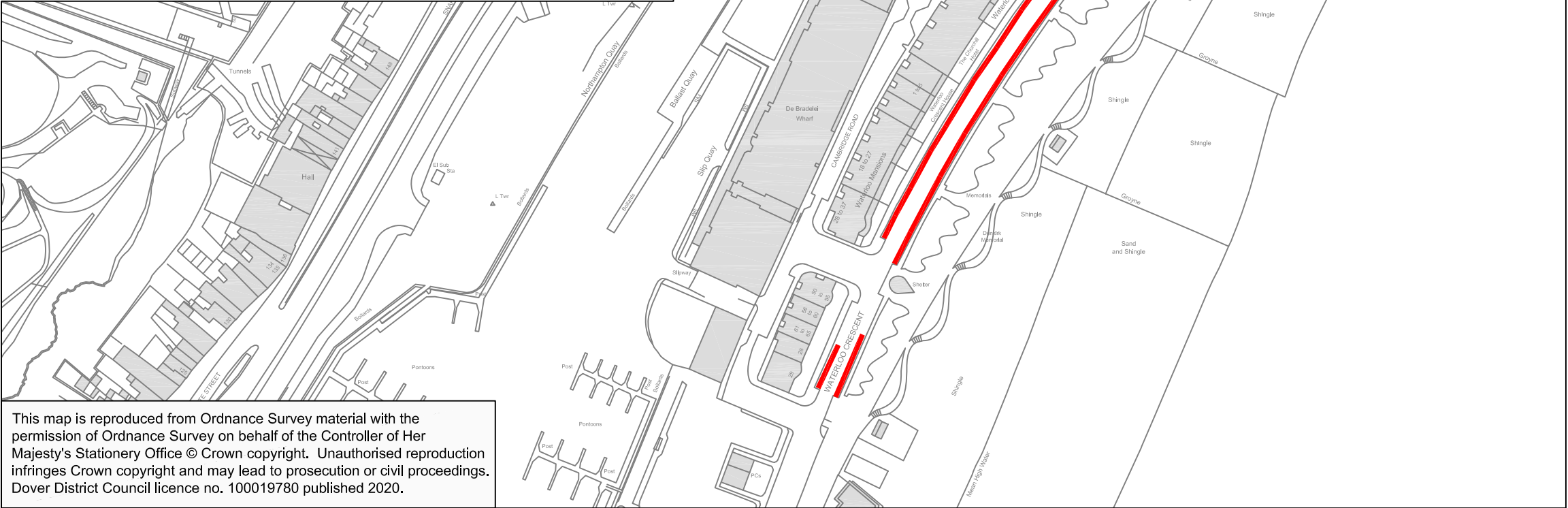
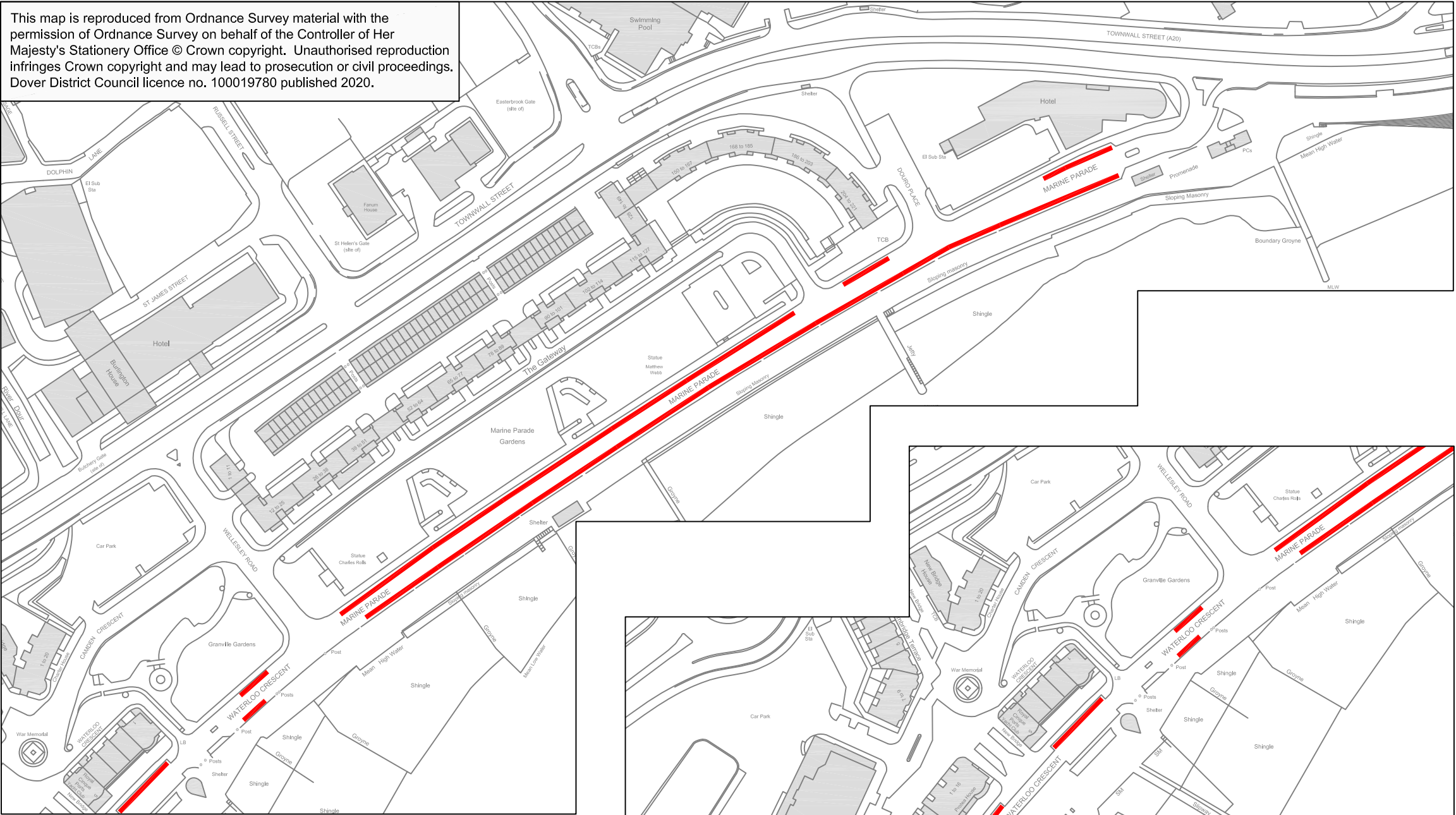

This map is reproduced from Ordnance Survey material with the permission of Ordnance Survey on behalf of the Controller of Her Majesty's Stationery Office © Crown copyright. Unauthorised reproduction infringes Crown copyright and may lead to prosecution or civil proceedings. Dover District Council licence no. 100019780 published 2020.

Key to Map

 Extent of Proposed Pay & Display (P&D) parking as detailed on sign below



Signs at 30 metre spacing (nominal)



Prepared by
Parking Services
Dover District Council
Honeywood Close
White Cliffs Business Park
Dover CT16 3PJ
Tel: (01304) 821199

Euring **Roger Walton**, C.Eng, M.I.C.E.
STRATEGIC DIRECTOR (OPERATIONS & COMMERCIAL)

Scheme
**Proposed Daytime P&D Parking with
Overnight P&D Caravan and Motor Caravan
Parking**

Location
**Marine Parade and Waterloo Cres,
Dover Seafront**

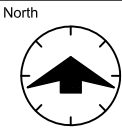

Designed: GEM Drawn: GEM Date: 9 Nov 2020

Scale
0 10 20 30 40
1 in 2000 (A3 size)

Drawing Number
TRAN/2020/0005

Rev