



Department
for Transport

Road Traffic Regulation Act 1984 Sections 64 and 65

Authorisation of traffic signs and special directions

Accessible transcript

Secretary of State for Transport's traffic authorisation of traffic signs to secure the expeditious and safe movement of traffic at the Whitehouse Level Crossing in Middlesbrough, for which the traffic authority permits the placing of signs by Network Rail.

The following pages contain a copy of the text from the Secretary of State for Transport's traffic authorisation regarding the above traffic signs.

A scanned copy of the signed authorisation and supporting documents from the application are appended to this letter. The supporting material is submitted to the Department for Transport by a third party. You should refer to the party involved for accessible copies of the supporting material.



ROAD TRAFFIC REGULATION ACT 1984 – SECTIONS 64 AND 65
AUTHORISATION OF TRAFFIC SIGNS AND SPECIAL DIRECTIONS

The Secretary of State for Transport, in exercise of his powers under Sections 64 and 65 of the Road Traffic Regulation Act 1984, and of all other powers enabling him in that behalf, to secure the expeditious and safe movement of traffic at the Whitehouse Level Crossing in Middlesbrough, for which the traffic authority permits the placing of signs by Network Rail, hereby:-

1. authorises the placing at or within the vicinity of the site shown on the attached plan numbered GT50/102/0011-1, for which Middlesbrough Council is the traffic authority, of a traffic sign consisting of a road marking (hereinafter referred to as “the authorised marking”) conforming as to size, colour and character with that shown in diagram 1045 in Schedule 9, Part 6, Item 26 to the Traffic Signs Regulations and General Directions 2016 (Part 1 of SI 2016/362, “the 2016 Regulations”), save that the overall size and shape of the authorised marking shall be as shown on the said plan; and
2. directs, without prejudice to any statutory provision to the like effect, that it is a condition of this authorisation that the placing of the authorised marking at or near the said site shall continue to have effect only until such day as may be appointed by one month’s notice given by the Secretary of State in writing to the traffic authority for the removal or alteration of the authorised marking and on that day the said authorisation shall, without prejudice to the giving of any further authorisation or direction, cease to have effect.

Section 36 of the Road Traffic Act 1988 shall apply to the authorised marking as it applies to the marking shown in diagram 1045 in Schedule 9, Part 6, Item 26 to the 2016 Regulations.



The provisions of Regulations 7, 9 and 10 of the 2016 Regulations shall apply to the authorised marking in the same manner as they apply to the marking shown in diagram 1045 in Schedule 9, Part 6, Item 26 of those Regulations.

Dated *16 November 2021*

Signed by authority of the Secretary of State

.....

A Delegated Official of the of the Department for Transport



Department
for Transport

**SCANNED
AUTHORISATION
AND SUPPORTING
DOCUMENTS
FOLLOW**



ROAD TRAFFIC REGULATION ACT 1984 – SECTIONS 64 AND 65
AUTHORISATION OF TRAFFIC SIGNS AND SPECIAL DIRECTIONS

The Secretary of State for Transport, in exercise of his powers under Sections 64 and 65 of the Road Traffic Regulation Act 1984, and of all other powers enabling him in that behalf, to secure the expeditious and safe movement of traffic at the Whitehouse Level Crossing in Middlesbrough, for which the traffic authority permits the placing of signs by Network Rail, hereby:-

1. authorises the placing at or within the vicinity of the site shown on the attached plan numbered GT50/102/0011-1, for which Middlesbrough Council is the traffic authority, of a traffic sign consisting of a road marking (hereinafter referred to as “the authorised marking”) conforming as to size, colour and character with that shown in diagram 1045 in Schedule 9, Part 6, Item 26 to the Traffic Signs Regulations and General Directions 2016 (Part 1 of SI 2016/362, “the 2016 Regulations”), save that the overall size and shape of the authorised marking shall be as shown on the said plan; and
2. directs, without prejudice to any statutory provision to the like effect, that it is a condition of this authorisation that the placing of the authorised marking at or near the said site shall continue to have effect only until such day as may be appointed by one month’s notice given by the Secretary of State in writing to the traffic authority for the removal or alteration of the authorised marking and on that day the said authorisation shall, without prejudice to the giving of any further authorisation or direction, cease to have effect.

Section 36 of the Road Traffic Act 1988 shall apply to the authorised marking as it applies to the marking shown in diagram 1045 in Schedule 9, Part 6, Item 26 to the 2016 Regulations.





The provisions of Regulations 7, 9 and 10 of the 2016 Regulations shall apply to the authorised marking in the same manner as they apply to the marking shown in diagram 1045 in Schedule 9, Part 6, Item 26 of those Regulations.

Dated *16 November 2021*

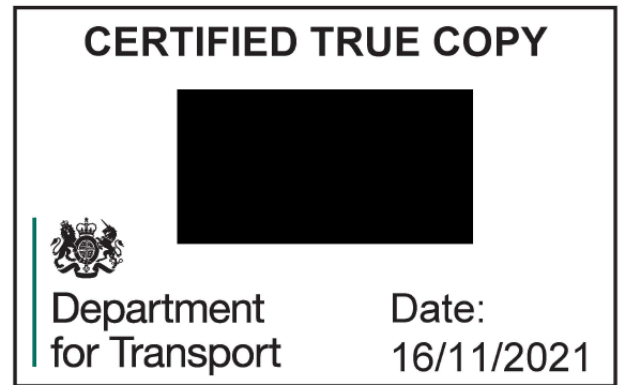
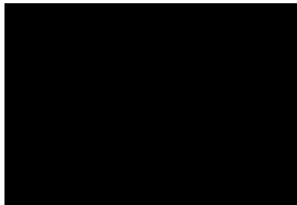
Signed by authority of the Secretary of State

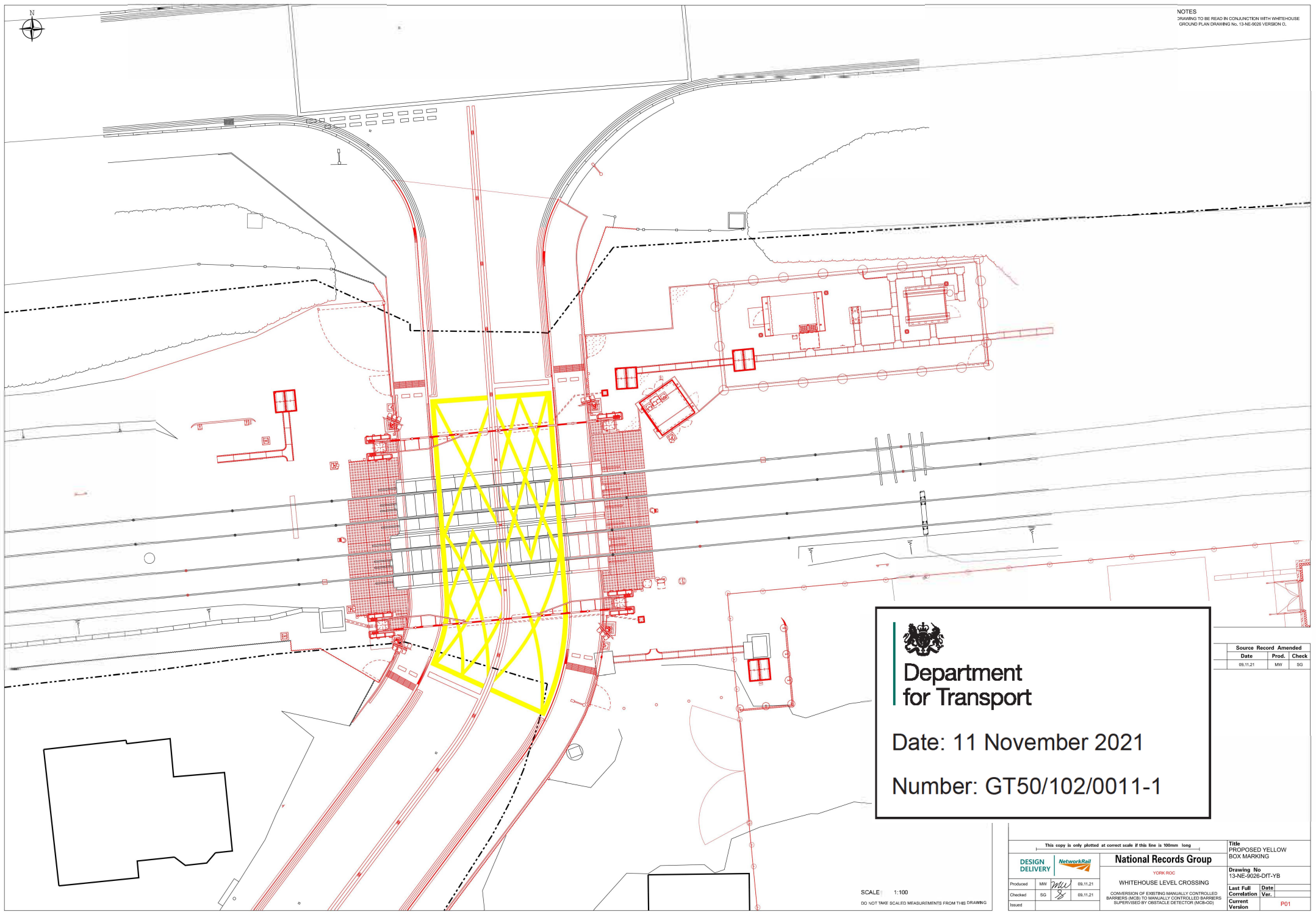

.....
A Delegated Official of the of the Department for Transport

**Department
for Transport**

Date: 11 November 2021

Number: GT50/102/0011-1

Source Record Amended		
Date	Prod.	Check
09.11.21	MW	SG

SCALE: 1:100
DO NOT TAKE SCALED MEASUREMENTS FROM THIS DRAWING

This copy is only plotted at correct scale if this line is 100mm long				Title PROPOSED YELLOW BOX MARKING	
DESIGN DELIVERY	NetworkRail	National Records Group		YORK RDC	
Produced	MW	09.11.21	Drawing No 13-NE-9026-DT-YB		
Checked	SG	09.11.21	Last Full Correlation Ver.		
Issued			Current Version		
			P01		

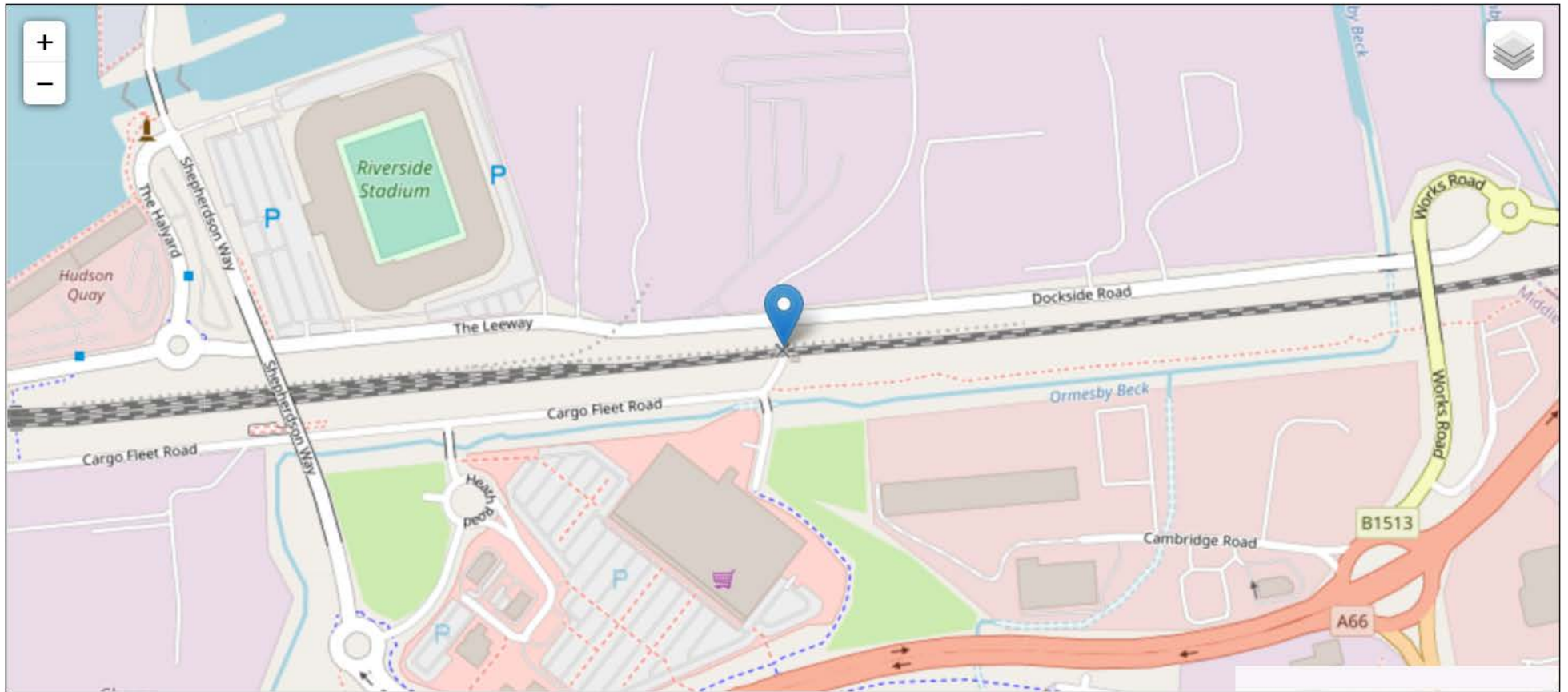

Coordinates

Latitude: 54.577 / 54°34'37"N
Longitude: -1.2117 / 1°12'42"W

OS Eastings: 451051
OS Northings: 520484
OS Grid: NZ510204

Mapcode National: GBR MHZJ.G1
Mapcode Global: WHD70.C761