



Department
for Transport

Road Traffic Regulation Act 1984 Sections 64 and 65

Authorisation of traffic signs and special directions

Accessible transcript

Secretary of State for Transport's traffic authorisation of traffic signs for the purpose of reducing vehicle speeds in Warwickshire, for which Warwickshire County Council is the traffic authority.

The following pages contain a copy of the text from the Secretary of State for Transport's traffic authorisation regarding the above traffic signs.

A scanned copy of the signed authorisation and supporting documents from the application are appended to this letter. The supporting material is submitted to the Department for Transport by a third party. You should refer to the party involved for accessible copies of the supporting material.



**HIGHWAYS ACT 1980 – SECTION 90
AUTHORISATION OF ROAD HUMPS**

The Secretary of State for Transport, in exercise of his powers under Section 90 of the Highways Act 1980, and of all other powers enabling him in that behalf, for the purpose of reducing vehicle speeds in Warwickshire, for which Warwickshire County Council is the traffic authority, hereby:-

1. authorises the placing upon a road hump, at or within 5 metres of the sites shown schematically on the attached plan numbered GT50/182/0014-1, of a toucan crossing (hereinafter referred to as “the authorised crossing”) as defined within Schedule 1 of the Traffic Signs Regulations and General Directions 2016 (Part 1 of S.I. 2016/362, “the 2016 Regulations”) and conforming as to size, colour and character with those shown on the attached plan numbered GT50/182/0014-2; and
2. directs, without prejudice to any statutory provision to the like effect, that it is a condition of this authorisation that the placing of the authorised crossing at or near the said sites shall continue to have effect only until such day as may be appointed by one month’s notice given by the Secretary of State in writing to the traffic authority for the removal or alteration of the authorised hump/s, and on that day the said authorisation shall, without prejudice to the giving of any further authorisation or direction, cease to have effect.

The provisions of the Highways (Road Humps) Regulations 1999 shall apply to the road humps and the authorised crossing, save that an imaginary line along the centre of the hump from one side of the road to the other need not be in the same position as an imaginary line along the centre of the limits of the crossing from one side of the road to the other as shown in the diagram in Schedule 14, Part 2, Item 51 of the 2016 Regulations.



The provisions of Regulations 5, 7, 9, 10 and 11 of the 2016 Regulations shall apply to the authorised crossing in the same manner as they apply to the marking shown in the diagram in Schedule 14, Part 2, Item 51 of those Regulations.

Dated *31 August 2022*

Signed by authority of the Secretary of State

.....

A Delegated Official of the Department for Transport



Department
for Transport

**SCANNED
AUTHORISATION
AND SUPPORTING
DOCUMENTS
FOLLOW**



**HIGHWAYS ACT 1980 – SECTION 90
AUTHORISATION OF ROAD HUMPS**

The Secretary of State for Transport, in exercise of his powers under Section 90 of the Highways Act 1980, and of all other powers enabling him in that behalf, for the purpose of reducing vehicle speeds in Warwickshire, for which Warwickshire County Council is the traffic authority, hereby:-

1. authorises the placing upon a road hump, at or within 5 metres of the sites shown schematically on the attached plan numbered GT50/182/0014-1, of a toucan crossing (hereinafter referred to as “the authorised crossing”) as defined within Schedule 1 of the Traffic Signs Regulations and General Directions 2016 (Part 1 of S.I. 2016/362, “the 2016 Regulations”) and conforming as to size, colour and character with those shown on the attached plan numbered GT50/182/0014-2; and
2. directs, without prejudice to any statutory provision to the like effect, that it is a condition of this authorisation that the placing of the authorised crossing at or near the said sites shall continue to have effect only until such day as may be appointed by one month’s notice given by the Secretary of State in writing to the traffic authority for the removal or alteration of the authorised hump/s, and on that day the said authorisation shall, without prejudice to the giving of any further authorisation or direction, cease to have effect.

The provisions of the Highways (Road Humps) Regulations 1999 shall apply to the road humps and the authorised crossing, save that an imaginary line along the centre of the hump from one side of the road to the other need not be in the same position as an imaginary line along the centre of the limits of the crossing from one side of the road to the other as shown in the diagram in Schedule 14, Part 2, Item 51 of the 2016 Regulations.



Department
for Transport

GT50/182/0014

The provisions of Regulations 5, 7, 9, 10 and 11 of the 2016 Regulations shall apply to the authorised crossing in the same manner as they apply to the marking shown in the diagram in Schedule 14, Part 2, Item 51 of those Regulations.

Dated *31 August 2022*

Signed by authority of the Secretary of State

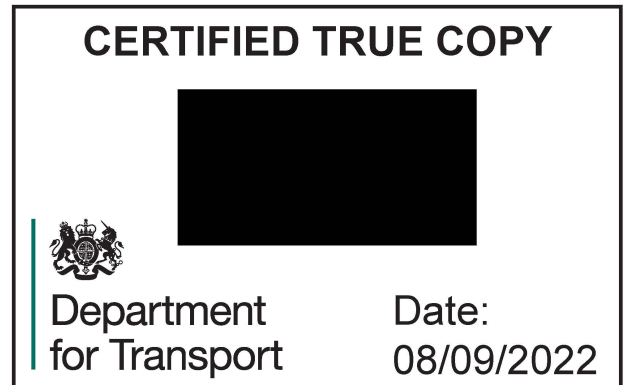
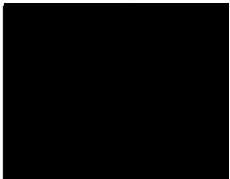

A Delegated Official of the Department for Transport

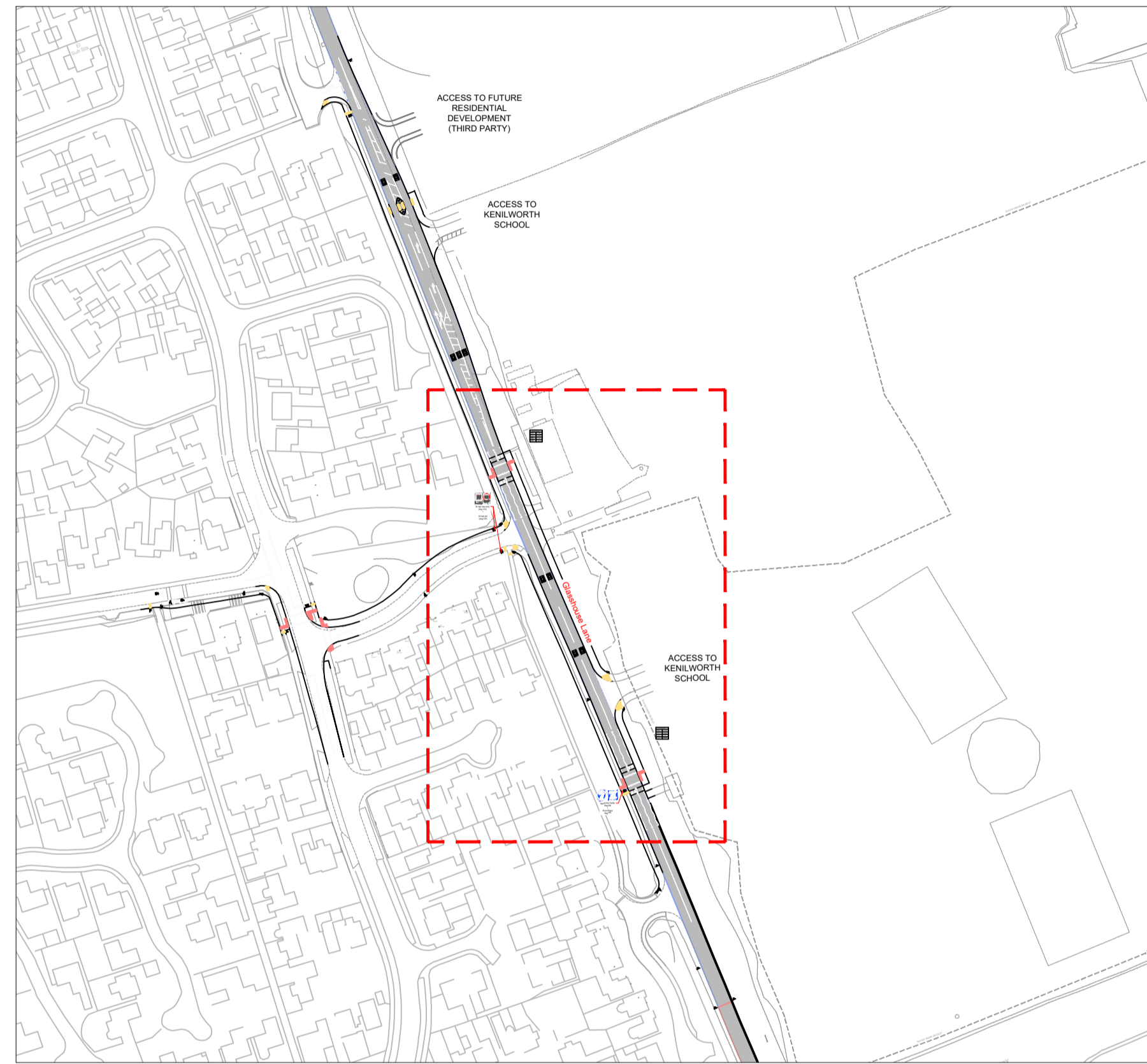

Context Plan
1:2000

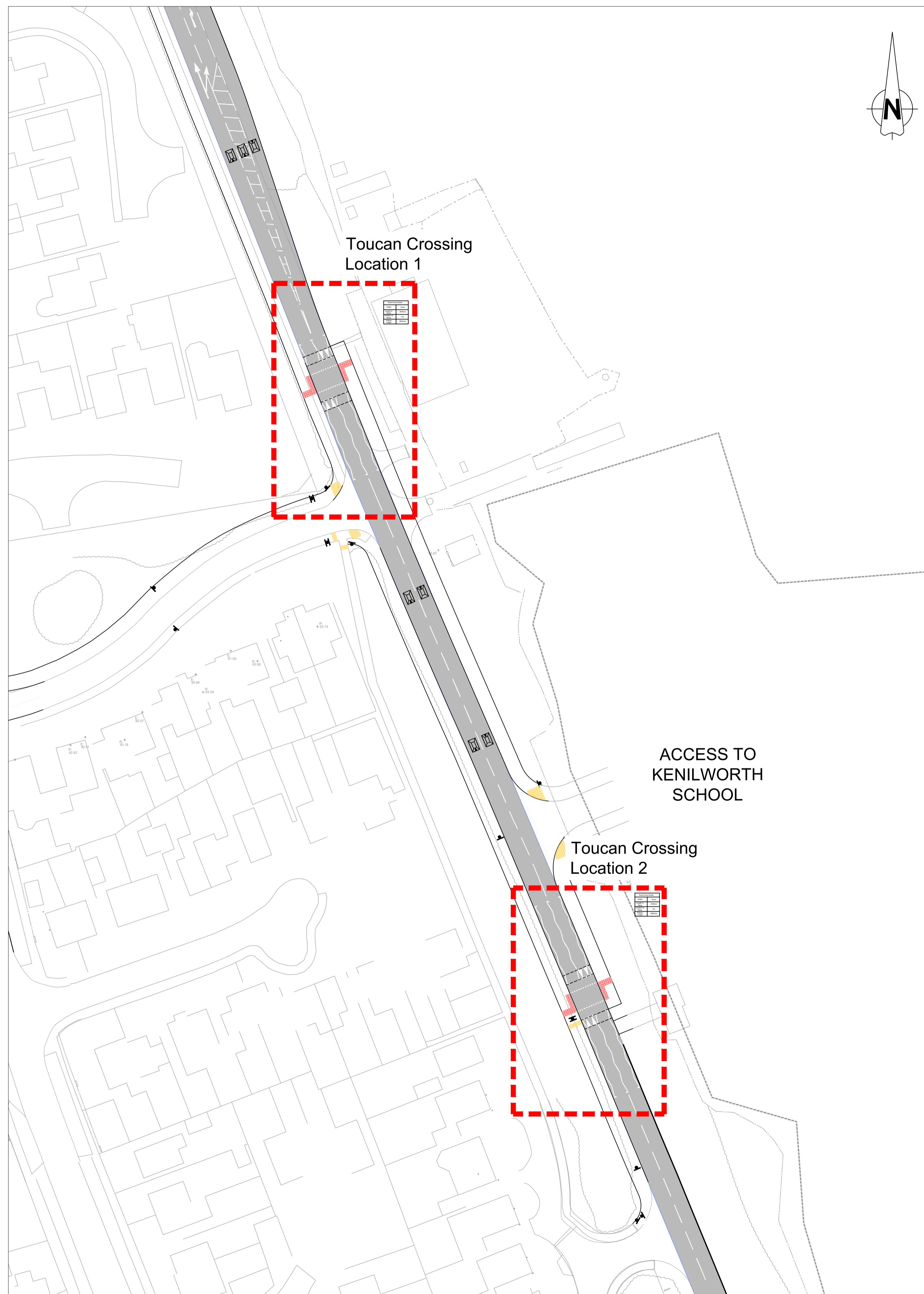

Location Plan
1:500

Construction Design and Management (CDM)
Key Residual Risks
 Contractors entering the site should gain permission from the relevant land owners and/or principle contractor working on site at the time of entry. Contractors shall be responsible for carrying out their own risk assessments and for liaising with the relevant services companies and authorities. Listed below are Site Specific key risks associated with the project.
 1) Overhead and underground services
 2) Street Lighting Cables
 3) Working adjacent to water courses
 4) Soft ground conditions
 5) Working adjacent to live highways
 6) Unchartered services

Notes:

- Do not scale this drawing. All dimensions must be checked/ verified on site. If in doubt ask.
- This drawing is to be read in conjunction with all relevant architects, engineers and specialists drawings and specifications.
- Brookbanks has prepared this drawing for the sole use of the client. The drawing may not be relied upon by any other party without the express agreement of the client and Brookbanks. Where any data supplied by the client or from other sources has been used, it has been assumed that the information is correct. No responsibility can be accepted by Brookbanks for inaccuracies in the data supplied by any other party. The drawing has been produced based on the assumption that all relevant information has been supplied by those bodies from whom it was requested.
- No part of this drawing may be copied or duplicated without the express permission of Brookbanks.
- All dimensions and all levels in meters unless noted otherwise.
- Any discrepancies noted on site are to be reported to the engineer immediately.
- The existing services shown on this drawing are not necessarily complete nor is their location with regard to position and depth precise. It is the contractor's responsibility to liaise with all relevant services companies to ensure that all services are accurately located and adequately protected during construction. The contractor's attention is drawn to the fact that it is highly likely that street lighting cables (or other private supplies) are present which are not shown on incumbent service drawings.
- Section 278 agreement highway works to be carried out in strict accordance with Warwickshire county council's requirements.
- All works within existing public highway, including any temporary works or traffic management measures, are subject to the approval of Warwickshire county council. When works are required on the public highway, the contractor shall liaise with and obtain all statutory approvals from Warwickshire county council, before commencing these works. These approvals include, but are not limited to, approval of traffic management measures, issue of works commencement notices, road opening notices, temporary traffic regulation orders etc.
- All traffic management shall comply with the requirements as set out in chapter 8 of the traffic signs manual. Warning signs may be erected outside the indicated boundaries. Any obstructions to traffic or pedestrians shall be properly signed and protected with barriers, cones, signs, and lamps.
- All planting in visibility splay to be agreed and approved by Warwickshire county council and in all cases no planting to be above 600mm in height above the carriageway. Also no obstructions of any kind within the visibility splay areas.
- Where excavated material is to be reused it shall be classified (graded) and laid and compacted, according to its classification, in accordance with the requirements of the Warwickshire county council highway specification.
- All materials within 450mm of the finished road levels to be non-frost susceptible.
- Limestone or basalt aggregate will not be permitted in the surface course.
- Excavation to depths greater than those shown in the drawing(s) shall not be undertaken without the prior approval of the engineer / Warwickshire county council.
- The engineer / Warwickshire county council shall be immediately notified of any variations to the reported ground conditions.
- All formations shall be proof rolled and any subsequent soft spots excavated and backfilled with type 1 granular material, up to an area of 3m² and 300mm deep. Any soft spots larger than this should be replaced with 6/2 granular material.
- All tactile areas to be laid in accordance with DETR "Guidance on the use of tactile paving surfaces".
- All traffic signs and road markings are to be in accordance with the 'traffic signs regulations and general directions 2016'
- Any damage caused to existing footways, roads or other third party property to be made good to the county engineers requirements.
- Contractor to allow free and full access to the works for local authority, drainage authority and the engineers inspectors.
- Temporary works associated with the construction of the works shall be the responsibility of the contractor.
- Contractor is deemed to have priced for all items and associated items on this drawing, including any earthworks or embankment requirements.
- Should any information included within the approved drawing be in conflict with any other detail specified within other approved supporting drawing, specification or document then WCC inspector should be contacted to provide the correct interpretation of requirements
- All works to be constructed in accordance with MCHW Volume 1 Specification for Highway Works and Warwickshire County Council's highways specification.

First Issue SMG JI RM 27.07.22



6150 Knights Court, Solihull Parkway, Birmingham, B37 7WY
 T +44 (0)203 958 5400 E mail@brookbanks.com
 W brookbanks.com

Kenilworth Multi Academy Trust

Kenilworth School & Sixth Form Relocation Project
 Site Access Scheme

Toucan Crossings:
 Location Plan

Status	Status Date	
Approval	July 2022	
Drawn	Checked	Date
SMG	Jl	27.07.22
Scale	Number	Rev
As shown	10848-100-171	-

UNTIL TECHNICAL APPROVAL HAS BEEN OBTAINED FROM THE RELEVANT LOCAL AUTHORITIES, IT SHOULD BE UNDERSTOOD THAT ALL DRAWINGS ARE ISSUED AS PRELIMINARY AND NOT FOR CONSTRUCTION. SHOULD THE CONTRACTOR COMMENCE SITE WORK PRIOR TO APPROVAL BEING GIVEN, IT IS ENTIRELY AT HIS OWN RISK.

Department for Transport

Date: 12 July 2022

Number: GT50/182/0014-1

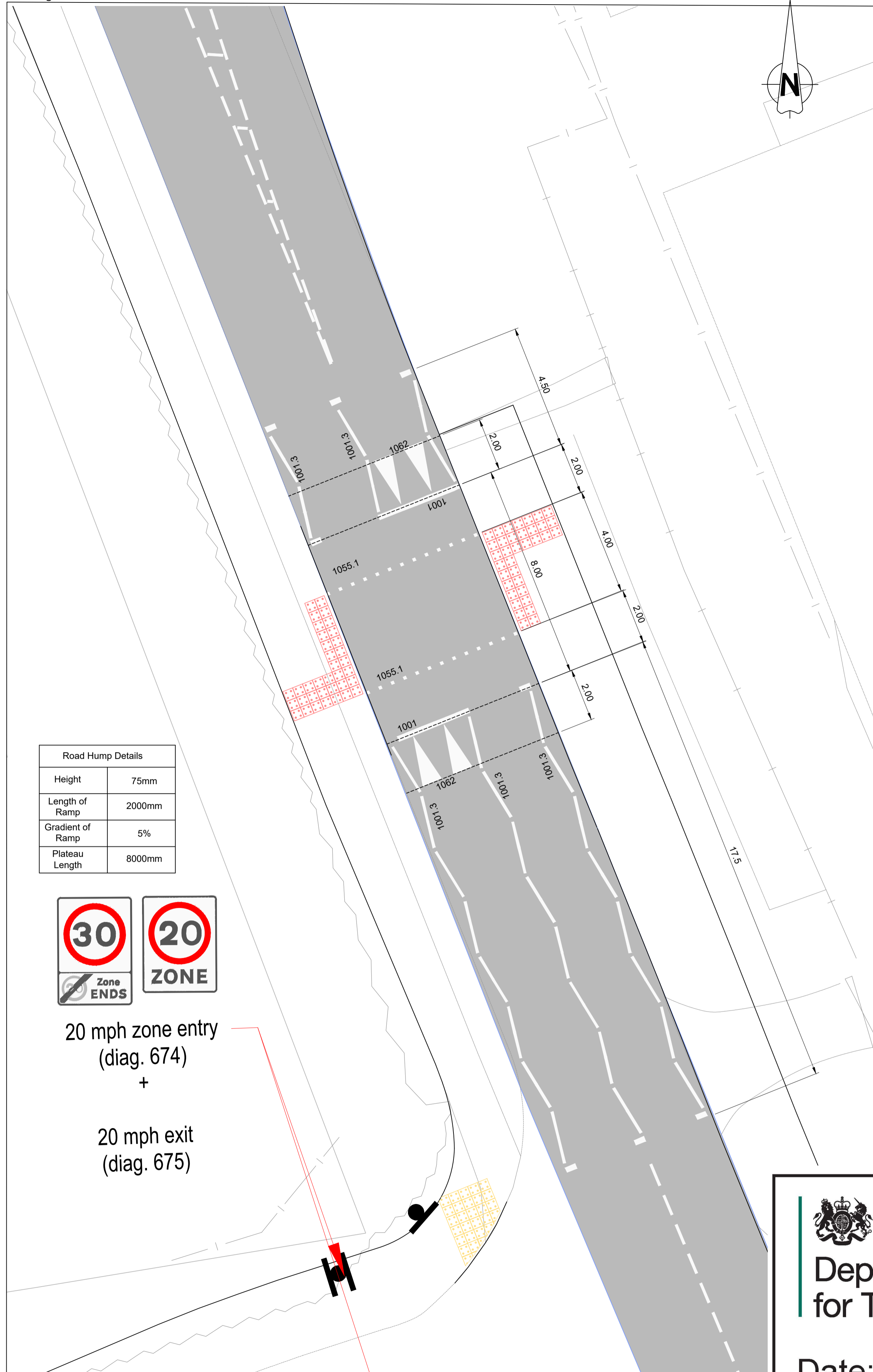

Toucan Crossing Location 1

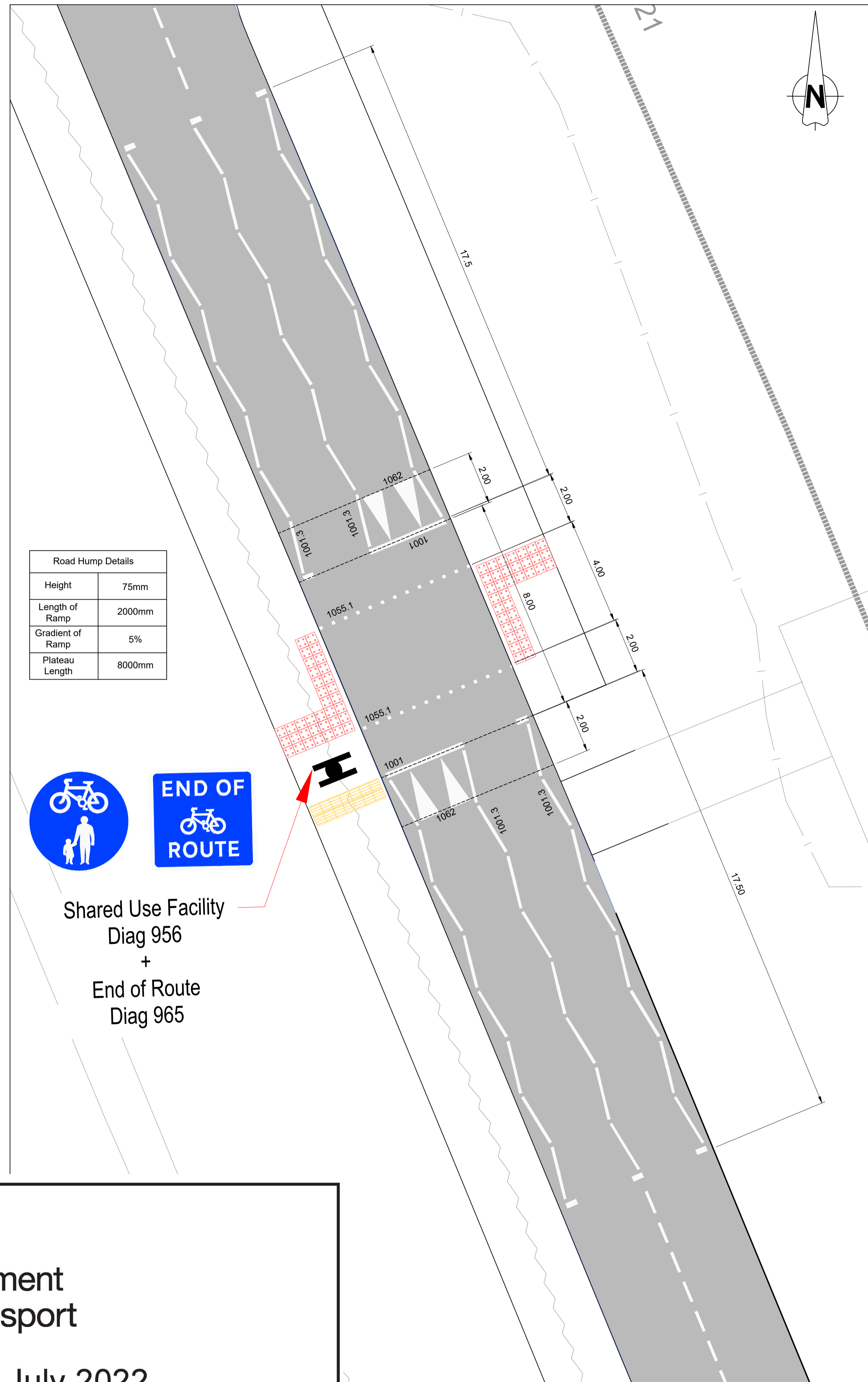

Toucan Crossing Location 2

Construction Design and Management (CDM)
Key Residual Risks

Contractors entering the site should gain permission from the relevant land owners and/or principle contractor working on site at the time of entry. Contractors shall be responsible for carrying out their own risk assessments and for liaising with the relevant services companies and authorities. Listed below are Site Specific key risks associated with the project.

- 1) Overhead and underground services
- 2) Street Lighting Cables
- 3) Working adjacent to water courses
- 4) Soft ground conditions
- 5) Working adjacent to live highways
- 6) Uncharted services

- Notes:**
1. Do not scale this drawing. All dimensions must be checked/ verified on site. If in doubt ask.
 2. This drawing is to be read in conjunction with all relevant architects, engineers and specialists drawings and specifications.
 3. Brookbanks has prepared this drawing for the sole use of the client. The drawing may not be relied upon by any other party without the express agreement of the client and Brookbanks. Where any data supplied by the client or from other sources has been used, it has been assumed that the information is correct. No responsibility can be accepted by Brookbanks for inaccuracies in the data supplied by any other party. The drawing has been produced based on the assumption that all relevant information has been supplied by those bodies from whom it was requested.
 4. No part of this drawing may be copied or duplicated without the express permission of Brookbanks.
 5. All dimensions and all levels in meters unless noted otherwise.
 6. Any discrepancies noted on site are to be reported to the engineer immediately.
 7. The existing services shown on this drawing are not necessarily complete nor is their location with regard to position and depth precise. It is the contractor's responsibility to liaise with all relevant services companies to ensure that all services are accurately located and adequately protected during construction. The contractor's attention is drawn to the fact that it is highly likely that street lighting cables (or other private supplies) are present which are not shown on incumbent service drawings.
 8. Section 278 agreement highway works to be carried out in strict accordance with Warwickshire county council's requirements.
 9. All works within existing public highway, including any temporary works or traffic management measures, are subject to the approval of Warwickshire county council. When works are required on the public highway, the contractor shall liaise with and obtain all statutory approvals from Warwickshire county council, before commencing these works. These approvals include, but are not limited to, approval of traffic management measures, issue of works commencement notices, road opening notices, temporary traffic regulation orders etc.
 10. All traffic management shall comply with the requirements as set out in chapter 8 of the traffic signs manual. Warning signs may be erected outside the indicated boundaries. Any obstructions to traffic or pedestrians shall be properly signed and protected with barriers, cones, signs, and lamps.
 11. All planting in visibility splay areas to be agreed and approved by Warwickshire county council and in all cases no planting to be above 600mm in height above the carriageway. Also no obstructions of any kind within the visibility splay areas.
 12. Where excavated material is to be reused it shall be classified (graded) and laid and compacted, according to its classification, in accordance with the requirements of the Warwickshire county council highway specification.
 13. All materials within 450mm of the finished road levels to be non-frost susceptible.
 14. Limestone or basalt aggregate will not be permitted in the surface course.
 15. Excavation to depths greater than those shown in the drawing(s) shall not be undertaken without the prior approval of the engineer / Warwickshire county council.
 16. The engineer / Warwickshire county council shall be immediately notified of any variations to the reported ground conditions.
 17. All formations shall be proof rolled and any subsequent soft spots excavated and backfilled with type 1 granular material, up to an area of 3m² and 300mm deep. Any soft spots larger than this should be replaced with 6/2 granular material.
 18. All tactile areas to be laid in accordance with DETR "Guidance on the use of tactile paving surfaces".
 19. All traffic signs and road markings are to be in accordance with the traffic signs regulations and general directions 2016.
 20. Any damage caused to existing footways, roads or other third party property to be made good to the county engineers requirements.
 21. Contractor to allow free and full access to the works for local authority, drainage authority and the engineers inspectors.
 22. Temporary works associated with the construction of the works shall be the responsibility of the contractor.
 23. Contractor is deemed to have priced for all items and associated items on this drawing, including any earthworks or embankment requirements.
 24. Should any information included within the approved drawing be in conflict with any other detail specified within other approved supporting drawing, specification or document then WCC inspector should be contacted to provide the correct interpretation of requirements.
 25. All works to be constructed in accordance with MCHW Volume 1 Specification for Highway Works and Warwickshire County Council's highways specification.

First Issue SMG JI RM 27.07.22



6150 Knights Court, Solihull Parkway, Birmingham, B37 7WY
T +44 (0)203 958 5400 E mail@brookbanks.com
W brookbanks.com

Kenilworth Multi Academy Trust

Kenilworth School & Sixth Form Relocation Project Site Access Scheme

Toucan Crossings: Layout Plan

Status	Status Date	
Approval	July 2022	
Drawn	Checked	Date
SMG	Jl	27.07.22
Scale	Number	Rev
1:100	10848-100-172	-

Department for Transport

Date: 12 July 2022

Number: GT50/182/0014-2

UNTIL TECHNICAL APPROVAL HAS BEEN OBTAINED FROM THE RELEVANT LOCAL AUTHORITIES, IT SHOULD BE UNDERSTOOD THAT ALL DRAWINGS ARE ISSUED AS PRELIMINARY AND NOT FOR CONSTRUCTION. SHOULD THE CONTRACTOR COMMENCE SITE WORK PRIOR TO APPROVAL BEING GIVEN, IT IS ENTIRELY AT HIS OWN RISK.

- KEY:**
- Highway boundary
 - Proposed traffic sign
 - Carriageway
 - Footway/ cycleway
 - Embankment/ verge
 - Blister tactile paving (buff at informal crossings)
 - Blister tactile paving (red at signalised crossings)
 - Corduroy tactile paving (buff at termination of shared use facility)
 - Proposed gully
 - Proposed highway drain
 - 2.4 x 90m SSD Junction visibility splay
 - Indicates a residual risk as a warning
 - Proposed traffic signal equipment
 - Proposed street lighting equipment
 - Proposed pedestrian guardrail
 - Proposed timber post and two rail fence (to WCC detail H702.1)

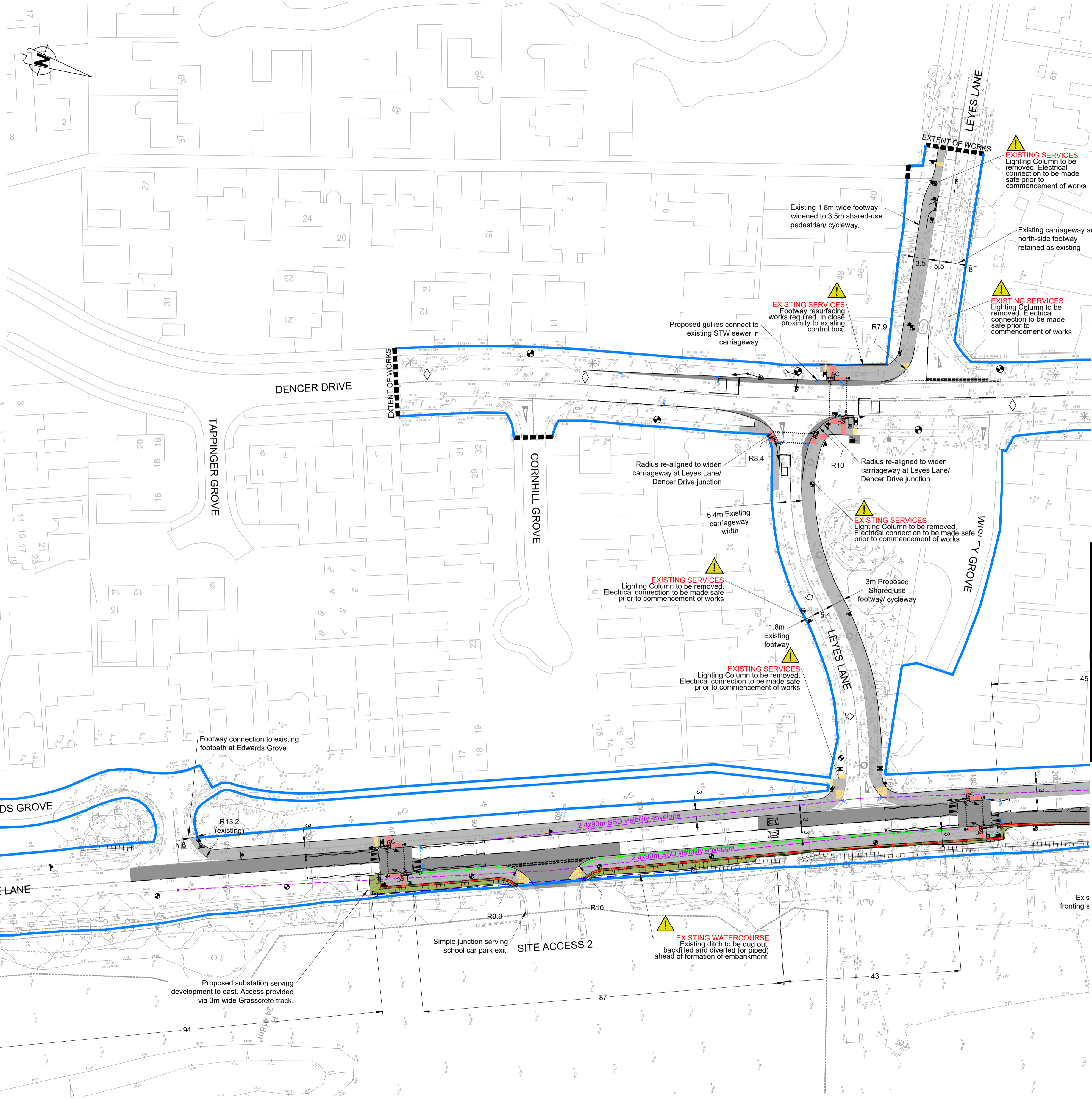

- Construction Design and Management (CDM)**
- Key Residual Risks**
- Contractors entering the site should gain permission from the relevant land owners and/or principle contractor working on site at the time of entry. Contractors shall be responsible for carrying out their own risk assessments and for liaising with the relevant services companies and authorities. Listed below are Site Specific key risks associated with the project.
- 1) Overhead and underground services
 - 2) Street Lighting Cables
 - 3) Working adjacent to water courses
 - 4) Soft ground conditions
 - 5) Working adjacent to live highways
 - 6) Unchartered services

- Notes:**
1. Do not scale this drawing. All dimensions must be checked/ verified on site. If in doubt ask.
 2. This drawing is to be read in conjunction with all relevant architects, engineers and specialists drawings and specifications.
 3. Brookbanks has prepared this drawing for the sole use of the client. The drawing may not be relied upon by any other party without the express agreement of the client and Brookbanks. Where any data supplied by the client or from other sources has been used, it has been assumed that the information is correct. No responsibility can be accepted by Brookbanks for inaccuracies in the data supplied by any other party. The drawing has been produced based on the assumption that all relevant information has been supplied by those bodies from whom it was requested.
 4. No part of this drawing may be copied or duplicated without the express permission of Brookbanks.
 5. All dimensions and all levels in meters unless noted otherwise.
 6. Any discrepancies noted on site are to be reported to the engineer immediately.
 7. The existing services shown on this drawing are not necessarily complete nor is their location with regard to position and depth precise. It is the contractor's responsibility to liaise with all relevant services companies to ensure that all services are accurately located and adequately protected during construction. The contractor's attention is drawn to the fact that it is highly likely that street lighting cables (or other private supplies) are present which are not shown on incumbent service drawings.
 8. Section 278 agreement highway works to be carried out in strict accordance with Warwickshire county council's requirements.
 9. All works within existing public highway, including any temporary works or traffic management measures, are subject to the approval of Warwickshire county council. When works are required on the public highway, the contractor shall liaise with and obtain all statutory approvals from Warwickshire county council, before commencing these works. These approvals include, but are not limited to, approval of traffic management measures, issue of works commencement notices, road opening notices, temporary traffic regulation orders etc.
 10. All traffic management shall comply with the requirements as set out in chapter 8 of the traffic signs manual. Warning signs may be erected outside the indicated boundaries. Any obstructions to traffic or pedestrians shall be properly signed and protected with barriers, cones, signs, and lamps.
 11. All planting in visibility splays to be agreed and approved by Warwickshire county council and in all cases no planting to be above 600mm in height above the carriageway. Also no obstructions of any kind within the visibility splay areas.
 12. Where excavated material is to be reused it shall be classified (graded) and laid and compacted, according to its classification, in accordance with the requirements of the Warwickshire county council highway specification.
 13. All materials within 450mm of the finished road levels to be non-frost susceptible.
 14. Limestone or basalt aggregate will not be permitted in the surface course.
 15. Excavation to depths greater than those shown in the drawing(s) shall not be undertaken without the prior approval of the engineer / Warwickshire county council.
 16. The engineer / Warwickshire county council shall be immediately notified of any variations to the reported ground conditions.
 17. All formations shall be proof rolled and any subsequent soft spots excavated and backfilled with type 1 granular material, up to an area of 3m² and 300mm deep. Any soft spots larger than this should be replaced with 6/2 granular material.
 18. All tactile areas to be laid in accordance with DETR "Guidance on the use of tactile paving surfaces".
 19. All traffic signs and road markings are to be in accordance with the 'traffic signs regulations and general directions 2016'.
 20. Any damage caused to existing footways, roads or other third party property to be made good to the county engineers requirements.
 21. Contractor to allow free and full access to the works for local authority, drainage authority and the engineers inspectors.
 22. Temporary works associated with the construction of the works shall be the responsibility of the contractor.
 23. Contractor is deemed to have priced for all items and associated items on this drawing, including any earthworks or embankment requirements.
 24. Should any information included within the approved drawing be in conflict with any other detail specified within other approved supporting drawing, specification or document then WCC inspector should be contacted to provide the correct interpretation of requirements.
 25. All works to be constructed in accordance with MCHW Volume 1 Specification for Highway Works and Warwickshire County Council's highways specification.

A Amended to WCC comments 1 MA JI RM 04.05.22
 First Issue CDW JI RM 31.01.22

BROOKBANKS

6150 Knights Court, Solihull Parkway, Birmingham, B37 7WY
 T +44 (0)203 958 5400 E mail@brookbanks.com
 W brookbanks.com

Kenilworth Multi Academy Trust

Kenilworth School & Sixth Form Relocation Project

Site Access Scheme

General Arrangement Sheet 1

Status	Status Date
Approval	Jan 2022
Drawn	Checked
CDW	JJ
Scale	Number
1:500	10848-100-101
	Rev
	A



UNTIL TECHNICAL APPROVAL HAS BEEN OBTAINED FROM THE RELEVANT LOCAL AUTHORITIES, IT SHOULD BE UNDERSTOOD THAT ALL DRAWINGS ARE ISSUED AS PRELIMINARY AND NOT FOR CONSTRUCTION. SHOULD THE CONTRACTOR COMMENCE SITE WORK PRIOR TO APPROVAL BEING GIVEN, IT IS ENTIRELY AT HIS OWN RISK.

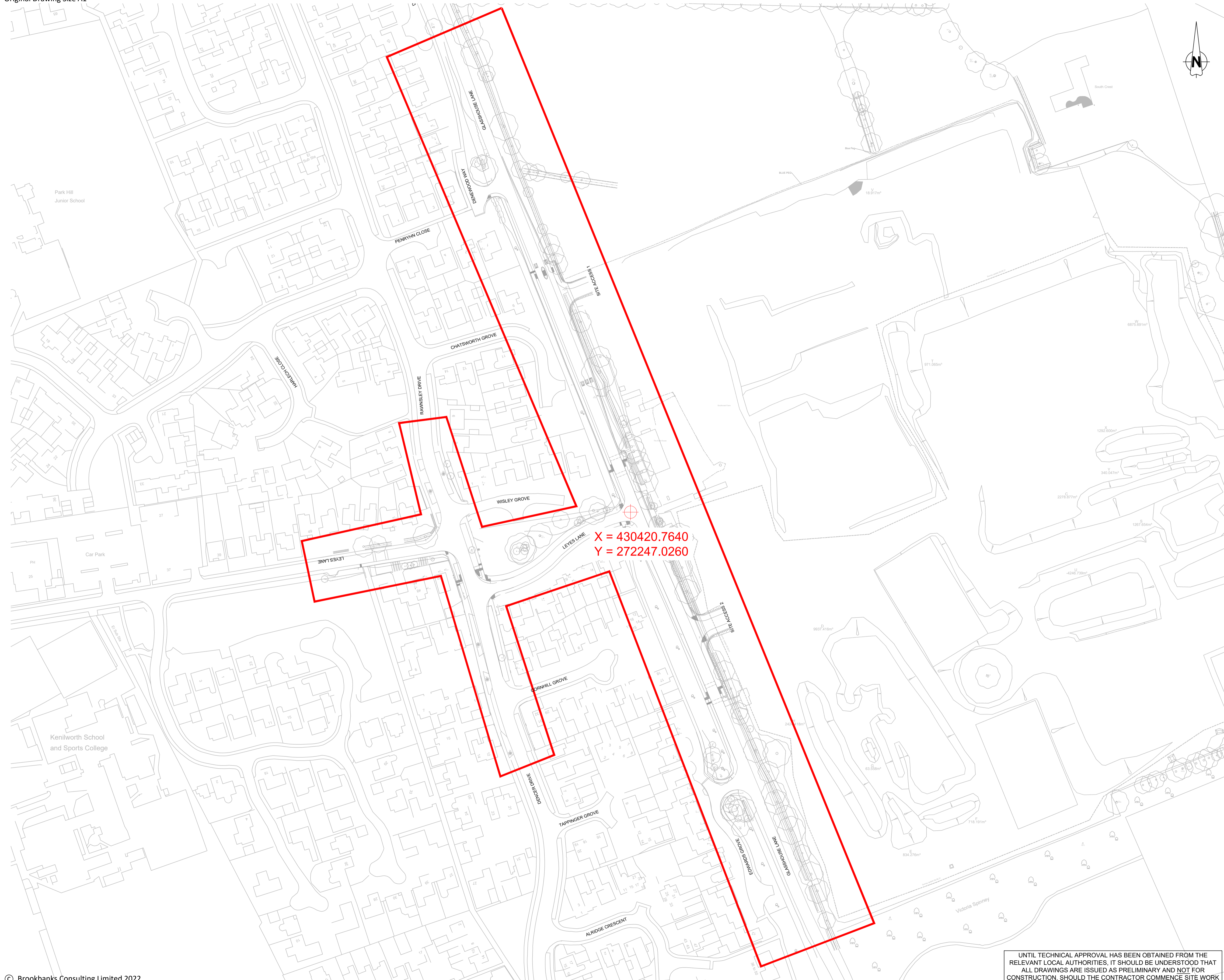

Construction Design and Management (CDM)
Key Residual Risks
 Contractors entering the site should gain permission from the relevant land owners and/or principle contractor working on site at the time of entry. Contractors shall be responsible for carrying out their own risk assessments and for liaising with the relevant services companies and authorities. Listed below are Site Specific key risks associated with the project.
 1) Overhead and underground services
 2) Street Lighting Cables
 3) Working adjacent to water courses
 4) Soft ground conditions
 5) Working adjacent to live highways
 6) Unchartered services

- Notes:**
- Do not scale this drawing. All dimensions must be checked/verified on site. If in doubt ask.
 - This drawing is to be read in conjunction with all relevant architects, engineers and specialists drawings and specifications.
 - Brookbanks has prepared this drawing for the sole use of the client. The drawing may not be relied upon by any other party without the express agreement of the client and Brookbanks. Where any data supplied by the client or from other sources has been used, it has been assumed that the information is correct. No responsibility can be accepted by Brookbanks for inaccuracies in the data supplied by any other party. The drawing has been produced based on the assumption that all relevant information has been supplied by those bodies from whom it was requested.
 - No part of this drawing may be copied or duplicated without the express permission of Brookbanks.
 - All dimensions and all levels in meters unless noted otherwise.
 - Any discrepancies noted on site are to be reported to the engineer immediately.
 - The existing services shown on this drawing are not necessarily complete nor is their location with regard to position and depth precise. It is the contractor's responsibility to liaise with all relevant services companies to ensure that all services are accurately located and adequately protected during construction. The contractor's attention is drawn to the fact that it is highly likely that street lighting cables (or other private supplies) are present which are not shown on incumbent service drawings.
 - Section 278 agreement highway works to be carried out in strict accordance with Warwickshire County Council's requirements.
 - All works within existing public highway, including any temporary works or traffic management measures, are subject to the approval of Warwickshire County Council. When works are required on the public highway, the contractor shall liaise with and obtain all statutory approvals from Warwickshire County Council, before commencing these works. These approvals include, but are not limited to, approval of traffic management measures, issue of works commencement notices, road opening notices, temporary traffic regulation orders etc.
 - All traffic management shall comply with the requirements as set out in chapter 8 of the traffic signs manual. Warning signs may be erected outside the indicated boundaries. Any obstructions to traffic or pedestrians shall be properly signed and protected with barriers, cones, signs, and lamps.
 - All planting in visibility splays to be agreed and approved by Warwickshire County Council and in all cases no planting to be above 600mm in height above the carriageway. Also no obstructions of any kind within the visibility splay areas.
 - Where excavated material is to be reused it shall be classified (graded) and laid and compacted, according to its classification, in accordance with the requirements of the Warwickshire County Council highway specification.
 - All materials within 450mm of the finished road levels to be non-frost susceptible.
 - Limestone or basalt aggregate will not be permitted in the surface course.
 - Excavation to depths greater than those shown in the drawing(s) shall not be undertaken without the prior approval of the engineer / Warwickshire County Council.
 - The engineer / Warwickshire County Council shall be immediately notified of any variations to the reported ground conditions.
 - All formations shall be proof rolled and any subsequent soft spots excavated and backfilled with type 1 granular material, up to an area of 3m² and 300mm deep. Any soft spots larger than this should be replaced with 6/2 granular material.
 - All tactile areas to be laid in accordance with DETR "Guidance on the use of tactile paving surfaces".
 - All traffic signs and road markings are to be in accordance with the traffic signs regulations and general directions 2016.
 - Any damage caused to existing footways, roads or other third party property to be made good to the county engineers requirements.
 - Contractor to allow free and full access to the works for local authority, drainage authority and the engineers inspectors.
 - Temporary works associated with the construction of the works shall be the responsibility of the contractor.
 - Contractor is deemed to have priced for all items and associated items on this drawing, including any earthworks or embankment requirements.
 - Should any information included within the approved drawing be in conflict with any other detail specified within other approved supporting drawing, specification or document then WCC Inspector should be contacted to provide the correct interpretation of requirements.
 - All works to be constructed in accordance with MCHW Volume 1 Specification for Highway Works and Warwickshire County Council's Highways Specification.

KEY:
 Indicative works boundary (refer to S278 coloured plan for definitive extent of works)

A Amended to WCC comments 1 MA JI RM 04.05.22
 First Issue HG JI RM 31.01.22

BROOKBANKS
 6150 Knights Court, Solihull Parkway, Birmingham, B37 7WY
 T +44 (0)203 958 5400 E mail@brookbanks.com
 W brookbanks.com

Kenilworth Multi Academy Trust
Kenilworth School & Sixth Form Relocation Project
Site Access Scheme
Location Plan

Status	Status Date
Approval	Jan 2022
Drawn	Checked
HG	JJ
Scale	Number
1:1000	10848-100-111
	Rev
	A

0 20 40 60 80 100
 METRES

UNTIL TECHNICAL APPROVAL HAS BEEN OBTAINED FROM THE RELEVANT LOCAL AUTHORITIES, IT SHOULD BE UNDERSTOOD THAT ALL DRAWINGS ARE ISSUED AS PRELIMINARY AND NOT FOR CONSTRUCTION. SHOULD THE CONTRACTOR COMMENCE SITE WORK PRIOR TO APPROVAL BEING GIVEN, IT IS ENTIRELY AT HIS OWN RISK.

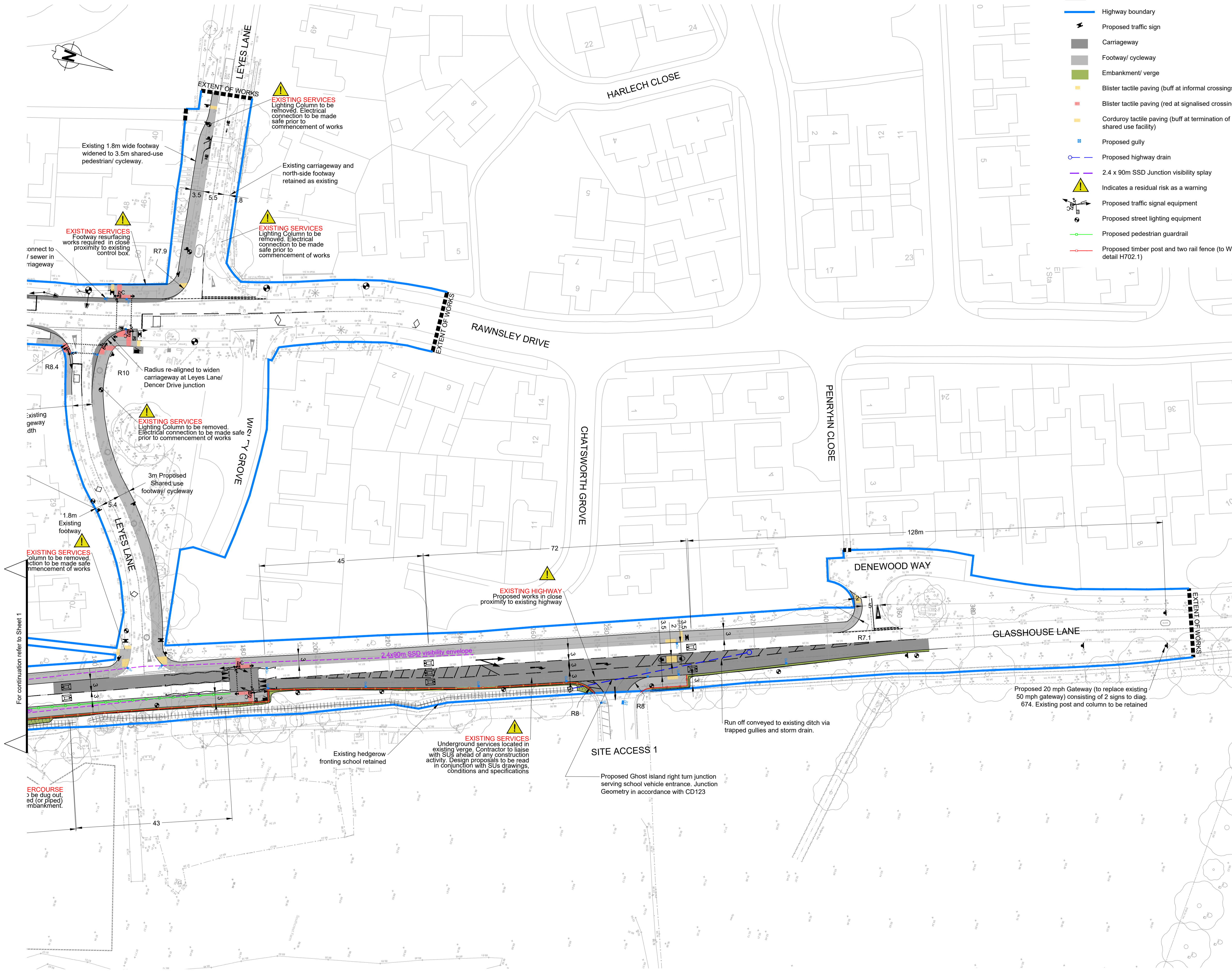

- KEY:**
- Highway boundary
 - Proposed traffic sign
 - Carriageway
 - Footway/ cycleway
 - Embankment/ verge
 - Blister tactile paving (buff at informal crossings)
 - Blister tactile paving (red at signalised crossings)
 - Corduroy tactile paving (buff at termination of shared use facility)
 - Proposed gully
 - Proposed highway drain
 - 2.4 x 90m SSD Junction visibility splay
 - Indicates a residual risk as a warning
 - Proposed traffic signal equipment
 - Proposed street lighting equipment
 - Proposed pedestrian guardrail
 - Proposed timber post and two rail fence (to WCC detail H702.1)

Construction Design and Management (CDM)
Key Residual Risks
 Contractors entering the site should gain permission from the relevant land owners and/or principle contractor working on site at the time of entry. Contractors shall be responsible for carrying out their own risk assessments and for liaising with the relevant services companies and authorities. Listed below are Site Specific key risks associated with the project.

- 1) Overhead and underground services
- 2) Street Lighting Cables
- 3) Working adjacent to water courses
- 4) Soft ground conditions
- 5) Working adjacent to live highways
- 6) Unchartered services

- Notes:**
1. Do not scale this drawing. All dimensions must be checked/ verified on site. If in doubt ask.
 2. This drawing is to be read in conjunction with all relevant architects, engineers and specialists drawings and specifications.
 3. Brookbanks has prepared this drawing for the sole use of the client. The drawing may not be relied upon by any other party without the express agreement of the client and Brookbanks. Where any data supplied by the client or from other sources has been used, it has been assumed that the information is correct. No responsibility can be accepted by Brookbanks for inaccuracies in the data supplied by any other party. The drawing has been produced based on the assumption that all relevant information has been supplied by those bodies from whom it was requested.
 4. No part of this drawing may be copied or duplicated without the express permission of Brookbanks.
 5. All dimensions and all levels in meters unless noted otherwise.
 6. Any discrepancies noted on site are to be reported to the engineer immediately.
 7. The existing services shown on this drawing are not necessarily complete nor is their location with regard to position and depth precise. It is the contractor's responsibility to liaise with all relevant services companies to ensure that all services are accurately located and adequately protected during construction. The contractor's attention is drawn to the fact that it is highly likely that street lighting cables (or other private supplies) are present which are not shown on incumbent service drawings.
 8. Section 278 agreement highway works to be carried out in strict accordance with Warwickshire county council's requirements.
 9. All works within existing public highway, including any temporary works or traffic management measures, are subject to the approval of Warwickshire county council. When works are required on the public highway, the contractor shall liaise with and obtain all statutory approvals from Warwickshire county council, before commencing these works. These approvals include, but are not limited to, approval of traffic management measures, issue of works commencement notices, road opening notices, temporary traffic regulation orders etc.
 10. All traffic management shall comply with the requirements as set out in chapter 8 of the traffic signs manual. Warning signs may be erected outside the indicated boundaries. Any obstructions to traffic or pedestrians shall be properly signed and protected with barriers, cones, signs, and lamps.
 11. All planting in visibility splays to be agreed and approved by Warwickshire county council and in all cases no planting to be above 600mm in height above the carriageway. Also no obstructions of any kind within the visibility splay areas.
 12. Where excavated material is to be reused it shall be classified (graded) and laid and compacted, according to its classification, in accordance with the requirements of the Warwickshire county council highway specification.
 13. All materials within 450mm of the finished road levels to be non-frost susceptible.
 14. Limestone or basalt aggregate will not be permitted in the surface course.
 15. Excavation to depths greater than those shown in the drawing(s) shall not be undertaken without the prior approval of the engineer / Warwickshire county council.
 16. The engineer / Warwickshire county council shall be immediately notified of any variations to the reported ground conditions.
 17. All formations shall be proof rolled and any subsequent soft spots excavated and backfilled with type 1 granular material, up to an area of 3m² and 300mm deep. Any soft spots larger than this should be replaced with 6/2 granular material.
 18. All tactile areas to be laid in accordance with DETR "Guidance on the use of tactile paving surfaces".
 19. All traffic signs and road markings are to be in accordance with the traffic signs regulations and general directions 2016.
 20. Any damage caused to existing footways, roads or other third party property to be made good to the county engineers requirements.
 21. Contractor to allow free and full access to the works for local authority, drainage authority and the engineers inspectors.
 22. Temporary works associated with the construction of the works shall be the responsibility of the contractor.
 23. Contractor is deemed to have priced for all items and associated items on this drawing, including any earthworks or embankment requirements.
 24. Should any information included within the approved drawing be in conflict with any other detail specified within other approved supporting drawing, specification or document then WCC inspector should be contacted to provide the correct interpretation of requirements.
 25. All works to be constructed in accordance with MCHW Volume 1 Specification for Highway Works and Warwickshire County Council's highway specification.

First Issue CDW JI RM 04.05.22

BROOKBANKS
 6150 Knights Court, Solihull Parkway, Birmingham, B37 7WY
 T +44 (0)203 958 5400 E mail@brookbanks.com
 W brookbanks.com

Kenilworth Multi Academy Trust
Kenilworth School & Sixth Form Relocation Project
Site Access Scheme
General Arrangement Sheet 2

Status	Date	Status	Date
Approval	April 2022	Drawn	Checked
CDW	Ji	27.04.22	
Scale	Number	Rev	
1:500	10848-100-102	-	

0 10 20 30 40 50
 METRES

UNTIL TECHNICAL APPROVAL HAS BEEN OBTAINED FROM THE RELEVANT LOCAL AUTHORITIES, IT SHOULD BE UNDERSTOOD THAT ALL DRAWINGS ARE ISSUED AS PRELIMINARY AND NOT FOR CONSTRUCTION. SHOULD THE CONTRACTOR COMMENCE SITE WORK PRIOR TO APPROVAL BEING GIVEN, IT IS ENTIRELY AT HIS OWN RISK.

Key Residual Risks

Contractors entering the site should gain permission from the relevant land owners and/or principle contractor working on site at the time of entry. Contractors shall be responsible for carrying out their own risk assessments and for liaising with the relevant services companies and authorities. Listed below are Site Specific key risks associated with the project.

- 1) Overhead and underground services
- 2) Street Lighting Cables
- 3) Working adjacent to water courses
- 4) Soft ground conditions
- 5) Working adjacent to live highways
- 6) Unchartered services

Notes:

1. Do not scale this drawing. All dimensions must be checked/ verified on site. If in doubt ask.
2. This drawing is to be read in conjunction with all relevant architects, engineers and specialists drawings and specifications.
3. Brookbanks has prepared this drawing for the sole use of the client. The drawing may not be relied upon by any other party without the express agreement of the client and Brookbanks. Where any data supplied by the client or from other sources has been used, it has been assumed that the information is correct. No responsibility can be accepted by Brookbanks for inaccuracies in the data supplied by any other party. The drawing has been produced based on the assumption that all relevant information has been supplied by those bodies from whom it was requested.
4. No part of this drawing may be copied or duplicated without the express permission of Brookbanks.
5. All dimensions and all levels in meters unless noted otherwise.
6. Any discrepancies noted on site are to be reported to the engineer immediately.
7. The existing services shown on this drawing are not necessarily complete nor is their location with regard to position and depth precise. It is the contractor's responsibility to liaise with all relevant services companies to ensure that all services are accurately located and adequately protected during construction. The contractor's attention is drawn to the fact that it is highly likely that street lighting cables (or other private supplies) are present which are not shown on incumbent service drawings.
8. Section 278 agreement highway works to be carried out in strict accordance with Warwickshire county council's requirements.
9. All works within existing public highway, including any temporary works or traffic management measures, are subject to the approval of Warwickshire county council. When works are required on the public highway, the contractor shall liaise with and obtain all statutory approvals from Warwickshire county council, before commencing these works. These approvals include, but are not limited to, approval of traffic management measures, issue of works commencement notices, road opening notices, temporary traffic regulation orders etc.
10. All traffic management shall comply with the requirements as set out in chapter 8 of the traffic signs manual. Warning signs may be erected outside the indicated boundaries. Any obstructions to traffic or pedestrians shall be properly signed and protected with barriers, cones, signs, and lamps.
11. All planting in visibility splays to be agreed and approved by Warwickshire county council and in all cases no planting to be above 600mm in height above the carriageway. Also no obstructions of any kind within the visibility splay areas.
12. Where excavated material is to be reused it shall be classified (graded) and laid and compacted, according to its classification, in accordance with the requirements of the Warwickshire county council highway specification.
13. All materials within 450mm of the finished road levels to be non-frost susceptible.
14. Limestone or basalt aggregate will not be permitted in the surface course.
15. Excavation to depths greater than those shown in the drawing(s) shall not be undertaken without the prior approval of the engineer / Warwickshire county council.
16. The engineer / Warwickshire county council shall be immediately notified of any variations to the reported ground conditions.
17. All formations shall be proof rolled and any subsequent soft spots excavated and backfilled with type 1 granular material, up to an area of 3m² and 300mm deep. Any soft spots larger than this should be replaced with 6/2 granular material.
18. All tactile areas to be laid in accordance with DETR "Guidance on the use of tactile paving surfaces".
19. All traffic signs and road markings are to be in accordance with the 'traffic signs regulations and general directions 2016'.
20. Any damage caused to existing footways, roads or other third party property to be made good to the county engineers requirements.
21. Contractor to allow free and full access to the works for local authority, drainage authority and the engineers inspectors.
22. Temporary works associated with the construction of the works shall be the responsibility of the contractor.
23. Contractor is deemed to have priced for all items and associated items on this drawing, including any earthworks or embankment requirements.
24. Should any information included within the approved drawing be in conflict with any other detail specified within other approved supporting drawing, specification or document then WCC inspector should be contacted to provide the correct interpretation of requirements.
25. All works to be constructed in accordance with MCHW Volume 1 Specification for Highway Works and Warwickshire County Council's Highways Specification.

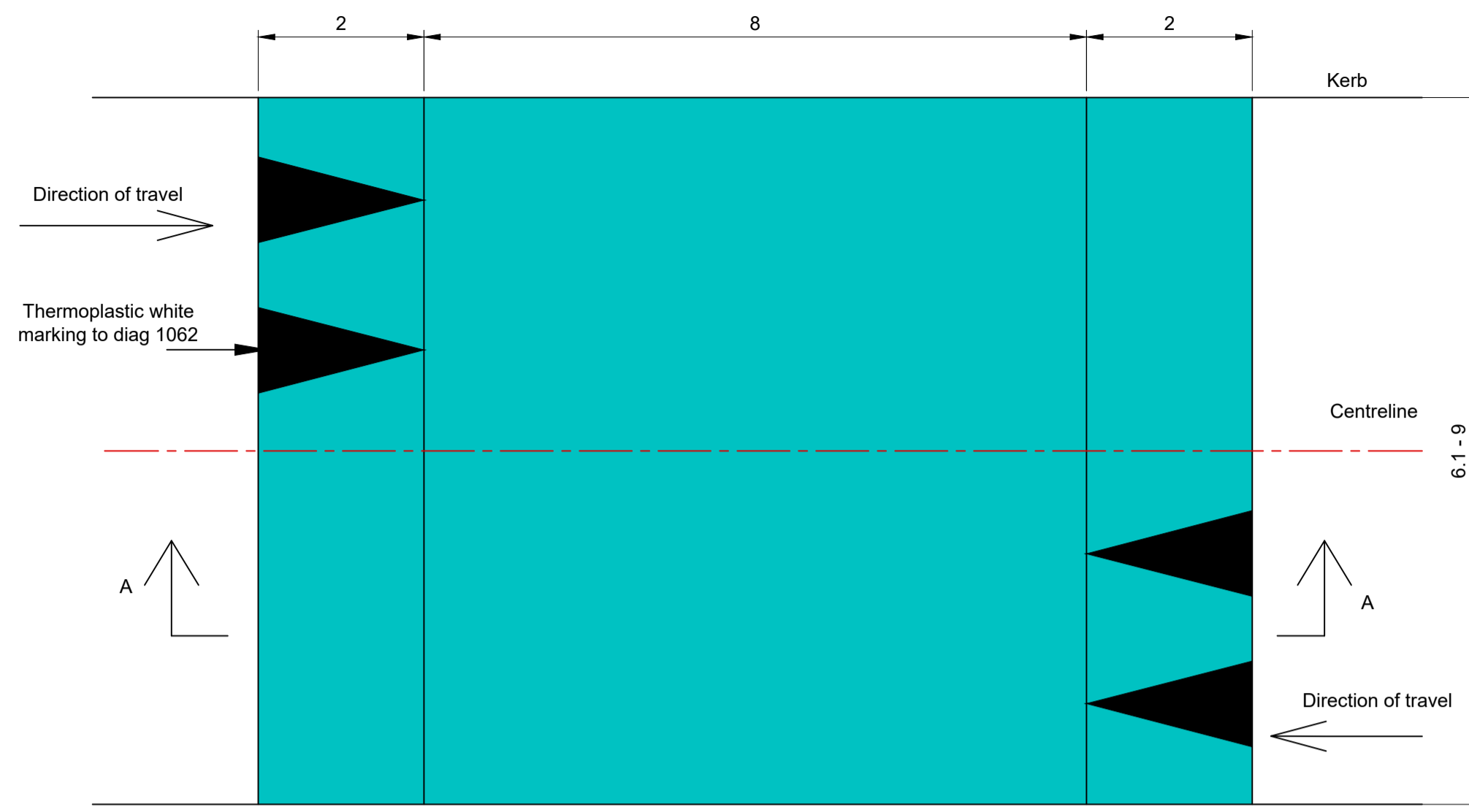

Plan Layout
Scale 1:50

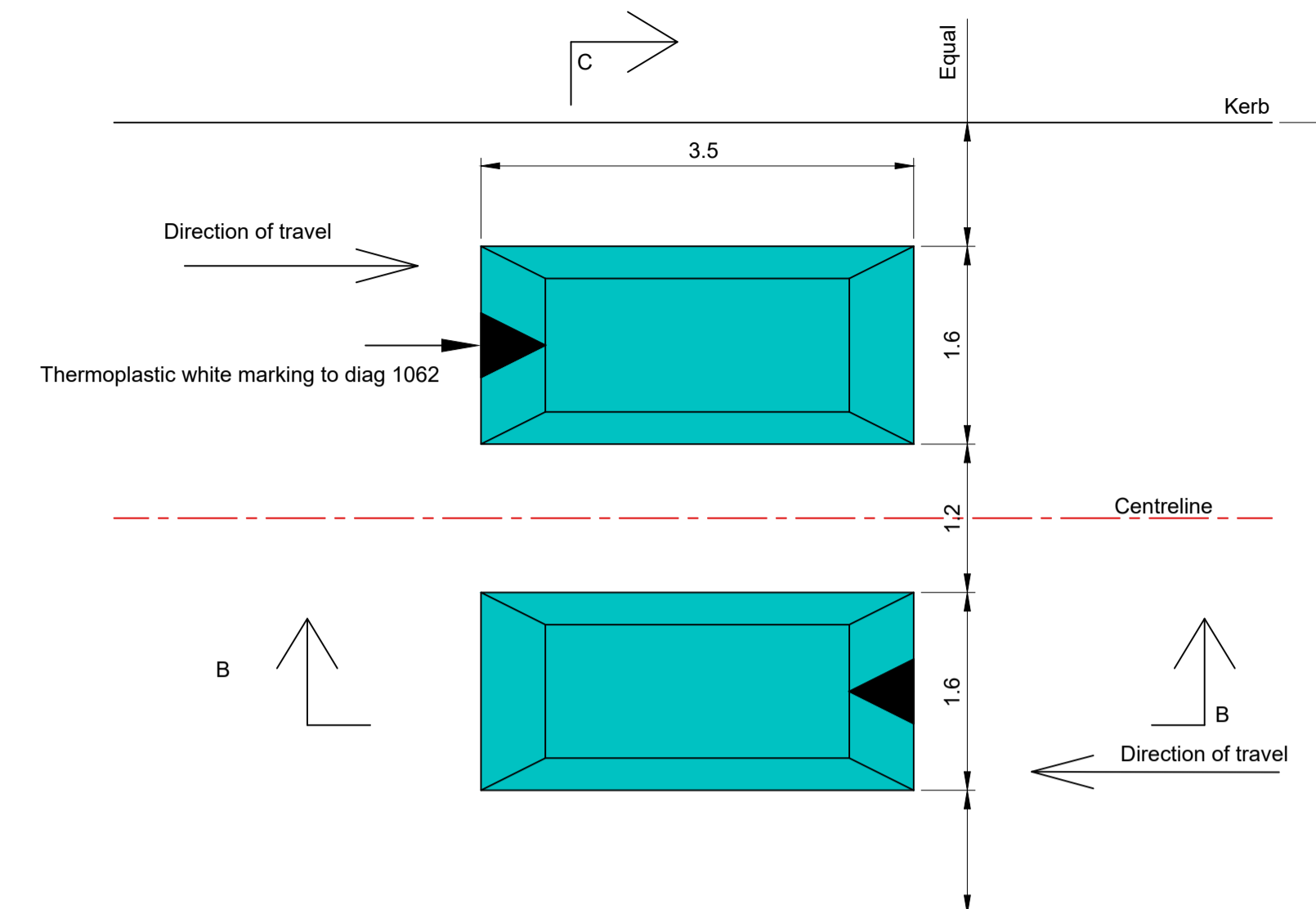

Plan Layout
Scale 1:50

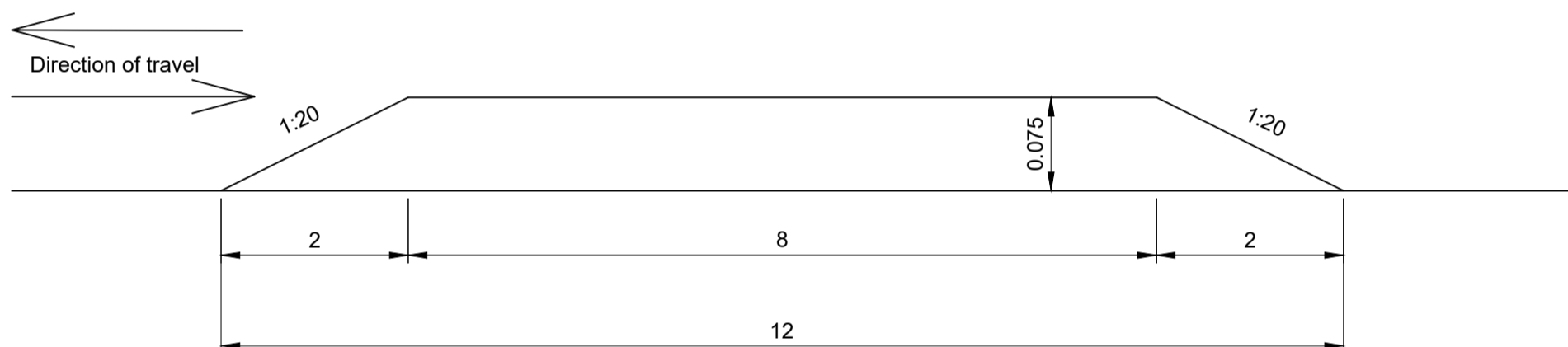

Section A-A
Scale 1:50

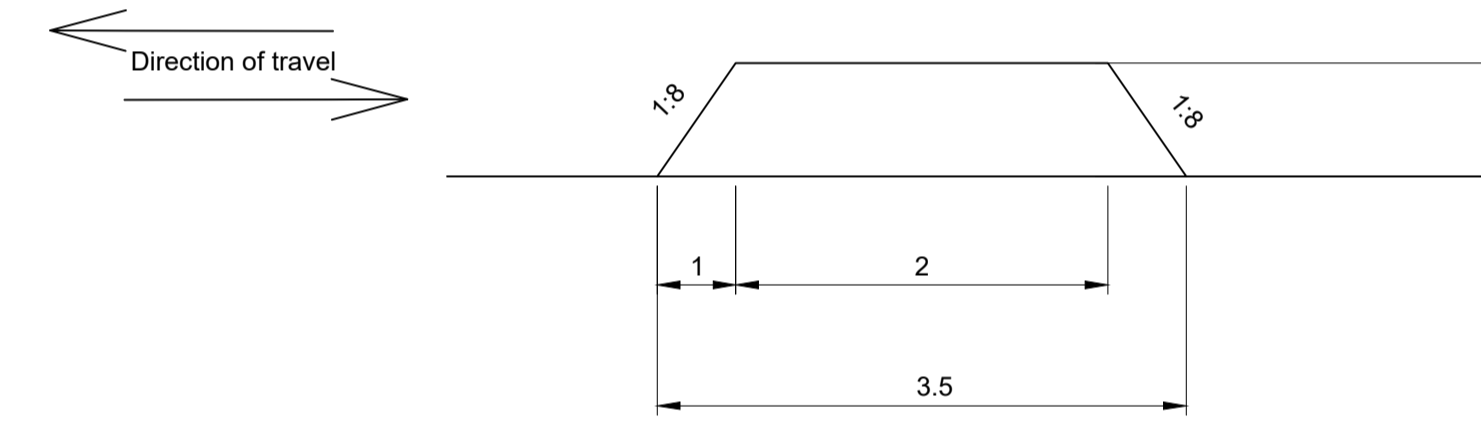

Section B-B
Scale 1:50

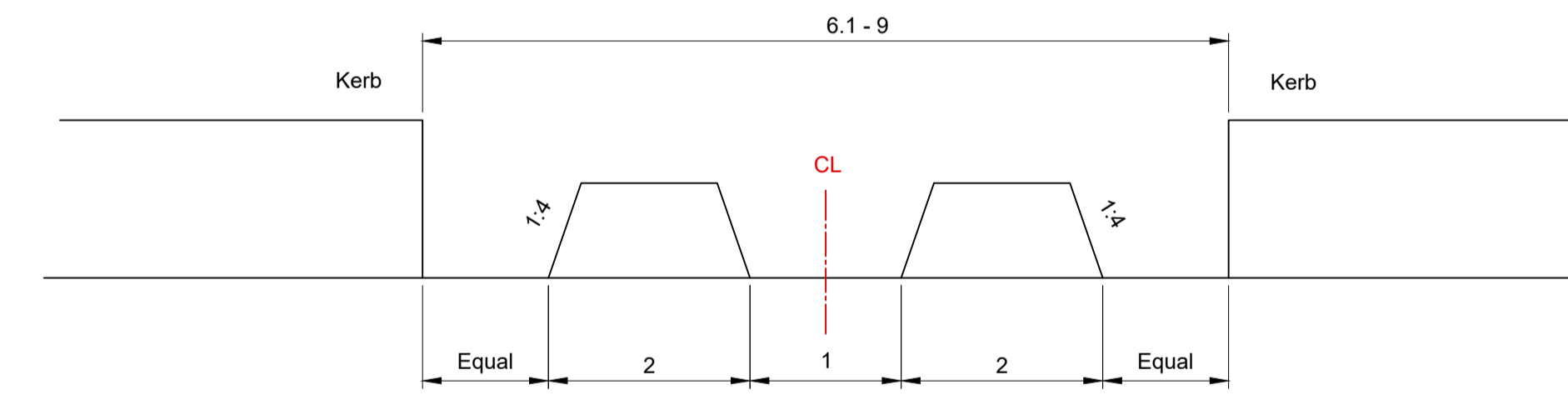

Section C-C
Scale 1:50

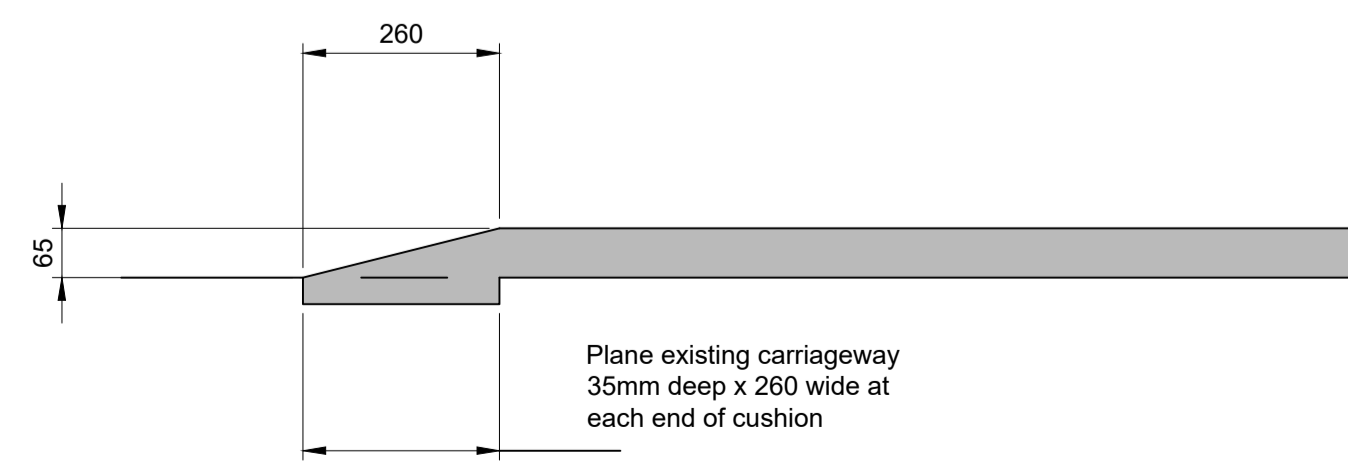

Side Ramps
Scale 1:10

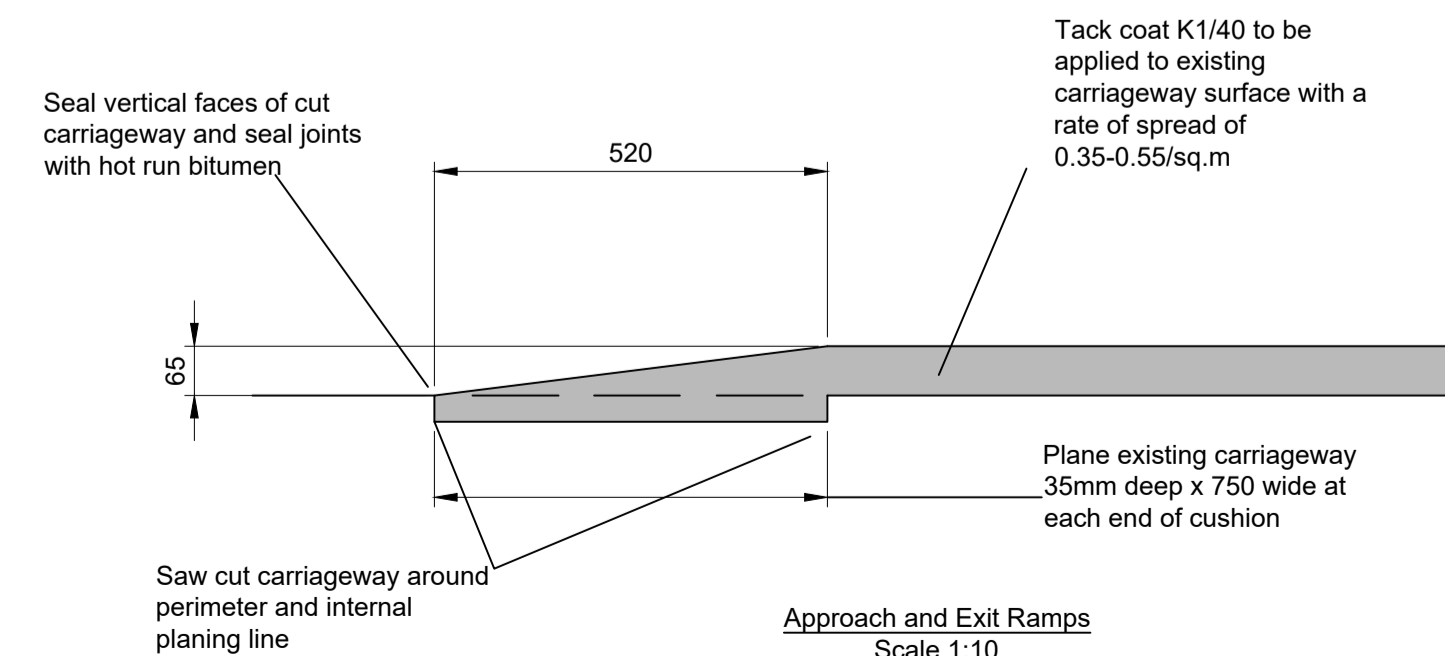

Approach and Exit Ramps
Scale 1:10

UNTIL TECHNICAL APPROVAL HAS BEEN OBTAINED FROM THE RELEVANT LOCAL AUTHORITIES, IT SHOULD BE UNDERSTOOD THAT ALL DRAWINGS ARE ISSUED AS PRELIMINARY AND NOT FOR CONSTRUCTION. SHOULD THE CONTRACTOR COMMENCE SITE WORK PRIOR TO APPROVAL BEING GIVEN, IT IS ENTIRELY AT HIS OWN RISK.



6150 Knights Court, Solihull Parkway, Birmingham, B37 7WY
T +44 (0)203 958 5400 E mail@brookbanks.com
W brookbanks.com

Kenilworth Multi Academy
Trust

Kenilworth School & Sixth Form
Site Access Scheme

Traffic Calming Details

Status	Status Date	
Approval	April 2022	
Drawn	Checked	Date
J1	J1	27.04.22
Scale	Number	Rev
As Shown	10848-100-152	-