



Department
for Transport

Road Traffic Regulation Act 1984 Sections 64 and 65

Authorisation of traffic signs and special directions

Accessible transcript

Secretary of State for Transport's traffic authorisation of traffic signs for the purpose of reducing vehicle speeds in Great Western Road, Gloucester for which Gloucestershire County Council is the traffic authority.

The following pages contain a copy of the text from the Secretary of State for Transport's traffic authorisation regarding the above traffic signs.

A scanned copy of the signed authorisation and supporting documents from the application are appended to this letter. The supporting material is submitted to the Department for Transport by a third party. You should refer to the party involved for accessible copies of the supporting material.



**HIGHWAYS ACT 1980 – SECTION 90
AUTHORISATION OF ROAD HUMPS**

The Secretary of State for Transport, in exercise of her powers under Section 90 of the Highways Act 1980, and of all other powers enabling her in that behalf, for the purpose of reducing vehicle speeds in Great Western Road, Gloucester for which Gloucestershire County Council is the traffic authority, hereby:-

1. authorises the placing upon a road hump, at or within 5 metres of the site shown schematically on the attached plan numbered GT50/048/0028-1 of a parallel crossing (hereinafter referred to as “the authorised crossing”) as defined within Schedule 1 of the Traffic Signs Regulations and General Directions 2016 (Part 1 of S.I. 2016/362, “the 2016 Regulations”) and conforming as to size, colour and character with that shown on the attached plan numbered GT50/048/0028-2, and
2. directs that the provisions of Schedule 14, Part 2, Item 53, Columns 4 and 5 of the 2016 Regulations shall apply to the authorised crossing; and
3. directs, without prejudice to any statutory provision to the like effect, that it is a condition of this authorisation that the placing of the authorised crossing at or near the said site shall continue to have effect only until such day as may be appointed by one month’s notice given by the Secretary of State in writing to the traffic authority for the removal or alteration of the authorised hump, and on that day the said authorisation shall, without prejudice to the giving of any further authorisation or direction, cease to have effect.

The provisions of the Highways (Road Humps) Regulations 1999 shall apply to the road hump and the authorised crossing, save that an imaginary line along the centre of each hump from one side of the road to the other need not be in the same position as an imaginary line along the centre of the limits of the crossing from one side of the road to the other as shown in the diagram in Schedule 14, Part 2, Item 53 of the 2016 Regulations.



Department
for Transport

GT50/048/0028

The provisions of Regulations 5, 7, 9, 10 and 11 of the 2016 Regulations shall apply to the authorised crossing in the same manner as they apply to the marking shown in the diagram in Schedule 14, Part 2, Item 53 of those Regulations.

Dated *06 January 2025*

Signed by authority of the Secretary of State

.....
A Delegated Official of the Department for Transport



Department
for Transport

**SCANNED
AUTHORISATION
AND SUPPORTING
DOCUMENTS
FOLLOW**



**HIGHWAYS ACT 1980 – SECTION 90
AUTHORISATION OF ROAD HUMPS**

The Secretary of State for Transport, in exercise of her powers under Section 90 of the Highways Act 1980, and of all other powers enabling her in that behalf, for the purpose of reducing vehicle speeds in Great Western Road, Gloucester for which Gloucestershire County Council is the traffic authority, hereby:-

1. authorises the placing upon a road hump, at or within 5 metres of the site shown schematically on the attached plan numbered GT50/048/0028-1 of a parallel crossing (hereinafter referred to as “the authorised crossing”) as defined within Schedule 1 of the Traffic Signs Regulations and General Directions 2016 (Part 1 of S.I. 2016/362, “the 2016 Regulations”) and conforming as to size, colour and character with that shown on the attached plan numbered GT50/048/0028-2, and
2. directs that the provisions of Schedule 14, Part 2, Item 53, Columns 4 and 5 of the 2016 Regulations shall apply to the authorised crossing; and
3. directs, without prejudice to any statutory provision to the like effect, that it is a condition of this authorisation that the placing of the authorised crossing at or near the said site shall continue to have effect only until such day as may be appointed by one month’s notice given by the Secretary of State in writing to the traffic authority for the removal or alteration of the authorised hump, and on that day the said authorisation shall, without prejudice to the giving of any further authorisation or direction, cease to have effect.

The provisions of the Highways (Road Humps) Regulations 1999 shall apply to the road hump and the authorised crossing, save that an imaginary line along the centre of each hump from one side of the road to the other need not be in the same position as an imaginary line along the centre of the limits of the crossing from one side of the road to the other as shown in the diagram in Schedule 14, Part 2, Item 53 of the 2016 Regulations.



Department
for Transport

GT50/048/0028

The provisions of Regulations 5, 7, 9, 10 and 11 of the 2016 Regulations shall apply to the authorised crossing in the same manner as they apply to the marking shown in the diagram in Schedule 14, Part 2, Item 53 of those Regulations.

Dated *06 January 2025*

Signed by authority of the Secretary of State

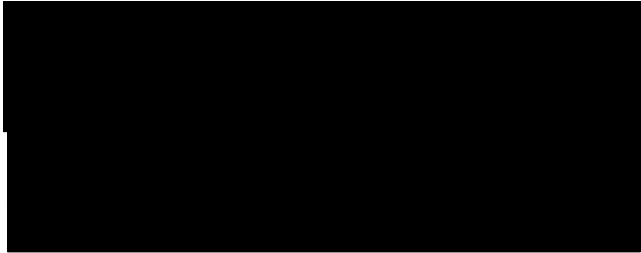

.....
A Delegated Official of the Department for Transport

CERTIFIED TRUE COPY



Department
for Transport

Date:
06/01/2025

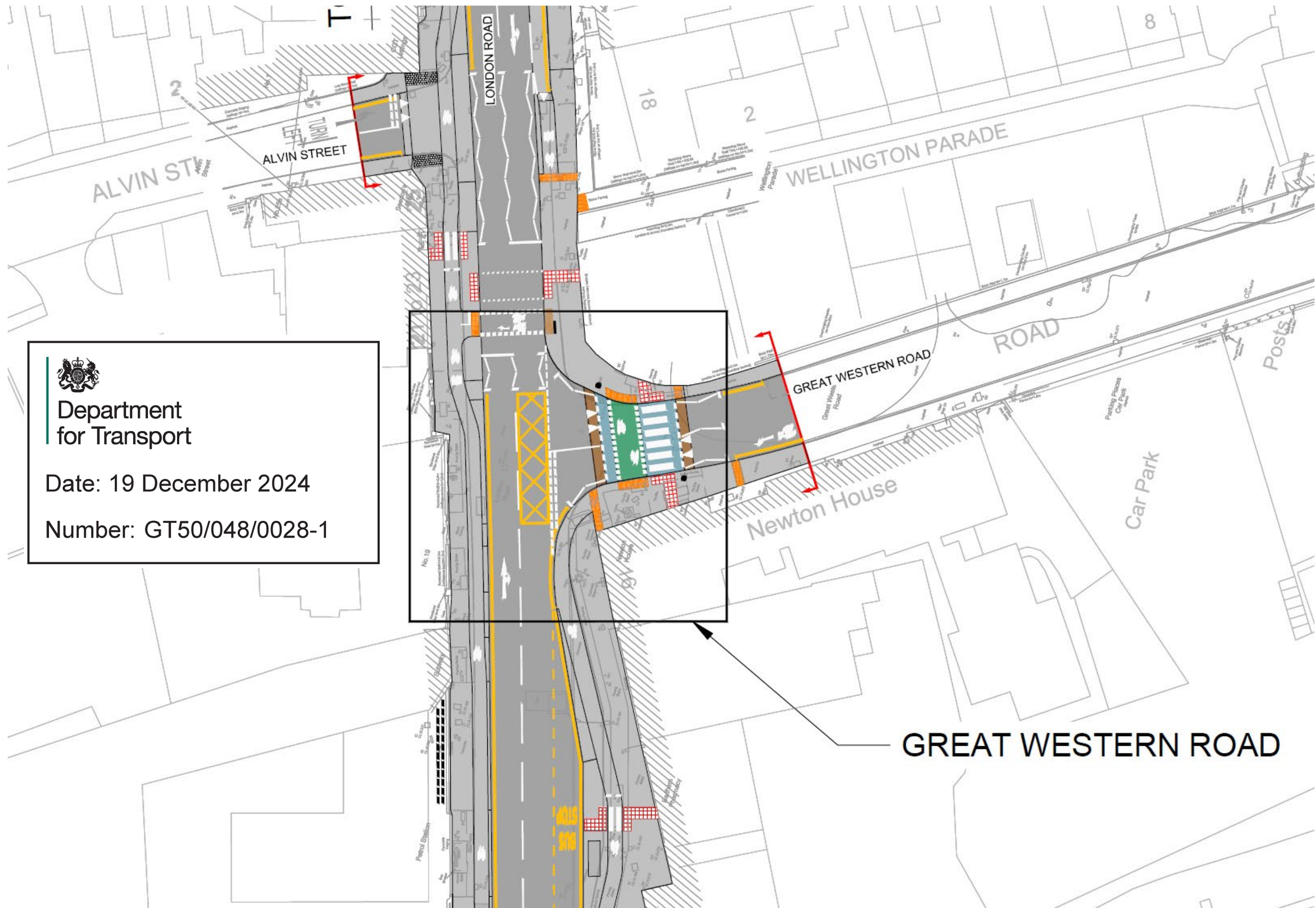

Department
for Transport
Date: 19 December 2024
Number: GT50/048/0028-1

GREAT WESTERN ROAD

Great Western Road, Gloucester, Gloucestershire. Postcode (nearest): GL1 3NE

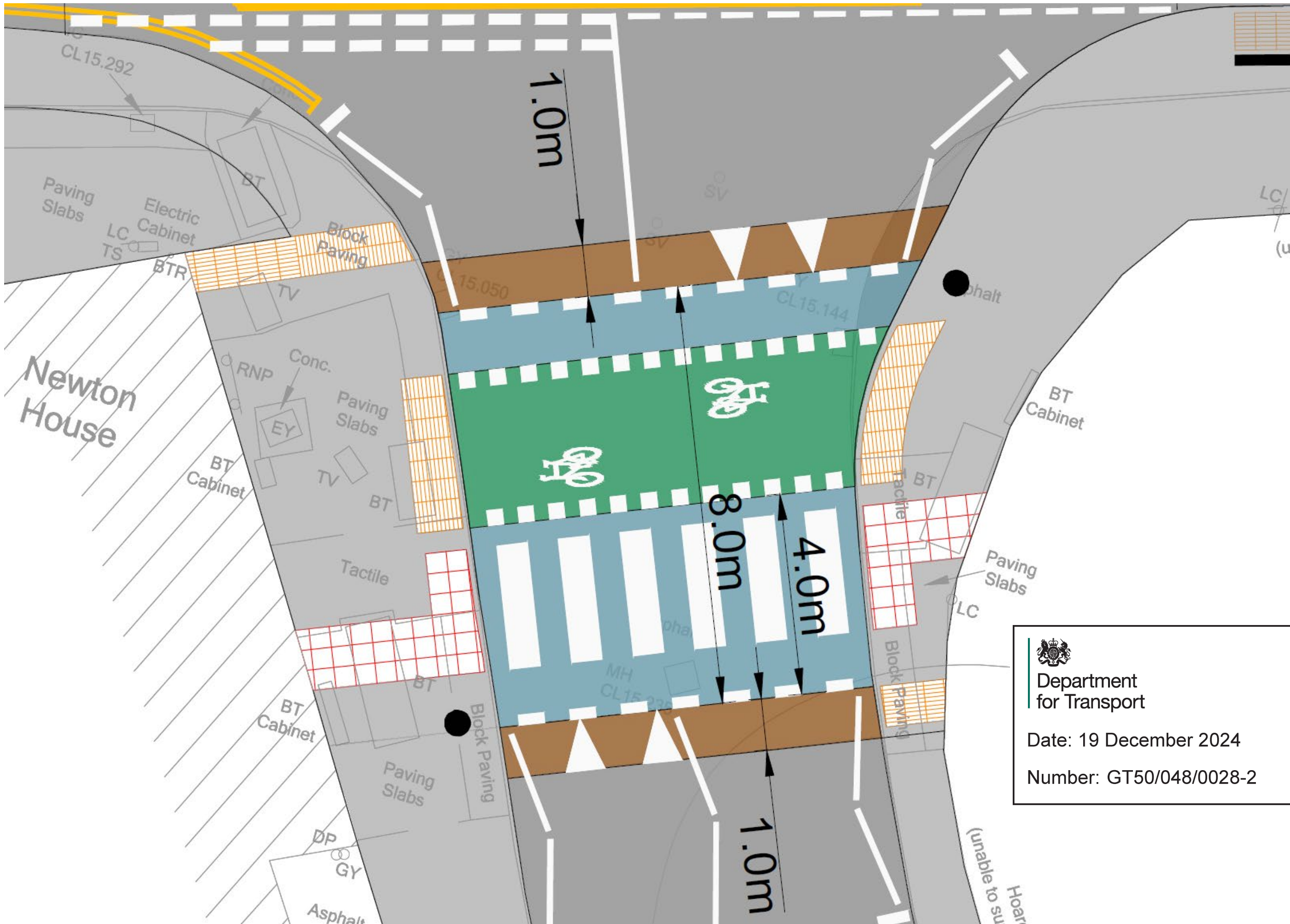



 Department
 for Transport
 Date: 19 December 2024
 Number: GT50/048/0028-2

DO NOT SCALE

0 10

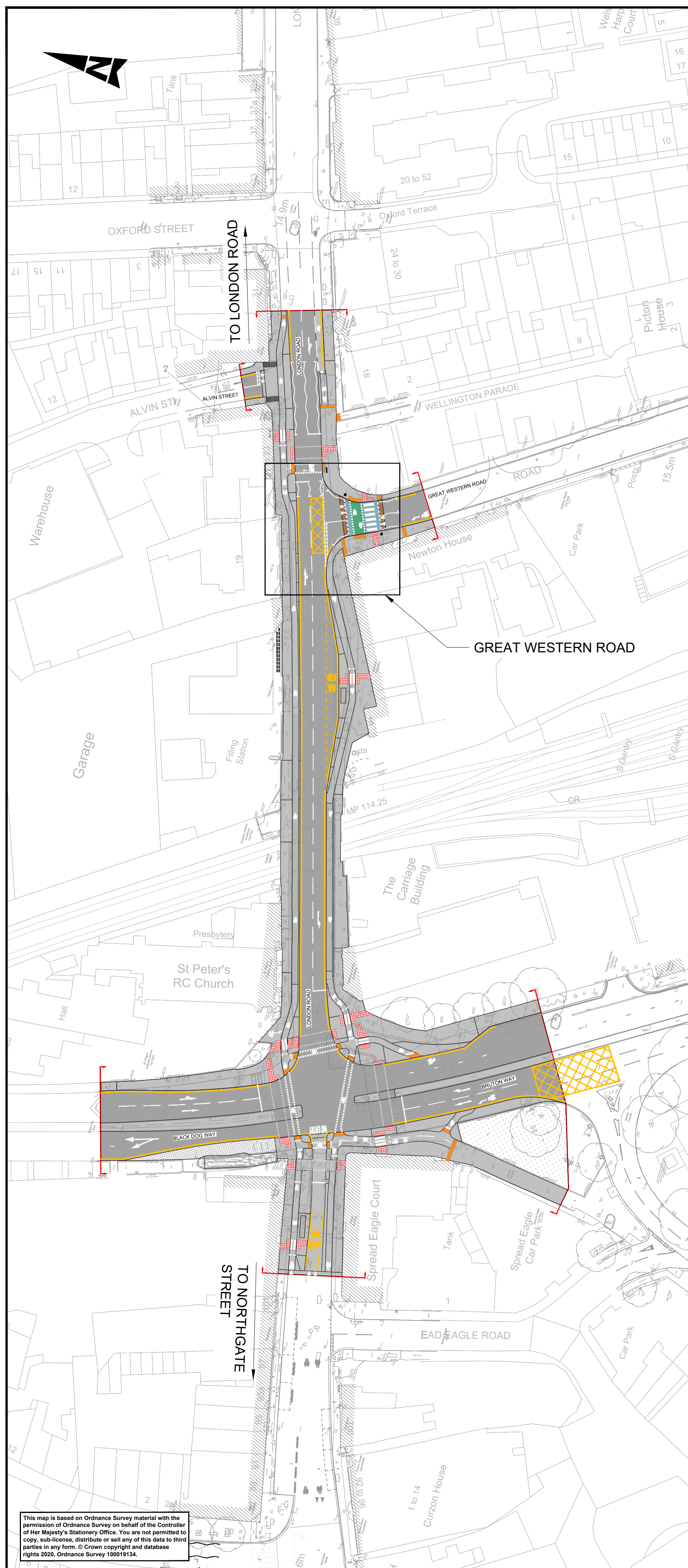
100



This map is based on Ordnance Survey material with the permission of Ordnance Survey on behalf of the Controller of Her Majesty's Stationery Office. You are not permitted to copy, sub-license, distribute or sell any of this data to third parties in any form. © Crown copyright and database rights 2020, Ordnance Survey 100019134.

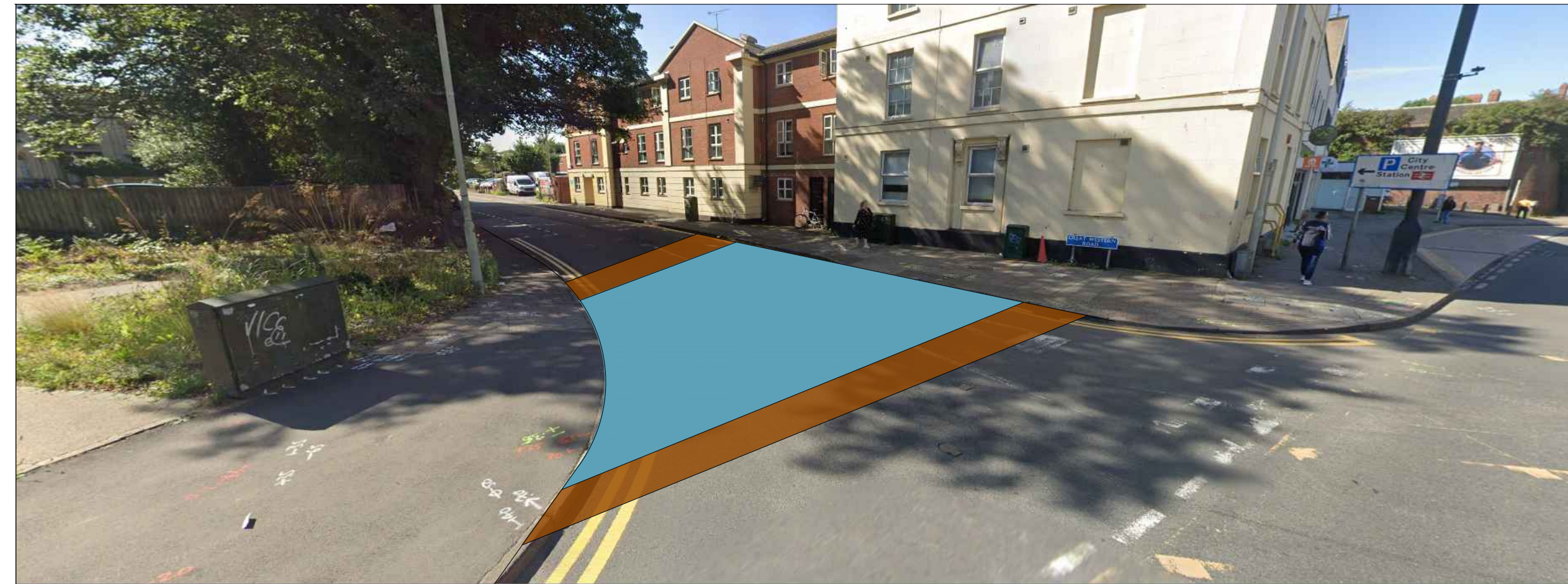

PROPOSED RAISED TABLE ON THE EXISTING ARRANGEMENT
CHAINAGE AT 185m

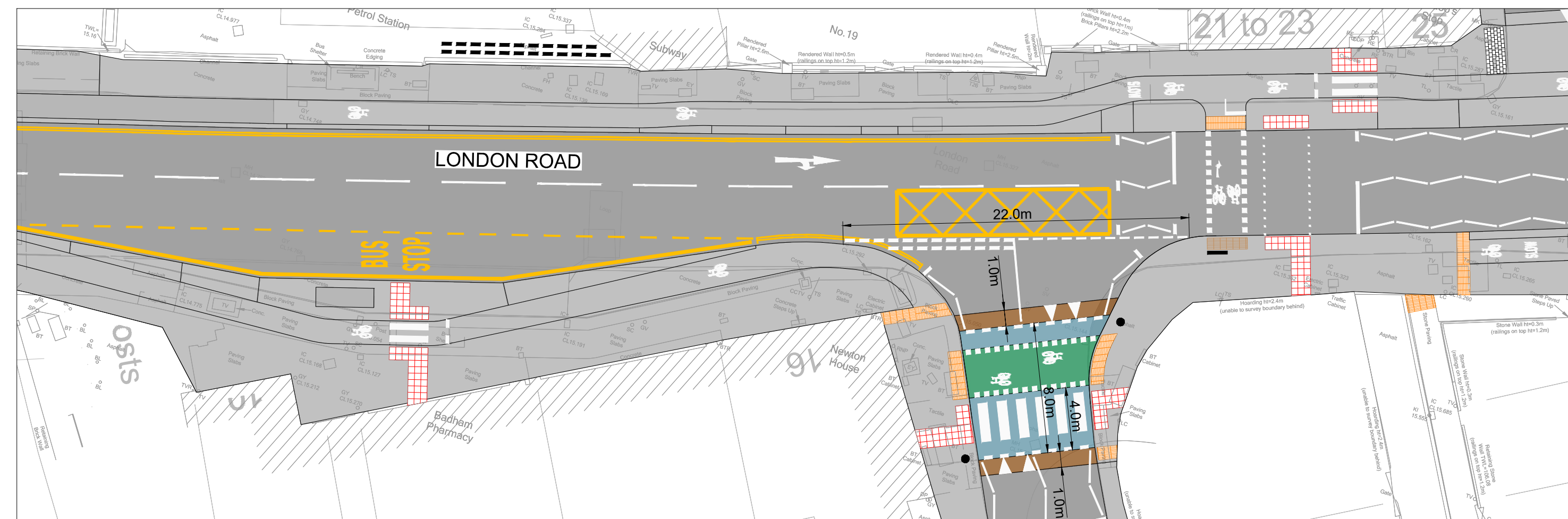

PROPOSED ARRANGEMENT WITH ROAD
HUMP (FLAT TOP) AT CH.185m

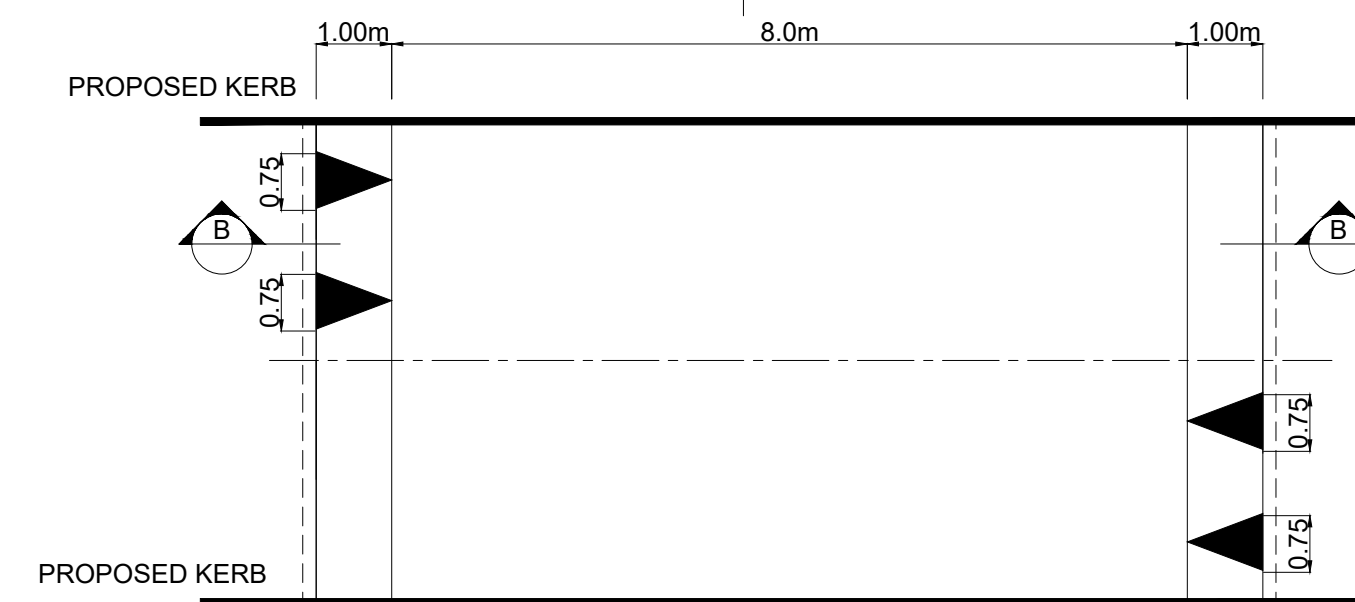

TYPICAL LAYOUT
SCALE 1:100

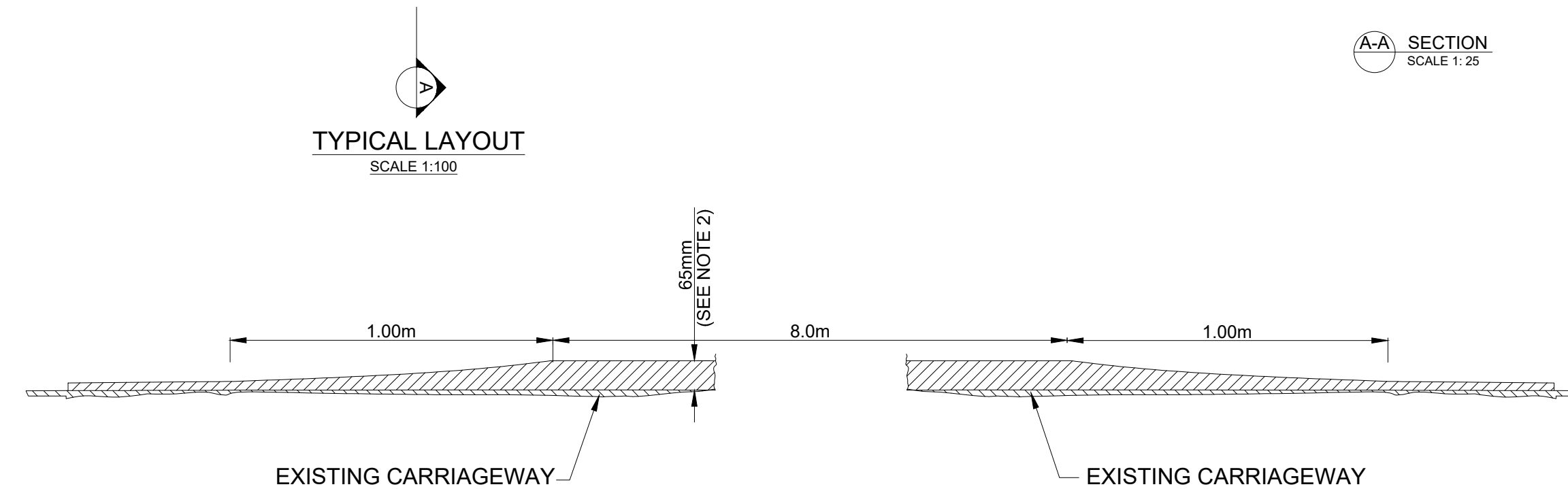

TYPICAL DETAILS OF ROAD HUMP (FLAT TOP)

B-B SECTION
SCALE 1:20

NOTES:

1. ALL DIMENSIONS ARE IN METRES UNLESS OTHERWISE STATED.
2. ALL HUMPS ARE TO HAVE A MAXIMUM HEIGHT OF 65mm ABOVE THE EXISTING CARRIAGEWAY LEVEL.
3. THE WEARING COURSE SHALL BE GROUP B24 OR B25 WITH BITUMEN BINDER GRADE 100 PEN. PSV SHALL BE 55 WITH AAV MAX. 12 UNLESS OTHERWISE SPECIFIED BY THE ENGINEER. THERE IS NO SURFACE TEXTURES DEPTH REQUIREMENT.
4. FOR HUMPS DETAILS, PLEASE REFER TO GH/HSD/1100/15.

KEY:

- CARRIAGEWAY
- PROPOSED TACTILE PAVING (CONTROLLED CROSSING - RED COLOUR)
- PROPOSED CORDUROY PAVING
- PROPOSED TRAMLINE AND LADDER PAVING

SAFETY, HEALTH AND ENVIRONMENTAL INFORMATION

In addition to the hazards/risks normally associated with the types of work detailed on this drawing, note the following significant residual risks (Reference shall also be made to the design hazard log).

Construction	NA
Maintenance / Cleaning	NA
Use	NA
Decommissioning / Demolition	NA

Status	Revision	Drawn	Checked	Reviewed	Authorised	Issue Date
Description						
Status	Revision	Drawn	Checked	Reviewed	Authorised	Issue Date
Description						
Status	Revision	Drawn	Checked	Reviewed	Authorised	Issue Date
Description						
Status	Revision	Drawn	Checked	Reviewed	Authorised	Issue Date
Description						
Status	Revision	Drawn	Checked	Reviewed	Authorised	Issue Date
Description						
Status	Revision	Drawn	Checked	Reviewed	Authorised	Issue Date
Description						
Status	Revision	Drawn	Checked	Reviewed	Authorised	Issue Date
Description						
Status	Revision	Drawn	Checked	Reviewed	Authorised	Issue Date
Description						
Status	Revision	Drawn	Checked	Reviewed	Authorised	Issue Date
Description						

WORK IN PROGRESS S0

AtkinsRéalis
5th Floor, Block 5
Shire Hall
Bearland
Gloucester
GL1 2TH
Tel : 08000 514514

Copyright © AtkinsRéalis (2024) www.AtkinsRéalis.com

Gloucestershire
COUNTY COUNCIL

Project Title
Black Dog Way Detailed Design

Drawing Title
**PROPOSED PARALLEL CROSSING
GREAT WESTERN ROAD
AT CHANIAGE 180m**

Drawing Number
Project **BDW-GWR - ATK - HGN -**
Volume **BDW - SK - CH - 000101**

Location
Original Size: **A1** Scale: **NTS** Project Ref. No.: **5222395** Sheet: **1 of 1** Rev: **P01.1**