



Department  
for Transport

## Road Traffic Regulation Act 1984 Sections 64 and 65

### Authorisation of traffic signs and special directions

#### Accessible transcript

Secretary of State for Transport's traffic authorisation of traffic signs for the purpose of reducing vehicle speeds in Clay Lane, Jacobs Well, Guildford, for which Surrey County Council is the traffic authority.

The following pages contain a copy of the text from the Secretary of State for Transport's traffic authorisation regarding the above traffic signs.

A scanned copy of the signed authorisation and supporting documents from the application are appended to this letter. The supporting material is submitted to the Department for Transport by a third party. You should refer to the party involved for accessible copies of the supporting material.



**HIGHWAYS ACT 1980 – SECTION 90  
AUTHORISATION OF ROAD HUMPS**

The Secretary of State for Transport, in exercise of her powers under Section 90 of the Highways Act 1980, and of all other powers enabling her in that behalf, for the purpose of reducing vehicle speeds in Clay Lane, Jacobs Well, Guildford, for which Surrey County Council is the traffic authority, hereby:-

1. authorises the placing upon a road hump, at or within 5 metres of the site shown schematically on the attached plan numbered GT50/160/0031-1, of a signal-controlled pedestrian facility (hereinafter referred to as “the authorised crossing”) as defined within Schedule 1 of the Traffic Signs Regulations and General Directions 2016 (Part 1 of S.I. 2016/362, “the 2016 Regulations”) and conforming as to size, colour and character with that shown on the attached plan numbered GT50/160/0031-2; and
2. directs, without prejudice to any statutory provision to the like effect, that it is a condition of this authorisation that the placing of the authorised crossing at or near the said site shall continue to have effect only until such day as may be appointed by one month’s notice given by the Secretary of State in writing to the traffic authority for the removal or alteration of the authorised hump, and on that day the said authorisation shall, without prejudice to the giving of any further authorisation or direction, cease to have effect.

The provisions of the Highways (Road Humps) Regulations 1999 shall apply to the road hump and the authorised crossing, save that an imaginary line along the centre of each hump from one side of the road to the other need not be in the same position as an imaginary line along the centre of the limits of the crossing from one side of the road to the other as shown in the diagram in Schedule 14, Part 2, Item 51 of the 2016 Regulations.



The provisions of Regulations 5, 7, 9, 10 and 11 of the 2016 Regulations shall apply to the authorised crossing in the same manner as they apply to the marking shown in the diagram in Schedule 14, Part 2, Item 51 of those Regulations.

The provisions of Schedule 14, Part 2, Item 55, Columns 3, 4 and 6 of the 2016 Regulations shall apply to the authorised crossing.

Dated *20 January 2025*

Signed by authority of the Secretary of State

.....

A Delegated Official of the Department for Transport



Department  
for Transport

**SCANNED  
AUTHORISATION  
AND SUPPORTING  
DOCUMENTS  
FOLLOW**



**HIGHWAYS ACT 1980 – SECTION 90  
AUTHORISATION OF ROAD HUMPS**

The Secretary of State for Transport, in exercise of her powers under Section 90 of the Highways Act 1980, and of all other powers enabling her in that behalf, for the purpose of reducing vehicle speeds in Clay Lane, Jacobs Well, Guildford, for which Surrey County Council is the traffic authority, hereby:-

1. authorises the placing upon a road hump, at or within 5 metres of the site shown schematically on the attached plan numbered GT50/160/0031-1, of a signal-controlled pedestrian facility (hereinafter referred to as “the authorised crossing”) as defined within Schedule 1 of the Traffic Signs Regulations and General Directions 2016 (Part 1 of S.I. 2016/362, “the 2016 Regulations”) and conforming as to size, colour and character with that shown on the attached plan numbered GT50/160/0031-2; and
2. directs, without prejudice to any statutory provision to the like effect, that it is a condition of this authorisation that the placing of the authorised crossing at or near the said site shall continue to have effect only until such day as may be appointed by one month’s notice given by the Secretary of State in writing to the traffic authority for the removal or alteration of the authorised hump, and on that day the said authorisation shall, without prejudice to the giving of any further authorisation or direction, cease to have effect.

The provisions of the Highways (Road Humps) Regulations 1999 shall apply to the road hump and the authorised crossing, save that an imaginary line along the centre of each hump from one side of the road to the other need not be in the same position as an imaginary line along the centre of the limits of the crossing from one side of the road to the other as shown in the diagram in Schedule 14, Part 2, Item 51 of the 2016 Regulations.



Department  
for Transport

GT50/160/0031

The provisions of Regulations 5, 7, 9, 10 and 11 of the 2016 Regulations shall apply to the authorised crossing in the same manner as they apply to the marking shown in the diagram in Schedule 14, Part 2, Item 51 of those Regulations.

The provisions of Schedule 14, Part 2, Item 55, Columns 3, 4 and 6 of the 2016 Regulations shall apply to the authorised crossing.

Dated *20 January 2025*

Signed by authority of the Secretary of State

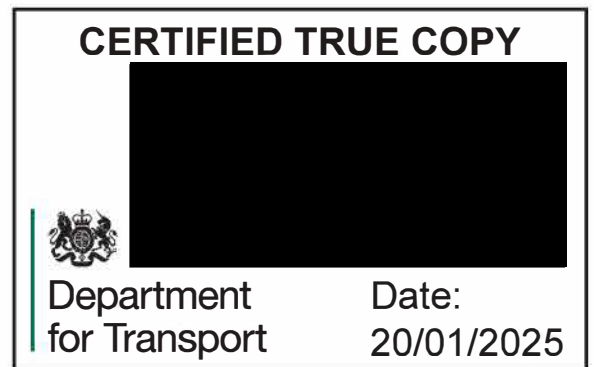
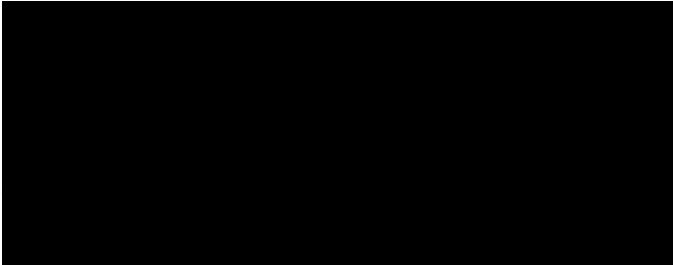

A Delegated Official of the Department for Transport

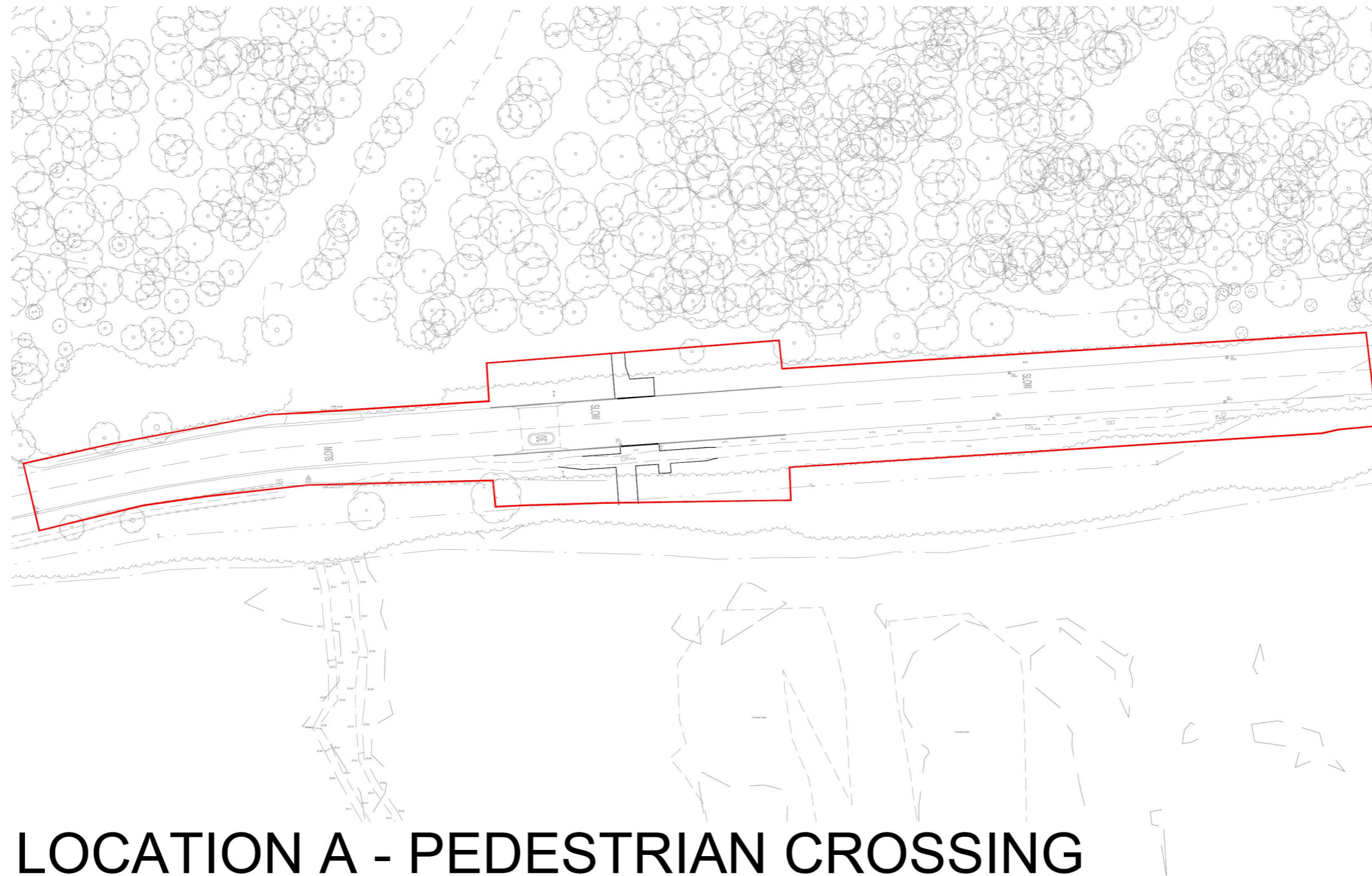

## LOCATION A - PEDESTRIAN CROSSING

Proposed Pedestrian Crossing:

Clay Lane, Jacobs Well, Guildford, GU4 7NZ

51.268398, -0.562218



Department  
for Transport

Date: 16 January 2025

Number: GT50/160/0031-1

DO NOT SCALE OFF THIS DRAWING

NOTES:

1. All dimensions are shown in metres unless otherwise stated
2. This drawing is to be read in conjunction with all Markides Associates drawings with project reference number 23335.
3. Proposed design has been undertaken using Topographical Survey 43247/BWLS-01\_22 Rev A provided by Survey Solution, dated 14/1/22.

KEY:

- SHEET LAYOUT
- S278 Boundary
- S38 Boundary
- Proposed Kerbline

ADDRESS:

**Proposed Car Park:**  
Clay Lane,  
Jacobs Well,  
Guildford,  
GU4 7NA

51.267331, -0.557068

//what3words  
winter.loyal.gitz

**Proposed Pedestrian Crossing:**

Clay Lane,  
Jacobs Well,  
Guildford,  
GU4 7NZ

51.268398, -0.562218

//what3words  
joins.flames.entire

### Proposed Pedestrian Crossing:

Clay Lane,  
Jacobs Well,  
Guildford,  
GU4 7NZ

51.268398, -0.562218

LOCATION A - PEDESTRIAN CROSSING

LOCATION B - CAR PARK

Revision History					
Rev	Comment	By	Chk'd	Appr	Date
P03	UPDATED AS PER SCC COMMENTS	CNV	BS	BS	05.07.24
P02	FOR APPROVAL	LB	BS	BS	02.04.24
P01	FOR APPROVAL	LB	BS	BS	27.02.24
Current Revision					
P03	UPDATED AS PER SCC COMMENTS	CNV	BS	BS	05.07.24
Rev	Comment	By	Chk'd	Appr	Date

S4 - FOR APPROVAL

GUILDFORD BC



Project  
WUV SANG  
SECTION 278

Drawing Title  
LOCATION PLAN

Markides Associates reference: 23335 1:1250 @A1  
23335-MA-XX-XX-DR-C-0001-S4 - P03



© Markides Associates 2024. All rights reserved

M:\Projects\23335\23335-MA-XX-XX-DR-C-0001-S4.dwg 23/03/2024 10:30:00 AM 23/03/2024 10:30:00 AM 23/03/2024 10:30:00 AM



Proposed Pedestrian Crossing:

Clay Lane,  
Jacobs Well,  
Guildford,  
GU4 7NZ

51.268398, -0.562218



LOCATION A - PEDESTRIAN CROSSING



Department  
for Transport

Date: 16 January 2025

Number: GT50/160/0031-2

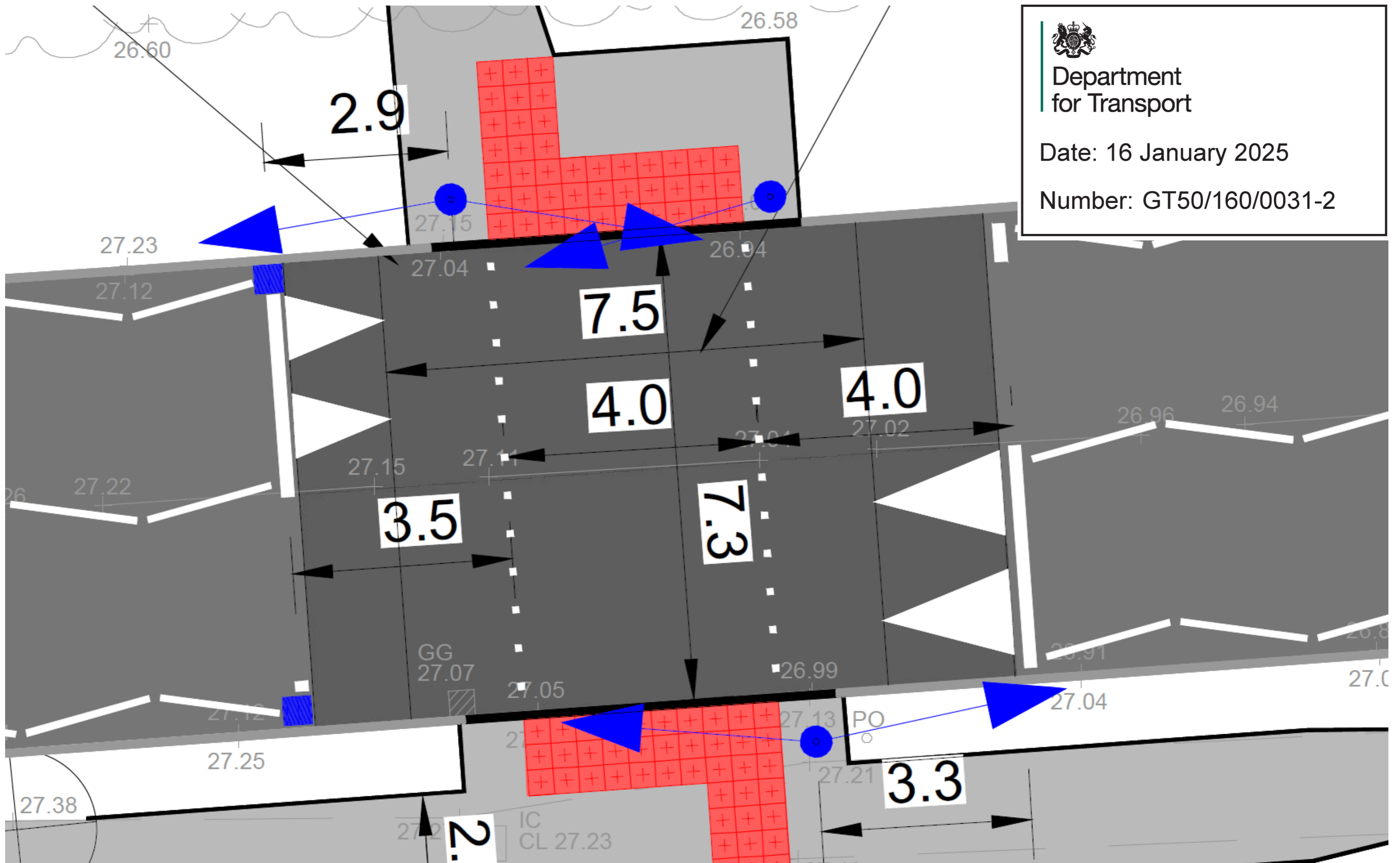

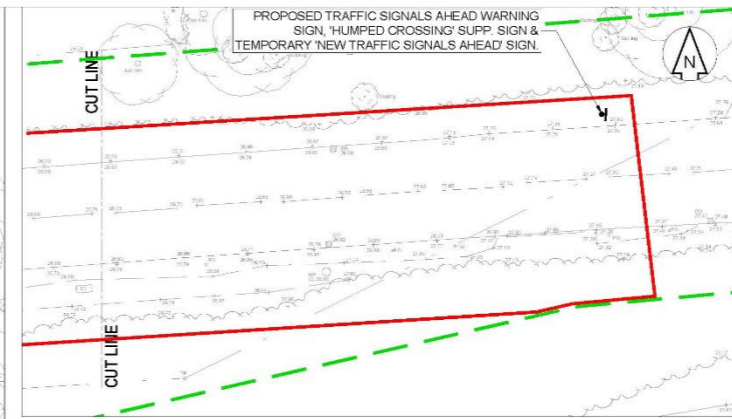
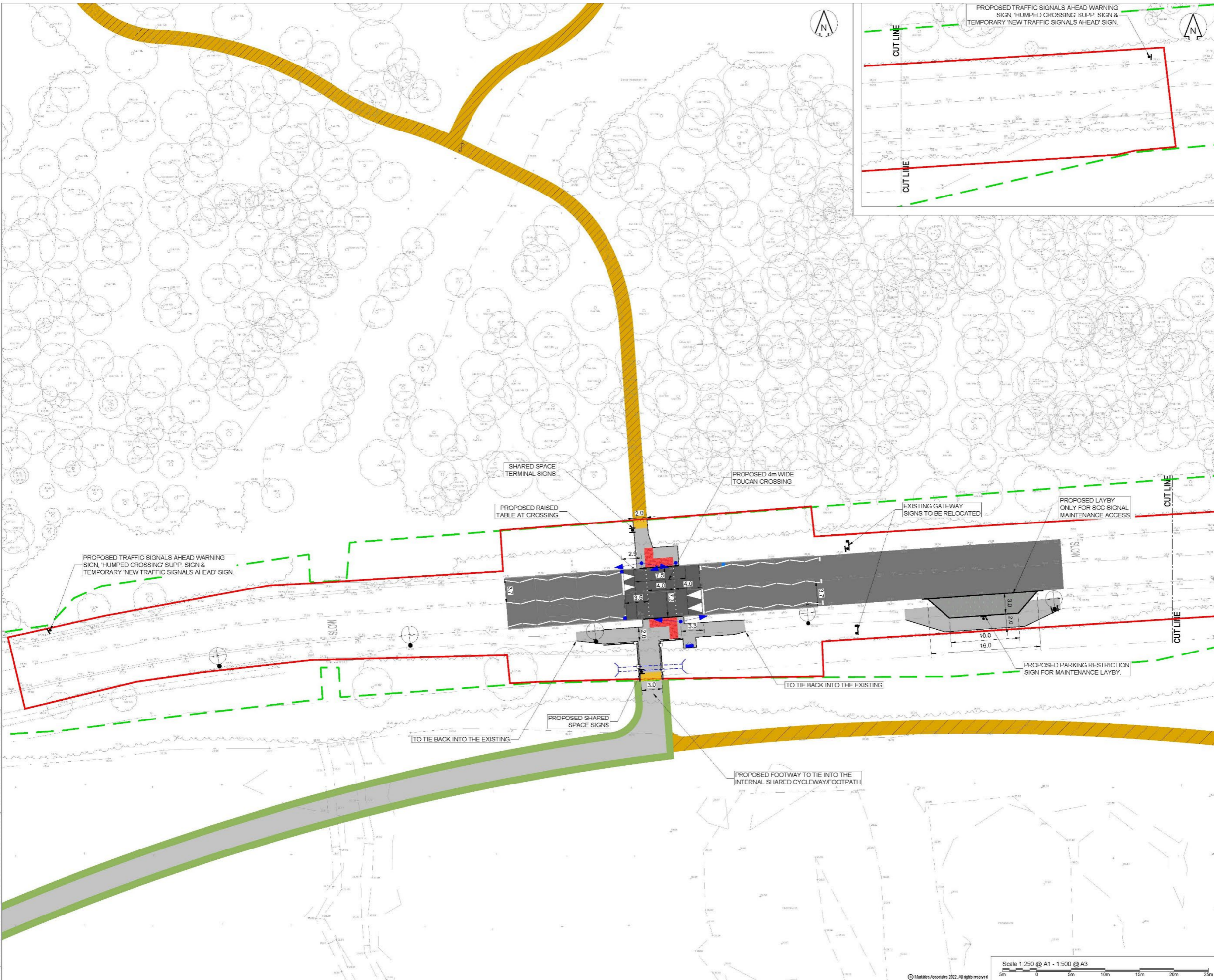

DO NOT SCALE OFF THIS DRAWING

- Notes:
- All dimensions are shown in metres unless otherwise stated.
  - This drawing is to be read in conjunction with all Markides Associates drawings with project reference number 23335.
  - Proposed design has been undertaken using Topographical Survey 43247/BWLS-01\_22 Rev A provided by Survey Solution, dated 14/11/22.
  - Contractor shall not construct works until traffic management plans/proposals have been agreed with Highways Authority (Surrey County Council).
  - All Highway works to be in accordance with the MCHW Specification for Highways Works and Surrey County Council Standard detail drawings.
  - Existing gullies within the S278 boundary are to be jetted and cleaned.
  - HEALTH AND SAFETY:** The works shall be carried out by specialist competent and experienced contractors who are members of a recognised national organisation. Operatives shall have received full and appropriate training for the operations they are to undertake. All work shall be carried out in accordance with all pertinent Health and Safety Regulations.
  - Raised table designed in accordance with the Traffic Calming Guidance, Chapter 2, with the gradient of 1:12.
  - For lighting design details, refer to LD112427 - Proposed Lighting Layout by OriginDC.

- KEY:
- Highway Boundary
  - S278 Boundary
  - Proposed Kerbline
  - Proposed Timber Post & Rail Fence 1.4m High
  - Existing Kerbline
  - Carriageway
  - Grasscrete
  - Footway
  - Road Markings
  - Proposed Red Colour Tactile Paving for controlled crossing (Blister surface)
  - Proposed Buff Colour Tactile Paving for cycleway end of route (Flat-topped bar surface laid transversely)
  - Proposed Traffic Signals
  - Proposed Traffic Controller
  - Proposed Signs
  - Existing Gully
  - Proposed Gully
  - Internal Shared Footway/Cycleway (Designed by Others)
  - Internal Footpath (Designed by Others)
  - Proposed Headwall & Culvert Pipe
  - Proposed Lighting Column (See Note 9)

Revision History

Rev	Comment	By	Chk'd	Appr	Date
P05	UPDATED AS PER SCC COMMENTS	CWV	BS	BS	18.12.24
P04	UPDATED AS PER SCC COMMENTS	CWV	BS	BS	21.06.24
P03	UPDATED AS PER SCC COMMENTS	CWV	BS	BS	09.07.24
P02	FOR APPROVAL	LB	BS	BS	02.04.24
P01	FOR APPROVAL	LB	BS	BS	27.02.24

**S4 - FOR APPROVAL**

**GUILDFORD BC**

**MARKIDES ASSOCIATES**  
TECHNOLOGY PLANNING AND ENGINEERING

Project:  
**WUV SANG SECTION 278**

Drawing Title:  
**GENERAL ARRANGEMENT LOCATION A PROPOSED SIGNALISED CROSSING**

Markides Associates reference: 23335 1250@A1  
23335-MA-XX-DR-C-0101-S4 - P05

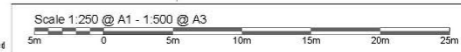

M:\Projects\23335\23335-MA-XX-DR-C-0101-S4.dwg