



Department
for Transport

Road Traffic Regulation Act 1984

Sections 64 and 65

Authorisation of traffic signs and special directions

Accessible transcript

Secretary of State for Transport's traffic authorisation of traffic signs for the purpose of informing road users of the crossing prerequisites in the vicinity of the Brick Kiln Level Crossing, for which the traffic authority Suffolk County Council permits the placing of signs by Network Rail.

The following pages contain a copy of the text from the Secretary of State for Transport's traffic authorisation regarding the above traffic signs.

A scanned copy of the signed authorisation and supporting documents from the application are appended to this letter. The supporting material is submitted to the Department for Transport by a third party. You should refer to the party involved for accessible copies of the supporting material.



**ROAD TRAFFIC REGULATION ACT – SECTIONS 64 AND 65
AUTHORISATION OF TRAFFIC SIGNS AND SPECIAL DIRECTIONS**

The Secretary of State for Transport, in exercise of her powers under Sections 64 and 65 of the Road Traffic Regulation Act 1984, and of all other powers enabling her in that behalf for the purpose of informing road users of the crossing prerequisites in the vicinity of the Brick Kiln Level Crossing, for which the traffic authority Suffolk County Council permits the placing of signs by Network Rail, hereby:-

1. authorises the erection at or within 5 metres of the sites marked schematically on the attached plan numbered GT50/144/0023-1 of a traffic sign (hereinafter referred to as “the authorised sign”) conforming as to size, colour and character with that shown in the attached drawing numbered GT50/144/0023-2; and
2. directs, without prejudice to any statutory provision to the like effect, that it is a condition of this authorisation that the erection of the authorised sign at or near the said sites shall continue to have effect only until such day as may be appointed by one month’s notice given by the Secretary of State in writing to the traffic authority for the removal or alteration of the authorised sign and on that day the said authorisation shall, without prejudice to the giving of any further authorisation or direction, cease to have effect.

The provisions of Regulation 11 of the Traffic Signs Regulations 2016 (Part 1 of S.I. 2016/362) shall apply to the authorised sign in the same manner as they apply to the signs shown in those Regulations.

Dated *06 January 2026*

Signed by authority of the Secretary of State

.....
A Delegated Official of the Department for Transport



Department
for Transport

SCANNED AUTHORISATION AND SUPPORTING DOCUMENTS FOLLOW



**ROAD TRAFFIC REGULATION ACT – SECTIONS 64 AND 65
AUTHORISATION OF TRAFFIC SIGNS AND SPECIAL DIRECTIONS**

The Secretary of State for Transport, in exercise of her powers under Sections 64 and 65 of the Road Traffic Regulation Act 1984, and of all other powers enabling her in that behalf for the purpose of informing road users of the crossing prerequisites in the vicinity of the Brick Kiln Level Crossing, for which the traffic authority Suffolk County Council permits the placing of signs by Network Rail, hereby:-

1. authorises the erection at or within 5 metres of the sites marked schematically on the attached plan numbered GT50/144/0023-1 of a traffic sign (hereinafter referred to as “the authorised sign”) conforming as to size, colour and character with that shown in the attached drawing numbered GT50/144/0023-2; and
2. directs, without prejudice to any statutory provision to the like effect, that it is a condition of this authorisation that the erection of the authorised sign at or near the said sites shall continue to have effect only until such day as may be appointed by one month’s notice given by the Secretary of State in writing to the traffic authority for the removal or alteration of the authorised sign and on that day the said authorisation shall, without prejudice to the giving of any further authorisation or direction, cease to have effect.

The provisions of Regulation 11 of the Traffic Signs Regulations 2016 (Part 1 of S.I. 2016/362) shall apply to the authorised sign in the same manner as they apply to the signs shown in those Regulations.

Dated *06 January 2026*

Signed by authority of the Secretary of State



A Delegated Official of the Department for Transport

Location of Brick Kiln Crossing, Saxmundham IP17 1HA,

what3words: defectors.coherent.pavillions



Department
for Transport

Date: 06 January 2026

Number: GT50/144/0023-1

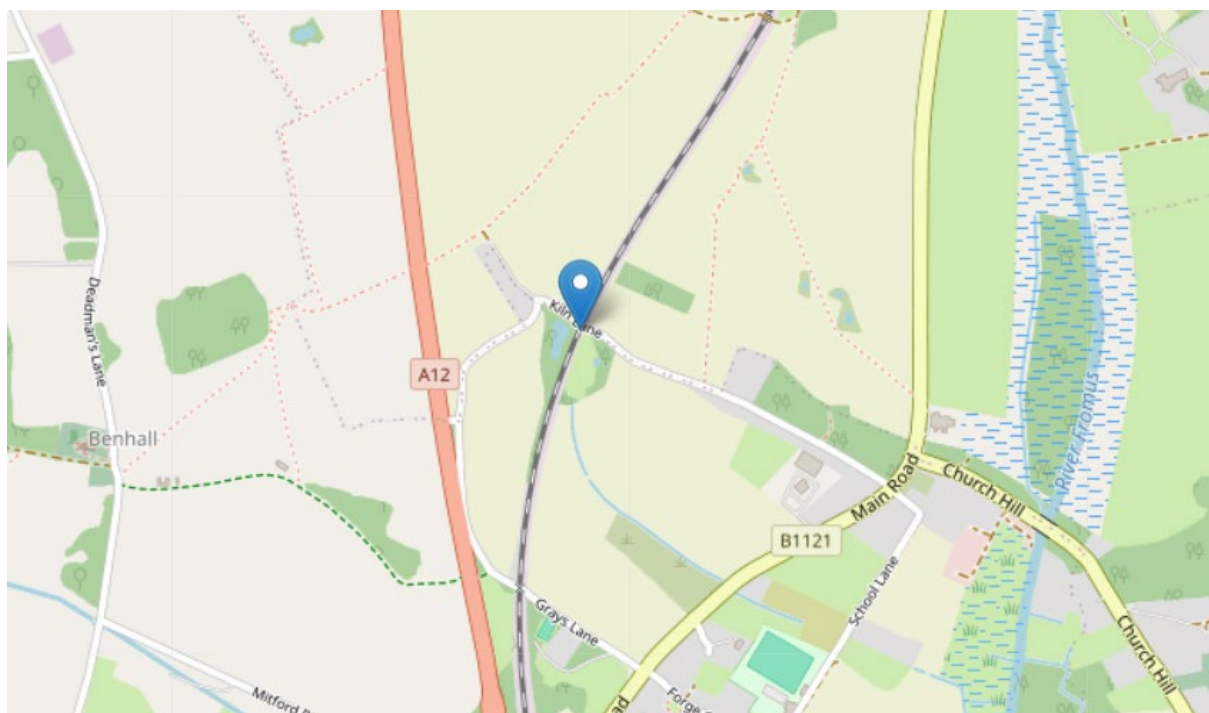
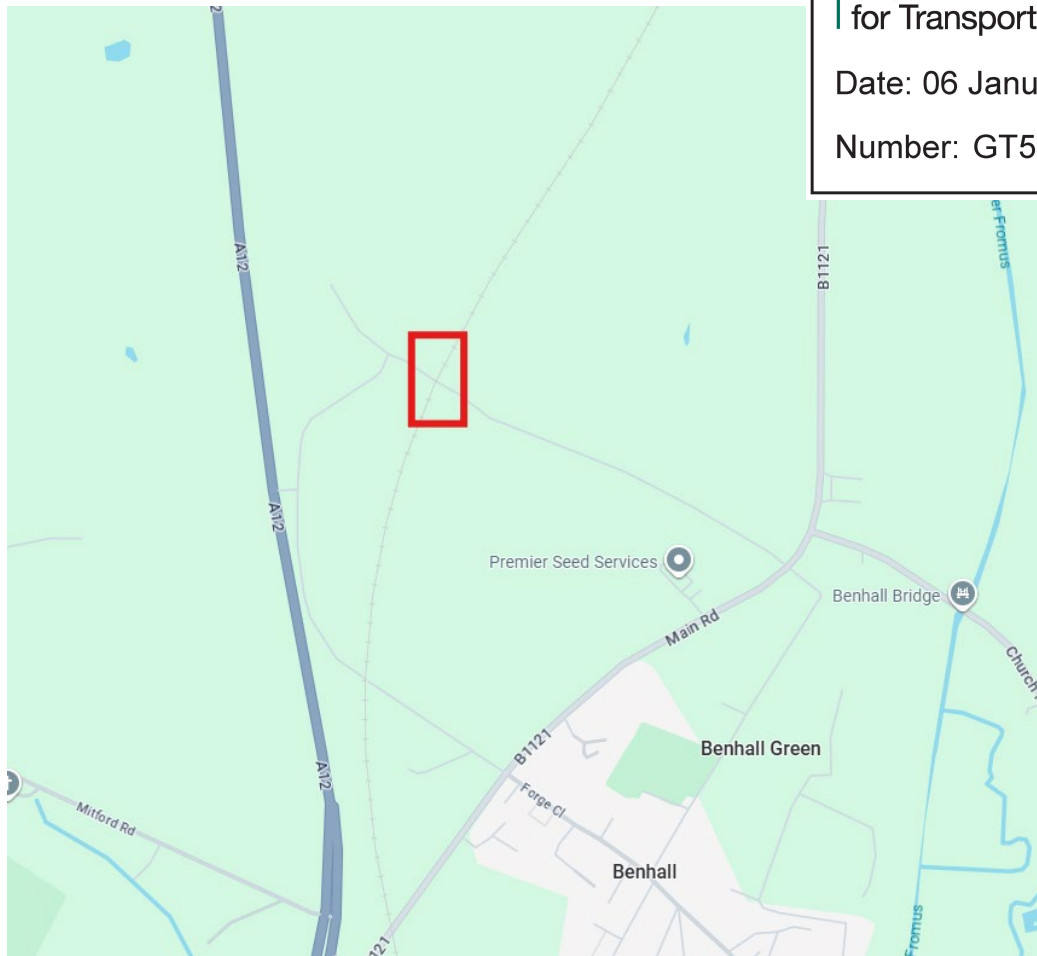

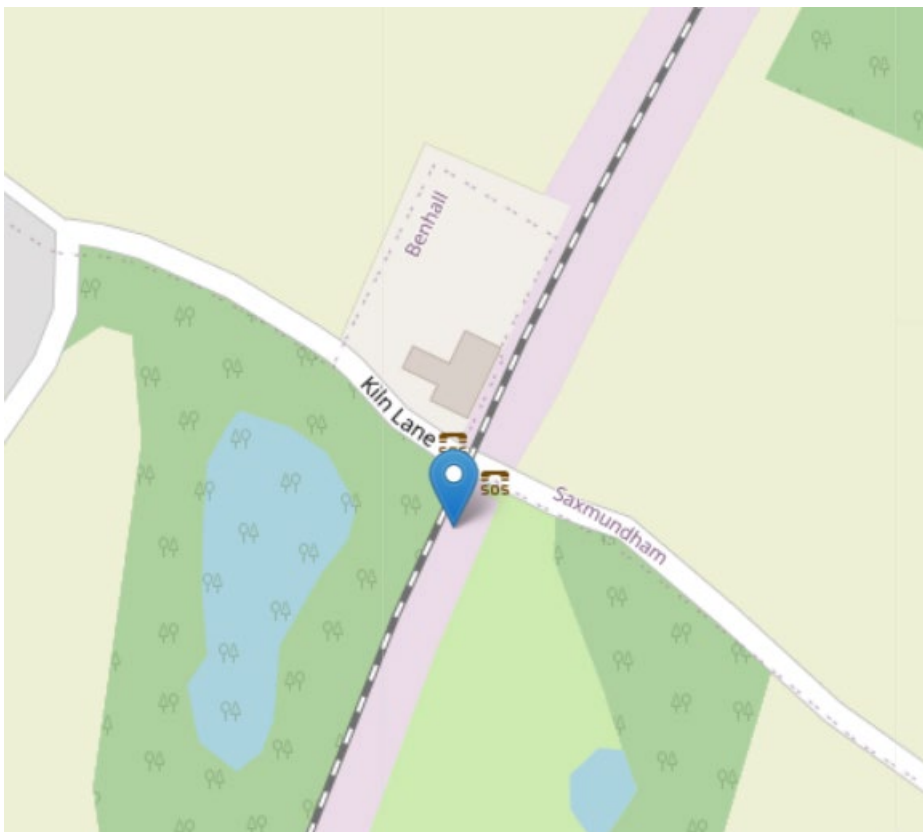
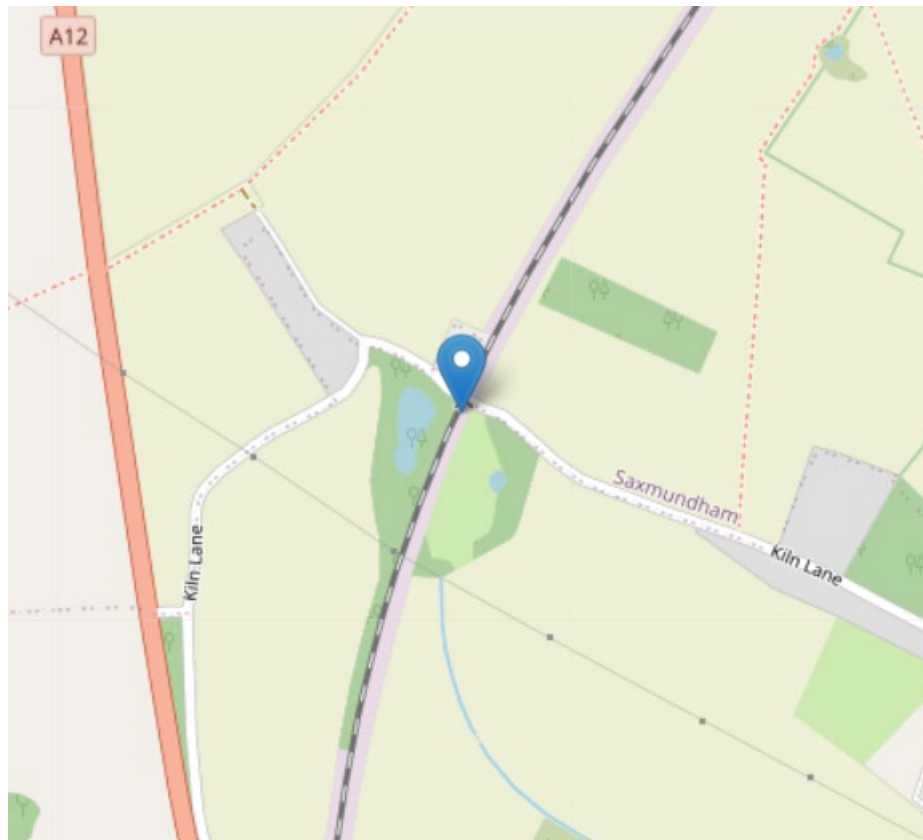

**EMERGENCY
VEHICLE
ACCESS ONLY**



Always telephone before crossing with an emergency vehicle

- 1. You must use the telephone provided to get permission to cross**
- 2. Tell the signaller what you are crossing with and follow the instructions given**
- 3. When permission is given, open both gates on foot**
- 4. Cross without stopping**
- 5. Close both gates on foot**
- 6. You must use the telephone again to tell the signaller that you have crossed safely**



Always telephone before crossing with a horse

- 1. You must use the telephone provided to get permission to cross**
- 2. Tell the signaller what you are crossing with and follow the instructions given**
- 3. When permission is given, open the first gate, enter the crossing, and close the gate behind you**
- 4. Cross without stopping**
- 5. Open the second gate, exit the crossing, and close the gate behind you**
- 6. You must use the telephone again to tell the signaller that you have crossed safely**

Width 600mm, H=1320mm.



Department
for Transport

Date: 06 January 2026

Number: GT50/144/0023-2

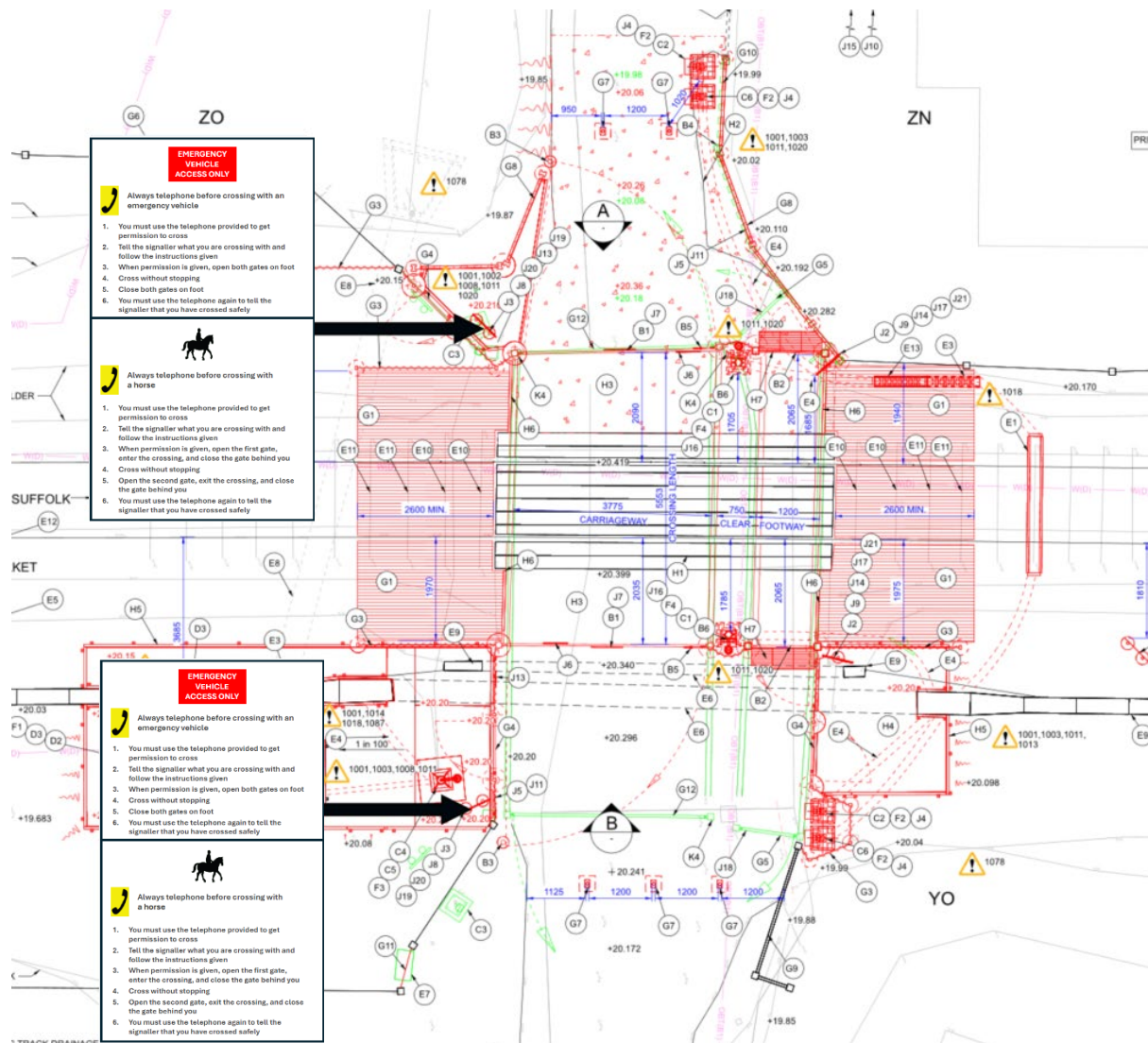



Instructions when using Vehicle Gates

EMERGENCY VEHICLE ACCESS ONLY



Always telephone before crossing with an emergency vehicle

1. You must use the telephone provided to get permission to cross
2. Tell the signaller what you are crossing with and follow the instructions given
3. When permission is given, open both gates on foot
4. Cross without stopping
5. Close both gates on foot
6. You must use the telephone again to tell the signaller that you have crossed safely



Always telephone before crossing with a horse

1. You must use the telephone provided to get permission to cross
2. Tell the signaller what you are crossing with and follow the instructions given
3. When permission is given, open the first gate, enter the crossing, and close the gate behind you
4. Cross without stopping
5. Open the second gate, exit the crossing, and close the gate behind you
6. You must use the telephone again to tell the signaller that you have crossed safely