



Department  
for Transport

## **Road Traffic Regulation Act 1984**

### **Sections 64 and 65**

## **Authorisation of traffic signs and special directions**

### **Accessible transcript**

Secretary of State for Transport's traffic authorisation of traffic signs for the purpose of reducing vehicle speeds on Mingle Lane, Great Shelford, Cambridge for which Cambridgeshire County Council is the traffic authority.

The following pages contain a copy of the text from the Secretary of State for Transport's traffic authorisation regarding the above traffic signs.

A scanned copy of the signed authorisation and supporting documents from the application are appended to this letter. The supporting material is submitted to the Department for Transport by a third party. You should refer to the party involved for accessible copies of the supporting material.



**HIGHWAYS ACT 1980 – SECTION 90**  
**AUTHORISATION OF ROAD HUMPS**

The Secretary of State for Transport, in exercise of her powers under Section 90 of the Highways Act 1980, and of all other powers enabling her in that behalf, for the purpose of reducing vehicle speeds on Mingle Lane, Great Shelford, Cambridge for which Cambridgeshire County Council is the traffic authority, hereby:-

1. authorises the placing upon a road hump, at or within 5 metres of the site shown schematically on the attached plan numbered GT50/020/0031-1 of a parallel crossing (hereinafter referred to as “the authorised crossing”) as defined within Schedule 1 of the Traffic Signs Regulations and General Directions 2016 (Part 1 of S.I. 2016/362, “the 2016 Regulations”) and conforming as to size, colour and character with that shown on the attached plan numbered GT50/020/0031-2, and
2. directs that the provisions of Schedule 14, Part 2, Item 53, Columns 4 and 5 of the 2016 Regulations shall apply to the authorised crossing; and
3. directs, without prejudice to any statutory provision to the like effect, that it is a condition of this authorisation that the placing of the authorised crossing at or near the said site shall continue to have effect only until such day as may be appointed by one month’s notice given by the Secretary of State in writing to the traffic authority for the removal or alteration of the authorised hump, and on that day the said authorisation shall, without prejudice to the giving of any further authorisation or direction, cease to have effect.

The provisions of the Highways (Road Humps) Regulations 1999 shall apply to the road hump and the authorised crossing, save that an imaginary line along the centre of each hump from one side of the road to the other need not be in the same position as an imaginary line along the centre of the limits of the crossing from one side of the road to the other as shown in the diagram in Schedule 14, Part 2, Item 53 of the 2016 Regulations.



# Department for Transport

GT50/020/0031

The provisions of Regulations 5, 7, 9, 10 and 11 of the 2016 Regulations shall apply to the authorised crossing in the same manner as they apply to the marking shown in the diagram in Schedule 14, Part 2, Item 53 of those Regulations.

Dated *13 January 2026*

Signed by authority of the Secretary of State

.....  
A Delegated Official of the Department for Transport



Department  
for Transport

# **SCANNED AUTHORISATION AND SUPPORTING DOCUMENTS FOLLOW**



**HIGHWAYS ACT 1980 – SECTION 90**  
**AUTHORISATION OF ROAD HUMPS**

The Secretary of State for Transport, in exercise of her powers under Section 90 of the Highways Act 1980, and of all other powers enabling her in that behalf, for the purpose of reducing vehicle speeds on Mingle Lane, Great Shelford, Cambridge for which Cambridgeshire County Council is the traffic authority, hereby:-

1. authorises the placing upon a road hump, at or within 5 metres of the site shown schematically on the attached plan numbered GT50/020/0031-1 of a parallel crossing (hereinafter referred to as “the authorised crossing”) as defined within Schedule 1 of the Traffic Signs Regulations and General Directions 2016 (Part 1 of S.I. 2016/362, “the 2016 Regulations”) and conforming as to size, colour and character with that shown on the attached plan numbered GT50/020/0031-2, and
2. directs that the provisions of Schedule 14, Part 2, Item 53, Columns 4 and 5 of the 2016 Regulations shall apply to the authorised crossing; and
3. directs, without prejudice to any statutory provision to the like effect, that it is a condition of this authorisation that the placing of the authorised crossing at or near the said site shall continue to have effect only until such day as may be appointed by one month’s notice given by the Secretary of State in writing to the traffic authority for the removal or alteration of the authorised hump, and on that day the said authorisation shall, without prejudice to the giving of any further authorisation or direction, cease to have effect.

The provisions of the Highways (Road Humps) Regulations 1999 shall apply to the road hump and the authorised crossing, save that an imaginary line along the centre of each hump from one side of the road to the other need not be in the same position as an imaginary line along the centre of the limits of the crossing from one side of the road to the other as shown in the diagram in Schedule 14, Part 2, Item 53 of the 2016 Regulations.



# Department for Transport

GT50/020/0031

The provisions of Regulations 5, 7, 9, 10 and 11 of the 2016 Regulations shall apply to the authorised crossing in the same manner as they apply to the marking shown in the diagram in Schedule 14, Part 2, Item 53 of those Regulations.

Dated *13 January 2026*

Signed by authority of the Secretary of State



A Delegated Official of the Department for Transport

**CERTIFIED TRUE COPY**



Department  
for Transport

Date:  
14/01/2026





Department  
for Transport

Date: 13 January 2026

Number: GT50/020/0031-1

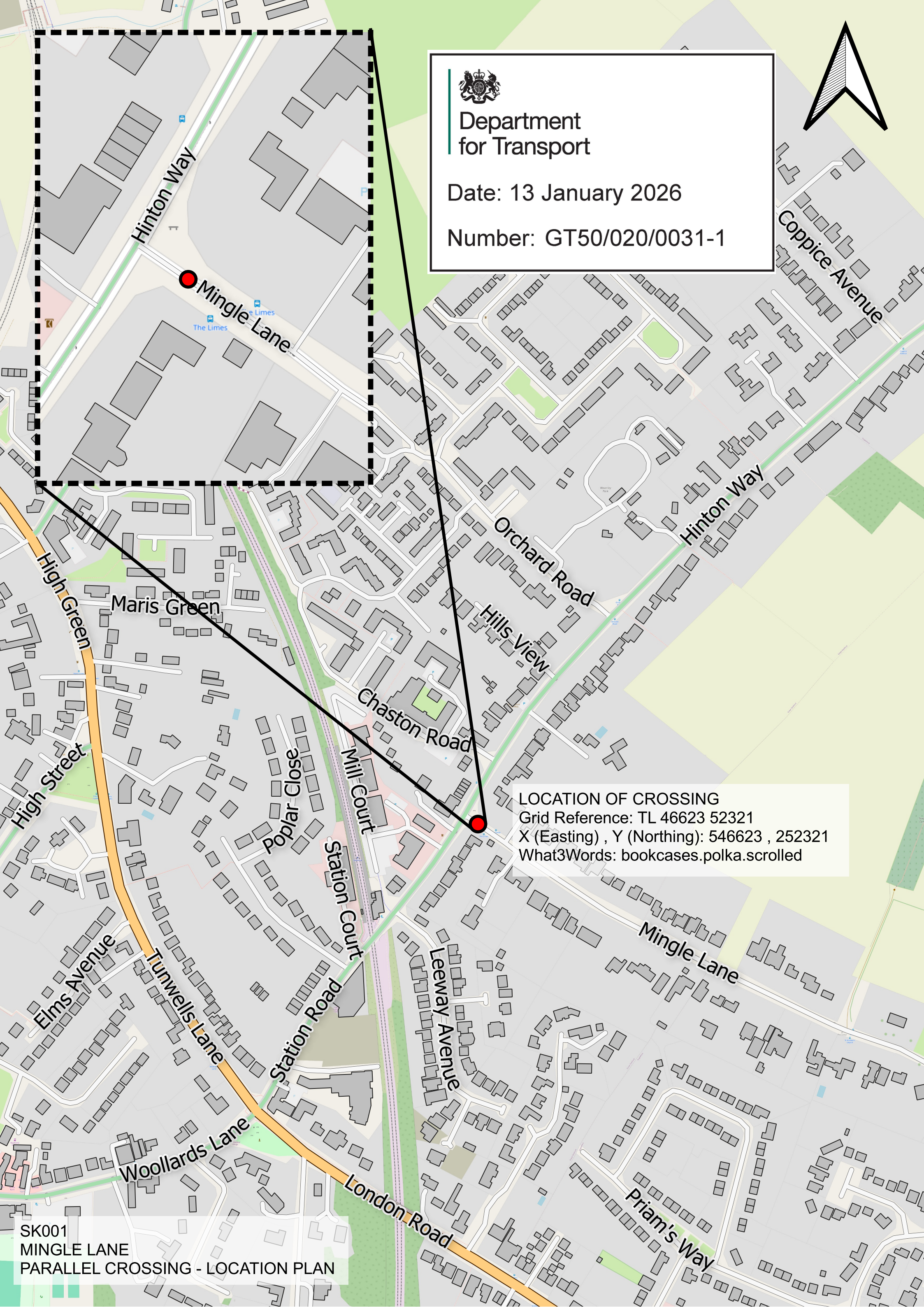
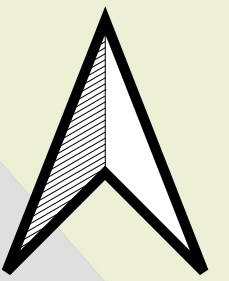

LOCATION OF CROSSING

Grid Reference: TL 46623 52321

X (Easting) , Y (Northing): 546623 , 252321

What3Words: bookcases.polka.scrolled





Department  
for Transport

Date: 13 January 2026

Number: GT50/020/0031-2



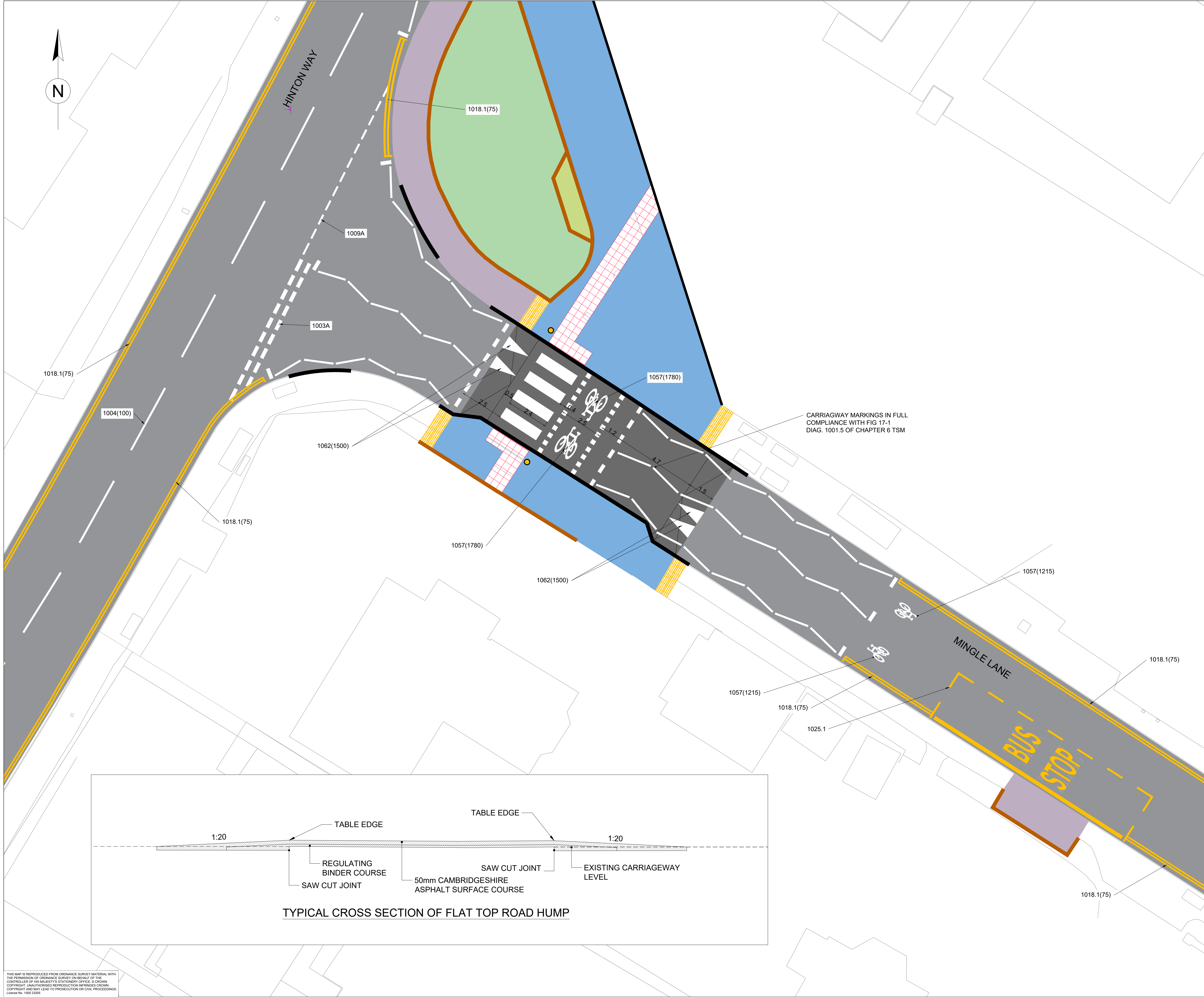

### NOTES

- ALL DIMENSIONS IN METRES UNLESS OTHERWISE STATED
- ALL HUMPS TO HAVE A MAXIMUM HEIGHT OF 75mm ABOVE CARRIAGEWAY LEVEL
- DO NOT SCALE FROM THIS DRAWING
- THIS DESIGN IS SUBJECT TO AUTHORISATION BY THE DEPARTMENT FOR TRANSPORT

### KEY

- CARRIAGEWAY
- PROPOSED ROAD HUMP
- PROPOSED FOOTWAY
- PROPOSED SHARED USE PATH
- PROPOSED LANDSCAPING
- PROPOSED PAVING FLAGS
- PROPOSED ROAD MARKING (WHITE)
- PROPOSED ROAD MARKING (YELLOW)
- PROPOSED BLISTER TACTILE PAVING SURFACE (RED)
- PROPOSED KERB
- PROPOSED EDGING
- YELLOW GLOBE TO DIAG. 4007 COMBINED WITH SUPPLEMENTARY LIGHTING
- PROPOSED HAZARD TACTILE PAVING SURFACE (BUFF)

### SAFETY, HEALTH AND ENVIRONMENTAL INFORMATION

In addition to the hazards/risks normally associated with the types of work detailed on this drawing, note the following significant residual risks (Reference shall also be made to the design hazard log).

Construction  
Live traffic & utilities, Presence of tar.  
Presence of soil contamination, asbestos and breaking of concrete not known.

Maintenance / Cleaning  
None

Use  
None

Decommissioning / Demolition  
None

P02	PM	AW	RS	05/01/25
REVISED AS PER TENDER SUBMISSION				
P01	AW	PC	PE	20/03/25
FIRST DRAFT				
Rev	Drawn / Des	Checked	Approved	Date
Description				
Drawing Status				Suitability
FOR DFT AUTHORISATION				S4
		5 Wellbrook Court, Cambridge CB3 0NA		
Copyright © AtkinsRéalis (2025)		Tel: +44 (0) 1223276002 www.atkinsrealis.com		
Client  Growing and sharing prosperity Delivering our City Deal				
Project Title GCP Early Works - Detailed Design Stapleford Village				
Drawing Title PARALLEL CROSSING ON ROAD HUMP FOR DFT AUTHORISATION				
Scale 1:100	Designed / Drawn AW	Checked PC	Approved PE	Authorised RS
Original Size A1	Date 18/03/25	Date 19/03/25	Date 20/03/25	Date 20/03/25
Drawing Number Project 5223864 GSFR	Originator ATK DR	Volume GEN 000001	Job No. 5223864	Revision P02

### TYPICAL CROSS SECTION OF FLAT TOP ROAD HUMP